

**TRACT 42915 - Portion of Blocks 17, 34, 35, and 38, Eugene Island Area, Revised, St. Mary Parish, Louisiana**

The beds and bottoms of all water bodies belonging to the State of Louisiana located in Blocks 17, 34, 35, and 38, Eugene Island Area, Revised, together with any present lands formed by accretion to the shoreline or islands formed therein, located in St. Mary Parish, Louisiana, owned by and not presently under mineral lease as of October 10, 2012, from the State of Louisiana, the geographical area of which is more fully described as follows: Beginning at a point having Coordinates of X = 1,967,399.14 and Y = 241,744.30; thence South 71 degrees 37 minutes 54 seconds East 2,693.79 feet to the Southwest corner of State Lease No. 19924 having Coordinates of X = 1,969,955.68 and Y = 240,895.42; thence East 5,000 feet along the South boundary of said State Lease No. 19924 to its Southeast corner having Coordinates of X = 1,974,955.68 and Y = 240,895.42; thence South 58 degrees 34 minutes 28 seconds East 2,851.53 feet to a point having Coordinates of X = 1,977,388.94 and Y = 239,408.66; thence South 02 degrees 14 minutes 08 seconds East 13,854.81 feet to a point on the Three Mile Line, as decreed by the Supreme Court of the United States, as determined by a Special Master appointed therein, in litigation styled *United States v. State of Louisiana et al No. 9 Original*, in 1975, having Coordinates of X = 1,977,929.41 and Y = 225,564.39; thence Northwesterly along an arc having a radius of 18,240.60 feet and a center located at X = 1,987,818 and Y = 240,892 to a point having Coordinates of X = 1,975,782 and Y = 227,186; thence Northwesterly along an arc having a radius of 18,240.60 feet and a center located at X = 1,987,371 and Y = 241,272 to a point having Coordinates of X = 1,972,054 and Y = 231,367; thence Northwesterly on a straight line to a point having Coordinates of X = 1,967,603.12 and Y = 233,313.87; thence North 01 degrees 23 minutes 10 seconds West 8,432.89 feet to the point of beginning, containing approximately **2,499.28 acres, LESS AND EXCEPT** that portion thereof, if any, lying seaward of the line three nautical miles from the coast line of Louisiana, as said three mile line has been decreed by the Supreme Court of the United States, as determined by a Special Master appointed therein, in litigation styled **United States v. State of Louisiana et al No. 9 Original**, in 1975, all as more particularly outlined on a plat in the Office of Mineral Resources, Department of Natural Resources. All bearings, distances and coordinates are based on the Louisiana Coordinate System of 1927, (South Zone).

NOTE: The above description of the Tract nominated for lease has been provided and corrected, where required, exclusively by the nomination party. Any mineral lease selected from this Tract and awarded by the Louisiana State Mineral and Energy Board shall be without warranty of any kind, either express, implied, or statutory, including, but not limited to, the implied warranties of merchantability and fitness for a particular purpose. Should the mineral lease awarded by the Louisiana State Mineral and Energy Board be subsequently modified, cancelled or abrogated due to the existence of conflicting leases, operating agreements, private claims or other future obligations or conditions which may affect all or any portion of the leased Tract, it shall not relieve the Lessee of the

obligation to pay any bonus due thereon to the Louisiana State Mineral and Energy Board, nor shall the Louisiana State Mineral and Energy Board be obligated to refund any consideration paid by the Lessor prior to such modification, cancellation, or abrogation, including, but not limited to, bonuses, rentals and royalties.

NOTE: The above described tract may be in the vicinity of existing shell reefs where drilling and dredging operations must be conducted in strict conformity with the regulations adopted by the Louisiana Department of Wildlife and Fisheries and/or the U.S. Corps of Engineers, U.S. Army.

NOTE: The State of Louisiana does hereby reserve, and this lease shall be subject to, the imprescriptible right of surface use in the nature of a servitude in favor of the Department of Natural Resources, including its Offices and Commissions, for the sole purpose of implementing, constructing, servicing and maintaining approved coastal zone management and/or restoration projects. Utilization of any and all rights derived under this lease by the mineral lessee, its agents, successors or assigns, shall not interfere with nor hinder the reasonable surface use by the Department of Natural Resources, its Offices or Commissions, as herein above reserved.

NOTE: It appears, according to our records, that a portion of this Tract is located within the restrictive safety fairway area as set out by the Corps of Engineers, U.S. Army and/or the restrictive anchorage area as set out by the U.S. Coast Guard.

NOTE: This tract is located in an area designated by the Louisiana Legislature or the Wildlife and Fisheries Commission as a Public Oyster Seed Ground, Reservation, or area of Calcasieu or Sabine Lake. Proposed projects occurring in these areas will be evaluated on a case by case basis by Louisiana Department of Wildlife & Fisheries. Modifications to proposed project features including, but not limited to, access routes, well sites, flowlines, and appurtenant structures maybe required by the Louisiana Department of Wildlife and Fisheries. In addition, compensatory mitigation will be required to offset unavoidable habitat impacts.

Bidder	Cash Payment	Price/Acre	Rental	Oil	Gas	Other

Applicant: LESLIE M. COOPER

Legend

- 12100015 Blocks
- Active\_Leases

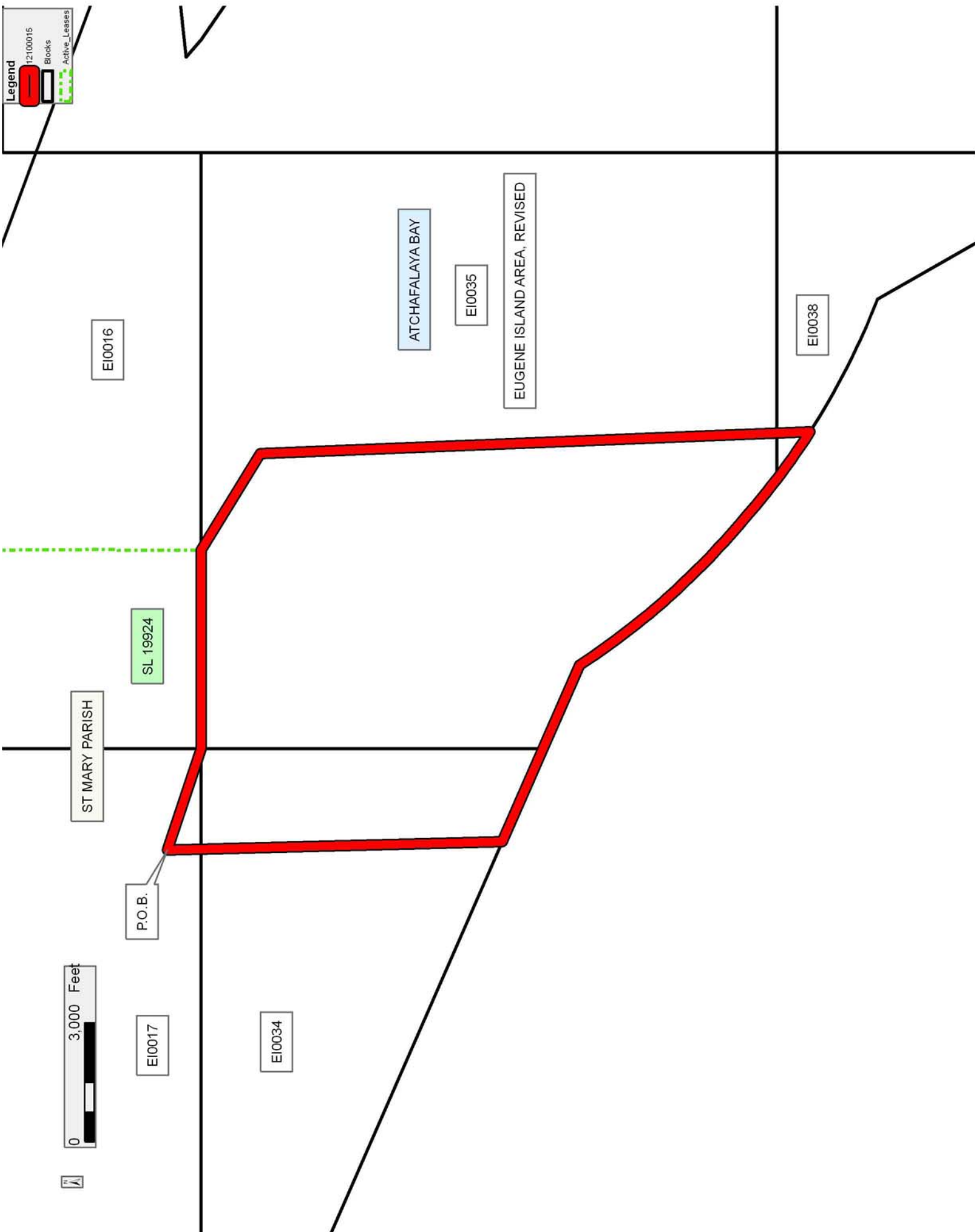

**TRACT 42916 - Portion of Blocks 35, 36, 37, and 38, Eugene Island Area, Revised, St. Mary Parish, Louisiana**

The beds and bottoms of all water bodies belonging to the State of Louisiana located in Blocks 35, 36, 37, and 38, Eugene Island Area, Revised, together with any present lands formed by accretion to the shoreline or islands formed therein, located in St. Mary Parish, Louisiana, owned by and not presently under mineral lease as of October 10, 2012, from the State of Louisiana, the geographical area of which is more fully described as follows: Beginning at a point having Coordinates of X = 1,977,388.94 and Y = 239,408.66; thence South 58 degrees 34 minutes 28 seconds East 8,615.60 feet to a point having Coordinates of X = 1,984,740.78 and Y = 234,916.56; thence South 02 degrees 14 minutes 08 seconds East 17,296.41 feet to a point on the Three Mile Line, as decreed by the Supreme Court of the United States, as determined by a Special Master appointed therein, in litigation styled *United States v. State of Louisiana et al No. 9 Original*, in 1975, having Coordinates of X = 1,985,415.51 and Y = 217,633.31; thence Northwesterly on a straight line to a point having Coordinates of X = 1,984,419 and Y = 218,858; thence Northwesterly along an arc having a radius of 18,240.60 feet and a center located at X = 1,998,568 and Y = 230,370 to a point having Coordinates of X = 1,982,726 and Y = 221,329; thence Northwesterly on a straight line to a point having Coordinates of X = 1,981,279 and Y = 223,864; thence Northwesterly along an arc having a radius of 18,240.60 feet and a center located at X = 1,987,818 and Y = 240,892 to a point having Coordinates of X = 1,977,929.41 and Y = 225,564.39; thence North 02 degrees 14 minutes 08 seconds West 13,854.81 feet to the point of beginning, containing approximately **2,435.03 acres, LESS AND EXCEPT** that portion thereof, if any, lying seaward of the line three nautical miles from the coast line of Louisiana, as said three mile line has been decreed by the Supreme Court of the United States, as determined by a Special Master appointed therein, in litigation styled **United States v. State of Louisiana et al No. 9 Original**, in 1975, all as more particularly outlined on a plat in the Office of Mineral Resources, Department of Natural Resources. All bearings, distances and coordinates are based on the Louisiana Coordinate System of 1927, (South Zone).

NOTE: The above description of the Tract nominated for lease has been provided and corrected, where required, exclusively by the nomination party. Any mineral lease selected from this Tract and awarded by the Louisiana State Mineral and Energy Board shall be without warranty of any kind, either express, implied, or statutory, including, but not limited to, the implied warranties of merchantability and fitness for a particular purpose. Should the mineral lease awarded by the Louisiana State Mineral and Energy Board be subsequently modified, cancelled or abrogated due to the existence of conflicting leases, operating agreements, private claims or other future obligations or conditions which may affect all or any portion of the leased Tract, it shall not relieve the Lessee of the obligation to pay any bonus due thereon to the Louisiana State Mineral and Energy Board, nor shall the Louisiana State Mineral and Energy Board be

obligated to refund any consideration paid by the Lessor prior to such modification, cancellation, or abrogation, including, but not limited to, bonuses, rentals and royalties.

NOTE: The above described tract may be in the vicinity of existing shell reefs where drilling and dredging operations must be conducted in strict conformity with the regulations adopted by the Louisiana Department of Wildlife and Fisheries and/or the U.S. Corps of Engineers, U.S. Army.

NOTE: The State of Louisiana does hereby reserve, and this lease shall be subject to, the imprescriptible right of surface use in the nature of a servitude in favor of the Department of Natural Resources, including its Offices and Commissions, for the sole purpose of implementing, constructing, servicing and maintaining approved coastal zone management and/or restoration projects. Utilization of any and all rights derived under this lease by the mineral lessee, its agents, successors or assigns, shall not interfere with nor hinder the reasonable surface use by the Department of Natural Resources, its Offices or Commissions, as herein above reserved.

NOTE: This tract is located in an area designated by the Louisiana Legislature or the Wildlife and Fisheries Commission as a Public Oyster Seed Ground, Reservation, or area of Calcasieu or Sabine Lake. Proposed projects occurring in these areas will be evaluated on a case by case basis by Louisiana Department of Wildlife & Fisheries. Modifications to proposed project features including, but not limited to, access routes, well sites, flowlines, and appurtenant structures maybe required by the Louisiana Department of Wildlife and Fisheries. In addition, compensatory mitigation will be required to offset unavoidable habitat impacts.

Applicant: LESLIE M. COOPER

Bidder	Cash Payment	Price/Acre	Rental	Oil	Gas	Other

**Legend**

- 12100014
- Blocks
- Countries

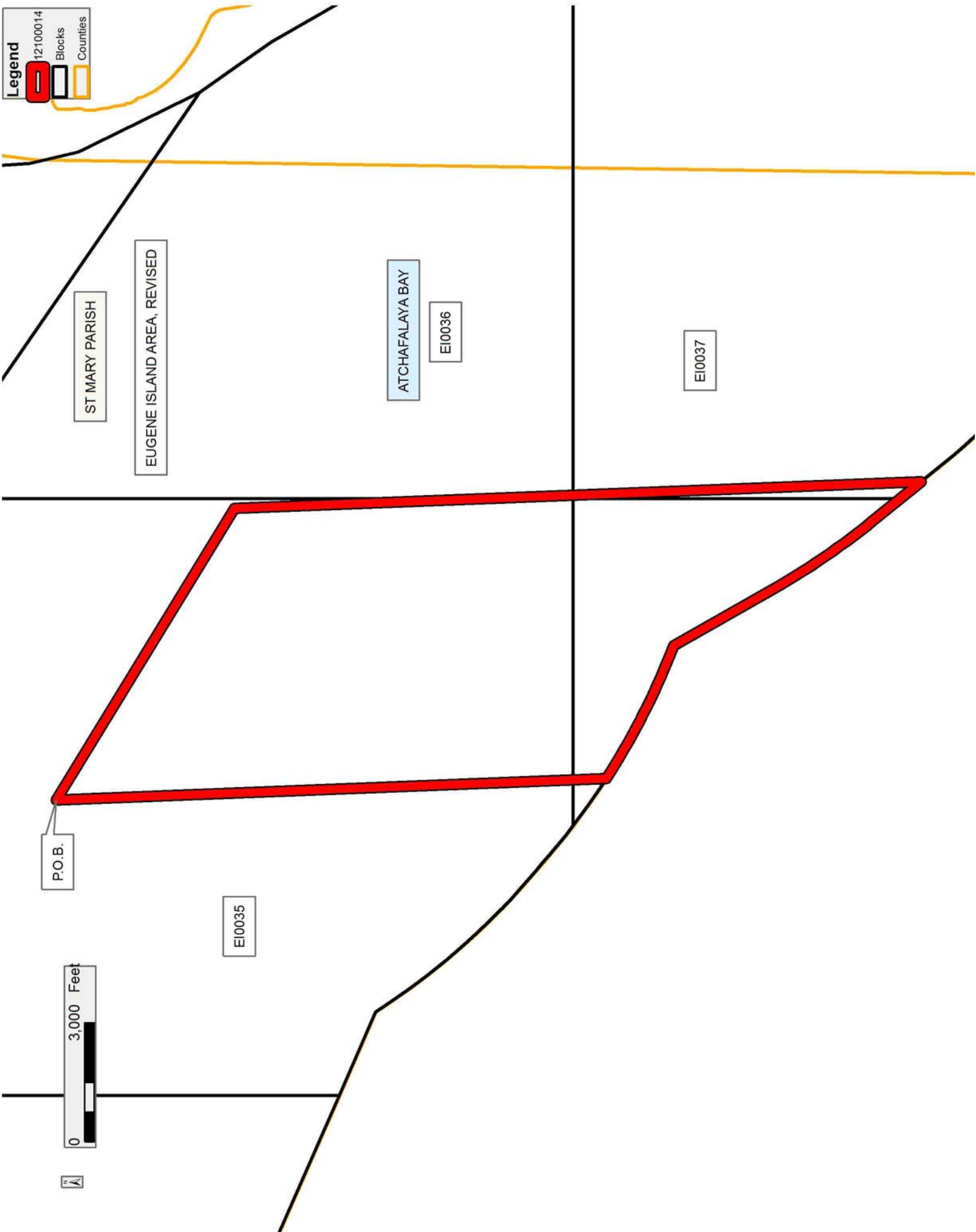

**TRACT 42917 - Portion of Block 39, South Pass Area, Plaquemines Parish, Louisiana**

The beds and bottoms of all water bodies belonging to the State of Louisiana located in Block 39, South Pass Area, together with any present lands formed by accretion to the shoreline or islands formed therein, located in Plaquemines Parish, Louisiana, owned by and not presently under mineral lease as of October 10, 2012, from the State of Louisiana, the geographical area of which is more fully described as follows: Beginning at a point on the North line of Block 39, South Pass Area having Coordinates of X = 2,638,065.00 and Y = 111,666.00; thence East 7,379.00 feet along the North line of said Block 39 to its Northeast corner having Coordinates of X = 2,645,444.00 and Y = 111,666.00; thence South 5,574.85 feet along the East line of said Block 39 to a point having Coordinates of X = 2,645,444.00 and Y = 106,091.15; thence South 36 degrees 38 minutes 30 seconds West 11,444.84 feet to a point on the South line of said Block 39 having Coordinates of X = 2,638,613.61 and Y = 96,908.00; thence West 548.61 feet along the South line of said Block 39 to a point having Coordinates of X = 2,638,065.00 and Y = 96,908.00; thence North 14,758.00 feet to the point of beginning, containing **1,780.01 acres, LESS AND EXCEPT** that portion thereof, if any, lying seaward of the line three nautical miles from the coast line of Louisiana, as said three mile line has been decreed by the Supreme Court of the United States, as determined by a Special Master appointed therein, in litigation styled **United States v. State of Louisiana et al No. 9 Original**, in 1975, all as more particularly outlined on a plat in the Office of Mineral Resources, Department of Natural Resources. All bearings, distances and coordinates are based on the Louisiana Coordinate System of 1927, (South Zone).

NOTE: The above description of the Tract nominated for lease has been provided and corrected, where required, exclusively by the nomination party. Any mineral lease selected from this Tract and awarded by the Louisiana State Mineral and Energy Board shall be without warranty of any kind, either express, implied, or statutory, including, but not limited to, the implied warranties of merchantability and fitness for a particular purpose. Should the mineral lease awarded by the Louisiana State Mineral and Energy Board be subsequently modified, cancelled or abrogated due to the existence of conflicting leases, operating agreements, private claims or other future obligations or conditions which may affect all or any portion of the leased Tract, it shall not relieve the Lessee of the obligation to pay any bonus due thereon to the Louisiana State Mineral and Energy Board, nor shall the Louisiana State Mineral and Energy Board be obligated to refund any consideration paid by the Lessor prior to such modification, cancellation, or abrogation, including, but not limited to, bonuses, rentals and royalties.

NOTE: The State of Louisiana does hereby reserve, and this lease shall be subject to, the imprescriptible right of surface use in the nature of a servitude in favor of the Department of Natural Resources, including its Offices and Commissions, for the sole purpose of implementing,



constructing, servicing and maintaining approved coastal zone management and/or restoration projects. Utilization of any and all rights derived under this lease by the mineral lessee, its agents, successors or assigns, shall not interfere with nor hinder the reasonable surface use by the Department of Natural Resources, its Offices or Commissions, as herein above reserved.

NOTE: It appears, according to our records, that a portion of this Tract is located within the restrictive safety fairway area as set out by the Corps of Engineers, U.S. Army and/or the restrictive anchorage area as set out by the U.S. Coast Guard.

Applicant: HAROLD J. ANDERSON, INC.

Bidder	Cash Payment	Price/Acre	Rental	Oil	Gas	Other

**Legend**

12100054  
Blocks

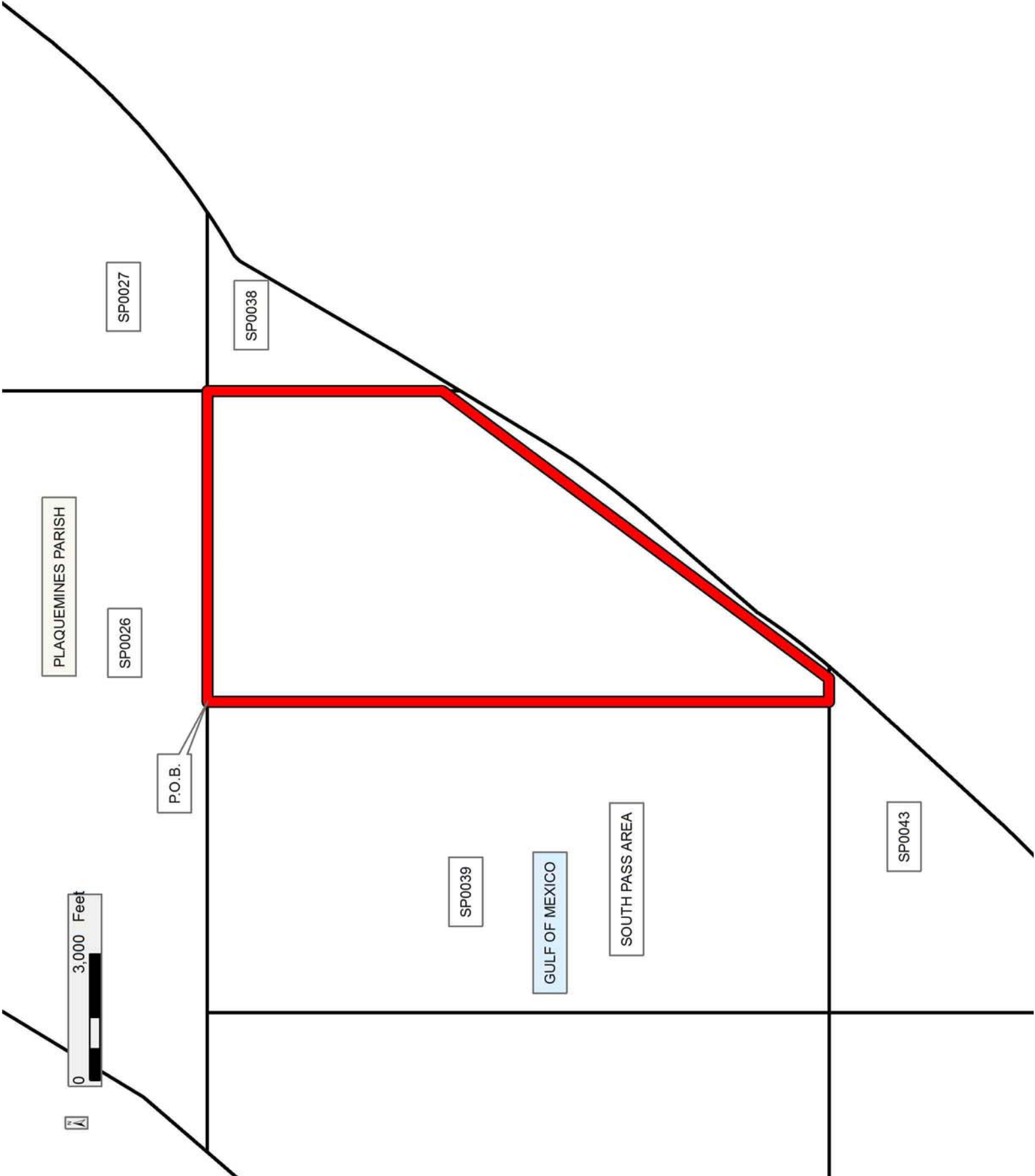

**TRACT 42918 - Portion of Block 39, South Pass Area, Plaquemines Parish, Louisiana**

The beds and bottoms of all water bodies belonging to the State of Louisiana located in Block 39, South Pass Area, together with any present lands formed by accretion to the shoreline or islands formed therein, located in Plaquemines Parish, Louisiana, owned by and not presently under mineral lease as of October 10, 2012, from the State of Louisiana, the geographical area of which is more fully described as follows: Beginning at the Northwest corner of Block 39, South Pass Area having Coordinates of X = 2,630,686.00 and Y = 111,666.00; thence East 7,379.00 feet along the North line of said Block 39 to a point having Coordinates of X = 2,638,065.00 and Y = 111,666.00; thence South 14,758.00 feet to a point on the South line of said Block 39 having Coordinates of X = 2,638,065.00 and Y = 96,908.00; thence West 7,379.00 feet along the South line of said Block 39 to its Southwest corner having Coordinates of X = 2,630,686.00 and Y = 96,908.00; thence North 14,757.98 feet along the West line of said Block 39 to the point of beginning, containing **2,499.98 acres**, all as more particularly outlined on a plat on file in the Office of Mineral Resources, Department of Natural Resources. All bearings, distances and coordinates are based on Louisiana Coordinate System of 1927, (North or South Zone).

NOTE: The above description of the Tract nominated for lease has been provided and corrected, where required, exclusively by the nomination party. Any mineral lease selected from this Tract and awarded by the Louisiana State Mineral and Energy Board shall be without warranty of any kind, either express, implied, or statutory, including, but not limited to, the implied warranties of merchantability and fitness for a particular purpose. Should the mineral lease awarded by the Louisiana State Mineral and Energy Board be subsequently modified, cancelled or abrogated due to the existence of conflicting leases, operating agreements, private claims or other future obligations or conditions which may affect all or any portion of the leased Tract, it shall not relieve the Lessee of the obligation to pay any bonus due thereon to the Louisiana State Mineral and Energy Board, nor shall the Louisiana State Mineral and Energy Board be obligated to refund any consideration paid by the Lessor prior to such modification, cancellation, or abrogation, including, but not limited to, bonuses, rentals and royalties.

NOTE: The State of Louisiana does hereby reserve, and this lease shall be subject to, the imprescriptible right of surface use in the nature of a servitude in favor of the Department of Natural Resources, including its Offices and Commissions, for the sole purpose of implementing, constructing, servicing and maintaining approved coastal zone management and/or restoration projects. Utilization of any and all rights derived under this lease by the mineral lessee, its agents, successors or assigns, shall not interfere with nor hinder the reasonable surface use by the Department of Natural Resources, its Offices or Commissions, as herein above reserved.

NOTE: It appears, according to our records, that a portion of this Tract is located within the restrictive safety fairway area as set out by the Corps of Engineers, U.S. Army and/or the restrictive anchorage area as set out by the U.S. Coast Guard.

Applicant: HAROLD J. ANDERSON, INC.

Bidder	Cash Payment	Price/Acre	Rental	Oil	Gas	Other

Legend  
12100053  
Blocks

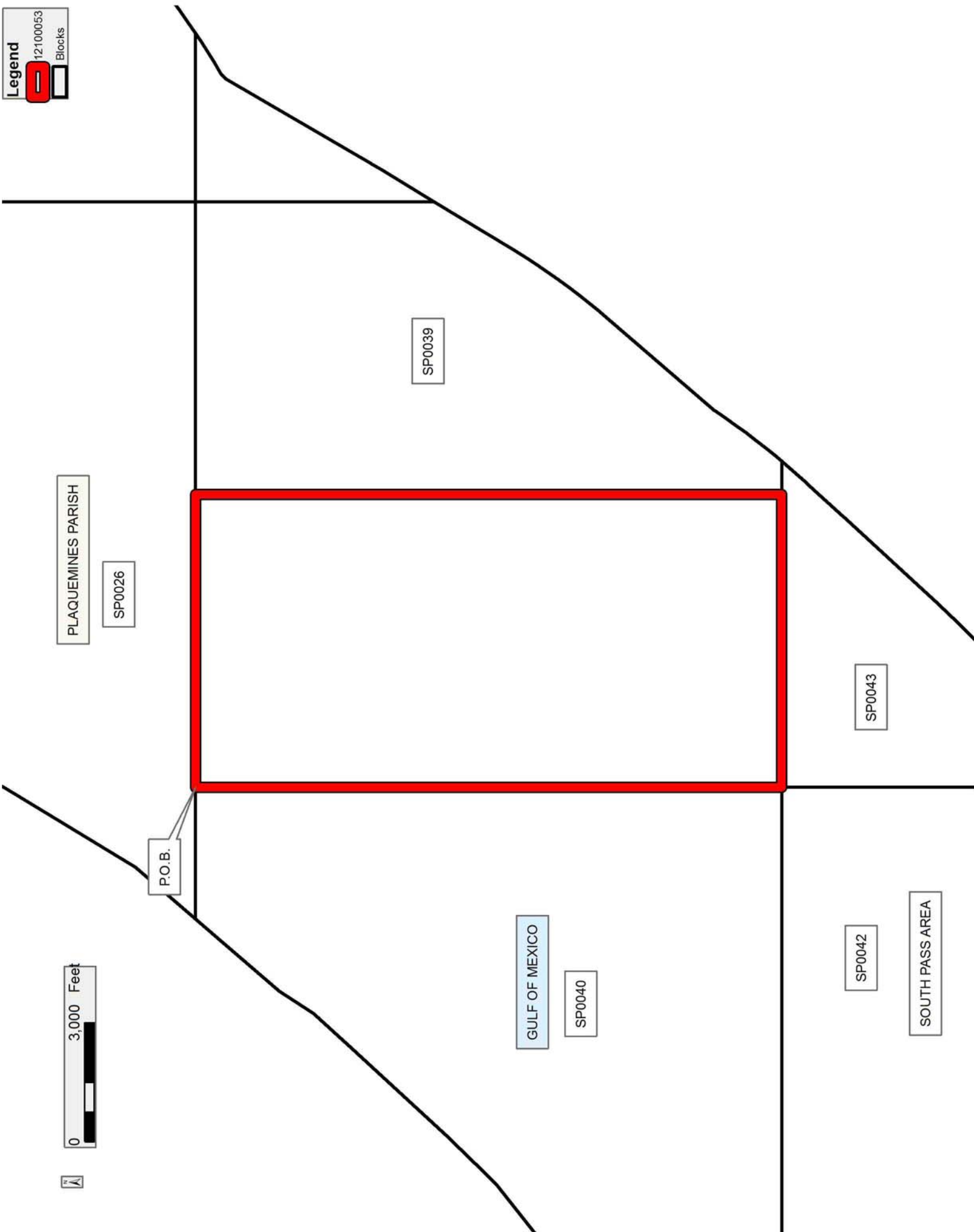

**TRACT 42919 - Portion of Blocks 40, and 42, South Pass Area, Plaquemines Parish, Louisiana**

The beds and bottoms of all water bodies belonging to the State of Louisiana located in Blocks 40, and 42, South Pass Area, together with any present lands formed by accretion to the shoreline or islands formed therein, located in Plaquemines Parish, Louisiana, owned by and not presently under mineral lease as of October 10, 2012, from the State of Louisiana, the geographical area of which is more fully described as follows: Beginning at a point on the East line of Block 40, South Pass Area having Coordinates of X = 2,630,686.00 and Y = 104,287.00; thence South 7,379.00 feet along the East line of said Block 40 to its Southeast corner, and the Northeast corner of Block 42, South Pass Area having Coordinates of X = 2,630,686.00 and Y = 96,908.00; thence South 7,378.99 feet along the East line of said Block 42 to a point having Coordinates of X = 2,630,686.00 and Y = 89,529.01; thence West 7,379.00 a point having Coordinates of X = 2,623,307.00 and Y = 89,529.01; thence North 7,378.99 a point on the common Block lines between said Blocks 40 and 42 having Coordinates of X = 2,623,307.00 and Y = 96,908.00; thence North approximately 6,693 feet a point on the boundary of State Lease No. 2552, as amended having a Coordinate of X = 2,623,307.00; thence Northeasterly along the boundary of said State Lease No. 2552 to the point of intersection with an East West line having a Coordinate of Y = 104,287.00; thence East approximately 5,926 feet to the point of beginning, containing **2,489 acres**, all as more particularly outlined on a plat on file in the Office of Mineral Resources, Department of Natural Resources. All bearings, distances and coordinates are based on Louisiana Coordinate System of 1927, (North or South Zone).

NOTE: The above description of the Tract nominated for lease has been provided and corrected, where required, exclusively by the nomination party. Any mineral lease selected from this Tract and awarded by the Louisiana State Mineral and Energy Board shall be without warranty of any kind, either express, implied, or statutory, including, but not limited to, the implied warranties of merchantability and fitness for a particular purpose. Should the mineral lease awarded by the Louisiana State Mineral and Energy Board be subsequently modified, cancelled or abrogated due to the existence of conflicting leases, operating agreements, private claims or other future obligations or conditions which may affect all or any portion of the leased Tract, it shall not relieve the Lessee of the obligation to pay any bonus due thereon to the Louisiana State Mineral and Energy Board, nor shall the Louisiana State Mineral and Energy Board be obligated to refund any consideration paid by the Lessor prior to such modification, cancellation, or abrogation, including, but not limited to, bonuses, rentals and royalties.

NOTE: The State of Louisiana does hereby reserve, and this lease shall be subject to, the imprescriptible right of surface use in the nature of a servitude in favor of the Department of Natural Resources, including its Offices and Commissions, for the sole purpose of implementing,

constructing, servicing and maintaining approved coastal zone management and/or restoration projects. Utilization of any and all rights derived under this lease by the mineral lessee, its agents, successors or assigns, shall not interfere with nor hinder the reasonable surface use by the Department of Natural Resources, its Offices or Commissions, as herein above reserved.

NOTE: It appears, according to our records, that a portion of this Tract is located within the restrictive safety fairway area as set out by the Corps of Engineers, U.S. Army and/or the restrictive anchorage area as set out by the U.S. Coast Guard.

Applicant: HAROLD J. ANDERSON, INC.

Bidder	Cash Payment	Price/Acre	Rental	Oil	Gas	Other

**Legend**

- 12100044
- Blocks
- Active\_Leases

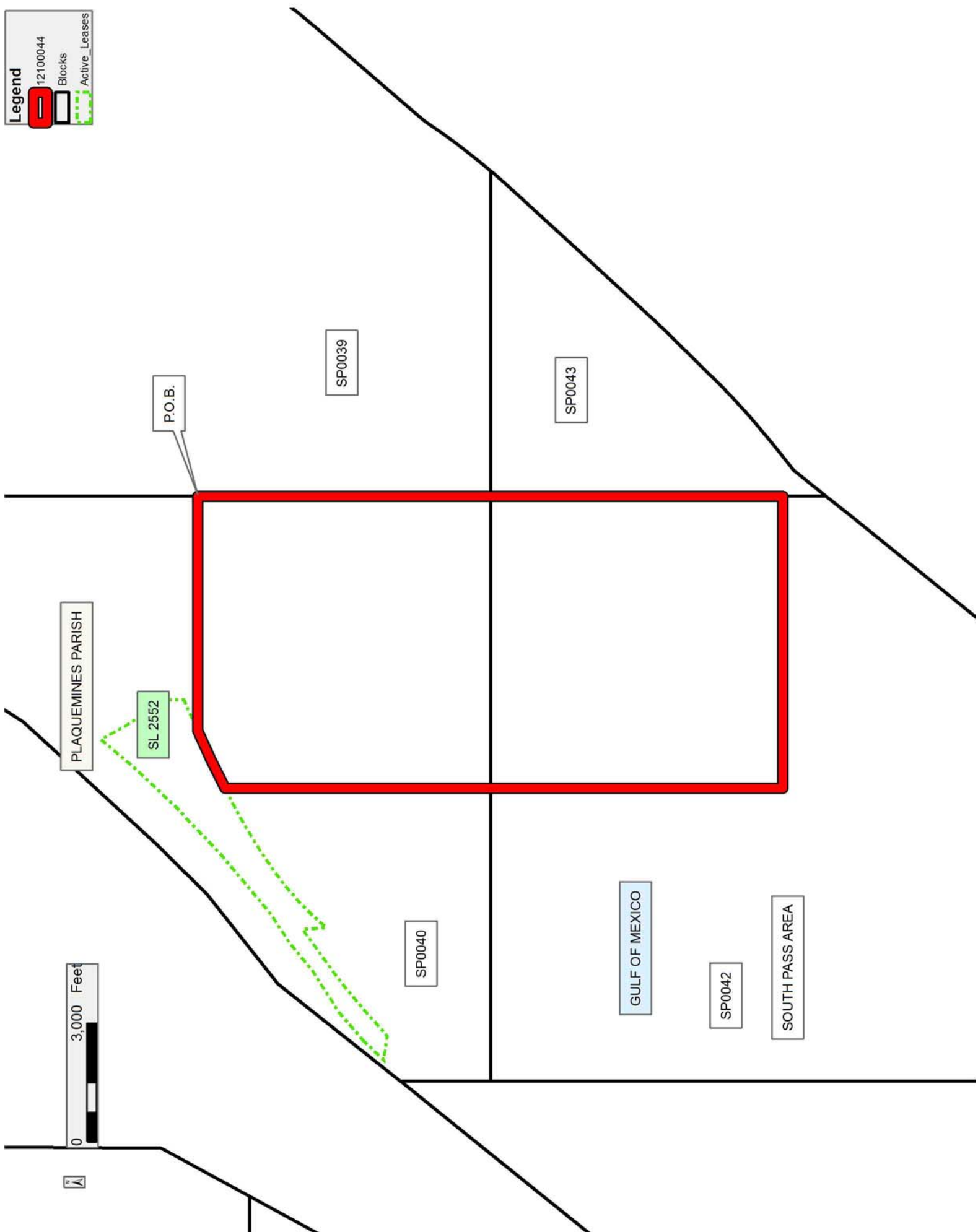



**TRACT 42920 - Portion of Blocks 40, 41, and 42, South Pass Area, Plaquemines Parish, Louisiana**

The beds and bottoms of all water bodies belonging to the State of Louisiana located in Blocks 40, 41, and 42, South Pass Area, together with any present lands formed by accretion to the shoreline or islands formed therein, located in Plaquemines Parish, Louisiana, owned by and not presently under mineral lease as of October 10, 2012, from the State of Louisiana, the geographical area of which is more fully described as follows: Beginning at a point within Block 42 South Pass Area having Coordinates of X = 2,623,307.00 and Y = 89,529.01; thence West 7,379.00 feet to a point on the West line of said Block 42 having Coordinates of X = 2,615,928.00 and Y = 89,529.01; thence West 3,776.84 feet to a point having Coordinates of X = 2,612,151.16 and Y = 89,529.01; thence North 4,982.31 feet to a point on the boundary of State Lease No. 17381 having Coordinates of X = 2,612,151.16 and Y = 94,511.32; thence Northeasterly on a straight line along the boundary of said State Lease No. 17381 to its Easternmost corner and a point on the boundary of State Lease No. 17193 having Coordinates of X = 2,612,822.55 and Y = 95,342.10; thence along the boundary of said State Lease No. 17193 the following courses and distances: East 3,105.45 feet and North 3,842.91 feet to its Northeast corner and a point on the boundary of State Lease No. 2566, as amended having Coordinates of X = 2,615,928.00 and Y = 99,185.01; thence Northeasterly along the boundary of said State Lease No. 2566 to a point on the boundary of State Lease No. 2522, as amended; thence Northeasterly along the boundary of said State Lease No. 2522 to the point of intersection with a North-South line having a Coordinate of X = 2,623,307.00; thence South approximately 14,072 feet to the point of beginning, containing **2,500 acres**, all as more particularly outlined on a plat on file in the Office of Mineral Resources, Department of Natural Resources. All bearings, distances and coordinates are based on Louisiana Coordinate System of 1927, (North or South Zone).

NOTE: The above description of the Tract nominated for lease has been provided and corrected, where required, exclusively by the nomination party. Any mineral lease selected from this Tract and awarded by the Louisiana State Mineral and Energy Board shall be without warranty of any kind, either express, implied, or statutory, including, but not limited to, the implied warranties of merchantability and fitness for a particular purpose. Should the mineral lease awarded by the Louisiana State Mineral and Energy Board be subsequently modified, cancelled or abrogated due to the existence of conflicting leases, operating agreements, private claims or other future obligations or conditions which may affect all or any portion of the leased Tract, it shall not relieve the Lessee of the obligation to pay any bonus due thereon to the Louisiana State Mineral and Energy Board, nor shall the Louisiana State Mineral and Energy Board be obligated to refund any consideration paid by the Lessor prior to such modification, cancellation, or abrogation, including, but not limited to, bonuses, rentals and royalties.

NOTE: The State of Louisiana does hereby reserve, and this lease shall be subject to, the imprescriptible right of surface use in the nature of a servitude in favor of the Department of Natural Resources, including its Offices and Commissions, for the sole purpose of implementing, constructing, servicing and maintaining approved coastal zone management and/or restoration projects. Utilization of any and all rights derived under this lease by the mineral lessee, its agents, successors or assigns, shall not interfere with nor hinder the reasonable surface use by the Department of Natural Resources, its Offices or Commissions, as herein above reserved.

NOTE: It appears, according to our records, that a portion of this Tract is located within the restrictive safety fairway area as set out by the Corps of Engineers, U.S. Army and/or the restrictive anchorage area as set out by the U.S. Coast Guard.

Applicant: HAROLD J. ANDERSON, INC.

Bidder	Cash Payment	Price/Acre	Rental	Oil	Gas	Other

Legend

12100042

Blocks

Active\_Leases

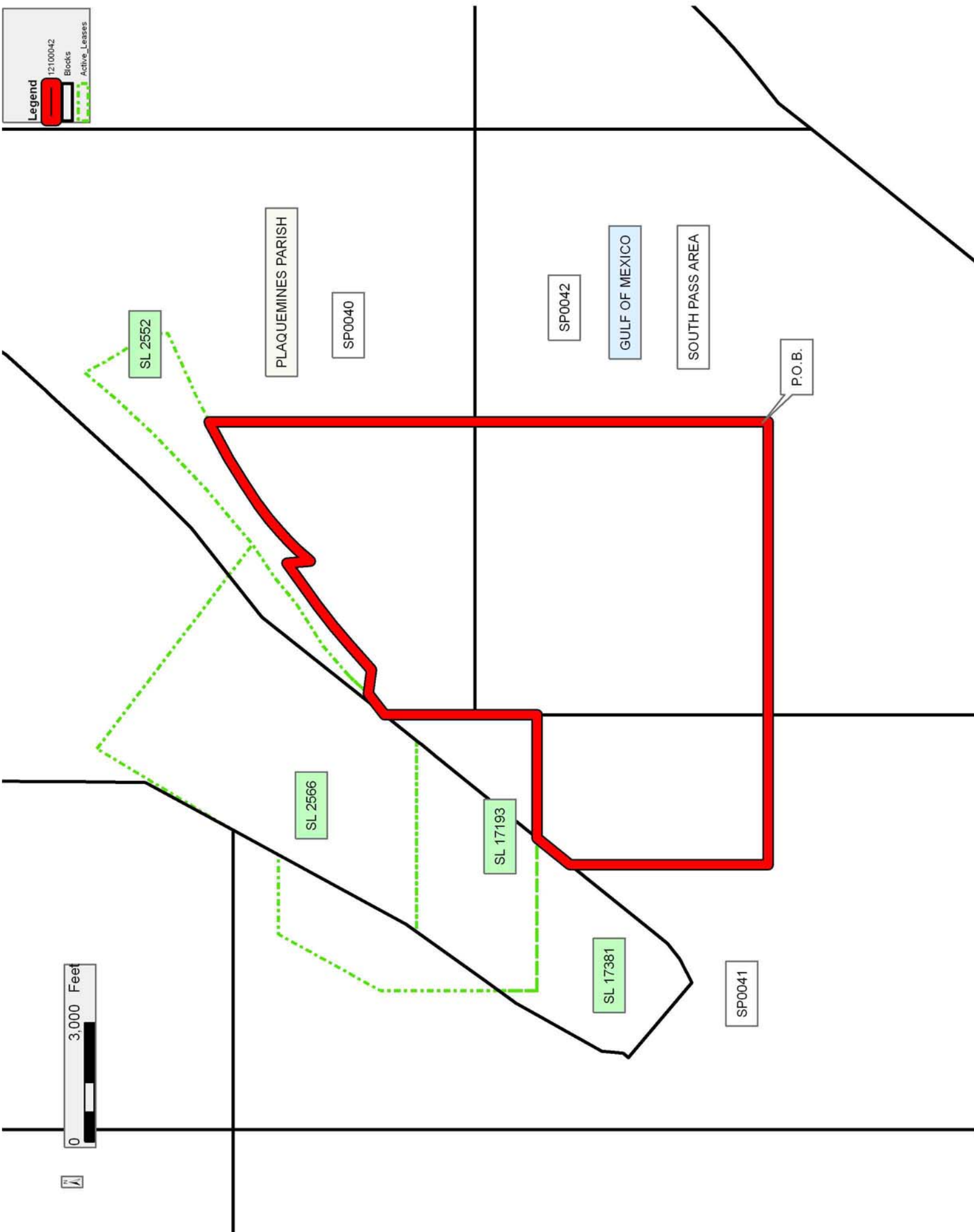

**TRACT 42921 - Portion of Block 41, South Pass Area, Plaquemines Parish, Louisiana**

The beds and bottoms of all water bodies belonging to the State of Louisiana located in Block 41, South Pass Area, together with any present lands formed by accretion to the shoreline or islands formed therein, located in Plaquemines Parish, Louisiana, owned by and not presently under mineral lease as of October 10, 2012, from the State of Louisiana, the geographical area of which is more fully described as follows: Beginning at the Northwest corner of Block 41, South Pass Area having Coordinates of X = 2,605,477.93 and Y = 102,992.10; thence East approximately 7,552 feet along the North line of said Block 41 to a point on the boundary of State Lease No. 2566 having a Coordinate of Y = 102,992.10; thence Southwesterly along the boundary of said State Lease No. 2566 to the Northernmost Northeast corner of State Lease No. 17193 having Coordinates of X = 2,612,391.72 and Y = 101,850.29; thence along the boundary of said State Lease No. 17193 the following courses and distances: West 1,994.30 feet, South 29 degrees 01 minutes 30 seconds West 2,925.63 feet and South 2,985.42 a point on the boundary of State Lease No. 17381 having Coordinates of X = 2,608,977.93 and Y = 96,306.68; thence along the boundary of said State Lease No. 17381 the following courses and distances: Southwesterly on a straight line to a point having Coordinates of X = 2,608,665.00 and Y = 95,870.00, Southwesterly on a straight line to a point having Coordinates of X = 2,607,455.00 and Y = 93,710.00, Southwesterly on a straight line to a point having Coordinates of X = 2,607,400.00 and Y = 93,175.00, Southwesterly on a straight line to a point having Coordinates of X = 2,607,290.00 and Y = 93,040.00, Southeasterly on a straight line to a point having Coordinates of X = 2,609,180.00 and Y = 91,445.00, Northeasterly on a straight line to a point having Coordinates of X = 2,609,785.00 and Y = 91,750.00, Northeasterly on a straight line to a point having Coordinates of X = 2,610,160.00 and Y = 92,050.00 and Northeasterly on a straight line to a point having Coordinates of X = 2,612,151.16 and Y = 94,511.32; thence South 4,982.31 a point having Coordinates of X = 2,612,151.16 and Y = 89,529.01; thence West 6,673.23 to a point on the West line of said Block 41 having Coordinates of X = 2,605,477.93 and Y = 89,529.01; thence North 13,463.09 feet along the West line of said Block 41 to the point of beginning, containing **1,352 acres**, all as more particularly outlined on a plat on file in the Office of Mineral Resources, Department of Natural Resources. All bearings, distances and coordinates are based on Louisiana Coordinate System of 1927, (North or South Zone).

NOTE: The above description of the Tract nominated for lease has been provided and corrected, where required, exclusively by the nomination party. Any mineral lease selected from this Tract and awarded by the Louisiana State Mineral and Energy Board shall be without warranty of any kind, either express, implied, or statutory, including, but not limited to, the implied warranties of merchantability and fitness for a particular purpose. Should the mineral lease awarded by the Louisiana State Mineral and Energy Board be subsequently modified, cancelled or abrogated due to

the existence of conflicting leases, operating agreements, private claims or other future obligations or conditions which may affect all or any portion of the leased Tract, it shall not relieve the Lessee of the obligation to pay any bonus due thereon to the Louisiana State Mineral and Energy Board, nor shall the Louisiana State Mineral and Energy Board be obligated to refund any consideration paid by the Lessor prior to such modification, cancellation, or abrogation, including, but not limited to, bonuses, rentals and royalties.

NOTE: The State of Louisiana does hereby reserve, and this lease shall be subject to, the imprescriptible right of surface use in the nature of a servitude in favor of the Department of Natural Resources, including its Offices and Commissions, for the sole purpose of implementing, constructing, servicing and maintaining approved coastal zone management and/or restoration projects. Utilization of any and all rights derived under this lease by the mineral lessee, its agents, successors or assigns, shall not interfere with nor hinder the reasonable surface use by the Department of Natural Resources, its Offices or Commissions, as herein above reserved.

NOTE: It appears, according to our records, that a portion of this Tract is located within the restrictive safety fairway area as set out by the Corps of Engineers, U.S. Army and/or the restrictive anchorage area as set out by the U.S. Coast Guard.

Applicant: HAROLD J. ANDERSON, INC.

Bidder	Cash Payment	Price/Acre	Rental	Oil	Gas	Other

**Legend**

- 12:100048
- Blocks
- Active\_Leases

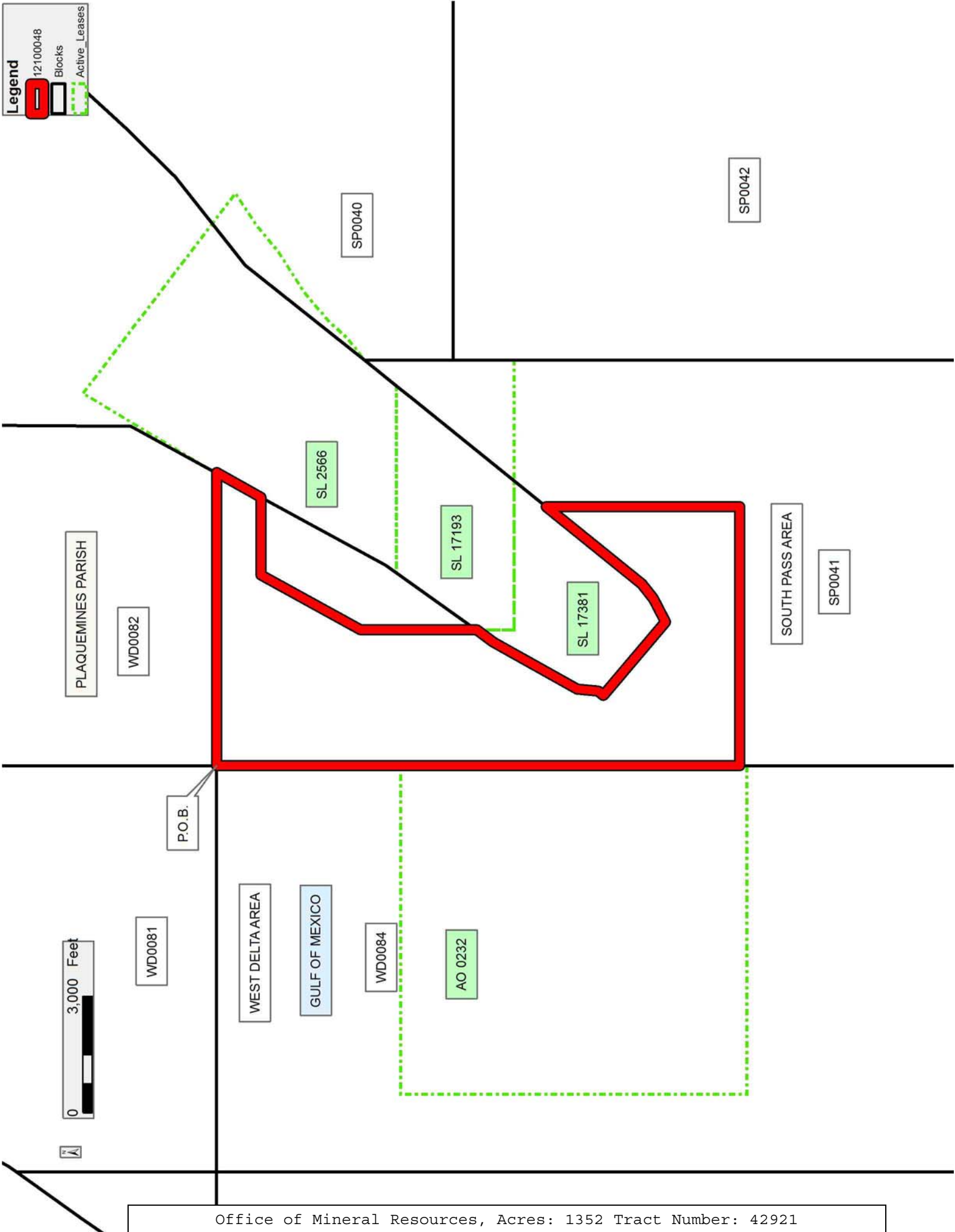

**TRACT 42922 - Portion of Block 84, West Delta Area, Plaquemines Parish, Louisiana**

The beds and bottoms of all water bodies belonging to the State of Louisiana located in Block 84, West Delta Area, together with any present lands formed by accretion to the shoreline or islands formed therein, located in Plaquemines Parish, Louisiana, owned by and not presently under mineral lease as of October 10, 2012, from the State of Louisiana, the geographical area of which is more fully described as follows: Beginning at the Northwest corner of Block 84, West Delta Area having Coordinates of X = 2,595,027.93 and Y = 102,992.10; thence East 10,450.00 feet along the North line of said Block 84 to its Northeast corner having Coordinates of X = 2,605,477.93 and Y = 102,992.10; thence South 4,734.74 feet along the East line of said Block 84 to the Northeast corner of Operating Agreement A0232 having Coordinates of X = 2,605,477.93 and Y = 98,257.36; thence along the boundary of said Operating Agreement A0232 the following courses and distances: West 8,450.00 feet and South 5,686.31 feet to a point having Coordinates of X = 2,597,027.93 and Y = 92,571.05; thence West 2,000.00 feet to a point on the West line of said Block 84 having Coordinates of X = 2,595,027.93 and Y = 92,571.05; thence North 10,421.05 feet along the West line of said Block 84 to the point of beginning, containing **1,396.94 acres**, all as more particularly outlined on a plat on file in the Office of Mineral Resources, Department of Natural Resources. All bearings, distances and coordinates are based on Louisiana Coordinate System of 1927, (North or South Zone).

NOTE: The above description of the Tract nominated for lease has been provided and corrected, where required, exclusively by the nomination party. Any mineral lease selected from this Tract and awarded by the Louisiana State Mineral and Energy Board shall be without warranty of any kind, either express, implied, or statutory, including, but not limited to, the implied warranties of merchantability and fitness for a particular purpose. Should the mineral lease awarded by the Louisiana State Mineral and Energy Board be subsequently modified, cancelled or abrogated due to the existence of conflicting leases, operating agreements, private claims or other future obligations or conditions which may affect all or any portion of the leased Tract, it shall not relieve the Lessee of the obligation to pay any bonus due thereon to the Louisiana State Mineral and Energy Board, nor shall the Louisiana State Mineral and Energy Board be obligated to refund any consideration paid by the Lessor prior to such modification, cancellation, or abrogation, including, but not limited to, bonuses, rentals and royalties.

NOTE: The State of Louisiana does hereby reserve, and this lease shall be subject to, the imprescriptible right of surface use in the nature of a servitude in favor of the Department of Natural Resources, including its Offices and Commissions, for the sole purpose of implementing, constructing, servicing and maintaining approved coastal zone management and/or restoration projects. Utilization of any and all rights derived under this lease by the mineral lessee, its agents, successors or assigns,

shall not interfere with nor hinder the reasonable surface use by the Department of Natural Resources, its Offices or Commissions, as herein above reserved.

Applicant: HAROLD J. ANDERSON, INC.

Bidder	Cash Payment	Price/Acre	Rental	Oil	Gas	Other



**Legend**

- 12100049
- Blocks
- Active\_Leases

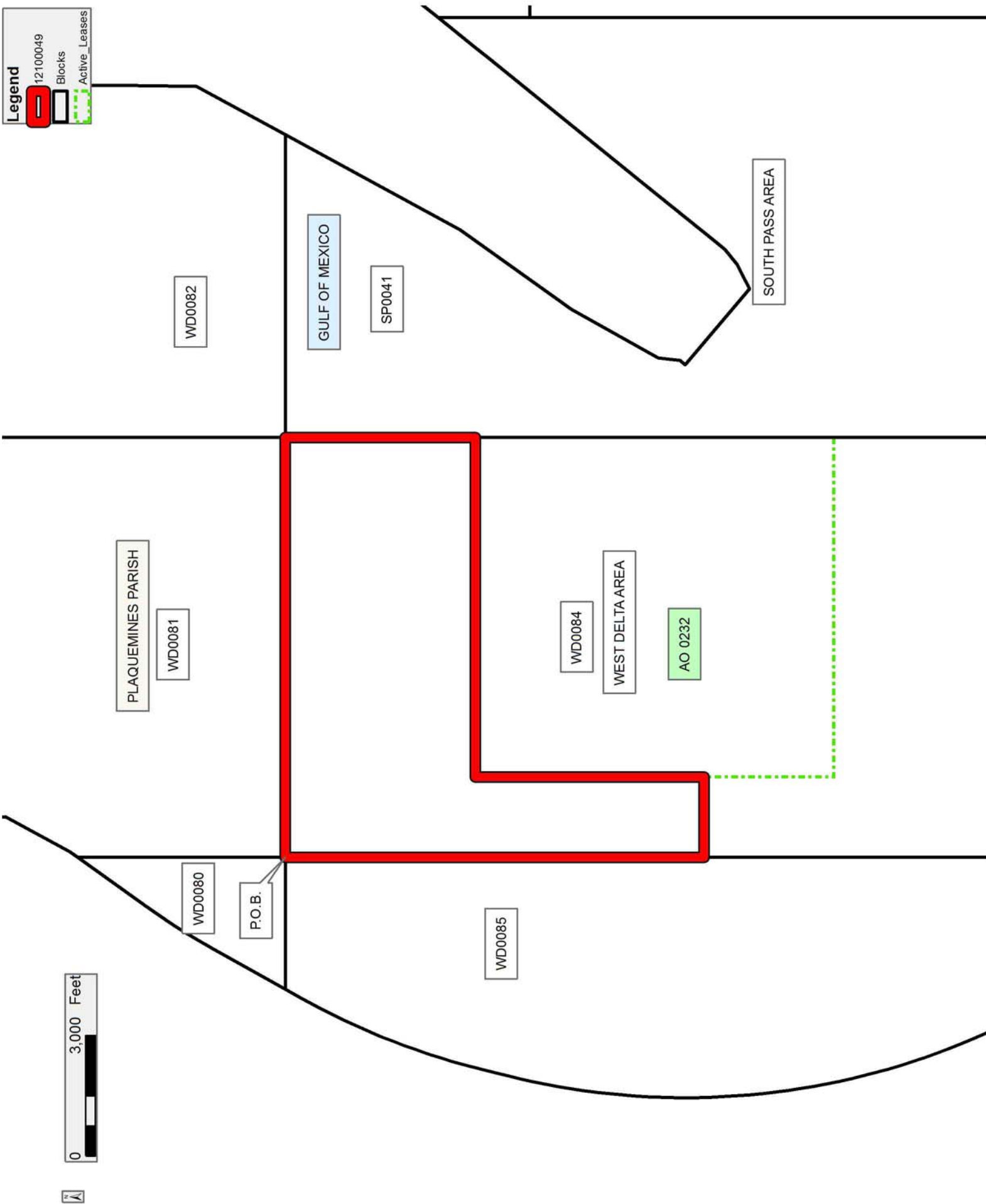

**TRACT 42923 - Portion of Block 85, West Delta Area, Plaquemines Parish, Louisiana**

The beds and bottoms of all water bodies belonging to the State of Louisiana located in Block 85, West Delta Area, together with any present lands formed by accretion to the shoreline or islands formed therein, located in Plaquemines Parish, Louisiana, owned by and not presently under mineral lease as of October 10, 2012, from the State of Louisiana, the geographical area of which is more fully described as follows: Beginning at the Northeast corner of Block 85, West Delta Area having Coordinates of X = 2,595,027.93 and Y = 102,992.10; thence South 15,839.97 feet along the East line of said Block 85 to a point having Coordinates of X = 2,595,027.93 and Y = 87,152.13; thence West 4,637.62 feet to a point having Coordinates of X = 2,590,390.31 and Y = 87,152.13; thence North 05 degrees 53 minutes 18 seconds East 15,923.99 feet to a point having Coordinates of X = 2,592,023.91 and Y = 102,992.10; thence East 3,004.02 feet to the point of beginning, containing **1,389.39 acres, LESS AND EXCEPT** that portion thereof, if any, lying seaward of the line three nautical miles from the coast line of Louisiana, as said three mile line has been decreed by the Supreme Court of the United States, as determined by a Special Master appointed therein, in litigation styled **United States v. State of Louisiana et al No. 9 Original**, in 1975, all as more particularly outlined on a plat in the Office of Mineral Resources, Department of Natural Resources. All bearings, distances and coordinates are based on the Louisiana Coordinate System of 1927, (South Zone).

NOTE: The above description of the Tract nominated for lease has been provided and corrected, where required, exclusively by the nomination party. Any mineral lease selected from this Tract and awarded by the Louisiana State Mineral and Energy Board shall be without warranty of any kind, either express, implied, or statutory, including, but not limited to, the implied warranties of merchantability and fitness for a particular purpose. Should the mineral lease awarded by the Louisiana State Mineral and Energy Board be subsequently modified, cancelled or abrogated due to the existence of conflicting leases, operating agreements, private claims or other future obligations or conditions which may affect all or any portion of the leased Tract, it shall not relieve the Lessee of the obligation to pay any bonus due thereon to the Louisiana State Mineral and Energy Board, nor shall the Louisiana State Mineral and Energy Board be obligated to refund any consideration paid by the Lessor prior to such modification, cancellation, or abrogation, including, but not limited to, bonuses, rentals and royalties.

NOTE: The State of Louisiana does hereby reserve, and this lease shall be subject to, the imprescriptible right of surface use in the nature of a servitude in favor of the Department of Natural Resources, including its Offices and Commissions, for the sole purpose of implementing, constructing, servicing and maintaining approved coastal zone management and/or restoration projects. Utilization of any and all rights derived under this lease by the mineral lessee, its agents, successors or assigns,

shall not interfere with nor hinder the reasonable surface use by the Department of Natural Resources, its Offices or Commissions, as herein above reserved.

Applicant: HAROLD J. ANDERSON, INC.

Bidder	Cash Payment	Price/Acre	Rental	Oil	Gas	Other

Legend  
12100051  
Blocks



**TRACT 42924 - Portion of Block 43, South Pass Area, Plaquemines Parish, Louisiana**

The beds and bottoms of all water bodies belonging to the State of Louisiana located in Block 43, South Pass Area, together with any present lands formed by accretion to the shoreline or islands formed therein, located in Plaquemines Parish, Louisiana, owned by and not presently under mineral lease as of October 10, 2012, from the State of Louisiana, the geographical area of which is more fully described as follows: Beginning at the Northwest corner of Block 43, South Pass Area having Coordinates of X = 2,630,686.00 and Y = 96,908.00; thence East 7,927.61 feet along the North line of said Block 43 to a point having Coordinates of X = 2,638,613.61 and Y = 96,908.00; thence South 44 degrees 28 minutes 05 seconds West 11,316.88 feet to a point on the West line of said Block 43 having Coordinates of X = 2,630,686.00 and Y = 88,831.82; thence North 8,076.18 feet along the West line of said Block 43 to the point of beginning, containing **734.90 acres, LESS AND EXCEPT** that portion thereof, if any, lying seaward of the line three nautical miles from the coast line of Louisiana, as said three mile line has been decreed by the Supreme Court of the United States, as determined by a Special Master appointed therein, in litigation styled **United States v. State of Louisiana et al No. 9 Original**, in 1975, all as more particularly outlined on a plat in the Office of Mineral Resources, Department of Natural Resources. All bearings, distances and coordinates are based on the Louisiana Coordinate System of 1927, (South Zone).

NOTE: The above description of the Tract nominated for lease has been provided and corrected, where required, exclusively by the nomination party. Any mineral lease selected from this Tract and awarded by the Louisiana State Mineral and Energy Board shall be without warranty of any kind, either express, implied, or statutory, including, but not limited to, the implied warranties of merchantability and fitness for a particular purpose. Should the mineral lease awarded by the Louisiana State Mineral and Energy Board be subsequently modified, cancelled or abrogated due to the existence of conflicting leases, operating agreements, private claims or other future obligations or conditions which may affect all or any portion of the leased Tract, it shall not relieve the Lessee of the obligation to pay any bonus due thereon to the Louisiana State Mineral and Energy Board, nor shall the Louisiana State Mineral and Energy Board be obligated to refund any consideration paid by the Lessor prior to such modification, cancellation, or abrogation, including, but not limited to, bonuses, rentals and royalties.

NOTE: The State of Louisiana does hereby reserve, and this lease shall be subject to, the imprescriptible right of surface use in the nature of a servitude in favor of the Department of Natural Resources, including its Offices and Commissions, for the sole purpose of implementing, constructing, servicing and maintaining approved coastal zone management and/or restoration projects. Utilization of any and all rights derived under this lease by the mineral lessee, its agents, successors or assigns,

shall not interfere with nor hinder the reasonable surface use by the Department of Natural Resources, its Offices or Commissions, as herein above reserved.

NOTE: It appears, according to our records, that a portion of this Tract is located within the restrictive safety fairway area as set out by the Corps of Engineers, U.S. Army and/or the restrictive anchorage area as set out by the U.S. Coast Guard.

Applicant: HAROLD J. ANDERSON, INC.

Bidder	Cash Payment	Price/Acre	Rental	Oil	Gas	Other

**Legend**

12100055  
Blocks

