

TRACT 42955 - Portion of Block 38, Breton Sound Area, Plaquemines Parish, Louisiana

The beds and bottoms of all water bodies belonging to the State of Louisiana located in Block 38, Breton Sound Area, together with any present lands formed by accretion to the shoreline or islands formed therein, located in Plaquemines Parish, Louisiana, owned by and not presently under mineral lease as of November 14, 2012, from the State of Louisiana, the geographical area of which is more fully described as follows: Beginning at a point on the West line of said Block 38, having Coordinates of X = 2,709,100.00 and Y = 313,486.00; thence North 2,069.59 feet along the West line of said Block 38 to a point on the Louisiana Coastline, as decreed by the Supreme Court of the United States, as determined by a Special Master appointed therein, in litigation styled *United States v. State of Louisiana et al No. 9 Original*, in 1975, having Coordinates of X = 2,709,100.00 and Y = 315,555.59; thence along said Louisiana Coastline the following: Northeasterly on a straight line to a point having Coordinates of X = 2,710,380 and Y = 315,995, Northeasterly on a straight line to a point having Coordinates of X = 2,711,772 and Y = 316,107, Northeasterly on a straight line to a point having Coordinates of X = 2,713,324 and Y = 316,801, Northeasterly on a straight line to a point having Coordinates of X = 2,714,633 and Y = 317,731, Northeasterly on a straight line to a point having Coordinates of X = 2,715,236 and Y = 318,391, Northeasterly on a straight line to a point having Coordinates of X = 2,717,012 and Y = 320,677 and Northeasterly on a straight line to a point of intersection with the North line of said Block 38, having Coordinates of X = 2,718,009.98 and Y = 322,330.00; thence East 5,840.02 feet along the North line of said Block 38 to its Northeast corner having Coordinates of X = 2,723,850.00 and Y = 322,330.00; thence South 8,844.00 feet along the East line of said Block 38 to a point having Coordinates of X = 2,723,850.00 and Y = 313,486.00; thence West 14,750.00 feet to the point of beginning, containing approximately **2,047.88 acres**, all as more particularly outlined on a plat on file in the Office of Mineral Resources, Department of Natural Resources. All bearings, distances and coordinates are based on Louisiana Coordinate System of 1927, (North or South Zone).

NOTE: The above description of the Tract nominated for lease has been provided and corrected, where required, exclusively by the nomination party. Any mineral lease selected from this Tract and awarded by the Louisiana State Mineral and Energy Board shall be without warranty of any kind, either express, implied, or statutory, including, but not limited to, the implied warranties of merchantability and fitness for a particular purpose. Should the mineral lease awarded by the Louisiana State Mineral and Energy Board be subsequently modified, cancelled or abrogated due to the existence of conflicting leases, operating agreements, private claims or other future obligations or conditions which may affect all or any portion of the leased Tract, it shall not relieve the Lessee of the obligation to pay any bonus due thereon to the Louisiana State Mineral and Energy Board, nor shall the Louisiana State Mineral and Energy Board be

obligated to refund any consideration paid by the Lessor prior to such modification, cancellation, or abrogation, including, but not limited to, bonuses, rentals and royalties.

NOTE: The State of Louisiana does hereby reserve, and this lease shall be subject to, the imprescriptible right of surface use in the nature of a servitude in favor of the Department of Natural Resources, including its Offices and Commissions, for the sole purpose of implementing, constructing, servicing and maintaining approved coastal zone management and/or restoration projects. Utilization of any and all rights derived under this lease by the mineral lessee, its agents, successors or assigns, shall not interfere with nor hinder the reasonable surface use by the Department of Natural Resources, its Offices or Commissions, as herein above reserved.

Applicant: MIDNITE ENERGY, INC.

Bidder	Cash Payment	Price/Acre	Rental	Oil	Gas	Other

Legend
12110011
Blocks

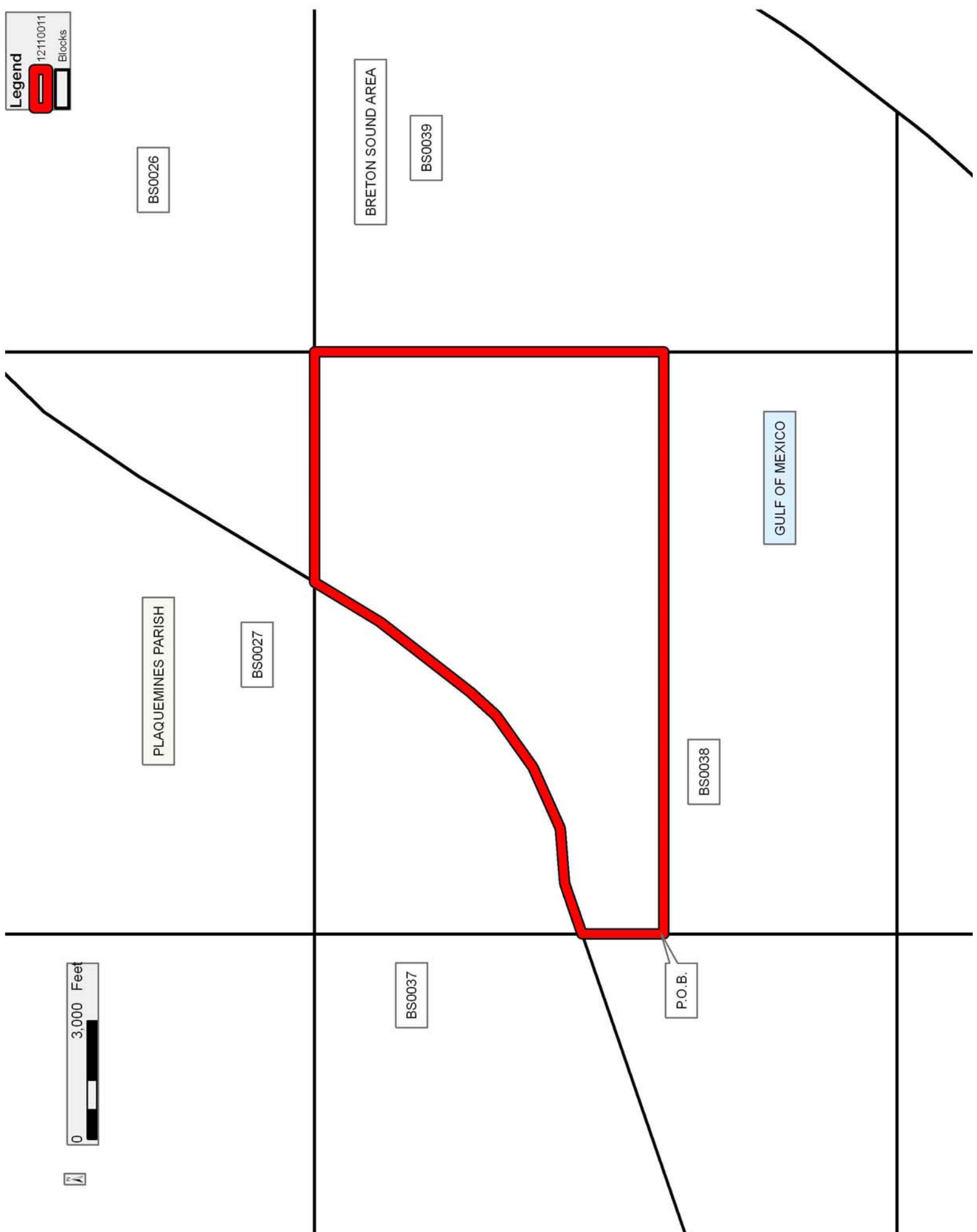

TRACT 42956 - Portion of Blocks 37, and 44, Breton Sound Area, Plaquemines Parish, Louisiana

The beds and bottoms of all water bodies belonging to the State of Louisiana located in Blocks 37, and 44, Breton Sound Area, together with any present lands formed by accretion to the shoreline or islands formed therein, located in Plaquemines Parish, Louisiana, owned by and not presently under mineral lease as of November 14, 2012, from the State of Louisiana, the geographical area of which is more fully described as follows: Beginning at a point having Coordinates of X = 2,701,875.00 and Y = 299,337.00; thence North 13,738.35 feet to a point on the Louisiana Coastline, as decreed by the Supreme Court of the United States, as determined by a Special Master appointed therein, in litigation styled *United States v. State of Louisiana et al No. 9 Original*, in 1975, having Coordinates of X = 2,701,875.00 and Y = 313,075.35; thence Northeasterly along said Louisiana Coastline to a point of intersection with the East line of said Block 37, having Coordinates of X = 2,709,100.00 and Y = 315,555.59; thence South 16,218.59 feet along the East line of Blocks 37 and 44 to a point having Coordinates of X = 2,709,100.00 and Y = 299,337.00; thence West 7,225.00 feet to the point of beginning, containing approximately **2,484.38 acres**, all as more particularly outlined on a plat on file in the Office of Mineral Resources, Department of Natural Resources. All bearings, distances and coordinates are based on Louisiana Coordinate System of 1927, (North or South Zone).

NOTE: The above description of the Tract nominated for lease has been provided and corrected, where required, exclusively by the nomination party. Any mineral lease selected from this Tract and awarded by the Louisiana State Mineral and Energy Board shall be without warranty of any kind, either express, implied, or statutory, including, but not limited to, the implied warranties of merchantability and fitness for a particular purpose. Should the mineral lease awarded by the Louisiana State Mineral and Energy Board be subsequently modified, cancelled or abrogated due to the existence of conflicting leases, operating agreements, private claims or other future obligations or conditions which may affect all or any portion of the leased Tract, it shall not relieve the Lessee of the obligation to pay any bonus due thereon to the Louisiana State Mineral and Energy Board, nor shall the Louisiana State Mineral and Energy Board be obligated to refund any consideration paid by the Lessor prior to such modification, cancellation, or abrogation, including, but not limited to, bonuses, rentals and royalties.

NOTE: The State of Louisiana does hereby reserve, and this lease shall be subject to, the imprescriptible right of surface use in the nature of a servitude in favor of the Department of Natural Resources, including its Offices and Commissions, for the sole purpose of implementing, constructing, servicing and maintaining approved coastal zone management and/or restoration projects. Utilization of any and all rights derived under this lease by the mineral lessee, its agents, successors or assigns, shall not interfere with nor hinder the reasonable surface use by the

Department of Natural Resources, its Offices or Commissions, as herein above reserved.

NOTE: It appears, according to our records, that a portion of this Tract is located within the restrictive safety fairway area as set out by the Corps of Engineers, U.S. Army and/or the restrictive anchorage area as set out by the U.S. Coast Guard.

Applicant: MIDNITE ENERGY, INC.

Bidder	Cash Payment	Price/Acre	Rental	Oil	Gas	Other

Legend
12110014
Blocks

PLAQUEMINES PARISH

BS0038

GULF OF MEXICO

BS0043

BRETON SOUND AREA

BS0037

BS0044

P.O.B.



TRACT 42957 - Portion of Blocks 38, and 43, Breton Sound Area, Plaquemines Parish, Louisiana

The beds and bottoms of all water bodies belonging to the State of Louisiana located in Blocks 38, and 43, Breton Sound Area, together with any present lands formed by accretion to the shoreline or islands formed therein, located in Plaquemines Parish, Louisiana, owned by and not presently under mineral lease as of November 14, 2012, from the State of Louisiana, the geographical area of which is more fully described as follows: Beginning at a point on the West line of said Block 38, having Coordinates of X = 2,709,100.00 and Y = 313,486.00; thence East 14,750.00 feet to a point on the East line of said Block 38, having Coordinates of X = 2,723,850.00 and Y = 313,486.00; thence South 7,383.00 feet along the East line of said Blocks 38 and 43 to a point having Coordinates of X = 2,723,850.00 and Y = 306,103.00; thence West 14,750.00 feet to a point having Coordinates of X = 2,709,100.00 and Y = 306,103.00; thence North 7,383.00 feet to the point of beginning, containing approximately **2,499.98 acres**, all as more particularly outlined on a plat on file in the Office of Mineral Resources, Department of Natural Resources. All bearings, distances and coordinates are based on Louisiana Coordinate System of 1927, (North or South Zone).

NOTE: The above description of the Tract nominated for lease has been provided and corrected, where required, exclusively by the nomination party. Any mineral lease selected from this Tract and awarded by the Louisiana State Mineral and Energy Board shall be without warranty of any kind, either express, implied, or statutory, including, but not limited to, the implied warranties of merchantability and fitness for a particular purpose. Should the mineral lease awarded by the Louisiana State Mineral and Energy Board be subsequently modified, cancelled or abrogated due to the existence of conflicting leases, operating agreements, private claims or other future obligations or conditions which may affect all or any portion of the leased Tract, it shall not relieve the Lessee of the obligation to pay any bonus due thereon to the Louisiana State Mineral and Energy Board, nor shall the Louisiana State Mineral and Energy Board be obligated to refund any consideration paid by the Lessor prior to such modification, cancellation, or abrogation, including, but not limited to, bonuses, rentals and royalties.

NOTE: The State of Louisiana does hereby reserve, and this lease shall be subject to, the imprescriptible right of surface use in the nature of a servitude in favor of the Department of Natural Resources, including its Offices and Commissions, for the sole purpose of implementing, constructing, servicing and maintaining approved coastal zone management and/or restoration projects. Utilization of any and all rights derived under this lease by the mineral lessee, its agents, successors or assigns, shall not interfere with nor hinder the reasonable surface use by the Department of Natural Resources, its Offices or Commissions, as herein above reserved.

NOTE: It appears, according to our records, that a portion of this Tract is located within the restrictive safety fairway area as set out by the Corps of Engineers, U.S. Army and/or the restrictive anchorage area as set out by the U.S. Coast Guard.

Applicant: MIDNITE ENERGY, INC.

Bidder	Cash Payment	Price/Acre	Rental	Oil	Gas	Other

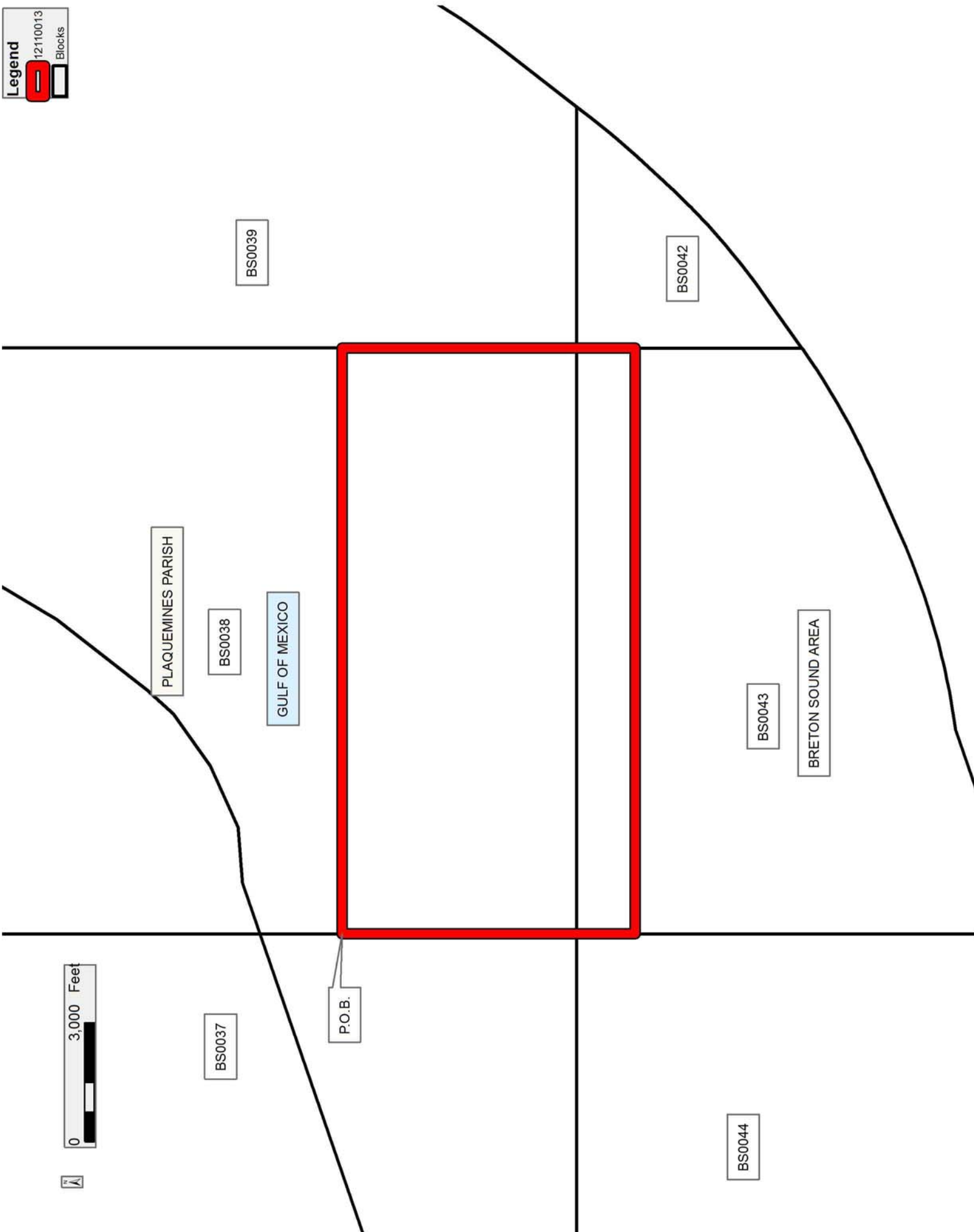

TRACT 42958 - Portion of Blocks 37, 44, and 45, Breton Sound Area, Plaquemines Parish, Louisiana

The beds and bottoms of all water bodies belonging to the State of Louisiana located in Blocks 37, 44, and 45, Breton Sound Area, together with any present lands formed by accretion to the shoreline or islands formed therein, located in Plaquemines Parish, Louisiana, owned by and not presently under mineral lease as of November 14, 2012, from the State of Louisiana, the geographical area of which is more fully described as follows: Beginning at a point on the East line of State Lease No. 19052, having Coordinates of X = 2,694,350.00 and Y = 299,337.00; thence North 1,493.00 feet along the East line of said State Lease No. 19052 to its Northeast corner, also being the Easternmost Southeast corner of State Lease No. 19391, having Coordinates of X = 2,694,350.00 and Y = 300,830.00; thence along the boundary of said State Lease No. 19391 as follows: North 3,800.00 feet to a point having Coordinates of X = 2,694,350.00 and Y = 304,630.00 and West 2,000.00 feet to the Northermost Northwest corner of said State Lease No. 19391, also being the Northeast corner of State Lease No. 2001, as amended, also being the Southeast corner of State Lease No. 1237, as amended, having Coordinates of X = 2,692,350.00 and Y = 304,630.00; thence North 2,950.00 feet along the East line of said State Lease No. 1237, as amended to its Northeast corner, also being a point on the South line of State Lease No. 1230, having Coordinates of X = 2,692,350.00 and Y = 307,580.00; thence along the boundary of said State Lease No. 1230 as follows: East 2000.00 feet to a point having Coordinates of X = 2,694,350.00 and Y = 307,580.00 and North 2,912.12 feet to a point on the Louisiana Coastline, as decreed by the Supreme Court of the United States, as determined by a Special Master appointed therein, in litigation styled *United States v. State of Louisiana et al No. 9 Original*, in 1975, having Coordinates of X = 2,694,350.00 and Y = 310,492.12; thence Northeasterly along said Louisiana Coastline to a point having Coordinates of X = 2,701,875.00 and Y = 313,075.35; thence South 13,738.35 feet to a point having Coordinates of X = 2,701,875.00 and Y = 299,337.00; thence West 7,525.00 feet to the point of beginning, containing approximately **2,285.62 acres**, all as more particularly outlined on a plat on file in the Office of Mineral Resources, Department of Natural Resources. All bearings, distances and coordinates are based on Louisiana Coordinate System of 1927, (North or South Zone).

NOTE: The above description of the Tract nominated for lease has been provided and corrected, where required, exclusively by the nomination party. Any mineral lease selected from this Tract and awarded by the Louisiana State Mineral and Energy Board shall be without warranty of any kind, either express, implied, or statutory, including, but not limited to, the implied warranties of merchantability and fitness for a particular purpose. Should the mineral lease awarded by the Louisiana State Mineral and Energy Board be subsequently modified, cancelled or abrogated due to the existence of conflicting leases, operating agreements, private claims or other future obligations or conditions which may affect all or any

portion of the leased Tract, it shall not relieve the Lessee of the obligation to pay any bonus due thereon to the Louisiana State Mineral and Energy Board, nor shall the Louisiana State Mineral and Energy Board be obligated to refund any consideration paid by the Lessor prior to such modification, cancellation, or abrogation, including, but not limited to, bonuses, rentals and royalties.

NOTE: The State of Louisiana does hereby reserve, and this lease shall be subject to, the imprescriptible right of surface use in the nature of a servitude in favor of the Department of Natural Resources, including its Offices and Commissions, for the sole purpose of implementing, constructing, servicing and maintaining approved coastal zone management and/or restoration projects. Utilization of any and all rights derived under this lease by the mineral lessee, its agents, successors or assigns, shall not interfere with nor hinder the reasonable surface use by the Department of Natural Resources, its Offices or Commissions, as herein above reserved.

NOTE: It appears, according to our records, that a portion of this Tract is located within the restrictive safety fairway area as set out by the Corps of Engineers, U.S. Army and/or the restrictive anchorage area as set out by the U.S. Coast Guard.

Applicant: MIDNITE ENERGY, INC.

Bidder	Cash Payment	Price/Acre	Rental	Oil	Gas	Other

Legend

- 12-110012
- Blocks
- Active Leases

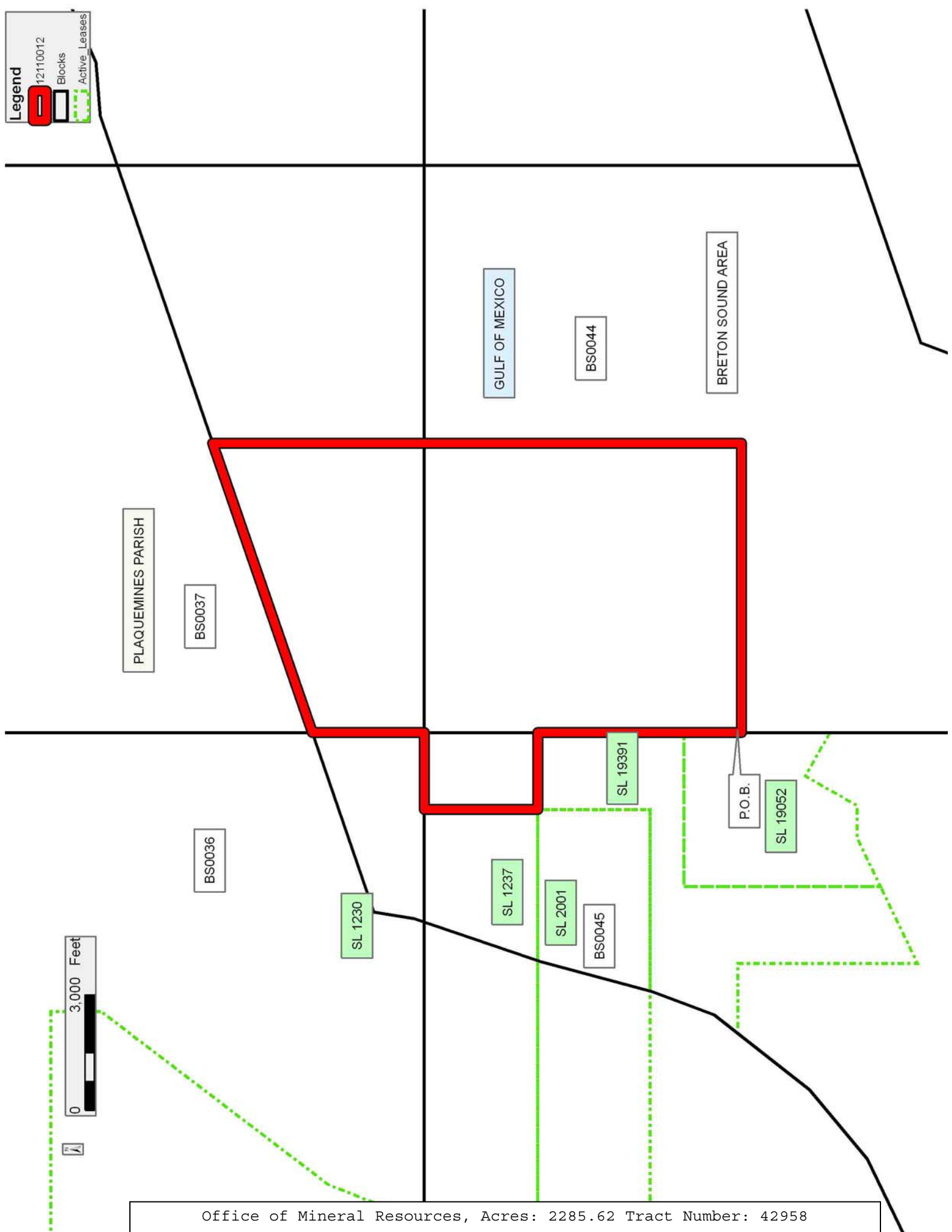

TRACT 42959 - Portion of Block 43, Breton Sound Area, Plaquemines Parish, Louisiana

The beds and bottoms of all water bodies belonging to the State of Louisiana located in Block 43, Breton Sound Area, together with any present lands formed by accretion to the shoreline or islands formed therein, located in Plaquemines Parish, Louisiana, owned by and not presently under mineral lease as of November 14, 2012, from the State of Louisiana, the geographical area of which is more fully described as follows: Beginning at a point on the West line of said Block 43, having Coordinates of X = 2,709,100.00 and Y = 306,103.00; thence East 14,750.00 feet to a point on the East line of said Block 43, having Coordinates of X = 2,723,850.00 and Y = 306,103.00; thence South 4,198.93 feet along the East line of said Block 43 to a point on the Three Mile Line, as decreed by the Supreme Court of the United States, as determined by a Special Master appointed therein, in litigation styled *United States v. State of Louisiana et al No. 9 Original*, in 1975, having Coordinates of X = 2,723,850.00 and Y = 301,904.07; thence along said Three Mile Line the following: Southwesterly along an arc to the right having a center of X = 2,713,324 and Y = 316,801 to a point having Coordinates of X = 2,720,770 and Y = 300,149, Southwesterly along a straight line to a point having Coordinates of X = 2,719,218 and Y = 299,455, Southwesterly along an arc to the right having a center of X = 2,711,772 and Y = 316,107 to a point having Coordinates of X = 2,714,238 and Y = 298,034 and Southwesterly along a straight line to a point of intersection with the West line of said Block 43, having Coordinates of X = 2,709,100.00 and Y = 296,270.08; thence North 9,832.92 feet along the West line of said Block 43 to the point of beginning, containing approximately **2,499.83 acres, LESS AND EXCEPT** that portion thereof, if any, lying seaward of the line three nautical miles from the coast line of Louisiana, as said three mile line has been decreed by the Supreme Court of the United States, as determined by a Special Master appointed therein, in litigation styled **United States v. State of Louisiana et al No. 9 Original**, in 1975, all as more particularly outlined on a plat in the Office of Mineral Resources, Department of Natural Resources. All bearings, distances and coordinates are based on the Louisiana Coordinate System of 1927, (South Zone).

NOTE: The above description of the Tract nominated for lease has been provided and corrected, where required, exclusively by the nomination party. Any mineral lease selected from this Tract and awarded by the Louisiana State Mineral and Energy Board shall be without warranty of any kind, either express, implied, or statutory, including, but not limited to, the implied warranties of merchantability and fitness for a particular purpose. Should the mineral lease awarded by the Louisiana State Mineral and Energy Board be subsequently modified, cancelled or abrogated due to the existence of conflicting leases, operating agreements, private claims or other future obligations or conditions which may affect all or any portion of the leased Tract, it shall not relieve the Lessee of the obligation to pay any bonus due thereon to the Louisiana State Mineral and Energy Board, nor shall the Louisiana State Mineral and Energy Board be

obligated to refund any consideration paid by the Lessor prior to such modification, cancellation, or abrogation, including, but not limited to, bonuses, rentals and royalties.

NOTE: The State of Louisiana does hereby reserve, and this lease shall be subject to, the imprescriptible right of surface use in the nature of a servitude in favor of the Department of Natural Resources, including its Offices and Commissions, for the sole purpose of implementing, constructing, servicing and maintaining approved coastal zone management and/or restoration projects. Utilization of any and all rights derived under this lease by the mineral lessee, its agents, successors or assigns, shall not interfere with nor hinder the reasonable surface use by the Department of Natural Resources, its Offices or Commissions, as herein above reserved.

NOTE: It appears, according to our records, that a portion of this Tract is located within the restrictive safety fairway area as set out by the Corps of Engineers, U.S. Army and/or the restrictive anchorage area as set out by the U.S. Coast Guard.

Applicant: MIDNITE ENERGY, INC.

Bidder	Cash Payment	Price/Acre	Rental	Oil	Gas	Other

Legend
12110015
Blocks

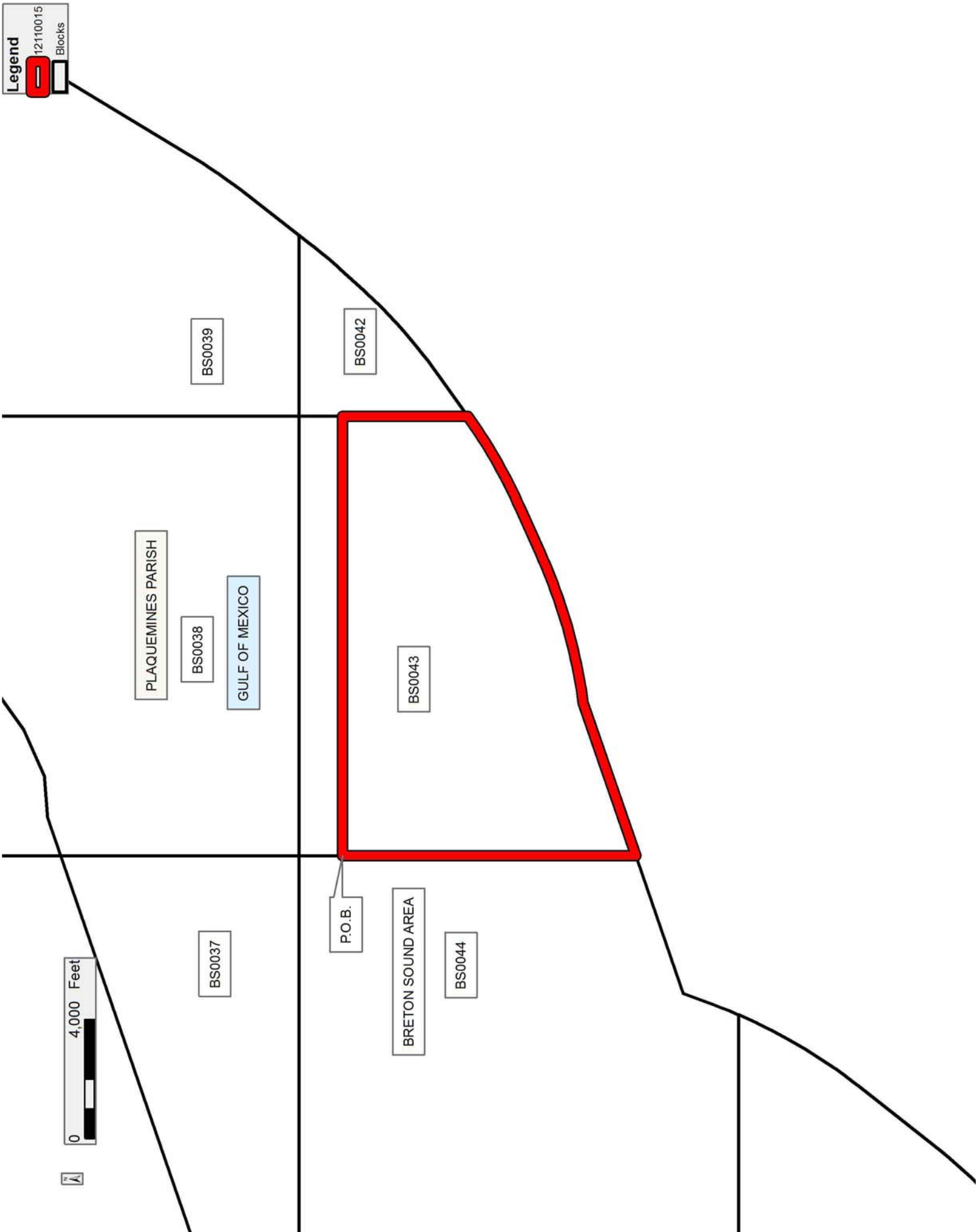

TRACT 42960 - Portion of Blocks 44, and 53, Breton Sound Area, Plaquemines Parish, Louisiana

The beds and bottoms of all water bodies belonging to the State of Louisiana located in Blocks 44, and 53, Breton Sound Area, together with any present lands formed by accretion to the shoreline or islands formed therein, located in Plaquemines Parish, Louisiana, owned by and not presently under mineral lease as of November 14, 2012, from the State of Louisiana, the geographical area of which is more fully described as follows: Beginning at a point on the East line of State Lease No. 19052, having Coordinates of X = 2,694,350.00 and Y = 299,337.00; thence East 14,750.00 feet to a point on the East line of said Block 44, having Coordinates of X = 2,709,100.00 and Y = 299,337.00; thence South 3,066.92 feet along the East line of said Block 44 to a point on the Three Mile Line, as decreed by the Supreme Court of the United States, as determined by a Special Master appointed therein, in litigation styled *United States v. State of Louisiana et al No. 9 Original*, in 1975, having Coordinates of X = 2,709,100.00 and Y = 296,270.08; thence along said Three Mile Line as follows: Southwesterly along a straight line to a point having Coordinates of X = 2,704,480 and Y = 294,684, Southwesterly along a straight line to a point having Coordinates of X = 2,704,099 and Y = 293,666, Southwesterly along an arc to the right having a center of X = 2,687,014 and Y = 300,054 to a point having Coordinates of X = 2,701,338 and Y = 288,761 and Southwesterly along a straight line to a point having Coordinates of X = 2,700,150.00 and Y = 287,254.14, said point also being the most Easterly Northeast corner of State Lease No. 3770, as amended; thence along the Northeast boundary of said State Lease No. 3770, as amended, as follows: West 5,000.00 feet to a point having Coordinates of X = 2,695,150.00 and Y = 287,254.14, North 46 degrees 44 minutes 26 seconds East 5,217.93 feet to a point having Coordinates of X = 2,698,950.00 and Y = 290,830.00 and West 4,600.00 feet to the Northernmost Northwest corner of said State Lease No. 3770, as amended, also being the Southeast corner of State Lease No. 12806, as amended, having Coordinates of X = 2,694,350.00 and Y = 290,830.00; thence North 89.16 feet along the East line of said State Lease No. 12806, as amended, to a point being the Southernmost corner of State Lease No. 16738, as amended, having Coordinates of X = 2,694,350.00 and Y = 290,919.16; thence North 29 degrees 33 minutes 37 seconds East 2,196.77 feet along the East line of said State Lease No. 16738, as amended, to its Northeast corner, also being the Southeast corner of State Lease No. 16736, as amended, having Coordinates of X = 2,695,433.75 and Y = 292,830.00; thence along the Southeastern and Northeastern boundaries of said State Lease No. 16736, as amended, as follows: North 29 degrees 33 minutes 37 seconds East 3,127.17 feet to a point having Coordinates of X = 2,696,976.51 and Y = 295,550.13 and North 60 degrees 26 minutes 23 seconds West 3,019.54 feet to the Northwest corner of said State Lease No. 16736, as amended, also being the Northeast corner of State Lease No. 16735, as amended, also being the Easternmost Southeast corner of said State Lease No. 19052, having Coordinates of X = 2,694,350.00 and Y = 297,039.79; thence North 2,297.21 feet along the East line of said State Lease No. 19052 to the point of beginning, containing approximately **2,499.92 acres**,

LESS AND EXCEPT that portion thereof, if any, lying seaward of the line three nautical miles from the coast line of Louisiana, as said three mile line has been decreed by the Supreme Court of the United States, as determined by a Special Master appointed therein, in litigation styled **United States v. State of Louisiana et al No. 9 Original**, in 1975, all as more particularly outlined on a plat in the Office of Mineral Resources, Department of Natural Resources. All bearings, distances and coordinates are based on the Louisiana Coordinate System of 1927, (South Zone).

NOTE: The above description of the Tract nominated for lease has been provided and corrected, where required, exclusively by the nomination party. Any mineral lease selected from this Tract and awarded by the Louisiana State Mineral and Energy Board shall be without warranty of any kind, either express, implied, or statutory, including, but not limited to, the implied warranties of merchantability and fitness for a particular purpose. Should the mineral lease awarded by the Louisiana State Mineral and Energy Board be subsequently modified, cancelled or abrogated due to the existence of conflicting leases, operating agreements, private claims or other future obligations or conditions which may affect all or any portion of the leased Tract, it shall not relieve the Lessee of the obligation to pay any bonus due thereon to the Louisiana State Mineral and Energy Board, nor shall the Louisiana State Mineral and Energy Board be obligated to refund any consideration paid by the Lessor prior to such modification, cancellation, or abrogation, including, but not limited to, bonuses, rentals and royalties.

NOTE: The State of Louisiana does hereby reserve, and this lease shall be subject to, the imprescriptible right of surface use in the nature of a servitude in favor of the Department of Natural Resources, including its Offices and Commissions, for the sole purpose of implementing, constructing, servicing and maintaining approved coastal zone management and/or restoration projects. Utilization of any and all rights derived under this lease by the mineral lessee, its agents, successors or assigns, shall not interfere with nor hinder the reasonable surface use by the Department of Natural Resources, its Offices or Commissions, as herein above reserved.

NOTE: It appears, according to our records, that a portion of this Tract is located within the restrictive safety fairway area as set out by the Corps of Engineers, U.S. Army and/or the restrictive anchorage area as set out by the U.S. Coast Guard.

Applicant: MIDNITE ENERGY, INC.

Bidder	Cash Payment	Price/Acre	Rental	Oil	Gas	Other

Legend

12110010
Blocks

Active_Leases

