

**TRACT 42980 - Portion of Blocks 12, and 9, Vermilion Area, Revised, Vermilion Parish, Louisiana**

The beds and bottoms of all water bodies belonging to the State of Louisiana located in Blocks 12, and 9, Vermilion Area, Revised, together with any present lands formed by accretion to the shoreline or islands formed therein, located in Vermilion Parish, Louisiana, owned by and not presently under mineral lease as of December 12, 2012, from the State of Louisiana, the geographical area of which is more fully described as follows: Beginning at a point within Block 9, Vermilion Area, Revised also being a point on the South boundary of State Lease No. 20352 having Coordinates of X = 1,713,035.00 and Y = 319,580.00; thence East 3,370.00 feet along the South boundary of said State Lease No. 20352 to the Northernmost corner of State Lease No. 19998 having Coordinates of X = 1,716,405.00 and Y = 319,580.00; thence along the boundaries of said State Lease No. 19998 the following courses: South 46 degrees 28 minutes 56 seconds West 4,647.25 feet to a point having Coordinates of X = 1,713,035.00 and Y = 316,380.00 and West 5,000.00 feet to its Northwest corner having Coordinates of X = 1,708,035.00 and Y = 316,380.00; thence North 1,990.91 feet to a point on the Louisiana Coastline, as decreed by the Supreme Court of the United States, as determined by a Special Master appointed therein, in litigation styled *United States v. State of Louisiana et al No. 9 Original*, in 1975, having Coordinates of X = 1,708,035.00 and Y = 318,370.91; thence along said Louisiana Coastline the following courses: Northeasterly along a straight line to a point having Coordinates of X = 1,708,756.00 and Y = 318,661.00, Northeasterly along a straight line to a point having Coordinates of X = 1,709,968.00 and Y = 319,818.00 and Northeasterly along a straight line to the Southwest corner of said State Lease No. 20352 having Coordinates of X = 1,711,037.92 and Y = 320,545.19; thence along the boundaries of said State Lease No. 20352 the following courses: South 78 degrees 13 minutes 41 seconds East 2,039.98 feet to a point having Coordinates of X = 1,713,035.00 and Y = 320,129.00 and South 549.00 feet to the point of beginning, containing approximately **513.49 acres**, all as more particularly outlined on a plat on file in the Office of Mineral Resources, Department of Natural Resources. All bearings, distances and coordinates are based on Louisiana Coordinate System of 1927, (North or South Zone).

NOTE: The above description of the Tract nominated for lease has been provided and corrected, where required, exclusively by the nomination party. Any mineral lease selected from this Tract and awarded by the Louisiana State Mineral and Energy Board shall be without warranty of any kind, either express, implied, or statutory, including, but not limited to, the implied warranties of merchantability and fitness for a particular purpose. Should the mineral lease awarded by the Louisiana State Mineral and Energy Board be subsequently modified, cancelled or abrogated due to the existence of conflicting leases, operating agreements, private claims or other future obligations or conditions which may affect all or any portion of the leased Tract, it shall not relieve the Lessee of the obligation to pay any bonus due thereon to the Louisiana State Mineral and

Energy Board, nor shall the Louisiana State Mineral and Energy Board be obligated to refund any consideration paid by the Lessor prior to such modification, cancellation, or abrogation, including, but not limited to, bonuses, rentals and royalties.

NOTE: The State of Louisiana does hereby reserve, and this lease shall be subject to, the imprescriptible right of surface use in the nature of a servitude in favor of the Department of Natural Resources, including its Offices and Commissions, for the sole purpose of implementing, constructing, servicing and maintaining approved coastal zone management and/or restoration projects. Utilization of any and all rights derived under this lease by the mineral lessee, its agents, successors or assigns, shall not interfere with nor hinder the reasonable surface use by the Department of Natural Resources, its Offices or Commissions, as herein above reserved.

Applicant: ALJ ENERGY

Bidder	Cash Payment	Price/Acre	Rental	Oil	Gas	Other

**Legend**

- 12120002
- Blocks
- Active\_Leases

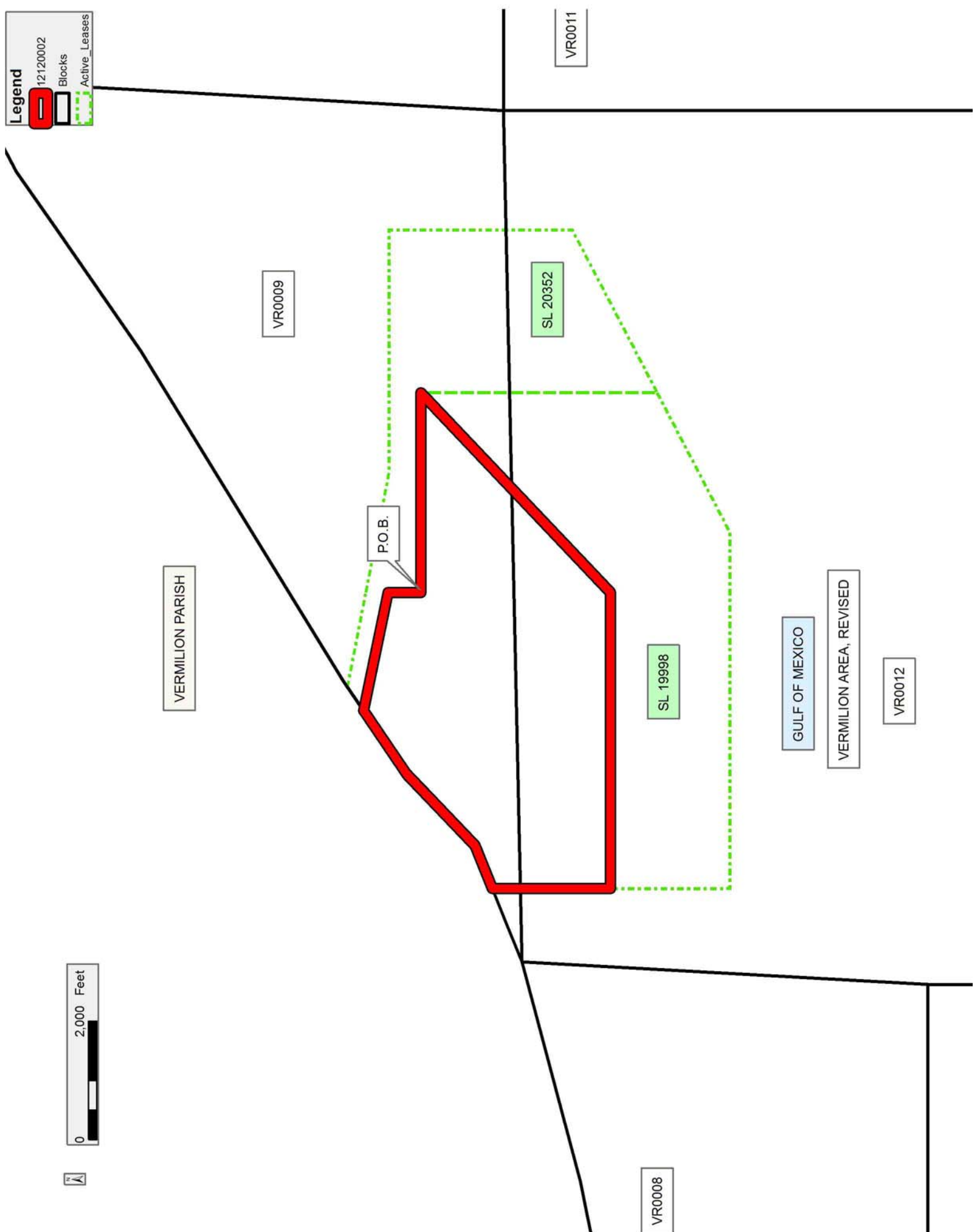

**TRACT 42981 - Portion of Block 77, Main Pass Area, Revised, Plaquemines Parish, Louisiana**

The beds and bottoms of all water bodies belonging to the State of Louisiana located in Block 77, Main Pass Area, Revised, together with any present lands formed by accretion to the shoreline or islands formed therein, located in Plaquemines Parish, Louisiana, owned by and not presently under mineral lease as of December 12, 2012, from the State of Louisiana, the geographical area of which is more fully described as follows: Beginning at a point on the West line of Block 77, Main Pass Area, Revised, having Coordinates of X = 2,763,508.00 and Y = 194,337.00; thence North 5,877.00 feet along the West line of said Block 77 to its Northwest corner having Coordinates of X = 2,763,508.00 and Y = 200,214.00; thence East 9,551.62 feet along the North line of said Block 77 to a point on the Three Mile Line, as decreed by the Supreme Court of the United States, as determined by a Special Master appointed therein, in litigation styled *United States v. State of Louisiana et al No. 9 Original*, in 1975, having Coordinates of X = 2,773,059.62 and Y = 200,214.00; thence along said Three Mile line the following: Southerly along an arc to the right having a radius of 18,240.60 feet and a center located at X = 2,755,178 and Y = 203,815 to a point having Coordinates of X = 2,770,763 and Y = 194,337; thence West 7,255.00 feet to the point of beginning, containing **1,160.34 acres, LESS AND EXCEPT** that portion thereof, if any, lying seaward of the line three nautical miles from the coast line of Louisiana, as said three mile line has been decreed by the Supreme Court of the United States, as determined by a Special Master appointed therein, in litigation styled **United States v. State of Louisiana et al No. 9 Original**, in 1975, all as more particularly outlined on a plat in the Office of Mineral Resources, Department of Natural Resources. All bearings, distances and coordinates are based on the Louisiana Coordinate System of 1927, (South Zone).

NOTE: The above description of the Tract nominated for lease has been provided and corrected, where required, exclusively by the nomination party. Any mineral lease selected from this Tract and awarded by the Louisiana State Mineral and Energy Board shall be without warranty of any kind, either express, implied, or statutory, including, but not limited to, the implied warranties of merchantability and fitness for a particular purpose. Should the mineral lease awarded by the Louisiana State Mineral and Energy Board be subsequently modified, cancelled or abrogated due to the existence of conflicting leases, operating agreements, private claims or other future obligations or conditions which may affect all or any portion of the leased Tract, it shall not relieve the Lessee of the obligation to pay any bonus due thereon to the Louisiana State Mineral and Energy Board, nor shall the Louisiana State Mineral and Energy Board be obligated to refund any consideration paid by the Lessor prior to such modification, cancellation, or abrogation, including, but not limited to, bonuses, rentals and royalties.

NOTE: The State of Louisiana does hereby reserve, and this lease shall be subject to, the imprescriptible right of surface use in the nature of a servitude in favor of the Department of Natural Resources, including its Offices and Commissions, for the sole purpose of implementing, constructing, servicing and maintaining approved coastal zone management and/or restoration projects. Utilization of any and all rights derived under this lease by the mineral lessee, its agents, successors or assigns, shall not interfere with nor hinder the reasonable surface use by the Department of Natural Resources, its Offices or Commissions, as herein above reserved.

Applicant: MERLIN EXPLORATION, INC.

Bidder	Cash Payment	Price/Acre	Rental	Oil	Gas	Other

**Legend**

- 12120009
- Blocks
- Active Leases



**TRACT 42982 - Portion of Block 77, Main Pass Area, Revised, Plaquemines Parish, Louisiana**

The beds and bottoms of all water bodies belonging to the State of Louisiana located in Block 77, Main Pass Area, Revised, together with any present lands formed by accretion to the shoreline or islands formed therein, located in Plaquemines Parish, Louisiana, owned by and not presently under mineral lease as of December 12, 2012, from the State of Louisiana, the geographical area of which is more fully described as follows: Beginning at a point on the West line of Block 77, Main Pass Area, Revised, having Coordinates of X = 2,763,508.00 and Y = 194,337.00; thence East 7,255.00 feet to a point on the Three Mile Line, as decreed by the Supreme Court of the United States, as determined by a Special Master appointed therein, in litigation styled *United States v. State of Louisiana et al No. 9 Original*, in 1975, having Coordinates of X = 2,770,763 and Y = 194,337; thence along said Three Mile line the following: Southerly along an arc to the right having a radius of 18,240.60 feet and a center located at X = 2,754,100 and Y = 186,915 to a point having Coordinates of X = 2,771,780 and Y = 191,404; and Southerly along an arc to the right having a radius of 18,240.60 feet and a center located at X = 2,754,263 and Y = 186,316 to a point on the South line of said Block 77 having Coordinates of X = 2,772,483.17 and Y = 185,456.00; thence West 8,975.17 feet along the South line of said Block 77 to its Southwest corner having Coordinates of X = 2,763,508.00 and Y = 185,456.00; thence North 8,881.00 feet along the West line of said Block 77 to the point of beginning, containing **1,726.13 acres, LESS AND EXCEPT** that portion thereof, if any, lying seaward of the line three nautical miles from the coast line of Louisiana, as said three mile line has been decreed by the Supreme Court of the United States, as determined by a Special Master appointed therein, in litigation styled **United States v. State of Louisiana et al No. 9 Original**, in 1975, all as more particularly outlined on a plat in the Office of Mineral Resources, Department of Natural Resources. All bearings, distances and coordinates are based on the Louisiana Coordinate System of 1927, (South Zone).

NOTE: The above description of the Tract nominated for lease has been provided and corrected, where required, exclusively by the nomination party. Any mineral lease selected from this Tract and awarded by the Louisiana State Mineral and Energy Board shall be without warranty of any kind, either express, implied, or statutory, including, but not limited to, the implied warranties of merchantability and fitness for a particular purpose. Should the mineral lease awarded by the Louisiana State Mineral and Energy Board be subsequently modified, cancelled or abrogated due to the existence of conflicting leases, operating agreements, private claims or other future obligations or conditions which may affect all or any portion of the leased Tract, it shall not relieve the Lessee of the obligation to pay any bonus due thereon to the Louisiana State Mineral and Energy Board, nor shall the Louisiana State Mineral and Energy Board be obligated to refund any consideration paid by the Lessor prior to such

modification, cancellation, or abrogation, including, but not limited to, bonuses, rentals and royalties.

NOTE: The State of Louisiana does hereby reserve, and this lease shall be subject to, the imprescriptible right of surface use in the nature of a servitude in favor of the Department of Natural Resources, including its Offices and Commissions, for the sole purpose of implementing, constructing, servicing and maintaining approved coastal zone management and/or restoration projects. Utilization of any and all rights derived under this lease by the mineral lessee, its agents, successors or assigns, shall not interfere with nor hinder the reasonable surface use by the Department of Natural Resources, its Offices or Commissions, as herein above reserved.

Applicant: MERLIN EXPLORATION, INC.

Bidder	Cash Payment	Price/Acre	Rental	Oil	Gas	Other



