

**TRACT 43016 - East Baton Rouge Parish, Louisiana**

A certain Tract of land, excluding the beds and bottoms of all navigable waters, belonging to and not presently under mineral lease from Board Of Supervisors Of Southern University And A&M College on December 12, 2012, being more fully described as follows: A certain tract of land, owned by Southern University, lying within Sections 41 and 42, Township 5 South Range 1 West, East Baton Rouge Parish being more particularly described as all that portion of Section 41, lying South of the North line of the Baker Canal and West of the Corporate Limits of the Town of Baker (1976) and all that portion of the East half of Section 42 owned by Southern University lying South of the North line of the Baker Canal and North of lands now or formerly owned by Lincoln Land Investments, Inc. and Davey Haney, (Insofar and only insofar as, this Nomination/Lease covers only those depths from the surface of the earth down to a certain depth not to exceed 8,700 feet), containing approximately **256 acres**, all as more particularly outlined on a plat on file in the Office of Mineral Resources, Department of Natural Resources. The description is based on information provided by the State Agency regarding location and ownership of surface and mineral rights. All bearings, distances and coordinates, if applicable, are based on Louisiana Coordinate System of 1927, (North or South Zone).

NOTE: The above description of the Tract nominated for lease has been provided and corrected, where required, exclusively by the nomination party. Any mineral lease selected from this Tract and awarded by the Louisiana State Mineral and Energy Board shall be without warranty of any kind, either express, implied, or statutory, including, but not limited to, the implied warranties of merchantability and fitness for a particular purpose. Should the mineral lease awarded by the Louisiana State Mineral and Energy Board be subsequently modified, cancelled or abrogated due to the existence of conflicting leases, operating agreements, private claims or other future obligations or conditions which may affect all or any portion of the leased Tract, it shall not relieve the Lessee of the obligation to pay any bonus due thereon to the Louisiana State Mineral and Energy Board, nor shall the Louisiana State Mineral and Energy Board be obligated to refund any consideration paid by the Lessor prior to such modification, cancellation, or abrogation, including, but not limited to, bonuses, rentals and royalties.

NOTE: Insofar and only insofar as, this Lease covers only depths from the surface of the earth down to a certain depth not to exceed 8700 feet.

NOTE: The minimum acceptable bonus will be \$150 per acre and a minimum royalty of 20%.

NOTE: The University shall have free access to the property at all times.

NOTE: Roads within the property and access routes shall remain accessible to the University at all times.

NOTE: Drilling on the property shall be by and with the permission of the proper University officials to prevent any interruption to crop production, animal production or experimental projects.

NOTE: No construction shall be erected unless by and with the permission of the University.

NOTE: Any damage to roads shall be repaired by the Lessee at no cost to the University.

NOTE: All utilities shall be supplied by Lessee.

NOTE: At the termination of the drilling and/or exploration all sites shall be restored to the original condition.

Applicant: QUEST EXPLORATION, L.L.C. to Agency and by Resolution from the Board Of Supervisors Of Southern University And A&M College authorizing the Mineral Board to act in its behalf

Bidder	Cash Payment	Price/Acre	Rental	Oil	Gas	Other

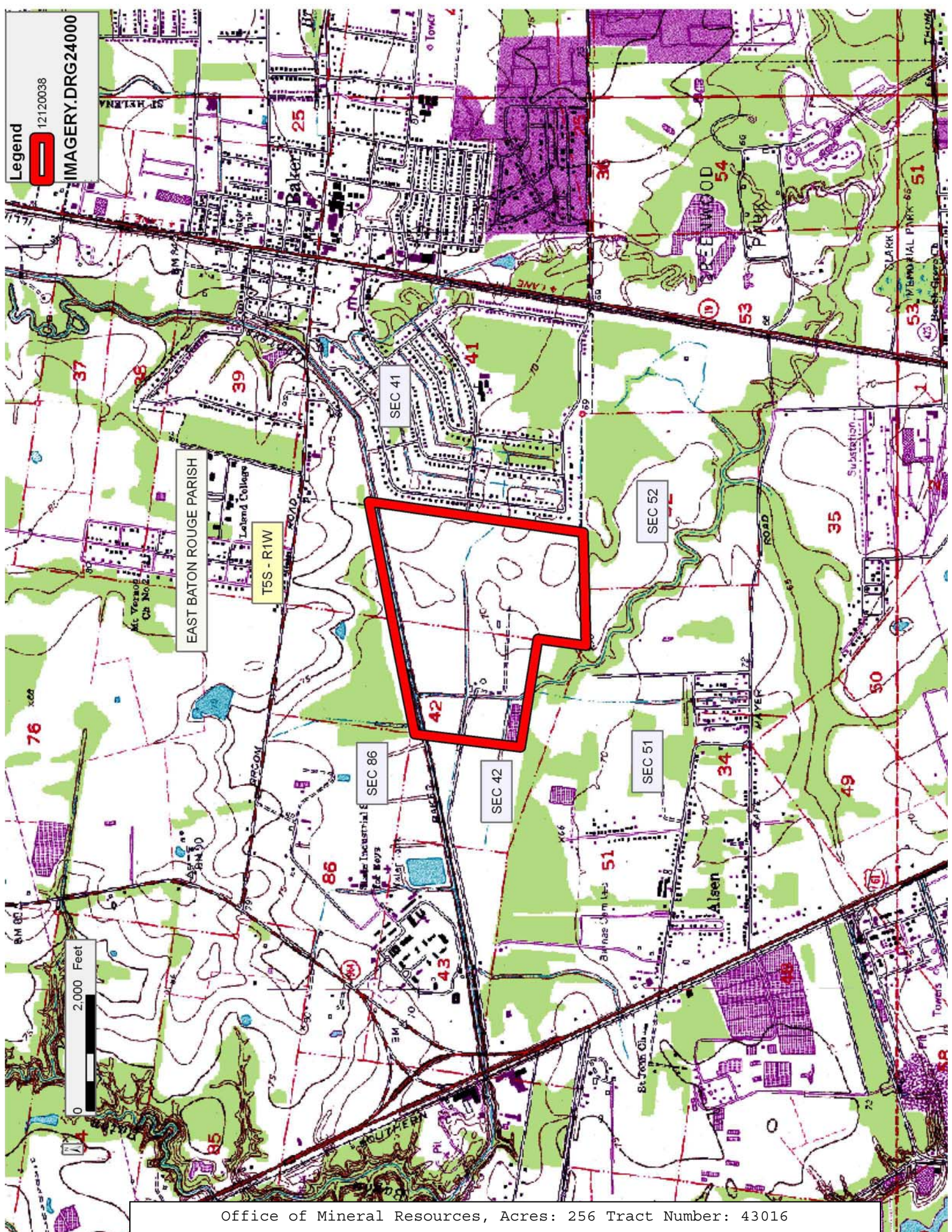

**TRACT 43017 - Iberia Parish School Board and St. Martin Parish School Board - St. Martin Parish, Louisiana**

The State Mineral and Energy Board acting on behalf of the Iberia Parish School Board and St. Martin Parish School Board, pursuant to Resolution(s) adopted by that (those) body(ies) and in accordance with Louisiana Revised Statutes 30:121-136 and 151-156, as amended, and Article XIV, Section 16(A)(9) and (B) of the Louisiana Constitution of 1974, as same may be continued and promulgated in proper statutory form and, further, amended from time to time, advertises the lands not under mineral lease on December 12, 2012, excluding the beds and bottoms of all navigable water bodies located within the following: All or a portion of Section 16, Township 13 South, Range 11 East in St. Martin Parish, Louisiana, containing approximately **639 acres**, all as more particularly outlined on a plat on file in the Office of Mineral Resources, Department of Natural Resources. All bearings, distances and coordinates are based on Louisiana Coordinate System of 1927, (North or South Zone).

NOTE: The above description of the Tract nominated for lease has been provided and corrected, where required, exclusively by the nomination party. Any mineral lease selected from this Tract and awarded by the Louisiana State Mineral and Energy Board shall be without warranty of any kind, either express, implied, or statutory, including, but not limited to, the implied warranties of merchantability and fitness for a particular purpose. Should the mineral lease awarded by the Louisiana State Mineral and Energy Board be subsequently modified, cancelled or abrogated due to the existence of conflicting leases, operating agreements, private claims or other future obligations or conditions which may affect all or any portion of the leased Tract, it shall not relieve the Lessee of the obligation to pay any bonus due thereon to the Louisiana State Mineral and Energy Board, nor shall the Louisiana State Mineral and Energy Board be obligated to refund any consideration paid by the Lessor prior to such modification, cancellation, or abrogation, including, but not limited to, bonuses, rentals and royalties.

NOTE: Lessors acknowledge that said Township 13 South, Range 11 East, is located 90.80% in the Parish of St. Martin and 9.20% in the Parish of Iberia; and Lessee is authorized and directed to pay any and all rentals and royalties which may accrue under the terms of this lease to Lessors separately and in the following proportions: St. Martin Parish School Board 90.80% and Iberia Parish School Board 9.20% and prospective bidders are hereby placed on notice that execution by the State Mineral Board of oil, gas and mineral lease on behalf of the St. Martin Parish School Board and the Iberia Parish School Board on the above described portion of section shall not be construed as a waiver by the State Mineral Board of any rights that it may have to lease for and on behalf of the State of Louisiana any navigable water bottoms that might be included within said portion of said section.

NOTE: This acreage is entirely within the boundary of Atchafalaya Basin Legal Area.

NOTE: The St. Martin and Iberia Parish School Boards are requiring a minimum \$200 per acre and 25% royalty.

NOTE: This lease will contain a primary term of five (5) years.

NOTE: The State of Louisiana does hereby reserve, and this lease shall be subject to, the imprescriptible right of surface use in the nature of a servitude in favor of the Department of Natural Resources, including its Offices and Commissions, for the sole purpose of implementing, constructing, servicing and maintaining approved coastal zone management and/or restoration projects. Utilization of any and all rights derived under this lease by the mineral lessee, its agents, successors or assigns, shall not interfere with nor hinder the reasonable surface use by the Department of Natural Resources, its Offices or Commissions, as herein above reserved.

Applicant: THEOPHILUS OIL, GAS & LAND SERVICES, LLC to Agency and by Resolution from the Iberia Parish School Board and St. Martin Parish School Board authorizing the Mineral Board to act in its behalf

Bidder	Cash Payment	Price/Acre	Rental	Oil	Gas	Other

Legend

12120039

IMAGERY.DRG24000

2,000 Feet



ST MARTIN PARISH

SEC 9

T13S - R11E

SEC 16

SEC 17

SEC 15

SEC 21

