

**TRACT 43124 - Avoyelles Parish, Louisiana**

All lands, including lands now or formerly constituting the beds and bottoms of all water bodies of every nature and description, owned by and not presently under mineral lease as of March 13, 2013 from the State of Louisiana, situated in Avoyelles Parish, Louisiana, and being more fully described as follows: That certain tract or parcel of land, excluding the beds and bottoms of all navigable waters being 39.61 acres in the Northwest Quarter of the Northeast Quarter (NW/4 of NE/4) of Section 27 and being 39.86 acres in the Southwest Quarter of the Southeast Quarter (SW/4 of SE/4) of Section 22, Township 3 North, Range 5 East, Avoyelles Parish, Louisiana. Being a portion of the same tract of land described in that certain instrument, dated August 31, 1965, under Patent No. 1238658, all as more particularly outlined on a plat on file in the Office of Mineral Resources, Department of Natural Resources, containing a total of approximately **79.47 acres**, all as more particularly outlined on a plat on file in the Office of Mineral Resources, Department of Natural Resources. All bearings, distances and coordinates are based on Louisiana Coordinate System of 1927, (North or South Zone), where applicable.

NOTE: The above description of the Tract nominated for lease has been provided and corrected, where required, exclusively by the nomination party. Any mineral lease selected from this Tract and awarded by the Louisiana State Mineral and Energy Board shall be without warranty of any kind, either express, implied, or statutory, including, but not limited to, the implied warranties of merchantability and fitness for a particular purpose. Should the mineral lease awarded by the Louisiana State Mineral and Energy Board be subsequently modified, cancelled or abrogated due to the existence of conflicting leases, operating agreements, private claims or other future obligations or conditions which may affect all or any portion of the leased Tract, it shall not relieve the Lessee of the obligation to pay any bonus due thereon to the Louisiana State Mineral and Energy Board, nor shall the Louisiana State Mineral and Energy Board be obligated to refund any consideration paid by the Lessor prior to such modification, cancellation, or abrogation, including, but not limited to, bonuses, rentals and royalties.

Applicant: MEAD OIL & GAS

Bidder	Cash Payment	Price/Acre	Rental	Oil	Gas	Other



13030007  
Blocks

IMAGERY.DRG24001

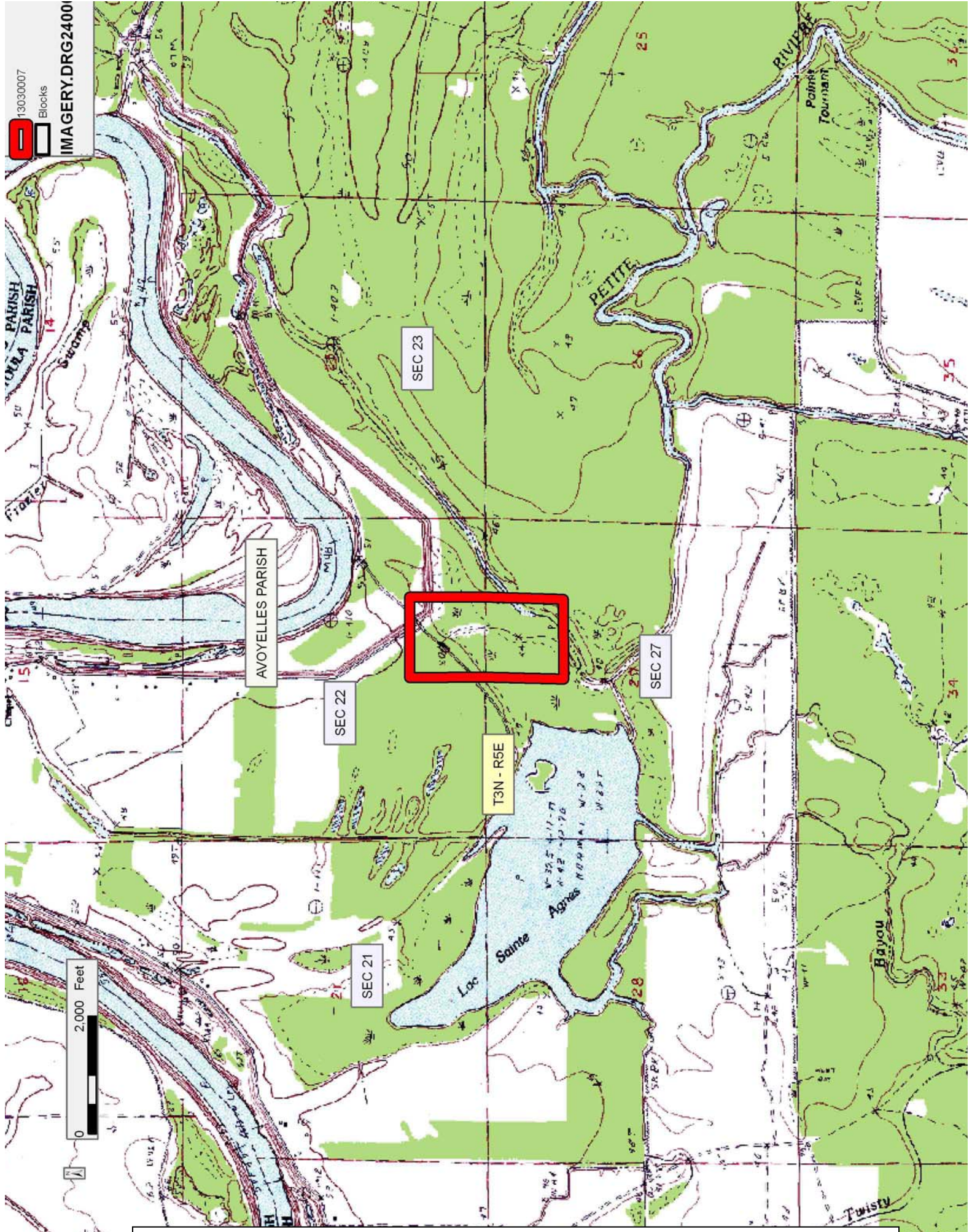

Office of Mineral Resources, Acres: 79.47 Tract Number: 43124



**TRACT 43125 - Avoyelles Parish, Louisiana**

All lands, including lands now or formerly constituting the beds and bottoms of all water bodies of every nature and description, owned by and not presently under mineral lease as of March 13, 2013 from the State of Louisiana, situated in Avoyelles Parish, Louisiana, and being more fully described as follows: That certain tract or parcel of land, excluding the beds and bottoms of all navigable waters being the Northwest Quarter of the Northwest Quarter (NW/4 of NW/4) of Section 36, Township 3 North, Range 5 East, Avoyelles Parish, Louisiana. Being a portion of the same tract of land described in that certain instrument, dated August 31, 1965, under Patent No. 1238658, all as more particularly outlined on a plat on file in the Office of Mineral Resources, Department of Natural Resources, containing approximately **40.13 acres**, all as more particularly outlined on a plat on file in the Office of Mineral Resources, Department of Natural Resources. All bearings, distances and coordinates are based on Louisiana Coordinate System of 1927, (North or South Zone), where applicable.

NOTE: The above description of the Tract nominated for lease has been provided and corrected, where required, exclusively by the nomination party. Any mineral lease selected from this Tract and awarded by the Louisiana State Mineral and Energy Board shall be without warranty of any kind, either express, implied, or statutory, including, but not limited to, the implied warranties of merchantability and fitness for a particular purpose. Should the mineral lease awarded by the Louisiana State Mineral and Energy Board be subsequently modified, cancelled or abrogated due to the existence of conflicting leases, operating agreements, private claims or other future obligations or conditions which may affect all or any portion of the leased Tract, it shall not relieve the Lessee of the obligation to pay any bonus due thereon to the Louisiana State Mineral and Energy Board, nor shall the Louisiana State Mineral and Energy Board be obligated to refund any consideration paid by the Lessor prior to such modification, cancellation, or abrogation, including, but not limited to, bonuses, rentals and royalties.

Applicant: MEAD OIL & GAS

Bidder	Cash Payment	Price/Acre	Rental	Oil	Gas	Other

Legend

13030008

IMAGERY.DRG24000

