

TRACT 43366 - St. Mary and Terrebonne Parishes, Louisiana

A portion of all lands located above the mean high water mark, together with lands now or formerly constituting the beds and bottoms of any water body of whatever description or nature belonging to the State of Louisiana which is now located within the boundaries of the Atchafalaya Delta Wildlife Management Area and not presently under mineral lease by the State of Louisiana on July 10, 2013, and more particularly located as follows: Beginning at a point having Coordinates of X = 2,027,128.00 and Y = 270,129.00; thence East 6,501.06 feet to a point on the Western boundary of State Lease No. 2077 having a Coordinate of Y = 270,129.00; thence along the boundary of said State Lease No. 2077 the following courses: South 27 degrees 42 minutes 21 seconds West 484.24 feet, Southwesterly 1,212.83 feet along a curve to the left having a radius of 25,000.00 feet whose chord bears South 55 degrees 52 minutes 39 seconds West 1,212.71 feet, Southwesterly 1,957.29 feet along a curve to the left having a radius of 3,000.00 feet whose chord bears South 35 degrees 15 minutes 38 seconds West 1,922.76 feet, Southerly 957.83 feet along a curve to the left having a radius of 2,000.00 feet whose chord bears South 03 degrees 50 minutes 54 seconds West 948.71 feet, Southeasterly 1,194.85 feet along a curve to the left having a radius of 2,000.00 feet whose chord bears South 28 degrees 36 minutes 35 seconds East 1,177.16 feet, Southeasterly 592.94 feet along a curve to the left having a radius of 40,000.00 feet whose chord bears South 46 degrees 29 minutes 11 seconds East 592.93 feet, South 231.75 feet, South 07 degrees 07 minutes 30 seconds East 443.42 feet, South 14 degrees 22 minutes 53 seconds East 402.62 feet, South 19 degrees 09 minutes 32 seconds East 624.60 feet, South 27 degrees 28 minutes 28 seconds East 563.56 feet, South 34 degrees 04 minutes 38 seconds East 820.98 feet, South 21 degrees 34 minutes 17 seconds East 462.39 feet, North 88 degrees 45 minutes 17 seconds East 230.05 feet, and South 49 degrees 20 minutes 18 seconds East approximately 436 feet to a point of intersection with the Eastern boundary of the Atchafalaya Delta Wildlife Management Area; thence Southwesterly and Southerly approximately 14,833 feet along the boundary of said Atchafalaya Delta Wildlife Management Area to a point of intersection with a North-South line having a Coordinate of X = 2,023,244.00; thence North approximately 7,223 feet to a point having Coordinates of X = 2,023,244.00 and Y = 259,944.00; thence East 2,690.28 feet to a point having Coordinates of X = 2,025,934.28 and Y = 259,944.00; thence North 2,538.22 feet to the Southeast corner of State Lease No. 21119 having Coordinates of X = 2,025,934.28 and Y = 262,482.22; thence continue North 4,216.48 feet along the East boundary of said State Lease No. 21119 to its Northeast corner having Coordinates of X = 2,025,934.28 and Y = 266,698.70; thence East 1,193.72 feet to a point having Coordinates of X = 2,027,128.00 and Y = 266,698.70; thence North 3,430.30 feet to the point of beginning, **LESS AND EXCEPT** that portion, if any, of State Lease No. 2077, that may lie within the above described tract and **LESS AND EXCEPT** that portion, if any, of the above described tract that may lie outside of the Atchafalaya Delta Wildlife Management Area, containing approximately **2,443 acres**, all as more particularly outlined on a plat on file in the Office of Mineral Resources, Department

of Natural Resources. All bearings, distances and coordinates are based on Louisiana Coordinate System of 1927, (South Zone).

NOTE: The above description of the Tract nominated for lease has been provided and corrected, where required, exclusively by the nomination party. Any mineral lease selected from this Tract and awarded by the Louisiana State Mineral and Energy Board shall be without warranty of any kind, either express, implied, or statutory, including, but not limited to, the implied warranties of merchantability and fitness for a particular purpose. Should the mineral lease awarded by the Louisiana State Mineral and Energy Board be subsequently modified, cancelled or abrogated due to the existence of conflicting leases, operating agreements, private claims or other future obligations or conditions which may affect all or any portion of the leased Tract, it shall not relieve the Lessee of the obligation to pay any bonus due thereon to the Louisiana State Mineral and Energy Board, nor shall the Louisiana State Mineral and Energy Board be obligated to refund any consideration paid by the Lessor prior to such modification, cancellation, or abrogation, including, but not limited to, bonuses, rentals and royalties.

NOTE: The mineral lease is located in the Atchafalaya Delta WMA under the jurisdiction of the Louisiana Department of Wildlife and Fisheries which has promulgated rules and regulations for the protection of game and wildlife on the aforesaid Tract and, therefore, shall be subject to said rules and regulations, a copy of which shall be attached to the mineral leases. In addition to the specific rules and regulations applicable, the following shall apply regarding operations under this mineral lease:

- No activities will be allowed without written authorization of the Louisiana Department of Wildlife and Fisheries.
- Proposed projects will be evaluated on a case by case basis. Modifications to proposed project features including but not limited to access routes, spoil placement, well sites, flowlines and appurtenant structures may be required by the Department of Wildlife and Fisheries.
- Compliance with the Atchafalaya Delta WMA regulations will be required unless otherwise specified by the Department of Wildlife and Fisheries.
- Compensatory mitigation will be required to offset unavoidable wetland impacts.
- Compensation and/or oyster seed ground surveys may be required by the Department for potential impacts to productive oyster seed grounds located within the management area.
- Removal of all structures, facilities and equipment will be required within 120 days of abandonment unless otherwise agreed to in writing by the Louisiana Department of Wildlife and Fisheries.
- No activities will be allowed during the hunting season unless approved by the Department.

- This tract is located within the emerging Atchafalaya Delta. No activities will be allowed on emergent islands, sub aerial mudflats or vegetated wetlands. Drilling will be restricted to passes and open water bays. The Louisiana Department of Wildlife and Fisheries (LDWF) shall have discretion to determine access routes. In the event that LDWF approves of dredging for access LDWF shall have discretion to require hydraulic or spray dredging.
- Prior to submitting application for wetland permits to Federal and State permitting agencies the leaseholder shall coordinate project details with the Department of Wildlife and Fisheries. Contact person for the Department will be Mike Windham at (504)284-5268.

Additionally, the Department will require a minimum bonus of \$350.00 per acre and a minimum royalty of 25%.

NOTE: The State of Louisiana does hereby reserve, and this lease shall be subject to, the imprescriptible right of surface use in the nature of a servitude in favor of the Department of Natural Resources, including its Offices and Commissions, for the sole purpose of implementing, constructing, servicing and maintaining approved coastal zone management and/or restoration projects. Utilization of any and all rights derived under this lease by the mineral lessee, its agents, successors or assigns, shall not interfere with nor hinder the reasonable surface use by the Department of Natural Resources, its Offices or Commissions, as herein above reserved.

NOTE: This tract is located in an area designated by the Louisiana Legislature or the Wildlife and Fisheries Commission as a Public Oyster Seed Ground, Reservation, or area of Calcasieu or Sabine Lake. Proposed projects occurring in these areas will be evaluated on a case by case basis by Louisiana Department of Wildlife & Fisheries. Modifications to proposed project features including, but not limited to, access routes, well sites, flowlines, and appurtenant structures maybe required by the Louisiana Department of Wildlife and Fisheries. In addition, compensatory mitigation will be required to offset unavoidable habitat impacts.

Bidder	Cash Payment	Price/Acre	Rental	Oil	Gas	Other

Applicant: LESLIE M. COOPER

Legend

- 13070029
- Wildlife
- Active_Leases
- Counties

TERREBONNE PARISH

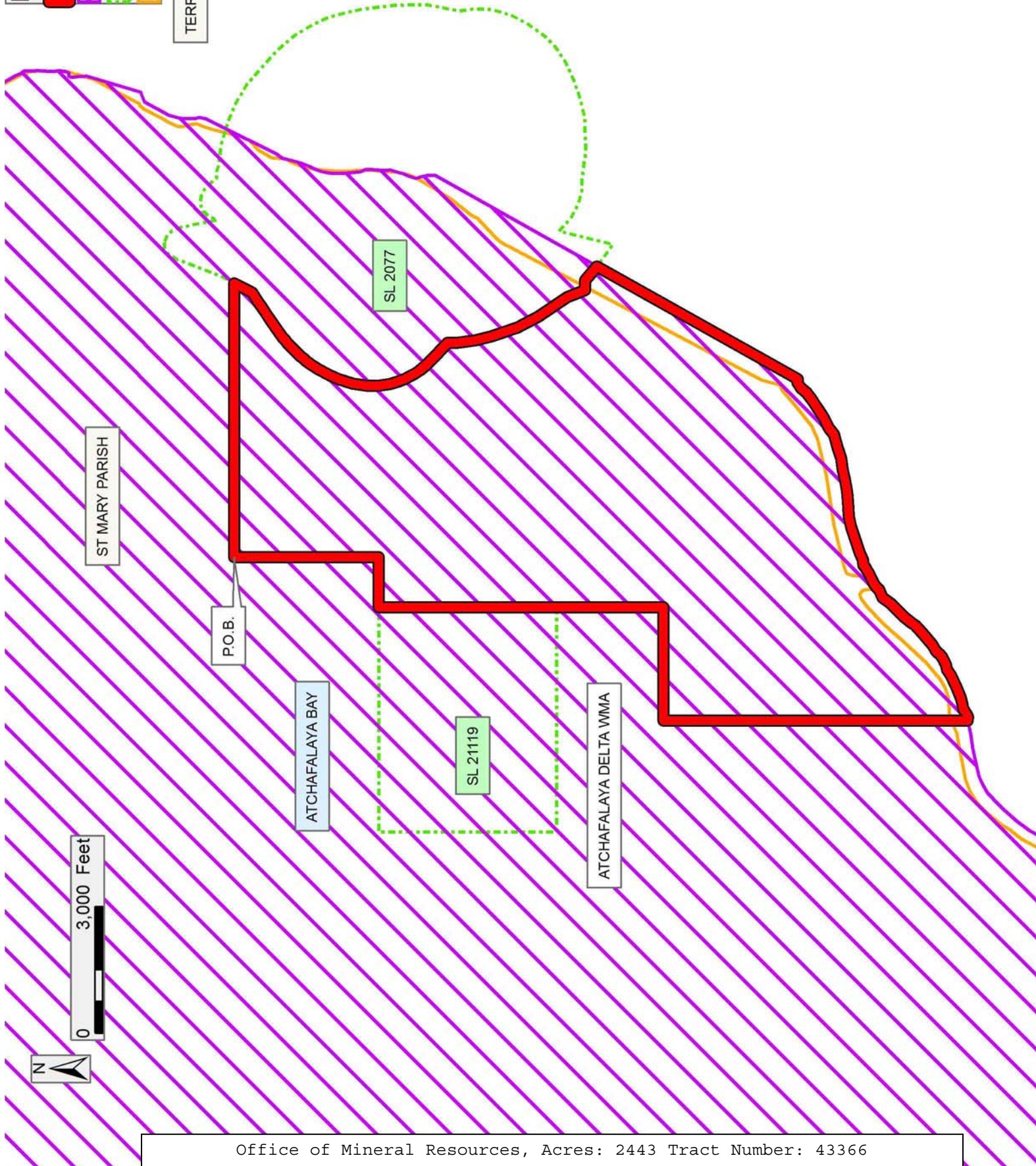

TRACT 43367 - St. Mary Parish, Louisiana

A portion of all lands located above the mean high water mark, together with lands now or formerly constituting the beds and bottoms of any water body of whatever description or nature belonging to the State of Louisiana which is now located within the boundaries of the Atchafalaya Delta Wildlife Management Area and not presently under mineral lease by the State of Louisiana on July 10, 2013, and more particularly located as follows: Beginning at a point within the Atchafalaya Delta Wildlife Management Area, having Coordinates of X = 1,966,185.41 and Y = 268,649.00; thence East 1,175.54 feet to a point being the Southwest corner of State Lease No. 21024 having Coordinates of X = 1,967,360.95 and Y = 268,649.00; thence East 7,555.56 feet along the Southern boundary of said State Lease No. 21024 to its Southeastern corner having Coordinates of X = 1,974,916.51 and Y = 268,649.00; thence continue East 1,845.49 feet to a point on the West boundary of State Lease No. 20690 having Coordinates of X = 1,976,762.00 and Y = 268,649.00; thence South 3,130.89 feet along the West boundary of said State Lease No. 20690 to its Southwest corner, also being the Northwest corner of State Lease No. 20693 having Coordinates of X = 1,976,762.00 and Y = 265,518.11; thence West 1,510.00 feet to a point having Coordinates of X = 1,975,252.00 and Y = 265,518.11; thence South 7,386.11 feet to a point having Coordinates of X = 1,975,252.00 and Y = 258,132.00; thence West 8,014.59 feet to a point on the Northeasterly boundary of State Lease No. 20694 having Coordinates of X = 1,967,237.41 and Y = 258,132.00; thence North 5,568.00 feet to a point having Coordinates of X = 1,967,237.41 and Y = 263,700.00; thence West 1,052.00 feet to a point having Coordinates of X = 1,966,185.41 and Y = 263,700.00; thence North 4,949.00 feet to the point of beginning, **LESS AND EXCEPT** IN ITS ENTIRETY, State Lease No. 21122 fully described as follows: Beginning at a point within the Atchafalaya Delta Wildlife Management Area, having Coordinates of X = 1,966,185.41 and Y = 268,649.00; thence South 44 degrees 42 minutes 23 seconds East 5,674.11 feet to the point of beginning of said State Lease No. 21122 having Coordinates of X = 1,970,177.00 and Y = 264,616.30; then North 32 degrees 23 minutes 28 seconds East 1,338.45 feet to a point having Coordinates of X = 1,970,894.00 and Y = 265,746.50; thence North 66 degrees 44 minutes 06 seconds East 974.22 feet to a point having Coordinates of X = 1,971,789.00 and Y = 266,131.30; thence South 73 degrees 03 minutes 06 seconds East 594.83 feet to a point having Coordinates of X = 1,972,358.00 and Y = 265,957.90; thence South 44 degrees 40 minutes 09 seconds East 1,285.90 feet to a point having Coordinates of X = 1,973,262.00 and Y = 265,043.40; thence South 00 degrees 59 minutes 41 seconds East 921.64 feet to a point having Coordinates of X = 1,973,278.00 and Y = 264,121.90; thence South 39 degrees 53 minutes 17 seconds West 977.72 feet to a point having Coordinates of X = 1,972,651.00 and Y = 263,371.70; thence North 49 degrees 01 minutes 14 seconds West 1,288.83 feet to a point having Coordinates of X = 1,971,678.00 and Y = 264,216.90; thence North 75 degrees 05 minutes 58 seconds West 1,553.23 feet to the point of beginning, containing approximately 111.23 acres; containing approximately **2,051.84 acres**, all as more particularly outlined on a plat

on file in the Office of Mineral Resources, Department of Natural Resources. All bearings, distances and coordinates are based on Louisiana Coordinate System of 1927, (South Zone).

NOTE: The above description of the Tract nominated for lease has been provided and corrected, where required, exclusively by the nomination party. Any mineral lease selected from this Tract and awarded by the Louisiana State Mineral and Energy Board shall be without warranty of any kind, either express, implied, or statutory, including, but not limited to, the implied warranties of merchantability and fitness for a particular purpose. Should the mineral lease awarded by the Louisiana State Mineral and Energy Board be subsequently modified, cancelled or abrogated due to the existence of conflicting leases, operating agreements, private claims or other future obligations or conditions which may affect all or any portion of the leased Tract, it shall not relieve the Lessee of the obligation to pay any bonus due thereon to the Louisiana State Mineral and Energy Board, nor shall the Louisiana State Mineral and Energy Board be obligated to refund any consideration paid by the Lessor prior to such modification, cancellation, or abrogation, including, but not limited to, bonuses, rentals and royalties.

NOTE: The mineral lease is located in the Atchafalaya Delta WMA under the jurisdiction of the Louisiana Department of Wildlife and Fisheries which has promulgated rules and regulations for the protection of game and wildlife on the aforesaid Tract and, therefore, shall be subject to said rules and regulations, a copy of which shall be attached to the mineral leases. In addition to the specific rules and regulations applicable, the following shall apply regarding operations under this mineral lease:

- No activities will be allowed without written authorization of the Louisiana Department of Wildlife and Fisheries.
- Proposed projects will be evaluated on a case by case basis. Modifications to proposed project features including but not limited to access routes, spoil placement, well sites, flowlines and appurtenant structures may be required by the Department of Wildlife and Fisheries.
- Compliance with the Atchafalaya Delta WMA regulations will be required unless otherwise specified by the Department of Wildlife and Fisheries.
- Compensatory mitigation will be required to offset unavoidable wetland impacts.
- Compensation and/or oyster seed ground surveys may be required by the Department for potential impacts to productive oyster seed grounds located within the management area.
- Removal of all structures, facilities and equipment will be required within 120 days of abandonment unless otherwise agreed to in writing by the Louisiana Department of Wildlife and Fisheries.

- No activities will be allowed during the hunting season unless approved by the Department.
- This tract is located within the emerging Atchafalaya Delta. No activities will be allowed on emergent islands, sub aerial mudflats or vegetated wetlands. Drilling will be restricted to passes and open water bays. The Louisiana Department of Wildlife and Fisheries (LDWF) shall have discretion to determine access routes. In the event that LDWF approves of dredging for access LDWF shall have discretion to require hydraulic or spray dredging.
- Prior to submitting application for wetland permits to Federal and State permitting agencies the leaseholder shall coordinate project details with the Department of Wildlife and Fisheries. Contact person for the Department will be Mike Windham at (504)284-5268.

Additionally, the Department will require a minimum bonus of \$350.00 per acre and a minimum royalty of 25%.

NOTE: The above described tract may be in the vicinity of existing shell reefs where drilling and dredging operations must be conducted in strict conformity with the regulations adopted by the Louisiana Department of Wildlife and Fisheries and/or the U.S. Corps of Engineers, U.S. Army.





NOTE: The State of Louisiana does hereby reserve, and this lease shall be subject to, the imprescriptible right of surface use in the nature of a servitude in favor of the Department of Natural Resources, including its Offices and Commissions, for the sole purpose of implementing, constructing, servicing and maintaining approved coastal zone management and/or restoration projects. Utilization of any and all rights derived under this lease by the mineral lessee, its agents, successors or assigns, shall not interfere with nor hinder the reasonable surface use by the Department of Natural Resources, its Offices or Commissions, as herein above reserved.

NOTE: This tract is located in an area designated by the Louisiana Legislature or the Wildlife and Fisheries Commission as a Public Oyster Seed Ground, Reservation, or area of Calcasieu or Sabine Lake. Proposed projects occurring in these areas will be evaluated on a case by case basis by Louisiana Department of Wildlife & Fisheries. Modifications to proposed project features including, but not limited to, access routes, well sites, flowlines, and appurtenant structures maybe required by the Louisiana Department of Wildlife and Fisheries. In addition, compensatory mitigation will be required to offset unavoidable habitat impacts.

Applicant: LESLIE M. COOPER

Bidder	Cash Payment	Price/Acre	Rental	Oil	Gas	Other

Legend

-  13070031
-  Wildlife
-  Blocks
-  Active_Leases

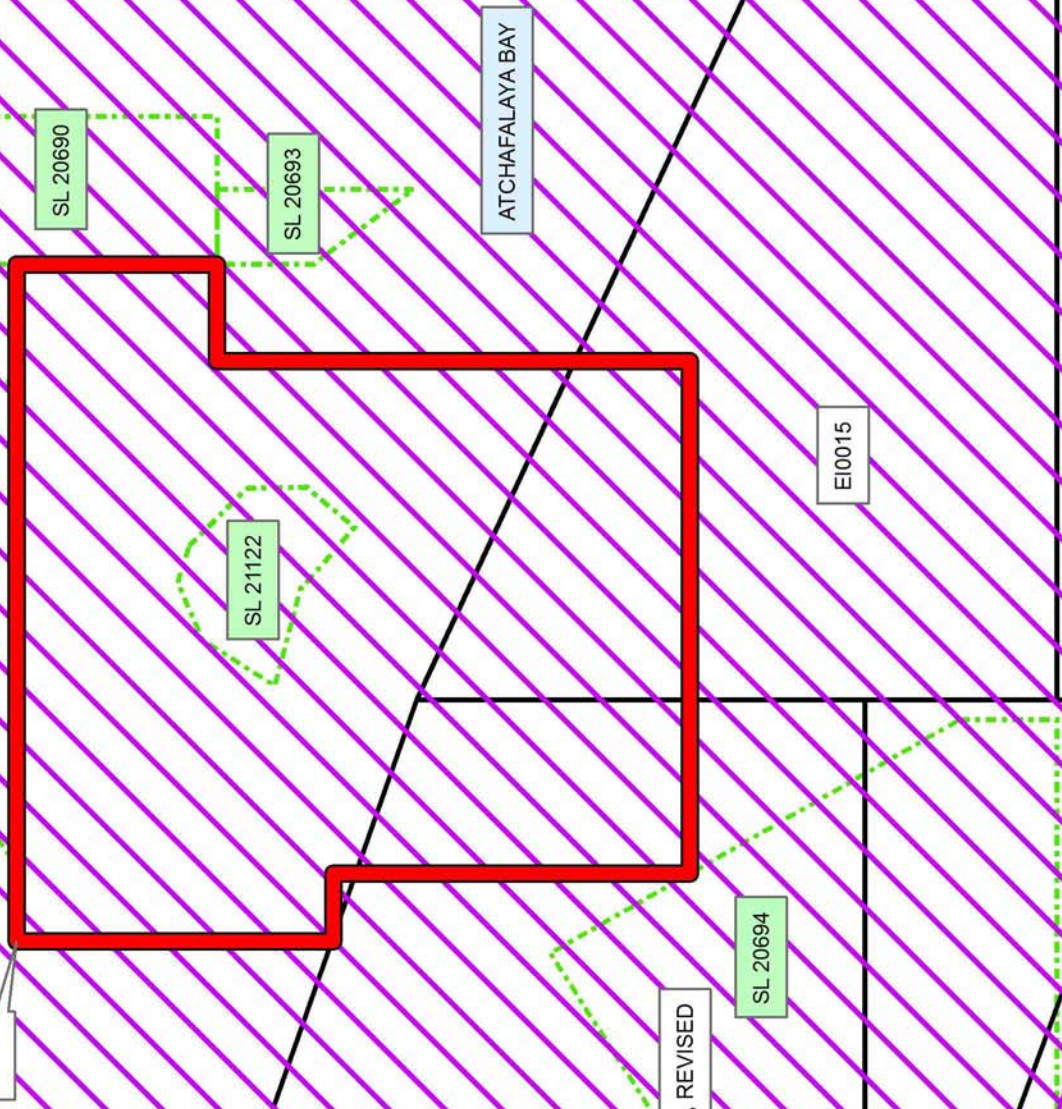
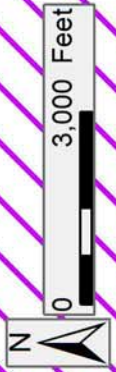

TRACT 43368 - St. Mary Parish, Louisiana

A portion of all lands located above the mean high water mark, together with lands now or formerly constituting the beds and bottoms of any water body of whatever description or nature belonging to the State of Louisiana which is now located within the boundaries of the Atchafalaya Delta Wildlife Management Area and not presently under mineral lease by the State of Louisiana on July 10, 2013, and more particularly located as follows: Beginning at a point within the Atchafalaya Delta Wildlife Management Area, also located on the East boundary of State Lease No. 20528 having Coordinates of X = 1,957,900.62 and Y = 268,649.00; thence East 8,284.79 feet to a point having Coordinates of X = 1,966,185.41 and Y = 268,649.00; thence South 4,949.00 feet to a point having Coordinates of X = 1,966,185.41 and Y = 263,700.00; thence West 12,885.41 feet to the Northeast corner of State Lease No. 20223 and the Southeast corner of State Lease No. 21120 having Coordinates of X = 1,953,300.00 and Y = 263,700.00; thence along the boundaries of said State Lease No. 21120 the following courses: North 56 degrees 43 minutes 13 seconds East 619.62 feet to a point having Coordinates of X = 1,953,818.00 and Y = 264,040.00, North 49 degrees 52 minutes 07 seconds East 823.99 feet to a point having Coordinates of X = 1,954,448.00 and Y = 264,571.10, North 28 degrees 04 minutes 57 seconds East 1,070.65 feet to a point having Coordinates of X = 1,954,952.00 and Y = 265,515.70, North 12 degrees 19 minutes 04 seconds East 1,307.81 feet to a point having Coordinates of X = 1,955,231.00 and Y = 266,793.40, South 70 degrees 17 minutes 17 seconds West 1,884.43 feet to a point having Coordinates of X = 1,953,457.00 and Y = 266,157.80, South 46 degrees 15 minutes 02 seconds West 1,645.97 feet to a point having Coordinates of X = 1,952,268.00 and Y = 265,019.60 and South 32 degrees 34 minutes 00 seconds West 497.88 feet to its Southwest corner of and the Northwest corner of said State Lease No. 20223 having Coordinates of X = 1,952,000.00 and Y = 264,600.00; thence along the boundaries of said State Lease No. 20223 the following courses and distances: South 45 degrees 00 minutes 00 seconds West 2,404.16 feet to a corner having Coordinates of X = 1,950,300.00 and Y = 262,900.00, South 26 degrees 33 minutes 54 seconds East 447.21 feet to a corner having Coordinates of X = 1,950,500.00 and Y = 262,500.00 and South 41 degrees 25 minutes 25 seconds West 1,200.66 feet to the Northeast corner of State Lease No. 21121 having Coordinates of X = 1,949,705.62 and Y = 261,599.70; thence North 80 degrees 32 minutes 46 seconds West 353.56 feet along the North boundary of said State Lease No. 21121 to its Northwest corner and a point on the north boundary of State Lease No. 21123 having Coordinates of X = 1,949,356.86 and Y = 261,657.77; thence North 81 degrees 38 minutes 20 seconds West 94.53 feet along the north boundary of said State Lease No. 21123 to the most eastern tip of State Lease No. 20532 having Coordinates of X = 1,949,263.33 and Y = 261,671.52; thence North 38 degrees 07 minutes 53 seconds West 2,519.35 feet along the boundary of said State Lease No. 20532 to the Southwest corner of State Lease No. 20753 having Coordinates of X = 1,947,707.72 and Y = 263,653.24; thence along the boundaries of said State Lease No. 20753 the following courses: North 61 degrees 58 minutes 54 seconds East 8,140.35 feet to a point having Coordinates of X = 1,954,894.00 and Y =

267,477.20 and North 10 degrees 45 minutes 42 seconds East 27.45 feet to a point located on the Southeast boundary of State Lease No. 20529 having Coordinates of X = 1,954,899.13 and Y = 267,504.16; thence North 69 degrees 07 minutes 19 seconds East 1,993.78 feet along the Southeast boundary of said State Lease No. 20529 to its Southeast corner, also being the Southwest corner of said State Lease No. 20528 having Coordinates of X = 1,956,762.00 and Y = 268,214.71; thence North 69 degrees 07 minutes 19 seconds East 1,218.63 feet along the Southeast boundary of said State Lease No. 20528 to the point of beginning, containing approximately **1,503.17 acres**, all as more particularly outlined on a plat on file in the Office of Mineral Resources, Department of Natural Resources. All bearings, distances and coordinates are based on Louisiana Coordinate System of 1927, (South Zone).

NOTE: The above description of the Tract nominated for lease has been provided and corrected, where required, exclusively by the nomination party. Any mineral lease selected from this Tract and awarded by the Louisiana State Mineral and Energy Board shall be without warranty of any kind, either express, implied, or statutory, including, but not limited to, the implied warranties of merchantability and fitness for a particular purpose. Should the mineral lease awarded by the Louisiana State Mineral and Energy Board be subsequently modified, cancelled or abrogated due to the existence of conflicting leases, operating agreements, private claims or other future obligations or conditions which may affect all or any portion of the leased Tract, it shall not relieve the Lessee of the obligation to pay any bonus due thereon to the Louisiana State Mineral and Energy Board, nor shall the Louisiana State Mineral and Energy Board be obligated to refund any consideration paid by the Lessor prior to such modification, cancellation, or abrogation, including, but not limited to, bonuses, rentals and royalties.

NOTE: The mineral lease is located in the Atchafalaya Delta WMA under the jurisdiction of the Louisiana Department of Wildlife and Fisheries which has promulgated rules and regulations for the protection of game and wildlife on the aforesaid Tract and, therefore, shall be subject to said rules and regulations, a copy of which shall be attached to the mineral leases. In addition to the specific rules and regulations applicable, the following shall apply regarding operations under this mineral lease:

- No activities will be allowed without written authorization of the Louisiana Department of Wildlife and Fisheries.
- Proposed projects will be evaluated on a case by case basis. Modifications to proposed project features including but not limited to access routes, spoil placement, well sites, flowlines and appurtenant structures may be required by the Department of Wildlife and Fisheries.

- Compliance with the Atchafalaya Delta WMA regulations will be required unless otherwise specified by the Department of Wildlife and Fisheries.
- Compensatory mitigation will be required to offset unavoidable wetland impacts.
- Compensation and/or oyster seed ground surveys may be required by the Department for potential impacts to productive oyster seed grounds located within the management area.
- Removal of all structures, facilities and equipment will be required within 120 days of abandonment unless otherwise agreed to in writing by the Louisiana Department of Wildlife and Fisheries.
- No activities will be allowed during the hunting season unless approved by the Department.
- This tract is located within the emerging Atchafalaya Delta. No activities will be allowed on emergent islands, sub aerial mudflats or vegetated wetlands. Drilling will be restricted to passes and open water bays. The Louisiana Department of Wildlife and Fisheries (LDWF) shall have discretion to determine access routes. In the event that LDWF approves of dredging for access LDWF shall have discretion to require hydraulic or spray dredging.
- Prior to submitting application for wetland permits to Federal and State permitting agencies the leaseholder shall coordinate project details with the Department of Wildlife and Fisheries. Contact person for the Department will be Mike Windham at (504)284-5268.

Additionally, the Department will require a minimum bonus of \$350.00 per acre and a minimum royalty of 25%.

NOTE: The above described tract may be in the vicinity of existing shell reefs where drilling and dredging operations must be conducted in strict conformity with the regulations adopted by the Louisiana Department of Wildlife and Fisheries and/or the U.S. Corps of Engineers, U.S. Army.

NOTE: The State of Louisiana does hereby reserve, and this lease shall be subject to, the imprescriptible right of surface use in the nature of a servitude in favor of the Department of Natural Resources, including its Offices and Commissions, for the sole purpose of implementing, constructing, servicing and maintaining approved coastal zone management and/or restoration projects. Utilization of any and all rights derived under this lease by the mineral lessee, its agents, successors or assigns, shall not interfere with nor hinder the reasonable surface use by the Department of Natural Resources, its Offices or Commissions, as herein above reserved.

NOTE: This tract is located in an area designated by the Louisiana Legislature or the Wildlife and Fisheries Commission as a Public Oyster Seed Ground, Reservation, or area of Calcasieu or Sabine Lake. Proposed

projects occurring in these areas will be evaluated on a case by case basis by Louisiana Department of Wildlife & Fisheries. Modifications to proposed project features including, but not limited to, access routes, well sites, flowlines, and appurtenant structures maybe required by the Louisiana Department of Wildlife and Fisheries. In addition, compensatory mitigation will be required to offset unavoidable habitat impacts.

Applicant: LESLIE M. COOPER

Bidder	Cash Payment	Price/Acre	Rental	Oil	Gas	Other

Legend

- 13070030
- Wildlife
- Blocks
- Active_Leases

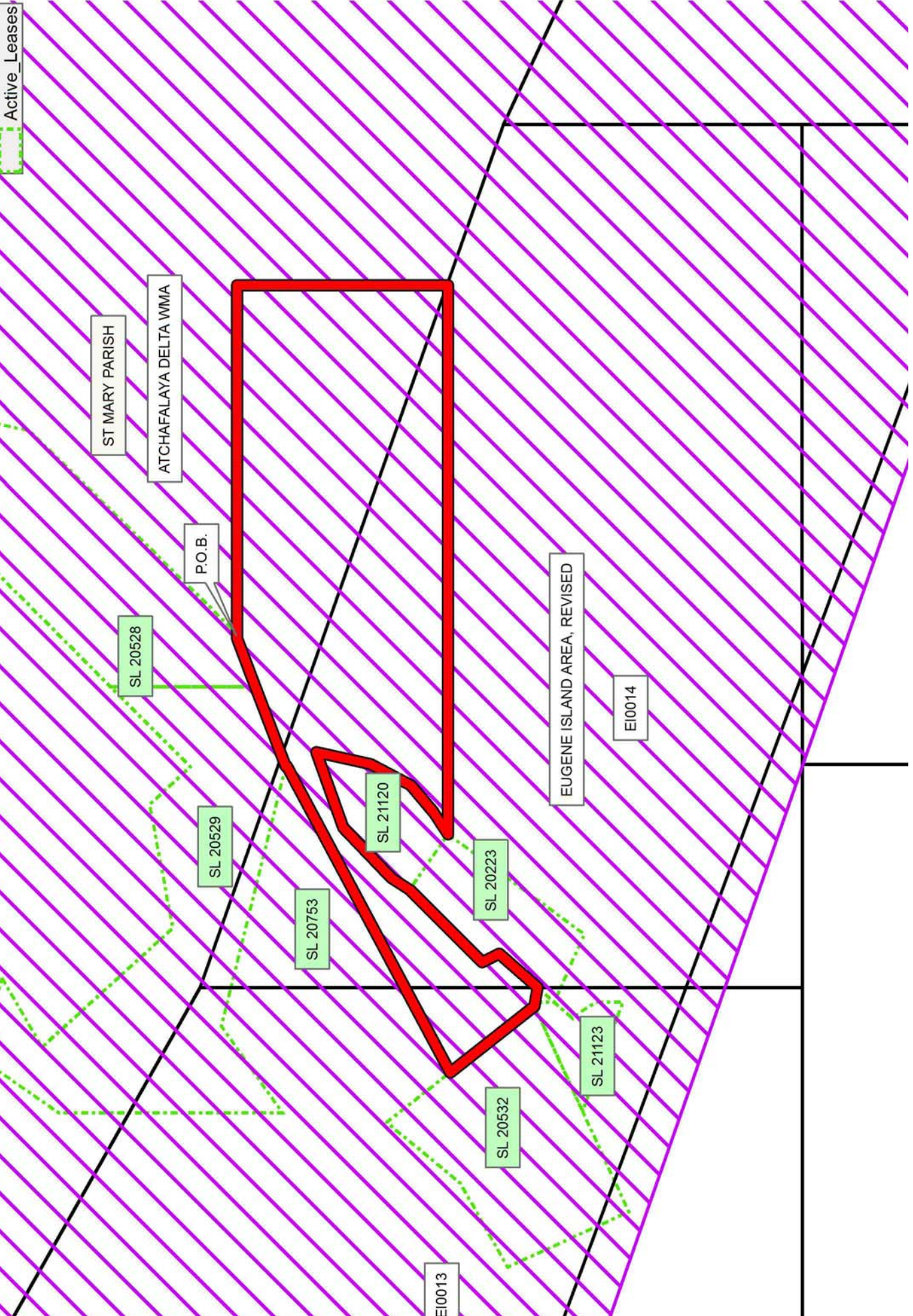
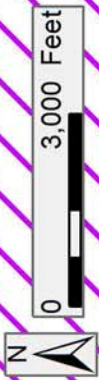

TRACT 43369 - St. Mary Parish, Louisiana

A portion of all lands located above the mean high water mark, together with lands now or formerly constituting the beds and bottoms of any water body of whatever description or nature belonging to the State of Louisiana which is now located within the boundaries of the Atchafalaya Delta Wildlife Management Area and not presently under mineral lease by the State of Louisiana on July 10, 2013, and more particularly located as follows: Beginning at a point within the Atchafalaya Delta Wildlife Management Area, and a point on the Eastern boundary of State Lease No. 20255 having Coordinates of X = 1,986,762.00 and Y = 267,322.00; thence East 10,846.00 feet to a point having Coordinates of X = 1,997,608.00 and Y = 267,322.00; thence South 7,378.00 feet to a point having Coordinates of X = 1,997,608.00 and Y = 259,944.00; thence West 10,846.00 feet to a point having Coordinates of X = 1,986,762.00 and Y = 259,944.00; thence North 5,934.00 feet to a point being the Southeast corner of said State Lease No. 20255 having Coordinates of X = 1,986,762.00 and Y = 265,878.00; thence North 1,444.00 feet along the Eastern boundary of said State Lease No. 20255 to the point of beginning, containing approximately **1,837.05 acres**, all as more particularly outlined on a plat on file in the Office of Mineral Resources, Department of Natural Resources. All bearings, distances and coordinates are based on Louisiana Coordinate System of 1927, (South Zone).

NOTE: The above description of the Tract nominated for lease has been provided and corrected, where required, exclusively by the nomination party. Any mineral lease selected from this Tract and awarded by the Louisiana State Mineral and Energy Board shall be without warranty of any kind, either express, implied, or statutory, including, but not limited to, the implied warranties of merchantability and fitness for a particular purpose. Should the mineral lease awarded by the Louisiana State Mineral and Energy Board be subsequently modified, cancelled or abrogated due to the existence of conflicting leases, operating agreements, private claims or other future obligations or conditions which may affect all or any portion of the leased Tract, it shall not relieve the Lessee of the obligation to pay any bonus due thereon to the Louisiana State Mineral and Energy Board, nor shall the Louisiana State Mineral and Energy Board be obligated to refund any consideration paid by the Lessor prior to such modification, cancellation, or abrogation, including, but not limited to, bonuses, rentals and royalties.

NOTE: The mineral lease is located in the Atchafalaya Delta WMA under the jurisdiction of the Louisiana Department of Wildlife and Fisheries which has promulgated rules and regulations for the protection of game and wildlife on the aforesaid Tract and, therefore, shall be subject to said rules and regulations, a copy of which shall be attached to the mineral leases. In addition to the specific rules and regulations applicable, the following shall apply regarding operations under this mineral lease:

- No activities will be allowed without written authorization of the Louisiana Department of Wildlife and Fisheries.
- Proposed projects will be evaluated on a case by case basis. Modifications to proposed project features including but not limited to access routes, spoil placement, well sites, flowlines and appurtenant structures may be required by the Department of Wildlife and Fisheries.
- Compliance with the Atchafalaya Delta WMA regulations will be required unless otherwise specified by the Department of Wildlife and Fisheries.
- Compensatory mitigation will be required to offset unavoidable wetland impacts.
- Compensation and/or oyster seed ground surveys may be required by the Department for potential impacts to productive oyster seed grounds located within the management area.
- Removal of all structures, facilities and equipment will be required within 120 days of abandonment unless otherwise agreed to in writing by the Louisiana Department of Wildlife and Fisheries.
- No activities will be allowed during the hunting season unless approved by the Department.
- This tract is located within the emerging Atchafalaya Delta. No activities will be allowed on emergent islands, sub aerial mudflats or vegetated wetlands. Drilling will be restricted to passes and open water bays. The Louisiana Department of Wildlife and Fisheries (LDWF) shall have discretion to determine access routes. In the event that LDWF approves of dredging for access LDWF shall have discretion to require hydraulic or spray dredging.
- Prior to submitting application for wetland permits to Federal and State permitting agencies the leaseholder shall coordinate project details with the Department of Wildlife and Fisheries. Contact person for the Department will be Mike Windham at (504)284-5268.

Additionally, the Department will require a minimum bonus of \$350.00 per acre and a minimum royalty of 25%.

NOTE: The above described tract may be in the vicinity of existing shell reefs where drilling and dredging operations must be conducted in strict conformity with the regulations adopted by the Louisiana Department of Wildlife and Fisheries and/or the U.S. Corps of Engineers, U.S. Army.

NOTE: The State of Louisiana does hereby reserve, and this lease shall be subject to, the imprescriptible right of surface use in the nature of a servitude in favor of the Department of Natural Resources, including its Offices and Commissions, for the sole purpose of implementing, constructing, servicing and maintaining approved coastal zone management and/or restoration projects. Utilization of any and all rights derived

under this lease by the mineral lessee, its agents, successors or assigns, shall not interfere with nor hinder the reasonable surface use by the Department of Natural Resources, its Offices or Commissions, as herein above reserved.

NOTE: This tract is located in an area designated by the Louisiana Legislature or the Wildlife and Fisheries Commission as a Public Oyster Seed Ground, Reservation, or area of Calcasieu or Sabine Lake. Proposed projects occurring in these areas will be evaluated on a case by case basis by Louisiana Department of Wildlife & Fisheries. Modifications to proposed project features including, but not limited to, access routes, well sites, flowlines, and appurtenant structures maybe required by the Louisiana Department of Wildlife and Fisheries. In addition, compensatory mitigation will be required to offset unavoidable habitat impacts.

Applicant: LESLIE M. COOPER

Bidder	Cash Payment	Price/Acre	Rental	Oil	Gas	Other

Legend

- 13070032
- Wildlife
- Active_Leases

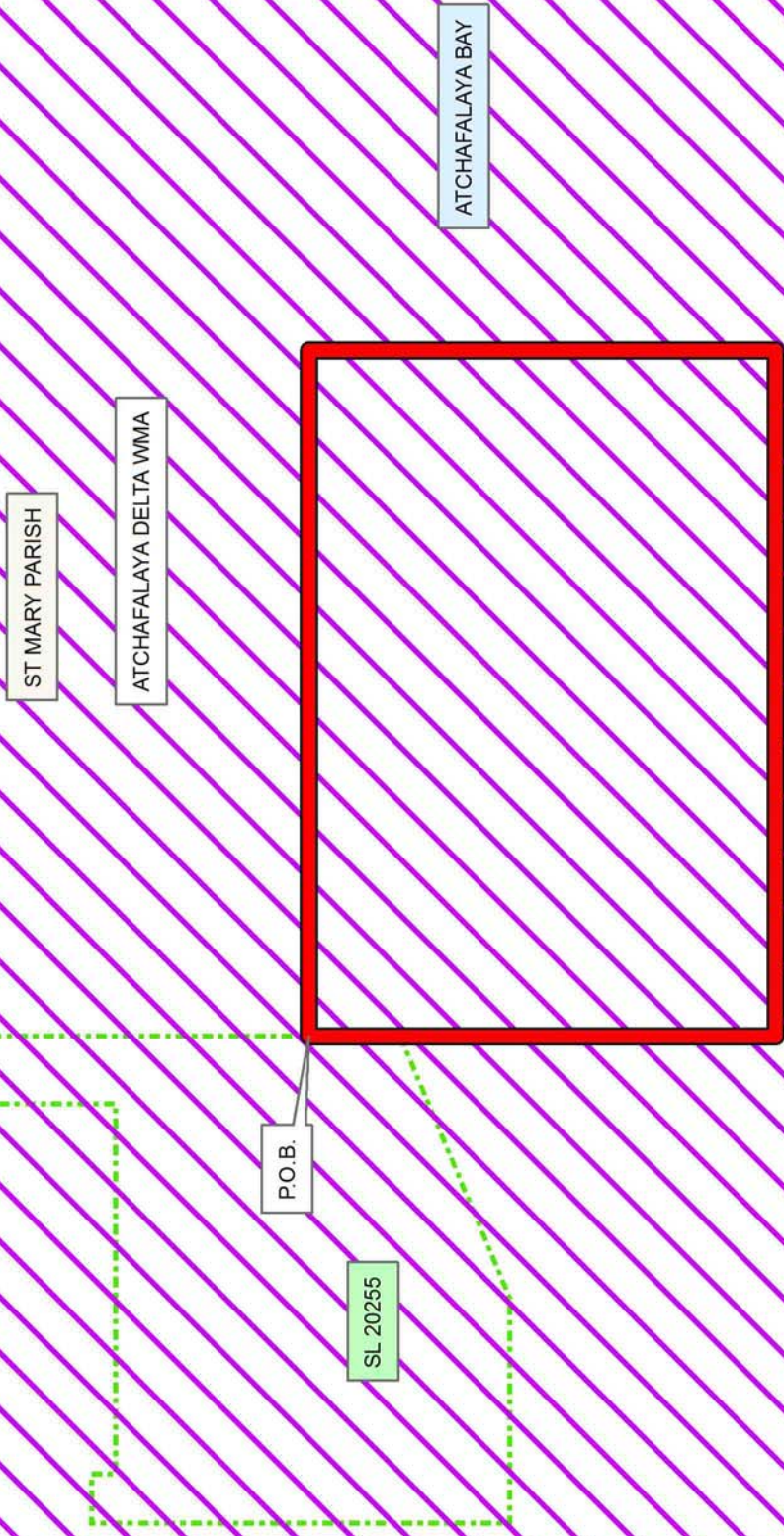

TRACT 43370 - St. Mary Parish, Louisiana

A portion of all lands located above the mean high water mark, together with lands now or formerly constituting the beds and bottoms of any water body of whatever description or nature belonging to the State of Louisiana which is now located within the boundaries of the Atchafalaya Delta Wildlife Management Area and not presently under mineral lease by the State of Louisiana on July 10, 2013, and more particularly located as follows: Beginning at a point within the Atchafalaya Delta Wildlife Management Area, having Coordinates of X = 1,975,252.00 and Y = 265,518.11; thence East 1,510.00 feet to a point being the Southwest corner of State Lease No. 20690 having Coordinates of X = 1,976,762.00 and Y = 265,518.11, said point also being the Northwest corner of State Lease No. 20693; thence along the West boundary of said State Lease No. 20693 the following courses: South 1,509.48 feet to a corner having Coordinates of X = 1,976,762.00 and Y = 264,008.63 and South 36 degrees 53 minutes 34 seconds East 1,952.75 feet to its Southeast corner, also being a point on the West boundary of State Lease No. 20692, having Coordinates of X = 1,977,934.27 and Y = 262,446.90; thence along the boundary of said State Lease No. 20692 the following courses: South 36 degrees 53 minutes 34 seconds East 814.12 feet to a corner having Coordinates of X = 1,978,423.00 and Y = 261,795.80, South 87 degrees 42 minutes 46 seconds East 1,378.10 feet to a corner having Coordinates of X = 1,979,800.00 and Y = 261,740.80 and North 49 degrees 37 minutes 19 seconds East 3,718.89 feet to its Northeast corner, also being a Southern corner of State Lease No. 20255 having Coordinates of X = 1,982,633.00 and Y = 264,150.00; thence North 67 degrees 17 minutes 26 seconds East 4,476.00 feet along the South boundary of said State Lease No. 20255 to its Southeast corner having Coordinates of X = 1,986,762.00 and Y = 265,878.00; thence South 5,934.00 feet to a point having Coordinates of X = 1,986,762.00 and Y = 259,944.00; thence East 6,970.00 feet to a point having Coordinates of X = 1,993,732.00 and Y = 259,944.00; thence South 3,017.00 feet to a point having Coordinates of X = 1,993,732.00 and Y = 256,927.00; thence West 18,480.00 feet to a point having Coordinates of X = 1,975,252.00 and Y = 256,927.00; thence North 8,591.11 feet to the Point of Beginning, containing approximately **2,319.42 acres**, all as more particularly outlined on a plat on file in the Office of Mineral Resources, Department of Natural Resources. All bearings, distances and coordinates are based on Louisiana Coordinate System of 1927, (South Zone).

NOTE: The above description of the Tract nominated for lease has been provided and corrected, where required, exclusively by the nomination party. Any mineral lease selected from this Tract and awarded by the Louisiana State Mineral and Energy Board shall be without warranty of any kind, either express, implied, or statutory, including, but not limited to, the implied warranties of merchantability and fitness for a particular purpose. Should the mineral lease awarded by the Louisiana State Mineral and Energy Board be subsequently modified, cancelled or abrogated due to the existence of conflicting leases, operating agreements, private claims or other future obligations or conditions which may affect all or any

portion of the leased Tract, it shall not relieve the Lessee of the obligation to pay any bonus due thereon to the Louisiana State Mineral and Energy Board, nor shall the Louisiana State Mineral and Energy Board be obligated to refund any consideration paid by the Lessor prior to such modification, cancellation, or abrogation, including, but not limited to, bonuses, rentals and royalties.

NOTE: The mineral lease is located in the Atchafalaya Delta WMA under the jurisdiction of the Louisiana Department of Wildlife and Fisheries which has promulgated rules and regulations for the protection of game and wildlife on the aforesaid Tract and, therefore, shall be subject to said rules and regulations, a copy of which shall be attached to the mineral leases. In addition to the specific rules and regulations applicable, the following shall apply regarding operations under this mineral lease:

- No activities will be allowed without written authorization of the Louisiana Department of Wildlife and Fisheries.
- Proposed projects will be evaluated on a case by case basis. Modifications to proposed project features including but not limited to access routes, spoil placement, well sites, flowlines and appurtenant structures may be required by the Department of Wildlife and Fisheries.
- Compliance with the Atchafalaya Delta WMA regulations will be required unless otherwise specified by the Department of Wildlife and Fisheries.
- Compensatory mitigation will be required to offset unavoidable wetland impacts.
- Compensation and/or oyster seed ground surveys may be required by the Department for potential impacts to productive oyster seed grounds located within the management area.
- Removal of all structures, facilities and equipment will be required within 120 days of abandonment unless otherwise agreed to in writing by the Louisiana Department of Wildlife and Fisheries.
- No activities will be allowed during the hunting season unless approved by the Department.
- This tract is located within the emerging Atchafalaya Delta. No activities will be allowed on emergent islands, sub aerial mudflats or vegetated wetlands. Drilling will be restricted to passes and open water bays. The Louisiana Department of Wildlife and Fisheries (LDWF) shall have discretion to determine access routes. In the event that LDWF approves of dredging for access LDWF shall have discretion to require hydraulic or spray dredging.
- Prior to submitting application for wetland permits to Federal and State permitting agencies the leaseholder shall coordinate project details with the Department of Wildlife and Fisheries. Contact person for the Department will be Mike Windham at (504)284-5268.

Additionally, the Department will require a minimum bonus of \$350.00 per acre and a minimum royalty of 25%.

NOTE: The above described tract may be in the vicinity of existing shell reefs where drilling and dredging operations must be conducted in strict conformity with the regulations adopted by the Louisiana Department of Wildlife and Fisheries and/or the U.S. Corps of Engineers, U.S. Army.

NOTE: The State of Louisiana does hereby reserve, and this lease shall be subject to, the imprescriptible right of surface use in the nature of a servitude in favor of the Department of Natural Resources, including its Offices and Commissions, for the sole purpose of implementing, constructing, servicing and maintaining approved coastal zone management and/or restoration projects. Utilization of any and all rights derived under this lease by the mineral lessee, its agents, successors or assigns, shall not interfere with nor hinder the reasonable surface use by the Department of Natural Resources, its Offices or Commissions, as herein above reserved.

NOTE: This tract is located in an area designated by the Louisiana Legislature or the Wildlife and Fisheries Commission as a Public Oyster Seed Ground, Reservation, or area of Calcasieu or Sabine Lake. Proposed projects occurring in these areas will be evaluated on a case by case basis by Louisiana Department of Wildlife & Fisheries. Modifications to proposed project features including, but not limited to, access routes, well sites, flowlines, and appurtenant structures maybe required by the Louisiana Department of Wildlife and Fisheries. In addition, compensatory mitigation will be required to offset unavoidable habitat impacts.

Applicant: LESLIE M. COOPER

Bidder	Cash Payment	Price/Acre	Rental	Oil	Gas	Other

Legend

- 13070033
- Wildlife
- Blocks
- Active_Leases

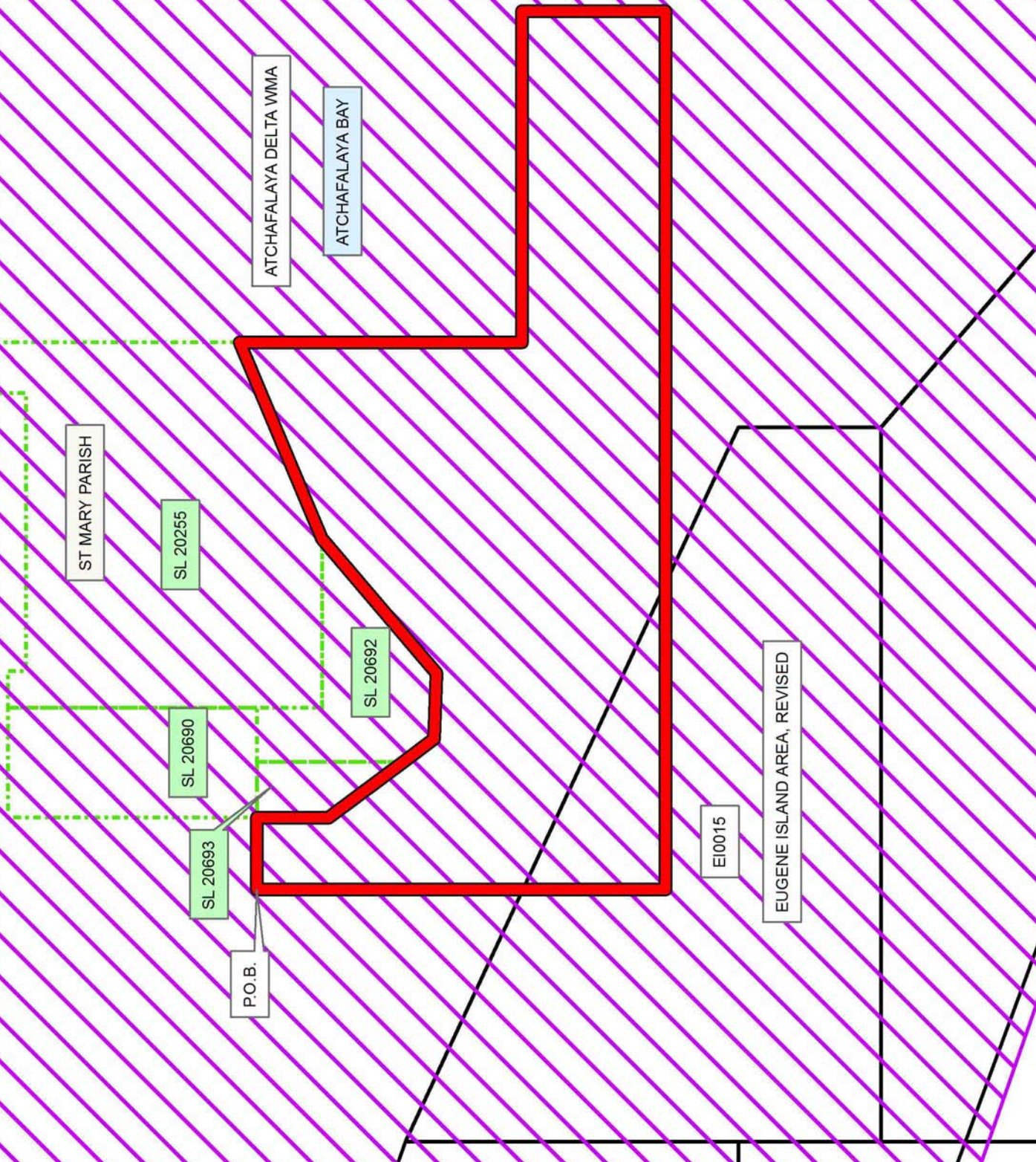

TRACT 43371 - St. Mary Parish, Louisiana

A portion of all lands located above the mean high water mark, together with lands now or formerly constituting the beds and bottoms of any water body of whatever description or nature belonging to the State of Louisiana which is now located within the boundaries of the Atchafalaya Delta Wildlife Management Area and not presently under mineral lease by the State of Louisiana on July 10, 2013, and more particularly located as follows: Beginning at a point within the Atchafalaya Delta Wildlife Management Area, also being the Northeast corner of State Lease No. 20223 having Coordinates of X = 1,953,300.00 and Y = 263,700.00; thence East 2,545.85 feet to a point having Coordinates of X = 1,955,845.85 and Y = 263,700.00; thence South 8,306.00 feet to the most West corner of the East portion of State Lease No. 1666, as amended, said corner located on the North boundary of State Lease No. 7870, as amended having Coordinates of X = 1,955,845.85 and Y = 255,394.00; thence South 80 degrees 38 minutes 33 seconds West 28.78 feet along the North boundary of said State Lease No. 7870 to its most West corner, also being a corner on the North boundary of State Lease No. 16988 having Coordinates of X = 1,955,817.45 and Y = 255,389.32; thence along the North boundary of said State Lease No. 16988 the following courses and distances: South 80 degrees 38 minutes 51 seconds West 143.07 feet to a corner having Coordinates of X = 1,955,676.28 and Y = 255,366.07 and Westerly along an arc having a radius of 6,200.00 feet and a center located at X = 1,954,689.23 and Y = 261,487.00 to a point located on the South boundary of the Atchafalaya Delta Wildlife Management Area having Coordinates of X = 1,955,127.29 and Y = 255,302.49; thence North 70 degrees 45 minutes 00 seconds West 1,667.23 feet along the said South boundary of the Atchafalaya Delta Wildlife Management Area to a point on the Northeast boundary of the West portion of said State Lease No. 1666 having Coordinates of X = 1,953,553.27 and Y = 255,852.16; thence along the Northeast and Northwest boundary of said State Lease No. 1666 the following courses and distances: North 43 degrees 37 minutes 43 seconds West 135.17 feet to a corner having Coordinates of X = 1,953,460.01 and Y = 255,950.00, North 48 degrees 00 minutes 46 seconds West 403.61 feet to a corner having Coordinates of X = 1,953,160.01 and Y = 256,220.00, North 55 degrees 04 minutes 09 seconds West 768.44 feet to a corner having Coordinates of X = 1,952,530.01 and Y = 256,660.00, North 57 degrees 50 minutes 52 seconds West 506.93 feet to a point having Coordinates of X = 1,952,100.82 and Y = 256,929.77, North 60 degrees 49 minutes 54 seconds West 631.63 feet to a corner having Coordinates of X = 1,951,549.29 and Y = 257,237.61, North 63 degrees 53 minutes 10 seconds West 255.35 feet to a corner having Coordinates of X = 1,951,320.01 and Y = 257,350.00, South 51 degrees 44 minutes 10 seconds West 147.85 feet to a point having Coordinates of X = 1,951,203.92 and Y = 257,258.44, South 51 degrees 08 minutes 48 seconds West 300.38 feet to a corner having Coordinates of X = 1,950,970.00 and Y = 257,070.00 and South 42 degrees 36 minutes 51 seconds West 324.68 feet to a point on the South boundary of the said Atchafalaya Delta Wildlife Management Area having Coordinates of X = 1,950,750.17 and Y = 256,831.06; thence North 70 degrees 45 minutes 00 seconds West 1,475.83 feet along the South boundary

of the said Atchafalaya Delta Wildlife Management Area to a point having Coordinates of X = 1,949,356.86 and Y = 257,317.63; thence North 2,280.53 feet to the Southwest corner of State Lease No. 21124 having Coordinates of X = 1,949,356.86 and Y = 259,596.52; thence South 69 degrees 39 minutes 31 seconds East 548.76 feet along the South boundary of said State Lease No. 21124 to its Southeast corner and a point on the West boundary of State Lease No. 20224 having Coordinates of X = 1,949,871.40 and Y = 259,405.77; thence along the Southwest boundary and the Southeast boundary of said State Lease No. 20224 the following courses and distances: South 32 degrees 00 minutes 19 seconds East 242.65 feet to a corner having Coordinates of X = 1,950,000.00 and Y = 259,200.00 and North 36 degrees 15 minutes 14 seconds East 1,617.81 feet to its Northeast corner, also being the Southeast corner of said State Lease No. 20223 having Coordinates of X = 1,950,956.72 and Y = 260,504.61; thence North 36 degrees 15 minutes 14 seconds East 3,962.51 feet along the East boundary of said State Lease No. 20223 to the point of beginning, containing approximately **856.18 acres**, all as more particularly outlined on a plat on file in the Office of Mineral Resources, Department of Natural Resources. All bearings, distances and coordinates are based on Louisiana Coordinate System of 1927, (South Zone).

NOTE: The above description of the Tract nominated for lease has been provided and corrected, where required, exclusively by the nomination party. Any mineral lease selected from this Tract and awarded by the Louisiana State Mineral and Energy Board shall be without warranty of any kind, either express, implied, or statutory, including, but not limited to, the implied warranties of merchantability and fitness for a particular purpose. Should the mineral lease awarded by the Louisiana State Mineral and Energy Board be subsequently modified, cancelled or abrogated due to the existence of conflicting leases, operating agreements, private claims or other future obligations or conditions which may affect all or any portion of the leased Tract, it shall not relieve the Lessee of the obligation to pay any bonus due thereon to the Louisiana State Mineral and Energy Board, nor shall the Louisiana State Mineral and Energy Board be obligated to refund any consideration paid by the Lessor prior to such modification, cancellation, or abrogation, including, but not limited to, bonuses, rentals and royalties.

NOTE: The mineral lease is located in the Atchafalaya Delta WMA under the jurisdiction of the Louisiana Department of Wildlife and Fisheries which has promulgated rules and regulations for the protection of game and wildlife on the aforesaid Tract and, therefore, shall be subject to said rules and regulations, a copy of which shall be attached to the mineral leases. In addition to the specific rules and regulations applicable, the following shall apply regarding operations under this mineral lease:

- No activities will be allowed without written authorization of the Louisiana Department of Wildlife and Fisheries.

- Proposed projects will be evaluated on a case by case basis. Modifications to proposed project features including but not limited to access routes, spoil placement, well sites, flowlines and appurtenant structures may be required by the Department of Wildlife and Fisheries.
- Compliance with the Atchafalaya Delta WMA regulations will be required unless otherwise specified by the Department of Wildlife and Fisheries.
- Compensatory mitigation will be required to offset unavoidable wetland impacts.
- Compensation and/or oyster seed ground surveys may be required by the Department for potential impacts to productive oyster seed grounds located within the management area.
- Removal of all structures, facilities and equipment will be required within 120 days of abandonment unless otherwise agreed to in writing by the Louisiana Department of Wildlife and Fisheries.
- No activities will be allowed during the hunting season unless approved by the Department.
- This tract is located within the emerging Atchafalaya Delta. No activities will be allowed on emergent islands, sub aerial mudflats or vegetated wetlands. Drilling will be restricted to passes and open water bays. The Louisiana Department of Wildlife and Fisheries (LDWF) shall have discretion to determine access routes. In the event that LDWF approves of dredging for access LDWF shall have discretion to require hydraulic or spray dredging.
- Prior to submitting application for wetland permits to Federal and State permitting agencies the leaseholder shall coordinate project details with the Department of Wildlife and Fisheries. Contact person for the Department will be Mike Windham at (504)284-5268.

Additionally, the Department will require a minimum bonus of \$350.00 per acre and a minimum royalty of 25%.

NOTE: The above described tract may be in the vicinity of existing shell reefs where drilling and dredging operations must be conducted in strict conformity with the regulations adopted by the Louisiana Department of Wildlife and Fisheries and/or the U.S. Corps of Engineers, U.S. Army.

NOTE: The State of Louisiana does hereby reserve, and this lease shall be subject to, the imprescriptible right of surface use in the nature of a servitude in favor of the Department of Natural Resources, including its Offices and Commissions, for the sole purpose of implementing, constructing, servicing and maintaining approved coastal zone management and/or restoration projects. Utilization of any and all rights derived under this lease by the mineral lessee, its agents, successors or assigns, shall not interfere with nor hinder the reasonable surface use by the

Department of Natural Resources, its Offices or Commissions, as herein above reserved.

NOTE: This tract is located in an area designated by the Louisiana Legislature or the Wildlife and Fisheries Commission as a Public Oyster Seed Ground, Reservation, or area of Calcasieu or Sabine Lake. Proposed projects occurring in these areas will be evaluated on a case by case basis by Louisiana Department of Wildlife & Fisheries. Modifications to proposed project features including, but not limited to, access routes, well sites, flowlines, and appurtenant structures maybe required by the Louisiana Department of Wildlife and Fisheries. In addition, compensatory mitigation will be required to offset unavoidable habitat impacts.

Applicant: LESLIE M. COOPER

Bidder	Cash Payment	Price/Acre	Rental	Oil	Gas	Other

Legend

- 13070036
- Wildlife
- Blocks
- Active_Leases

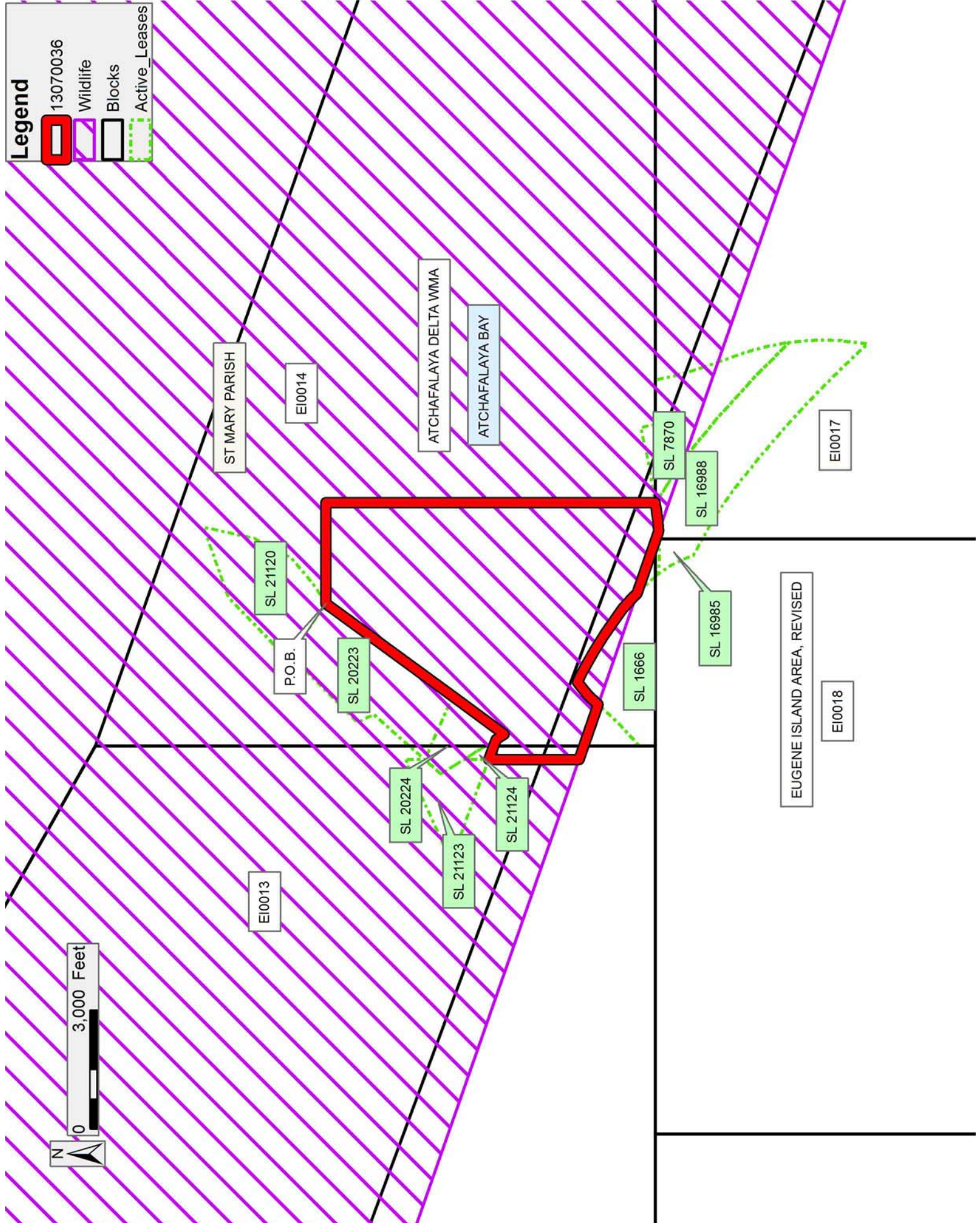

TRACT 43372 - St. Mary Parish, Louisiana

A portion of all lands located above the mean high water mark, together with lands now or formerly constituting the beds and bottoms of any water body of whatever description or nature belonging to the State of Louisiana which is now located within the boundaries of the Atchafalaya Delta Wildlife Management Area and not presently under mineral lease by the State of Louisiana on July 10, 2013, and more particularly located as follows: Beginning at a point within the Atchafalaya Delta Wildlife Management Area, having Coordinates of X = 1,955,845.85 and Y = 263,700.00; thence East 11,391.56 feet to a point having Coordinates of X = 1,967,237.41 and Y = 263,700.00; thence South 5,568.00 feet to a point on the East boundary of State Lease No. 20694 having Coordinates of X = 1,967,237.41 and Y = 258,132.00; thence along the East and North boundary of said State Lease No. 20694 the following courses and distances: North 29 degrees 43 minutes 22 seconds West 2,506.60 feet to a corner having Coordinates of X = 1,965,994.63 and Y = 260,308.82 and South 57 degrees 21 minutes 32 seconds West 5,602.71 feet to its Northwest corner and the Northeast corner of State Lease No. 21025 having Coordinates of X = 1,961,276.78 and Y = 257,286.86; thence South 57 degrees 24 minutes 15 seconds West 2,827.00 feet along the North boundary of said State Lease No. 21025 to a point of on the East boundary of State Lease No. 7868 having Coordinates of 1,958,895.05 and Y = 255,763.92; thence along the boundaries of said State Lease No. 7868 the following courses: North 06 degrees 14 minutes 24 seconds West 180.36 feet to a point having Coordinates of X = 1,958,875.45 and Y = 255,943.22, South 80 degrees 59 minutes 39 seconds West 1,011.34 feet to a corner having Coordinates of X = 1,957,876.58 and Y = 255,784.91 and South 77 degrees 20 minutes 02 seconds West 132.58 feet to its Northwest corner, also being the Northeast corner of the East portion of State Lease No. 1666, as amended having Coordinates of X = 1,957,747.23 and Y = 255,755.84; thence along the North boundary of said State Lease No. 1666 the following courses and distances: South 77 degrees 20 minutes 07 seconds West 830.81 feet to a corner having Coordinates of X = 1,956,936.63 and Y = 255,573.69 and South 80 degrees 38 minutes 43 seconds West 1,105.48 feet to its most West corner located on the North boundary of said State Lease No. 7870 having Coordinates of X = 1,955,845.85 and Y = 255,394.00; thence North 8,306.00 feet to the point of beginning, containing approximately **1,613.06 acres**, all as more particularly outlined on a plat on file in the Office of Mineral Resources, Department of Natural Resources. All bearings, distances and coordinates are based on Louisiana Coordinate System of 1927, (South Zone).

NOTE: The above description of the Tract nominated for lease has been provided and corrected, where required, exclusively by the nomination party. Any mineral lease selected from this Tract and awarded by the Louisiana State Mineral and Energy Board shall be without warranty of any kind, either express, implied, or statutory, including, but not limited to, the implied warranties of merchantability and fitness for a particular

purpose. Should the mineral lease awarded by the Louisiana State Mineral and Energy Board be subsequently modified, cancelled or abrogated due to the existence of conflicting leases, operating agreements, private claims or other future obligations or conditions which may affect all or any portion of the leased Tract, it shall not relieve the Lessee of the obligation to pay any bonus due thereon to the Louisiana State Mineral and Energy Board, nor shall the Louisiana State Mineral and Energy Board be obligated to refund any consideration paid by the Lessor prior to such modification, cancellation, or abrogation, including, but not limited to, bonuses, rentals and royalties.

NOTE: The mineral lease is located in the Atchafalaya Delta WMA under the jurisdiction of the Louisiana Department of Wildlife and Fisheries which has promulgated rules and regulations for the protection of game and wildlife on the aforesaid Tract and, therefore, shall be subject to said rules and regulations, a copy of which shall be attached to the mineral leases. In addition to the specific rules and regulations applicable, the following shall apply regarding operations under this mineral lease:

- No activities will be allowed without written authorization of the Louisiana Department of Wildlife and Fisheries.
- Proposed projects will be evaluated on a case by case basis. Modifications to proposed project features including but not limited to access routes, spoil placement, well sites, flowlines and appurtenant structures may be required by the Department of Wildlife and Fisheries.
- Compliance with the Atchafalaya Delta WMA regulations will be required unless otherwise specified by the Department of Wildlife and Fisheries.
- Compensatory mitigation will be required to offset unavoidable wetland impacts.
- Compensation and/or oyster seed ground surveys may be required by the Department for potential impacts to productive oyster seed grounds located within the management area.
- Removal of all structures, facilities and equipment will be required within 120 days of abandonment unless otherwise agreed to in writing by the Louisiana Department of Wildlife and Fisheries.
- No activities will be allowed during the hunting season unless approved by the Department.
- This tract is located within the emerging Atchafalaya Delta. No activities will be allowed on emergent islands, sub aerial mudflats or vegetated wetlands. Drilling will be restricted to passes and open water bays. The Louisiana Department of Wildlife and Fisheries (LDWF) shall have discretion to determine access routes. In the event that LDWF approves of dredging for access LDWF shall have discretion to require hydraulic or spray dredging.

- Prior to submitting application for wetland permits to Federal and State permitting agencies the leaseholder shall coordinate project details with the Department of Wildlife and Fisheries. Contact person for the Department will be Mike Windham at (504)284-5268.

Additionally, the Department will require a minimum bonus of \$350.00 per acre and a minimum royalty of 25%.

NOTE: The above described tract may be in the vicinity of existing shell reefs where drilling and dredging operations must be conducted in strict conformity with the regulations adopted by the Louisiana Department of Wildlife and Fisheries and/or the U.S. Corps of Engineers, U.S. Army.

NOTE: The State of Louisiana does hereby reserve, and this lease shall be subject to, the imprescriptible right of surface use in the nature of a servitude in favor of the Department of Natural Resources, including its Offices and Commissions, for the sole purpose of implementing, constructing, servicing and maintaining approved coastal zone management and/or restoration projects. Utilization of any and all rights derived under this lease by the mineral lessee, its agents, successors or assigns, shall not interfere with nor hinder the reasonable surface use by the Department of Natural Resources, its Offices or Commissions, as herein above reserved.

NOTE: This tract is located in an area designated by the Louisiana Legislature or the Wildlife and Fisheries Commission as a Public Oyster Seed Ground, Reservation, or area of Calcasieu or Sabine Lake. Proposed projects occurring in these areas will be evaluated on a case by case basis by Louisiana Department of Wildlife & Fisheries. Modifications to proposed project features including, but not limited to, access routes, well sites, flowlines, and appurtenant structures maybe required by the Louisiana Department of Wildlife and Fisheries. In addition, compensatory mitigation will be required to offset unavoidable habitat impacts.

Applicant: LESLIE M. COOPER

Bidder	Cash Payment	Price/Acre	Rental	Oil	Gas	Other

Legend

- 13070035
- Wildlife
- Blocks
- Active_Leases

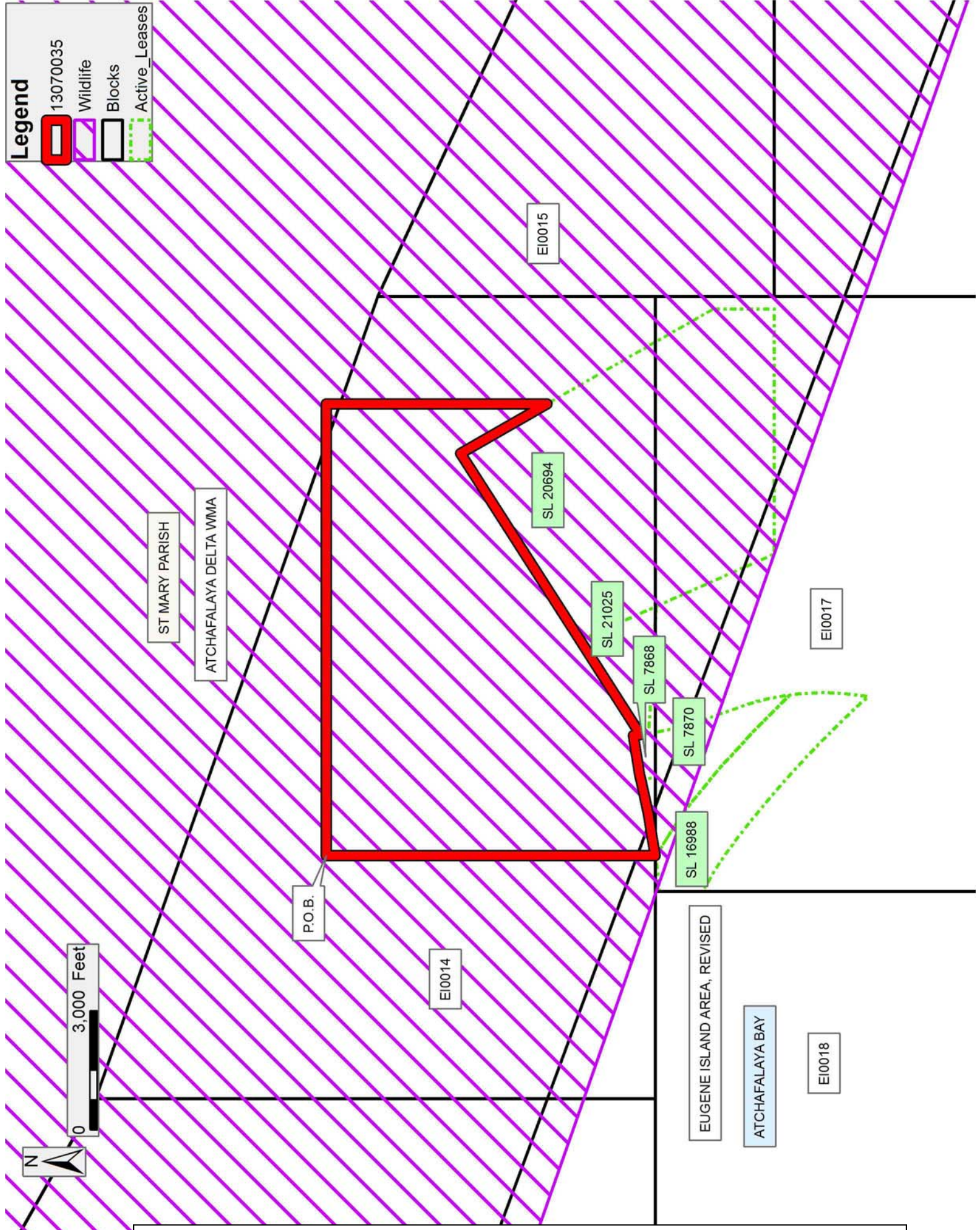

TRACT 43373 - St. Mary and Terrebonne Parishes, Louisiana

A portion of all lands located above the mean high water mark, together with lands now or formerly constituting the beds and bottoms of any water body of whatever description or nature belonging to the State of Louisiana which is now located within the boundaries of the Atchafalaya Delta Wildlife Management Area and not presently under mineral lease by the State of Louisiana on July 10, 2013, and more particularly located as follows: Beginning at a point within the Atchafalaya Delta Wildlife Management Area, having Coordinates of X = 2,008,488.00 and Y = 259,944.00; thence East 14,756.00 feet to a point having Coordinates of X = 2,023,244.00 and Y = 259,944.00; thence South 6,878.00 feet to a point having Coordinates of X = 2,023,244.00 and Y = 253,066.00; thence West 14,756.00 feet to a point having Coordinates of X = 2,008,488.00 and Y = 253,066.00; thence North 6,878.00 feet to the point of beginning, containing approximately **2,329.93 acres**, all as more particularly outlined on a plat on file in the Office of Mineral Resources, Department of Natural Resources. All bearings, distances and coordinates are based on Louisiana Coordinate System of 1927, (South Zone).

NOTE: The above description of the Tract nominated for lease has been provided and corrected, where required, exclusively by the nomination party. Any mineral lease selected from this Tract and awarded by the Louisiana State Mineral and Energy Board shall be without warranty of any kind, either express, implied, or statutory, including, but not limited to, the implied warranties of merchantability and fitness for a particular purpose. Should the mineral lease awarded by the Louisiana State Mineral and Energy Board be subsequently modified, cancelled or abrogated due to the existence of conflicting leases, operating agreements, private claims or other future obligations or conditions which may affect all or any portion of the leased Tract, it shall not relieve the Lessee of the obligation to pay any bonus due thereon to the Louisiana State Mineral and Energy Board, nor shall the Louisiana State Mineral and Energy Board be obligated to refund any consideration paid by the Lessor prior to such modification, cancellation, or abrogation, including, but not limited to, bonuses, rentals and royalties.

NOTE: The mineral lease is located in the Atchafalaya Delta WMA under the jurisdiction of the Louisiana Department of Wildlife and Fisheries which has promulgated rules and regulations for the protection of game and wildlife on the aforesaid Tract and, therefore, shall be subject to said rules and regulations, a copy of which shall be attached to the mineral leases. In addition to the specific rules and regulations applicable, the following shall apply regarding operations under this mineral lease:

- No activities will be allowed without written authorization of the Louisiana Department of Wildlife and Fisheries.
- Proposed projects will be evaluated on a case by case basis. Modifications to proposed project features including but not limited to access routes, spoil placement, well sites, flowlines and

appurtenant structures may be required by the Department of Wildlife and Fisheries.

- Compliance with the Atchafalaya Delta WMA regulations will be required unless otherwise specified by the Department of Wildlife and Fisheries.
- Compensatory mitigation will be required to offset unavoidable wetland impacts.
- Compensation and/or oyster seed ground surveys may be required by the Department for potential impacts to productive oyster seed grounds located within the management area.
- Removal of all structures, facilities and equipment will be required within 120 days of abandonment unless otherwise agreed to in writing by the Louisiana Department of Wildlife and Fisheries.
- No activities will be allowed during the hunting season unless approved by the Department.
- This tract is located within the emerging Atchafalaya Delta. No activities will be allowed on emergent islands, sub aerial mudflats or vegetated wetlands. Drilling will be restricted to passes and open water bays. The Louisiana Department of Wildlife and Fisheries (LDWF) shall have discretion to determine access routes. In the event that LDWF approves of dredging for access LDWF shall have discretion to require hydraulic or spray dredging.
- Prior to submitting application for wetland permits to Federal and State permitting agencies the leaseholder shall coordinate project details with the Department of Wildlife and Fisheries. Contact person for the Department will be Mike Windham at (504)284-5268.

Additionally, the Department will require a minimum bonus of \$350.00 per acre and a minimum royalty of 25%.

NOTE: The State of Louisiana does hereby reserve, and this lease shall be subject to, the imprescriptible right of surface use in the nature of a servitude in favor of the Department of Natural Resources, including its Offices and Commissions, for the sole purpose of implementing, constructing, servicing and maintaining approved coastal zone management and/or restoration projects. Utilization of any and all rights derived under this lease by the mineral lessee, its agents, successors or assigns, shall not interfere with nor hinder the reasonable surface use by the Department of Natural Resources, its Offices or Commissions, as herein above reserved.

NOTE: This tract is located in an area designated by the Louisiana Legislature or the Wildlife and Fisheries Commission as a Public Oyster Seed Ground, Reservation, or area of Calcasieu or Sabine Lake. Proposed projects occurring in these areas will be evaluated on a case by case basis by Louisiana Department of Wildlife & Fisheries. Modifications to proposed project features including, but not limited to, access routes,

well sites, flowlines, and appurtenant structures maybe required by the Louisiana Department of Wildlife and Fisheries. In addition, compensatory mitigation will be required to offset unavoidable habitat impacts.

Applicant: LESLIE M. COOPER

Bidder	Cash Payment	Price/Acre	Rental	Oil	Gas	Other

Legend
13070038
Wildlife

TERREBONNE PARISH

ST MARY PARISH

ATCHAFALAYA DELTA WMA

P.O.B.

ATCHAFALAYA BAY

0 3,000 Feet

TRACT 43374 - St. Mary Parish, Louisiana

A portion of all lands located above the mean high water mark, together with lands now or formerly constituting the beds and bottoms of any water body of whatever description or nature belonging to the State of Louisiana which is now located within the boundaries of the Atchafalaya Delta Wildlife Management Area and not presently under mineral lease by the State of Louisiana on July 10, 2013, and more particularly located as follows: Beginning at a point within the Atchafalaya Delta Wildlife Management Area being the Southeast corner of State Lease No. 21054 and a point on the West boundary of State Lease No. 20532 having Coordinates of X = 1,943,760.71 and Y = 260,946.56; thence along the boundary of said State Lease No. 20532 the following courses: South 24 degrees 35 minutes 56 seconds East 1,634.85 to a point having Coordinates of X = 1,944,441.24 and Y = 259,460.08 and North 65 degrees 21 minutes 49 seconds East 2,598.44 feet to the Western tip of State Lease No. 21123 having Coordinates of X = 1,946,803.15 and Y = 260,543.26; thence South 69 degrees 39 minutes 31 seconds East 2,723.56 feet along the south boundary of said State Lease No. 21123 to its Southeast corner and the Southwest corner of State Lease No. 21124 having Coordinates of X = 1,949,356.86 and Y = 259,596.52; thence South approximately 2,280.53 feet to a point of intersection with the South boundary of the Atchafalaya Delta Wildlife Management Area having Coordinates of X = 1,949,356.86 and Y = 257,315.99; thence Northwesterly, on a straight line, approximately 9,755.57 feet along the South boundary of said Atchafalaya Delta Wildlife Management Area to a point being the Southwest corner of said State Lease No. 21054 and the Eastern corner of State Lease No. 21045 having Coordinates of X = 1,940,146.62 and Y = 260,532.00; thence North 83 degrees 27 minutes 23 seconds East 3,637.79 feet along the south boundary of said State Lease No. 21054 to the point of beginning, **LESS AND EXCEPT** all portions of the above described tract that may fall outside the Atchafalaya Delta Wildlife Management Area, containing approximately **296.21 acres**, all as more particularly outlined on a plat on file in the Office of Mineral Resources, Department of Natural Resources. All bearings, distances and coordinates are based on Louisiana Coordinate System of 1927, (South Zone).

NOTE: The above description of the Tract nominated for lease has been provided and corrected, where required, exclusively by the nomination party. Any mineral lease selected from this Tract and awarded by the Louisiana State Mineral and Energy Board shall be without warranty of any kind, either express, implied, or statutory, including, but not limited to, the implied warranties of merchantability and fitness for a particular purpose. Should the mineral lease awarded by the Louisiana State Mineral and Energy Board be subsequently modified, cancelled or abrogated due to the existence of conflicting leases, operating agreements, private claims or other future obligations or conditions which may affect all or any portion of the leased Tract, it shall not relieve the Lessee of the obligation to pay any bonus due thereon to the Louisiana State Mineral and

Energy Board, nor shall the Louisiana State Mineral and Energy Board be obligated to refund any consideration paid by the Lessor prior to such modification, cancellation, or abrogation, including, but not limited to, bonuses, rentals and royalties.

NOTE: The mineral lease is located in the Atchafalaya Delta WMA under the jurisdiction of the Louisiana Department of Wildlife and Fisheries which has promulgated rules and regulations for the protection of game and wildlife on the aforesaid Tract and, therefore, shall be subject to said rules and regulations, a copy of which shall be attached to the mineral leases. In addition to the specific rules and regulations applicable, the following shall apply regarding operations under this mineral lease:

- No activities will be allowed without written authorization of the Louisiana Department of Wildlife and Fisheries.
- Proposed projects will be evaluated on a case by case basis. Modifications to proposed project features including but not limited to access routes, spoil placement, well sites, flowlines and appurtenant structures may be required by the Department of Wildlife and Fisheries.
- Compliance with the Atchafalaya Delta WMA regulations will be required unless otherwise specified by the Department of Wildlife and Fisheries.
- Compensatory mitigation will be required to offset unavoidable wetland impacts.
- Compensation and/or oyster seed ground surveys may be required by the Department for potential impacts to productive oyster seed grounds located within the management area.
- Removal of all structures, facilities and equipment will be required within 120 days of abandonment unless otherwise agreed to in writing by the Louisiana Department of Wildlife and Fisheries.
- No activities will be allowed during the hunting season unless approved by the Department.
- This tract is located within the emerging Atchafalaya Delta. No activities will be allowed on emergent islands, sub aerial mudflats or vegetated wetlands. Drilling will be restricted to passes and open water bays. The Louisiana Department of Wildlife and Fisheries (LDWF) shall have discretion to determine access routes. In the event that LDWF approves of dredging for access LDWF shall have discretion to require hydraulic or spray dredging.
- Prior to submitting application for wetland permits to Federal and State permitting agencies the leaseholder shall coordinate project details with the Department of Wildlife and Fisheries. Contact person for the Department will be Mike Windham at (504)284-5268.

Additionally, the Department will require a minimum bonus of \$350.00 per acre and a minimum royalty of 25%.

NOTE: The above described tract may be in the vicinity of existing shell reefs where drilling and dredging operations must be conducted in strict conformity with the regulations adopted by the Louisiana Department of Wildlife and Fisheries and/or the U.S. Corps of Engineers, U.S. Army.

NOTE: The State of Louisiana does hereby reserve, and this lease shall be subject to, the imprescriptible right of surface use in the nature of a servitude in favor of the Department of Natural Resources, including its Offices and Commissions, for the sole purpose of implementing, constructing, servicing and maintaining approved coastal zone management and/or restoration projects. Utilization of any and all rights derived under this lease by the mineral lessee, its agents, successors or assigns, shall not interfere with nor hinder the reasonable surface use by the Department of Natural Resources, its Offices or Commissions, as herein above reserved.

NOTE: This tract is located in an area designated by the Louisiana Legislature or the Wildlife and Fisheries Commission as a Public Oyster Seed Ground, Reservation, or area of Calcasieu or Sabine Lake. Proposed projects occurring in these areas will be evaluated on a case by case basis by Louisiana Department of Wildlife & Fisheries. Modifications to proposed project features including, but not limited to, access routes, well sites, flowlines, and appurtenant structures maybe required by the Louisiana Department of Wildlife and Fisheries. In addition, compensatory mitigation will be required to offset unavoidable habitat impacts.

Applicant: LESLIE M. COOPER

Bidder	Cash Payment	Price/Acre	Rental	Oil	Gas	Other

Legend

- 13070034
- Wildlife
- Blocks
- Active_Leases

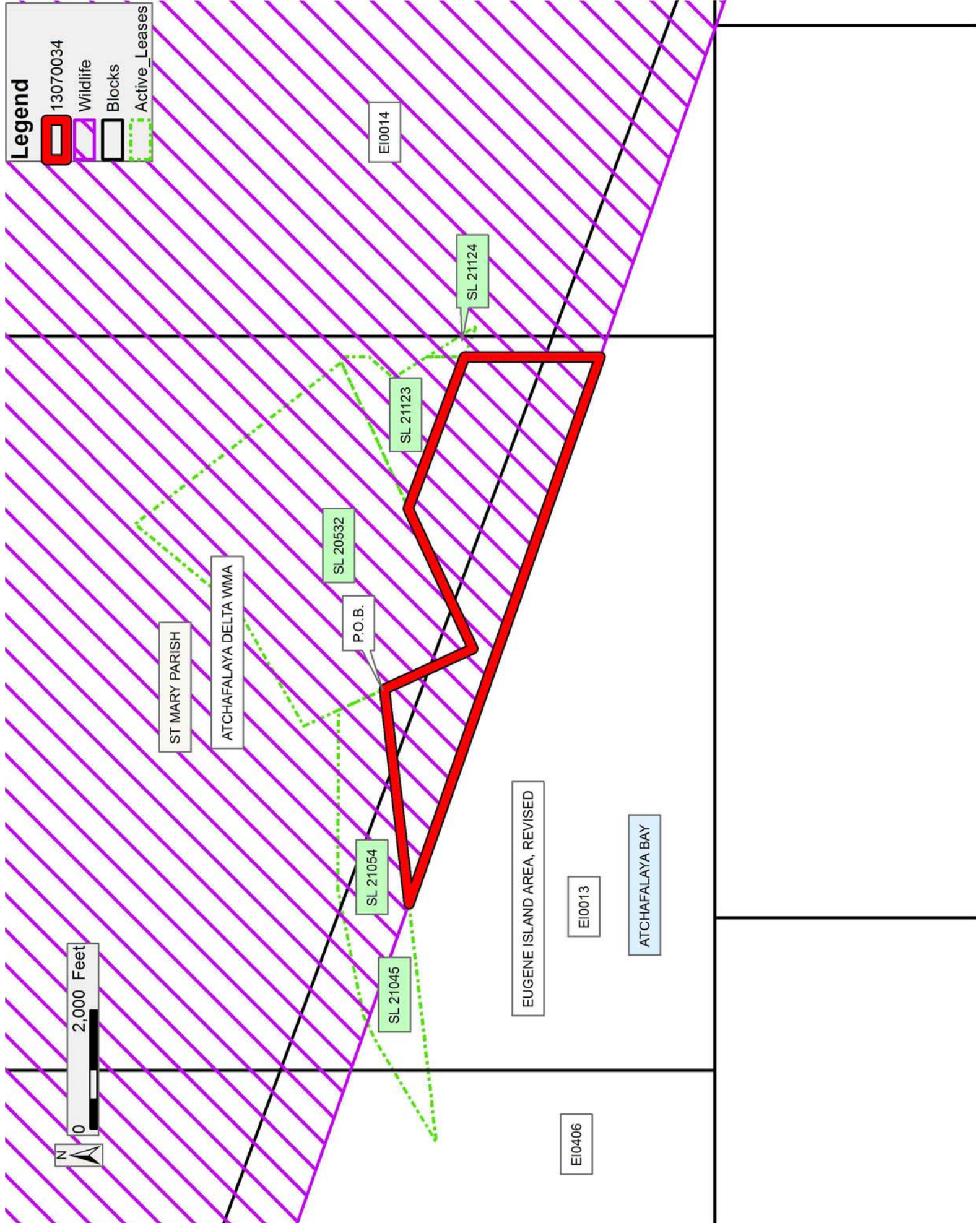

TRACT 43375 - St. Mary Parish, Louisiana

A portion of all lands located above the mean high water mark, together with lands now or formerly constituting the beds and bottoms of any water body of whatever description or nature belonging to the State of Louisiana which is now located within the boundaries of the Atchafalaya Delta Wildlife Management Area and not presently under mineral lease by the State of Louisiana on July 10, 2013, and more particularly located as follows: Beginning at a point within the Atchafalaya Delta Wildlife Management Area, having Coordinates of X = 1,993,732.00 and Y = 259,944.00; thence East 14,756.00 feet to a point having Coordinates of X = 2,008,488.00 and Y = 259,944.00; thence South 7,378.00 feet to a point having Coordinates of X = 2,008,488.00 and Y = 252,566.00; thence West 14,756.00 feet to a point having Coordinates of X = 1,993,732.00 and Y = 252,566.00; thence North 7,378.00 feet to the point of beginning, containing approximately **2,499.31 acres**, all as more particularly outlined on a plat on file in the Office of Mineral Resources, Department of Natural Resources. All bearings, distances and coordinates are based on Louisiana Coordinate System of 1927, (South Zone).

NOTE: The above description of the Tract nominated for lease has been provided and corrected, where required, exclusively by the nomination party. Any mineral lease selected from this Tract and awarded by the Louisiana State Mineral and Energy Board shall be without warranty of any kind, either express, implied, or statutory, including, but not limited to, the implied warranties of merchantability and fitness for a particular purpose. Should the mineral lease awarded by the Louisiana State Mineral and Energy Board be subsequently modified, cancelled or abrogated due to the existence of conflicting leases, operating agreements, private claims or other future obligations or conditions which may affect all or any portion of the leased Tract, it shall not relieve the Lessee of the obligation to pay any bonus due thereon to the Louisiana State Mineral and Energy Board, nor shall the Louisiana State Mineral and Energy Board be obligated to refund any consideration paid by the Lessor prior to such modification, cancellation, or abrogation, including, but not limited to, bonuses, rentals and royalties.

NOTE: The mineral lease is located in the Atchafalaya Delta WMA under the jurisdiction of the Louisiana Department of Wildlife and Fisheries which has promulgated rules and regulations for the protection of game and wildlife on the aforesaid Tract and, therefore, shall be subject to said rules and regulations, a copy of which shall be attached to the mineral leases. In addition to the specific rules and regulations applicable, the following shall apply regarding operations under this mineral lease:

- No activities will be allowed without written authorization of the Louisiana Department of Wildlife and Fisheries.
- Proposed projects will be evaluated on a case by case basis. Modifications to proposed project features including but not limited to access routes, spoil placement, well sites, flowlines and

appurtenant structures may be required by the Department of Wildlife and Fisheries.

- Compliance with the Atchafalaya Delta WMA regulations will be required unless otherwise specified by the Department of Wildlife and Fisheries.
- Compensatory mitigation will be required to offset unavoidable wetland impacts.
- Compensation and/or oyster seed ground surveys may be required by the Department for potential impacts to productive oyster seed grounds located within the management area.
- Removal of all structures, facilities and equipment will be required within 120 days of abandonment unless otherwise agreed to in writing by the Louisiana Department of Wildlife and Fisheries.
- No activities will be allowed during the hunting season unless approved by the Department.
- This tract is located within the emerging Atchafalaya Delta. No activities will be allowed on emergent islands, sub aerial mudflats or vegetated wetlands. Drilling will be restricted to passes and open water bays. The Louisiana Department of Wildlife and Fisheries (LDWF) shall have discretion to determine access routes. In the event that LDWF approves of dredging for access LDWF shall have discretion to require hydraulic or spray dredging.
- Prior to submitting application for wetland permits to Federal and State permitting agencies the leaseholder shall coordinate project details with the Department of Wildlife and Fisheries. Contact person for the Department will be Mike Windham at (504)284-5268.

Additionally, the Department will require a minimum bonus of \$350.00 per acre and a minimum royalty of 25%.

NOTE: The above described tract may be in the vicinity of existing shell reefs where drilling and dredging operations must be conducted in strict conformity with the regulations adopted by the Louisiana Department of Wildlife and Fisheries and/or the U.S. Corps of Engineers, U.S. Army.

NOTE: The State of Louisiana does hereby reserve, and this lease shall be subject to, the imprescriptible right of surface use in the nature of a servitude in favor of the Department of Natural Resources, including its Offices and Commissions, for the sole purpose of implementing, constructing, servicing and maintaining approved coastal zone management and/or restoration projects. Utilization of any and all rights derived under this lease by the mineral lessee, its agents, successors or assigns, shall not interfere with nor hinder the reasonable surface use by the Department of Natural Resources, its Offices or Commissions, as herein above reserved.

NOTE: This tract is located in an area designated by the Louisiana Legislature or the Wildlife and Fisheries Commission as a Public Oyster Seed Ground, Reservation, or area of Calcasieu or Sabine Lake. Proposed projects occurring in these areas will be evaluated on a case by case basis by Louisiana Department of Wildlife & Fisheries. Modifications to proposed project features including, but not limited to, access routes, well sites, flowlines, and appurtenant structures maybe required by the Louisiana Department of Wildlife and Fisheries. In addition, compensatory mitigation will be required to offset unavoidable habitat impacts.

Applicant: LESLIE M. COOPER

Bidder	Cash Payment	Price/Acre	Rental	Oil	Gas	Other

Legend
13070037
Wildlife

ATCHAFALAYA DELTA WMA

ST MARY PARISH

ATCHAFALAYA BAY

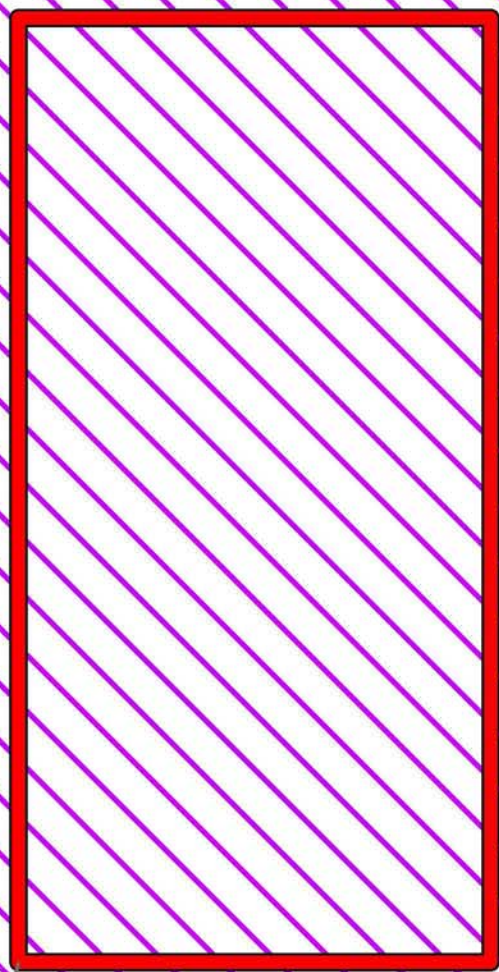

P.O.B.

0 3,000 Feet