

TRACT 43507 - Portion of Block 10, Grand Isle Area, Jefferson and Plaquemines Parishes, Louisiana

The beds and bottoms of all water bodies belonging to the State of Louisiana located in Block 10, Grand Isle Area, together with any present lands formed by accretion to the shoreline or islands formed therein, located in Jefferson and Plaquemines Parishes, Louisiana, owned by and not presently under mineral lease as of October 9, 2013, from the State of Louisiana, the geographical area of which is more fully described as follows: Beginning at the Southeast corner of Block 10, Grand Isle Area having Coordinates of X = 2,457,659.89 and Y = 185,535.39; thence West 14,758.04 feet along the South line of said Block 10 to its Southwest corner having Coordinates of X = 2,442,901.85 and Y = 185,535.39; thence North 7,379.02 feet along the West line of said Block 10 to a point having Coordinates of X = 2,442,901.85 and Y = 192,914.41; thence East 2,608.15 feet to the Southwest corner of State Lease No. 20790 having Coordinates of X = 2,445,510.00 and Y = 192,914.41; thence along the boundary of said State Lease No. 20790 the following courses: East 4,770.87 feet to a point having Coordinates of X = 2,450,280.87 and Y = 192,914.41 and East 7,379.02 feet to a point on the East block line of said Block 10 having Coordinates of X = 2,457,659.89 and Y = 192,914.41; thence South 7,379.02 feet along the East line of said Block 10 to the point of beginning, containing **2,500.00 acres**, all as more particularly outlined on a plat on file in the Office of Mineral Resources, Department of Natural Resources. All bearings, distances and coordinates are based on Louisiana Coordinate System of 1927, (North or South Zone).

NOTE: The above description of the Tract nominated for lease has been provided and corrected, where required, exclusively by the nomination party. Any mineral lease selected from this Tract and awarded by the Louisiana State Mineral and Energy Board shall be without warranty of any kind, either express, implied, or statutory, including, but not limited to, the implied warranties of merchantability and fitness for a particular purpose. Should the mineral lease awarded by the Louisiana State Mineral and Energy Board be subsequently modified, cancelled or abrogated due to the existence of conflicting leases, operating agreements, private claims or other future obligations or conditions which may affect all or any portion of the leased Tract, it shall not relieve the Lessee of the obligation to pay any bonus due thereon to the Louisiana State Mineral and Energy Board, nor shall the Louisiana State Mineral and Energy Board be obligated to refund any consideration paid by the Lessor prior to such modification, cancellation, or abrogation, including, but not limited to, bonuses, rentals and royalties.

NOTE: The State of Louisiana does hereby reserve, and this lease shall be subject to, the imprescriptible right of surface use in the nature of a servitude in favor of the Department of Natural Resources, including its Offices and Commissions, for the sole purpose of implementing, constructing, servicing and maintaining approved coastal zone management and/or restoration projects. Utilization of any and all rights derived

under this lease by the mineral lessee, its agents, successors or assigns, shall not interfere with nor hinder the reasonable surface use by the Department of Natural Resources, its Offices or Commissions, as herein above reserved.

Applicant: BLANTON PETROLEUM CORP.

Bidder	Cash Payment	Price/Acre	Rental	Oil	Gas	Other

Legend

- 13100024
- Blocks
- Active_Leases

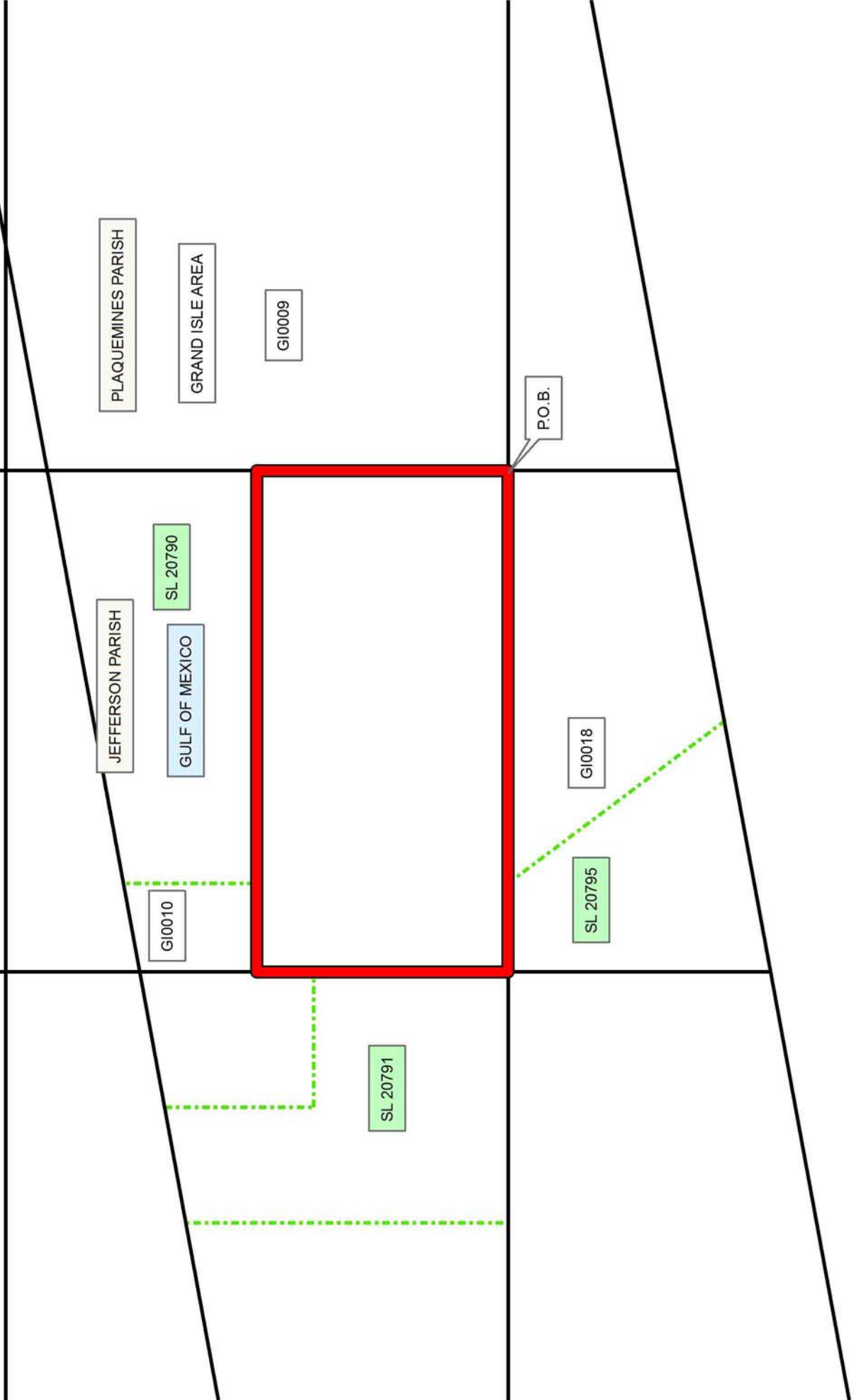

TRACT 43508 - Portion of Blocks 12, 13, 15, and 16, Grand Isle Area, Jefferson Parish, Louisiana

The beds and bottoms of all water bodies belonging to the State of Louisiana located in Blocks 12, 13, 15, and 16, Grand Isle Area, together with any present lands formed by accretion to the shoreline or islands formed therein, located in Jefferson Parish, Louisiana, owned by and not presently under mineral lease as of October 9, 2013, from the State of Louisiana, the geographical area of which is more fully described as follows: Beginning at a point on the North line of State Lease No. 20796 having Coordinates of X = 2,408,081.64 and Y = 177,630.82; thence North 7,904.57 feet to a point on the common block line between Block 15, Grand Isle Area and Block 13 Grand Isle Area, having Coordinates of X = 2,408,081.64 and Y = 185,535.39; thence North 00 degrees 22 minutes 56 seconds East 4,422.56 feet to a point on the Louisiana Coastline, as decreed by the Supreme Court of the United States, as determined by a Special Master appointed therein, in litigation styled *United States v. State of Louisiana et al No. 9 Original*, in 1975, having Coordinates of X = 2,408,111.15 and Y = 189,957.85; thence Northeasterly on a straight line along the said Coastline to a point having Coordinates of X = 2,418,600.00 and Y = 191,889.17; thence South 215.66 feet to the Northwest corner of State Lease No. 18738 having Coordinates of X = 2,418,600.00 and Y = 191,673.51; thence South 6,138.12 feet along the West line of said State Lease No. 18738 to a point on the North line of State Lease No. 799 having Coordinates of X = 2,418,600.00 and Y = 185,535.39; thence along the boundary of said State Lease No. 799 the following courses: West 3,907.43 feet to a point having Coordinates of X = 2,414,692.57 and Y = 185,535.39 and South 7,904.57 feet to the Northeast corner of State Lease No. 20796 having Coordinates of X = 2,414,692.57 and Y = 177,630.82; thence West 6,610.93 feet to the point of beginning, containing **2,498.55 acres**, all as more particularly outlined on a plat on file in the Office of Mineral Resources, Department of Natural Resources. All bearings, distances and coordinates are based on Louisiana Coordinate System of 1927, (North or South Zone).

NOTE: The above description of the Tract nominated for lease has been provided and corrected, where required, exclusively by the nomination party. Any mineral lease selected from this Tract and awarded by the Louisiana State Mineral and Energy Board shall be without warranty of any kind, either express, implied, or statutory, including, but not limited to, the implied warranties of merchantability and fitness for a particular purpose. Should the mineral lease awarded by the Louisiana State Mineral and Energy Board be subsequently modified, cancelled or abrogated due to the existence of conflicting leases, operating agreements, private claims or other future obligations or conditions which may affect all or any portion of the leased Tract, it shall not relieve the Lessee of the obligation to pay any bonus due thereon to the Louisiana State Mineral and Energy Board, nor shall the Louisiana State Mineral and Energy Board be obligated to refund any consideration paid by the Lessor prior to such

modification, cancellation, or abrogation, including, but not limited to, bonuses, rentals and royalties.

NOTE: The State of Louisiana does hereby reserve, and this lease shall be subject to, the imprescriptible right of surface use in the nature of a servitude in favor of the Department of Natural Resources, including its Offices and Commissions, for the sole purpose of implementing, constructing, servicing and maintaining approved coastal zone management and/or restoration projects. Utilization of any and all rights derived under this lease by the mineral lessee, its agents, successors or assigns, shall not interfere with nor hinder the reasonable surface use by the Department of Natural Resources, its Offices or Commissions, as herein above reserved.

Applicant: BLANTON PETROLEUM CORP.

Bidder	Cash Payment	Price/Acre	Rental	Oil	Gas	Other

Legend

- 13100033
- Blocks
- Active Lease

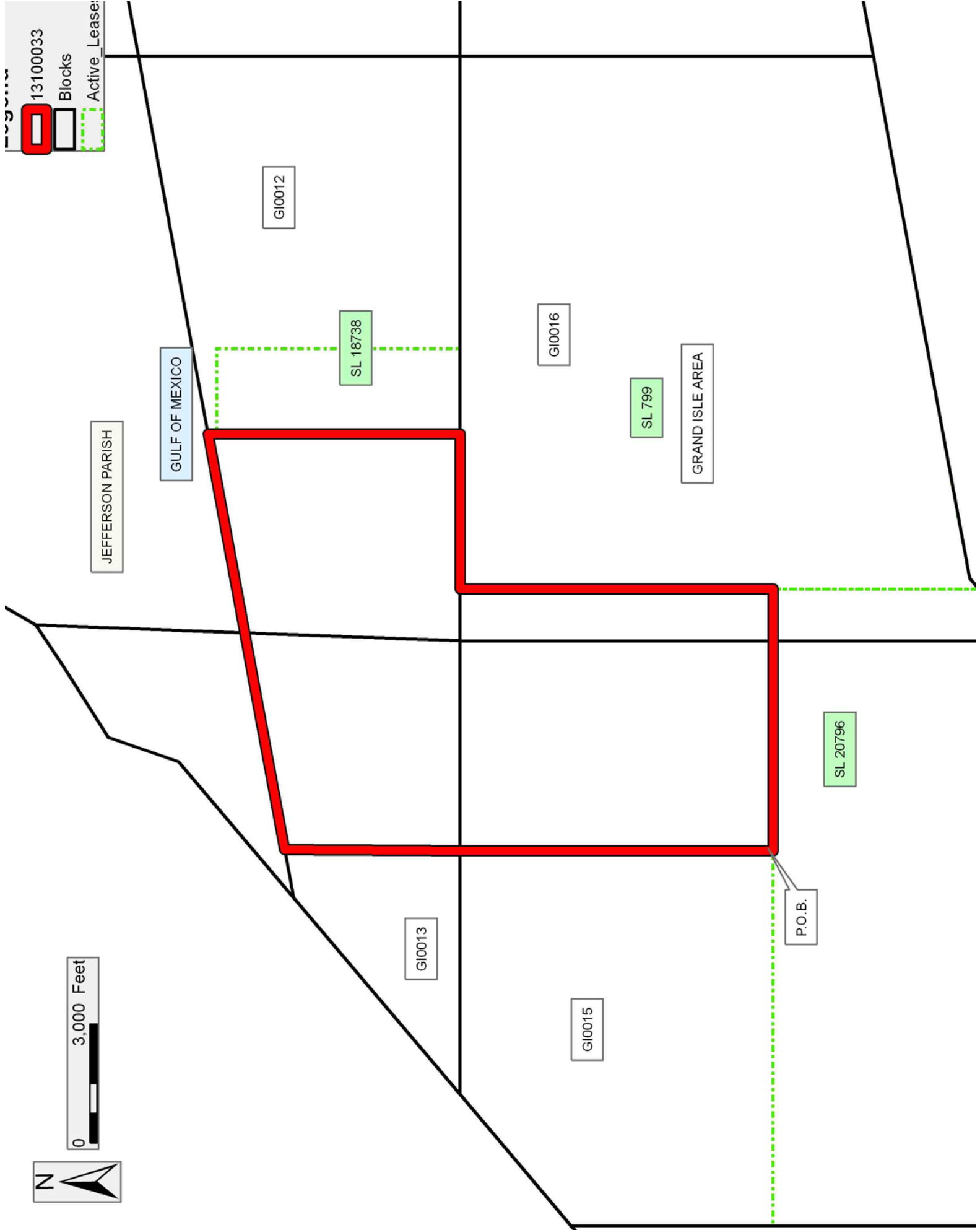

0 3,000 Feet

A north arrow is located to the left of a scale bar. The scale bar is marked with "0" at the start and "3,000 Feet" at the end.

TRACT 43509 - Portion of Blocks 13, and 15, Grand Isle Area, Jefferson Parish, Louisiana

The beds and bottoms of all water bodies belonging to the State of Louisiana located in Blocks 13, and 15, Grand Isle Area, together with any present lands formed by accretion to the shoreline or islands formed therein, located in Jefferson Parish, Louisiana, owned by and not presently under mineral lease as of October 9, 2013, from the State of Louisiana, the geographical area of which is more fully described as follows: Beginning at a point on the North line of State Lease No. 20796 having Coordinates of X = 2,408,081.64 and Y = 177,630.82; thence West 9,453.91 feet along the North line of said State Lease No. 20796 to a point on the West line of Block 15, Grand Isle Area having Coordinates of X = 2,398,627.73 and Y = 177,630.82; thence along the boundary of said Block 15 the following courses: North 5,111.15 feet to a point having Coordinates of X = 2,398,627.73 and Y = 182,741.97; North 49 degrees 45 minutes 38 seconds East 1,142.63 feet to a point having Coordinates of X = 2,399,499.96 and Y = 183,480.09 and North 49 degrees 45 minutes 53 seconds East 3,181.94 feet to the common corner between Block 15 and Block 13, Grand Isle Area having Coordinates of X = 2,401,929.05 and Y = 185,535.39; thence North 49 degrees 45 minutes 52 seconds East 6,498.54 feet along the Western block line of said Block 13 to a point on the Louisiana Coastline, as decreed by the Supreme Court of the United States, as determined by a Special Master appointed therein, in litigation styled *United States v. State of Louisiana et al No. 9 Original*, in 1975, having Coordinates of X = 2,406,890.00 and Y = 189,733.00; thence Northeasterly on a straight line along the said Coastline to a point having Coordinates of X = 2,408,111.15 and Y = 189,957.85; thence South 00 degrees 22 minutes 01 seconds West 4,422.56 feet to a point on the common block line of said Block 13 and said Block 15 having Coordinates of X = 2,408,081.64 and Y = 185,535.39; thence South 7,904.57 feet to the point of beginning, containing **1,968.05 acres**, all as more particularly outlined on a plat on file in the Office of Mineral Resources, Department of Natural Resources. All bearings, distances and coordinates are based on Louisiana Coordinate System of 1927, (North or South Zone).

NOTE: The above description of the Tract nominated for lease has been provided and corrected, where required, exclusively by the nomination party. Any mineral lease selected from this Tract and awarded by the Louisiana State Mineral and Energy Board shall be without warranty of any kind, either express, implied, or statutory, including, but not limited to, the implied warranties of merchantability and fitness for a particular purpose. Should the mineral lease awarded by the Louisiana State Mineral and Energy Board be subsequently modified, cancelled or abrogated due to the existence of conflicting leases, operating agreements, private claims or other future obligations or conditions which may affect all or any portion of the leased Tract, it shall not relieve the Lessee of the obligation to pay any bonus due thereon to the Louisiana State Mineral and Energy Board, nor shall the Louisiana State Mineral and Energy Board be obligated to refund any consideration paid by the Lessor prior to such

modification, cancellation, or abrogation, including, but not limited to, bonuses, rentals and royalties.

NOTE: The State of Louisiana does hereby reserve, and this lease shall be subject to, the imprescriptible right of surface use in the nature of a servitude in favor of the Department of Natural Resources, including its Offices and Commissions, for the sole purpose of implementing, constructing, servicing and maintaining approved coastal zone management and/or restoration projects. Utilization of any and all rights derived under this lease by the mineral lessee, its agents, successors or assigns, shall not interfere with nor hinder the reasonable surface use by the Department of Natural Resources, its Offices or Commissions, as herein above reserved.

Applicant: BLANTON PETROLEUM CORP.

Bidder	Cash Payment	Price/Acre	Rental	Oil	Gas	Other

Legend

- 13100034
- Blocks
- Active_Leases

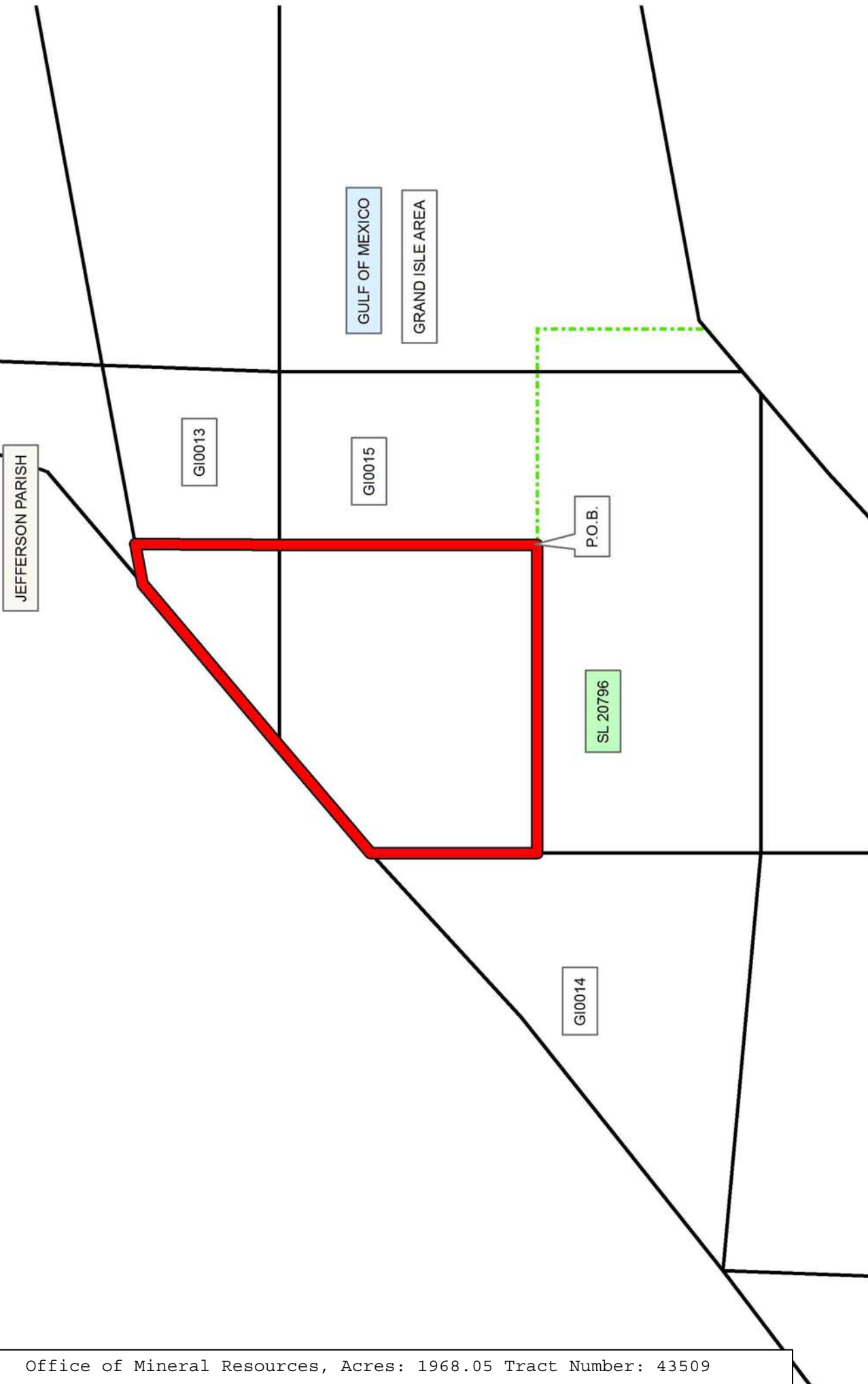

TRACT 43510 - Portion of Block 12, Grand Isle Area, Jefferson Parish, Louisiana

The beds and bottoms of all water bodies belonging to the State of Louisiana located in Block 12, Grand Isle Area, together with any present lands formed by accretion to the shoreline or islands formed therein, located in Jefferson Parish, Louisiana, owned by and not presently under mineral lease as of October 9, 2013, from the State of Louisiana, the geographical area of which is more fully described as follows: Beginning at the Northeast corner of State Lease No. 14031, said corner also being the most westerly Southwest corner of State Lease No. 20792, having Coordinates of X = 2,426,111.90 and Y = 187,573.51; thence along the boundary of said State Lease No. 20792 the following courses: East 2,031.91 feet to a point having Coordinates of X = 2,428,143.81 and Y = 187,573.51 and South 2,038.12 feet to a point on the South block line of Block 12, Grand Isle Area having Coordinates of X = 2,428,143.81 and Y = 185,535.39; thence West 2,031.91 feet along the South line of said Block 12 to the Southeast corner of said State Lease No. 14031 having Coordinates of X = 2,426,111.90 and Y = 185,535.39; thence North 2,038.12 feet along the East line of said State Lease No. 14031 to the Point of Beginning, containing **95.07 acres**, all as more particularly outlined on a plat on file in the Office of Mineral Resources, Department of Natural Resources. All bearings, distances and coordinates are based on Louisiana Coordinate System of 1927, (North or South Zone).

NOTE: The above description of the Tract nominated for lease has been provided and corrected, where required, exclusively by the nomination party. Any mineral lease selected from this Tract and awarded by the Louisiana State Mineral and Energy Board shall be without warranty of any kind, either express, implied, or statutory, including, but not limited to, the implied warranties of merchantability and fitness for a particular purpose. Should the mineral lease awarded by the Louisiana State Mineral and Energy Board be subsequently modified, cancelled or abrogated due to the existence of conflicting leases, operating agreements, private claims or other future obligations or conditions which may affect all or any portion of the leased Tract, it shall not relieve the Lessee of the obligation to pay any bonus due thereon to the Louisiana State Mineral and Energy Board, nor shall the Louisiana State Mineral and Energy Board be obligated to refund any consideration paid by the Lessor prior to such modification, cancellation, or abrogation, including, but not limited to, bonuses, rentals and royalties.

NOTE: The State of Louisiana does hereby reserve, and this lease shall be subject to, the imprescriptible right of surface use in the nature of a servitude in favor of the Department of Natural Resources, including its Offices and Commissions, for the sole purpose of implementing, constructing, servicing and maintaining approved coastal zone management and/or restoration projects. Utilization of any and all rights derived under this lease by the mineral lessee, its agents, successors or assigns, shall not interfere with nor hinder the reasonable surface use by the

Department of Natural Resources, its Offices or Commissions, as herein above reserved.

Applicant: BLANTON PETROLEUM CORP.

Bidder	Cash Payment	Price/Acre	Rental	Oil	Gas	Other

Legend

- 13100031 (Red outline)
- Blocks (Black outline)
- Active_Lease (Green dashed outline)

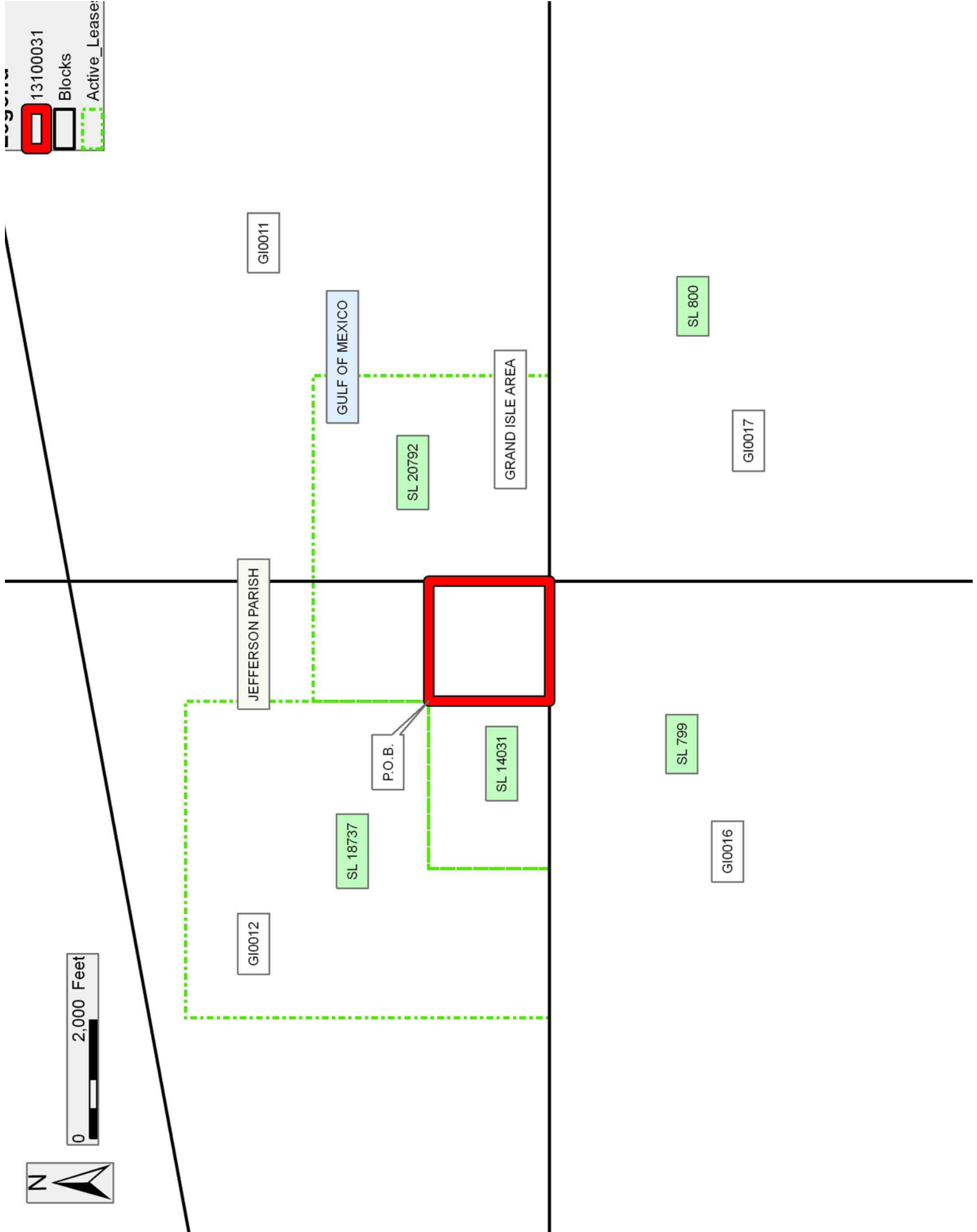

0 2,000 Feet

TRACT 43511 - Portion of Block 18, Grand Isle Area, Jefferson and Plaquemines Parishes, Louisiana

The beds and bottoms of all water bodies belonging to the State of Louisiana located in Block 18, Grand Isle Area, together with any present lands formed by accretion to the shoreline or islands formed therein, located in Jefferson and Plaquemines Parishes, Louisiana, owned by and not presently under mineral lease as of October 9, 2013, from the State of Louisiana, the geographical area of which is more fully described as follows: Beginning at the Northeast corner of Block 18, Grand Isle Area having Coordinates of X = 2,457,659.89 and Y = 185,535.39; thence South 5,001.22 feet along the East line of said Block 18 to a point on the Three Mile Line, as decreed by the Supreme Court of the United States, as determined by a Special Master appointed therein, in litigation styled *United States v. State of Louisiana et al No. 9 Original*, in 1975, having Coordinates of X = 2,457,659.89 and Y = 180,534.17; thence Southwesterly on a straight line along the said Three Mile Decree Line to the Southeast corner of State Lease No. 20795 having Coordinates of X = 2,450,280.87 and Y = 179,175.44; thence North 36 degrees 55 minutes 20 seconds West 7,955.38 feet along the Eastern boundary of said State Lease No. 20795 to a point on the North line of said Block 18 having Coordinates of X = 2,445,501.85 and Y = 185,535.39; thence East 12,158.04 feet along the North line of said Block 18 to the point of beginning, containing **1,311.16 acres, LESS AND EXCEPT** that portion thereof, if any, lying seaward of the line three nautical miles from the coast line of Louisiana, as said three mile line has been decreed by the Supreme Court of the United States, as determined by a Special Master appointed therein, in litigation styled **United States v. State of Louisiana et al No. 9 Original**, in 1975, all as more particularly outlined on a plat in the Office of Mineral Resources, Department of Natural Resources. All bearings, distances and coordinates are based on the Louisiana Coordinate System of 1927, (South Zone).

NOTE: The above description of the Tract nominated for lease has been provided and corrected, where required, exclusively by the nomination party. Any mineral lease selected from this Tract and awarded by the Louisiana State Mineral and Energy Board shall be without warranty of any kind, either express, implied, or statutory, including, but not limited to, the implied warranties of merchantability and fitness for a particular purpose. Should the mineral lease awarded by the Louisiana State Mineral and Energy Board be subsequently modified, cancelled or abrogated due to the existence of conflicting leases, operating agreements, private claims or other future obligations or conditions which may affect all or any portion of the leased Tract, it shall not relieve the Lessee of the obligation to pay any bonus due thereon to the Louisiana State Mineral and Energy Board, nor shall the Louisiana State Mineral and Energy Board be obligated to refund any consideration paid by the Lessor prior to such modification, cancellation, or abrogation, including, but not limited to, bonuses, rentals and royalties.

NOTE: The State of Louisiana does hereby reserve, and this lease shall be subject to, the imprescriptible right of surface use in the nature of a servitude in favor of the Department of Natural Resources, including its Offices and Commissions, for the sole purpose of implementing, constructing, servicing and maintaining approved coastal zone management and/or restoration projects. Utilization of any and all rights derived under this lease by the mineral lessee, its agents, successors or assigns, shall not interfere with nor hinder the reasonable surface use by the Department of Natural Resources, its Offices or Commissions, as herein above reserved.

Applicant: BLANTON PETROLEUM CORP.

Bidder	Cash Payment	Price/Acre	Rental	Oil	Gas	Other

Legend

- 13100017
- Blocks
- Active_Leases

