

TRACT 43522 - Lafourche Parish, Louisiana

All of the lands now or formerly constituting the beds and bottoms of all water bodies of every nature and description as to which title is vested in the State of Louisiana, together with all islands arising therein and other lands formed by accretion or by reliction, where allowed by law, excepting tax adjudicated lands, and not presently under mineral lease on October 9, 2013, situated in Lafourche Parish, Louisiana, and more particularly described as follows: Beginning at a point having Coordinates of X = 2,335,391.67 and Y = 366,000.00; thence East 13,597.98 feet to a point having Coordinates of X = 2,348,989.65 and Y = 366,000.00; thence South 10,771.79 feet to a point having Coordinates of X = 2,348,989.65 and Y = 355,228.21; thence West 13,597.98 feet to a point having Coordinates of X = 2,335,391.67 and Y = 355,228.21; thence North 3,134.29 feet to the Southeast corner of State Lease No. 21069 having Coordinates of X = 2,335,391.67 and Y = 358,362.50; thence North 1,473.29 feet along the boundary of said State Lease No. 21069 to its Southernmost Northeast corner having Coordinates of X = 2,335,391.67 and Y = 359,835.79; thence North 6,164.21 feet to the point of beginning, containing approximately **946 acres**, all as more particularly outlined on a plat on file in the Office of Mineral Resources, Department of Natural Resources. All bearings, distances and coordinates are based on Louisiana Coordinate System of 1927, (North or South Zone), where applicable.

NOTE: The above description of the Tract nominated for lease has been provided and corrected, where required, exclusively by the nomination party. Any mineral lease selected from this Tract and awarded by the Louisiana State Mineral and Energy Board shall be without warranty of any kind, either express, implied, or statutory, including, but not limited to, the implied warranties of merchantability and fitness for a particular purpose. Should the mineral lease awarded by the Louisiana State Mineral and Energy Board be subsequently modified, cancelled or abrogated due to the existence of conflicting leases, operating agreements, private claims or other future obligations or conditions which may affect all or any portion of the leased Tract, it shall not relieve the Lessee of the obligation to pay any bonus due thereon to the Louisiana State Mineral and Energy Board, nor shall the Louisiana State Mineral and Energy Board be obligated to refund any consideration paid by the Lessor prior to such modification, cancellation, or abrogation, including, but not limited to, bonuses, rentals and royalties.

NOTE: The State of Louisiana does hereby reserve, and this lease shall be subject to, the imprescriptible right of surface use in the nature of a servitude in favor of the Department of Natural Resources, including its Offices and Commissions, for the sole purpose of implementing, constructing, servicing and maintaining approved coastal zone management and/or restoration projects. Utilization of any and all rights derived under this lease by the mineral lessee, its agents, successors or assigns, shall not interfere with nor hinder the reasonable surface use by the Department of Natural Resources, its Offices or Commissions, as herein above reserved.

Applicant: SOUTHLAND OIL PROPERTIES, INC.

Bidder	Cash Payment	Price/Acre	Rental	Oil	Gas	Other

13100014
Active_Lease:
DOQQ2008



LAFOURCHE PARISH

LAKE SALVADOR

P.O.B.



SL 21069

T16S - R22E

T17S - R22E

**TRACT 43523 - Portion of Blocks 48, and 52, Main Pass Area, Revised,
Plaquemines Parish, Louisiana**

All of the lands now or formerly constituting the beds and bottoms of all water bodies of every nature and description as to which title is vested in the State of Louisiana, together with all islands arising therein and other lands formed by accretion or by reliction, where allowed by law, excepting tax adjudicated lands, and not presently under mineral lease on October 9, 2013, situated in Plaquemines Parish, Louisiana, and more particularly described as follows: Beginning at a point on the West boundary line of State Lease No. 19489 having Coordinates of X = 2,645,351.00 and Y = 264,068.08; thence South 718.08 feet along the boundary of said State Lease No. 19489 to a point on its Southwest corner having Coordinates of X = 2,645,351.00 and Y = 263,350.00; thence East 3,332.22 feet along the South boundary of State Lease No. 19489 to a point having Coordinates of X = 2,648,683.22 and Y = 263,350.00; thence South 02 degrees 02 minutes 46 seconds East a distance of approximately 2,991 feet to a point on the North boundary line of State Lease No. 195 as amended; thence Southwesterly along the North boundary line of said State Lease No. 195 a distance of approximately 4,930 feet to a point intersecting the boundary of State Lease No. 195 and the boundary of Price Tract C-3; thence North 15 degrees 30 minutes 00 seconds West a distance of approximately 11 feet to a point on the Northeast corner of Price Tract C-3 and the Southeast corner of Price Tract C-2 having Coordinates of X = 2,643,859.53 and Y = 260,231.56; thence North 15 degrees 30 minutes 00 seconds West a distance of 1,228.80 feet to a point having Coordinates of X = 2,643,531.15 and Y = 261,415.67; thence North 41 degrees 40 minutes 00 seconds West a distance of 3,364.51 feet to a point having Coordinates of X = 2,641,294.43 and Y = 263,929.05; thence North 88 degrees 02 minutes 13 seconds East a distance of 4,058.95 feet to the point of beginning, containing **456 acres**, all as more particularly outlined on a plat on file in the Office of Mineral Resources, Department of Natural Resources. All bearings, distances and coordinates are based on Louisiana Coordinate System of 1927, (North or South Zone), where applicable.

NOTE: The above description of the Tract nominated for lease has been provided and corrected, where required, exclusively by the nomination party. Any mineral lease selected from this Tract and awarded by the Louisiana State Mineral and Energy Board shall be without warranty of any kind, either express, implied, or statutory, including, but not limited to, the implied warranties of merchantability and fitness for a particular purpose. Should the mineral lease awarded by the Louisiana State Mineral and Energy Board be subsequently modified, cancelled or abrogated due to the existence of conflicting leases, operating agreements, private claims or other future obligations or conditions which may affect all or any portion of the leased Tract, it shall not relieve the Lessee of the obligation to pay any bonus due thereon to the Louisiana State Mineral and Energy Board, nor shall the Louisiana State Mineral and Energy Board be obligated to refund any consideration paid by the Lessor prior to such

modification, cancellation, or abrogation, including, but not limited to, bonuses, rentals and royalties.



NOTE: The State of Louisiana does hereby reserve, and this lease shall be subject to, the imprescriptible right of surface use in the nature of a servitude in favor of the Department of Natural Resources, including its Offices and Commissions, for the sole purpose of implementing, constructing, servicing and maintaining approved coastal zone management and/or restoration projects. Utilization of any and all rights derived under this lease by the mineral lessee, its agents, successors or assigns, shall not interfere with nor hinder the reasonable surface use by the Department of Natural Resources, its Offices or Commissions, as herein above reserved.

NOTE: This tract is located in an area designated by the Louisiana Legislature or the Wildlife and Fisheries Commission as a Public Oyster Seed Ground, Reservation, or area of Calcasieu or Sabine Lake. Proposed projects occurring in these areas will be evaluated on a case by case basis by Louisiana Department of Wildlife & Fisheries. Modifications to proposed project features including, but not limited to, access routes, well sites, flowlines, and appurtenant structures maybe required by the Louisiana Department of Wildlife and Fisheries. In addition, compensatory mitigation will be required to offset unavoidable habitat impacts.

Applicant: ACADIAN LAND SERVICES, L.L.C.

Bidder	Cash Payment	Price/Acre	Rental	Oil	Gas	Other

Legend

-  13100008
-  Blocks
-  Active_Leases



PLAQUEMINES PARISH

BRETON SOUND

MP0048

SL 19489

P.O.B.

MP0047

MP0052

MAIN PASS AREA, REVISED

PRICE CASE

SL 195

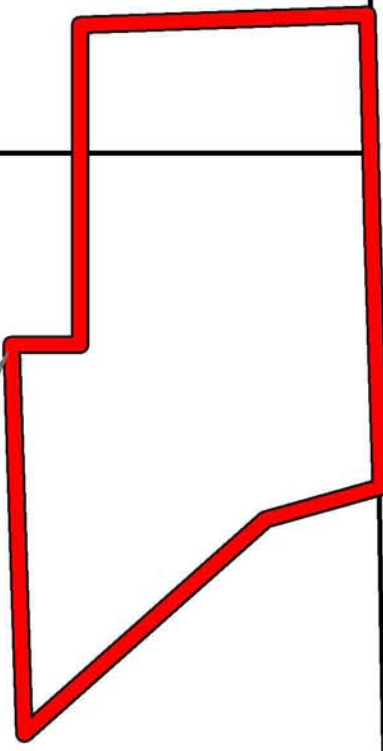

TRACT 43524 - Portion of Block 48, Main Pass Area, Revised, Plaquemines Parish, Louisiana

All of the lands now or formerly constituting the beds and bottoms of all water bodies of every nature and description as to which title is vested in the State of Louisiana, together with all islands arising therein and other lands formed by accretion or by reliction, where allowed by law, excepting tax adjudicated lands, and not presently under mineral lease on October 9, 2013, situated in Plaquemines Parish, Louisiana, and more particularly described as follows: Beginning at a point on a Western boundary line of Price Tract C-2 having Coordinates of X = 2,639,550.00 and Y = 263,869.26; thence North 88 degrees 02 minutes 13 seconds East 1,745.46 feet to a point having Coordinates of X = 2,641,294.43 and Y = 263,929.05; thence South 41 degrees 40 minutes 00 seconds East 3,364.51 feet to a point having Coordinates of X = 2,643,531.15 and Y = 261,415.67; thence South 15 degrees 30 minutes 00 seconds East 1,228.80 feet to the Southeast corner of Price Tract C-2 and the Northeast corner of Price Tract C-3 having Coordinates of X = 2,643,859.53 and Y = 260,231.56; thence South 15 degrees 30 minutes 00 seconds East approximately 11 feet to a point on the Northern boundary of State Lease No. 195 as amended; thence Southwesterly approximately 5,566 feet along the Northern boundary of said State Lease No. 195 to its Northwest corner to a point on the Eastern boundary of State Lease 17236 as amended; thence Northerly approximately 75 feet along the Eastern boundary line of said State Lease No. 17236 to its Northeast corner having Coordinates of X = 2,638,296.00 and Y = 260,119.02 said point also being the Western boundary of Price Tract C-3; thence North 02 degrees 08 minutes 19 seconds West 16.11 feet to a point having Coordinates of X = 2,638,295.40 and Y = 260,135.11; thence North 89 degrees 00 minutes 26 seconds East 1,254.79 feet to a point having Coordinates of X = 2,639,550.00 and Y = 260,156.85; thence North 3,712.40 feet to the point of beginning, containing 287 gross acres and **172 net acres**, all as more particularly outlined on a plat on file in the Office of Mineral Resources, Department of Natural Resources. All bearings, distances and coordinates are based on Louisiana Coordinate System of 1927, (North or South Zone), where applicable.

NOTE: The above description of the Tract nominated for lease has been provided and corrected, where required, exclusively by the nomination party. Any mineral lease selected from this Tract and awarded by the Louisiana State Mineral and Energy Board shall be without warranty of any kind, either express, implied, or statutory, including, but not limited to, the implied warranties of merchantability and fitness for a particular purpose. Should the mineral lease awarded by the Louisiana State Mineral and Energy Board be subsequently modified, cancelled or abrogated due to the existence of conflicting leases, operating agreements, private claims or other future obligations or conditions which may affect all or any portion of the leased Tract, it shall not relieve the Lessee of the obligation to pay any bonus due thereon to the Louisiana State Mineral and Energy Board, nor shall the Louisiana State Mineral and Energy Board be

obligated to refund any consideration paid by the Lessor prior to such modification, cancellation, or abrogation, including, but not limited to, bonuses, rentals and royalties.

NOTE: The State of Louisiana does hereby reserve, and this lease shall be subject to, the imprescriptible right of surface use in the nature of a servitude in favor of the Department of Natural Resources, including its Offices and Commissions, for the sole purpose of implementing, constructing, servicing and maintaining approved coastal zone management and/or restoration projects. Utilization of any and all rights derived under this lease by the mineral lessee, its agents, successors or assigns, shall not interfere with nor hinder the reasonable surface use by the Department of Natural Resources, its Offices or Commissions, as herein above reserved.

NOTE: This tract is located in an area designated by the Louisiana Legislature or the Wildlife and Fisheries Commission as a Public Oyster Seed Ground, Reservation, or area of Calcasieu or Sabine Lake. Proposed projects occurring in these areas will be evaluated on a case by case basis by Louisiana Department of Wildlife & Fisheries. Modifications to proposed project features including, but not limited to, access routes, well sites, flowlines, and appurtenant structures maybe required by the Louisiana Department of Wildlife and Fisheries. In addition, compensatory mitigation will be required to offset unavoidable habitat impacts.

Applicant: ACADIAN LAND SERVICES, L.L.C.

Bidder	Cash Payment	Price/Acre	Rental	Oil	Gas	Other

Legend

- 13100007
- Blocks
- Active_Leases

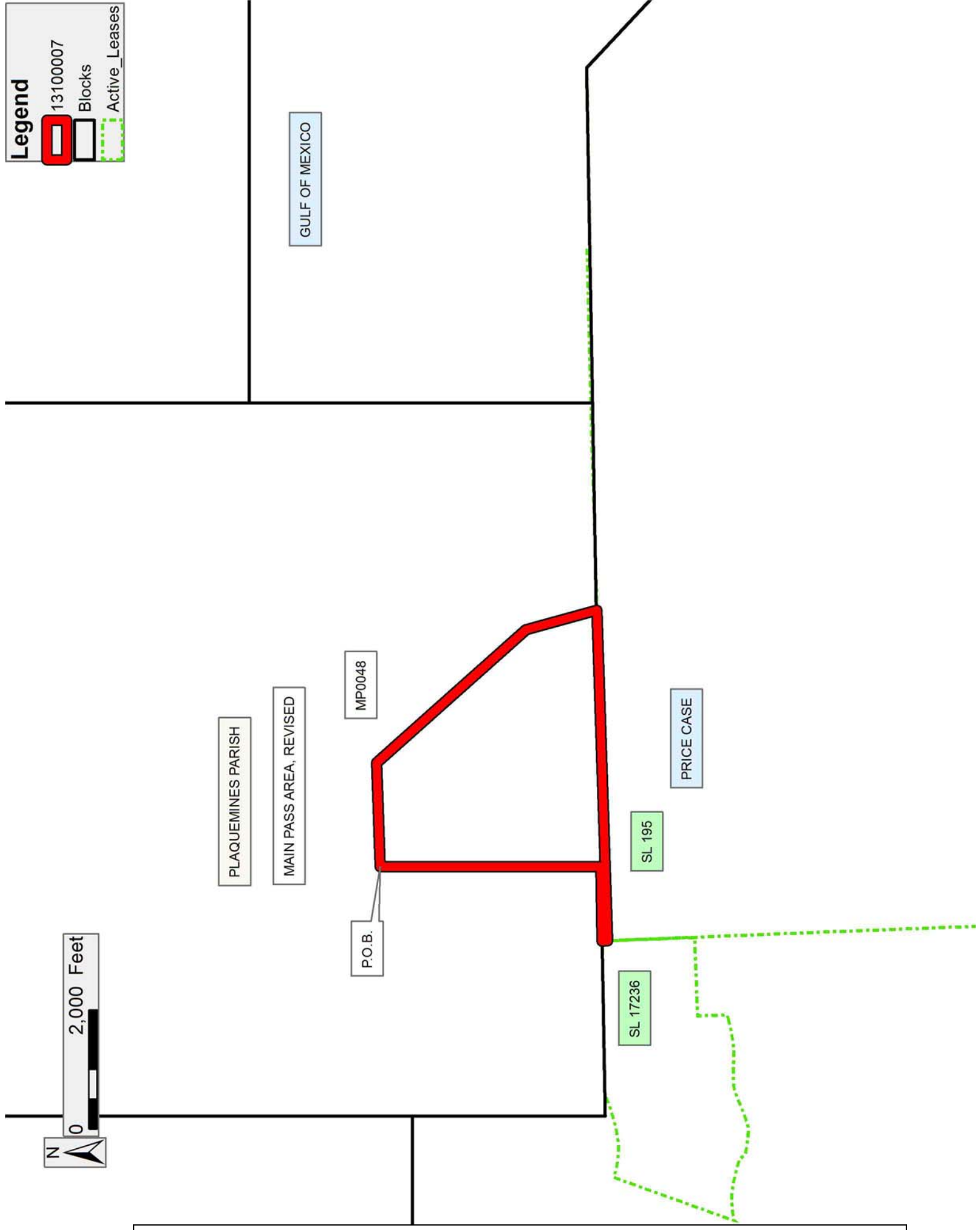

TRACT 43525 - Plaquemines Parish, Louisiana

All of the lands now or formerly constituting the beds and bottoms of all water bodies of every nature and description as to which title is vested in the State of Louisiana, together with all islands arising therein and other lands formed by accretion or by reliction, where allowed by law, excepting tax adjudicated lands, and not presently under mineral lease on October 9, 2013, situated in Plaquemines Parish, Louisiana, and more particularly described as follows: Beginning at a point on the Northeast corner of Price Tract B 1 and the Northwest corner of Price Tract C 3 having Coordinates of X = 2,638,295.40 and Y = 260,135.11; thence South 02 degrees 08 minutes 19 seconds East 16.11 to a point on a corner of State Lease No. 17236 having Coordinates of X = 2,638,296.00 and Y = 260,119.02; thence North 76 degrees 38 minutes 42 seconds West 64.98 feet along the boundary of said State Lease No. 17236 to a corner point of said State Lease No. 17236 having Coordinates of X = 2,638,232.78 and Y = 260,134.02; thence North 89 degrees 00 minutes 25 seconds East 62.63 feet to the point of beginning, containing 0.0116 gross acres and **0.0046 net acres**, all as more particularly outlined on a plat on file in the Office of Mineral Resources, Department of Natural Resources. All bearings, distances and coordinates are based on Louisiana Coordinate System of 1927, (North or South Zone), where applicable.

NOTE: The above description of the Tract nominated for lease has been provided and corrected, where required, exclusively by the nomination party. Any mineral lease selected from this Tract and awarded by the Louisiana State Mineral and Energy Board shall be without warranty of any kind, either express, implied, or statutory, including, but not limited to, the implied warranties of merchantability and fitness for a particular purpose. Should the mineral lease awarded by the Louisiana State Mineral and Energy Board be subsequently modified, cancelled or abrogated due to the existence of conflicting leases, operating agreements, private claims or other future obligations or conditions which may affect all or any portion of the leased Tract, it shall not relieve the Lessee of the obligation to pay any bonus due thereon to the Louisiana State Mineral and Energy Board, nor shall the Louisiana State Mineral and Energy Board be obligated to refund any consideration paid by the Lessor prior to such modification, cancellation, or abrogation, including, but not limited to, bonuses, rentals and royalties.

NOTE: The State of Louisiana does hereby reserve, and this lease shall be subject to, the imprescriptible right of surface use in the nature of a servitude in favor of the Department of Natural Resources, including its Offices and Commissions, for the sole purpose of implementing, constructing, servicing and maintaining approved coastal zone management and/or restoration projects. Utilization of any and all rights derived under this lease by the mineral lessee, its agents, successors or assigns, shall not interfere with nor hinder the reasonable surface use by the



Department of Natural Resources, its Offices or Commissions, as herein above reserved.

Applicant: ACADIAN LAND SERVICES, L.L.C.

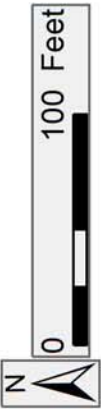
Bidder	Cash Payment	Price/Acre	Rental	Oil	Gas	Other



Legend

-  13100006
-  Blocks
-  Active_Leases

PLAQUEMINES PARISH

MP0048

MAIN PASS AREA, REVISED

P.O.B.

PRICE CASE

SL 17236

TRACT 43526 - Portion of Blocks 4 and 6, Grand Isle Area, Jefferson Parish, Louisiana

All of the lands now or formerly constituting the beds and bottoms of all water bodies of every nature and description as to which title is vested in the State of Louisiana, together with all islands arising therein and other lands formed by accretion or by reliction, where allowed by law, excepting tax adjudicated lands, and not presently under mineral lease on October 9, 2013, situated in Jefferson Parish, Louisiana, and more particularly described as follows: Beginning at a point on the East line Block 6, Grand Isle Area having Coordinates of X = 2,442,901.85 and Y = 207,672.44; thence West 14,758.04 feet to a point on the West line of said Block 6 having Coordinates of X = 2,428,143.81 and Y = 207,672.44; thence along the boundary of said Block 6 the following courses: North 829.78 feet to a point having Coordinates of X = 2,428,143.81 and Y = 208,502.22; North 57 degrees 30 minutes 48 seconds East 924.93 feet to a point having Coordinates of X = 2,428,924.00 and Y = 208,999.00; North 52 degrees 19 minutes 08 seconds East 1,581.96 feet to a point having Coordinates of X = 2,430,176.00 and Y = 209,966.00, North 56 degrees 35 minutes 46 seconds East 3,443.90 feet to a point having Coordinates of X = 2,433,051.00 and Y = 211,862.00; North 56 degrees 06 minutes 09 seconds East 4,057.66 feet to a point having Coordinates of X = 2,436,419.00 and Y = 214,125.00; and North 46 degrees 36 minutes 05 seconds East 1,348.44 feet to a point being the Southwest corner of Block 4, Grand Isle Area having Coordinates of X = 2,437,398.76 and Y = 215,051.47; thence North 46 degrees 36 minutes 05 seconds East 751.79 feet along the West line of said Block 4, to a point having Coordinates of X = 2,437,945.00 and Y = 215,568.00; thence South 84 degrees 03 minutes 03 seconds East 4,983.69 feet to a point having Coordinates of X = 2,442,901.85 and Y = 215,051.47; thence South 7,379.03 feet to the point of beginning, (This lease includes only waterbottoms claimed and owned by the state and specifically excludes any land which the state may claim or own and to which the mineral rights are vested in the state), containing approximately **1,817.10 acres**, all as more particularly outlined on a plat on file in the Office of Mineral Resources, Department of Natural Resources. All bearings, distances and coordinates are based on Louisiana Coordinate System of 1927, (North or South Zone), where applicable.

NOTE: The above description of the Tract nominated for lease has been provided and corrected, where required, exclusively by the nomination party. Any mineral lease selected from this Tract and awarded by the Louisiana State Mineral and Energy Board shall be without warranty of any kind, either express, implied, or statutory, including, but not limited to, the implied warranties of merchantability and fitness for a particular purpose. Should the mineral lease awarded by the Louisiana State Mineral and Energy Board be subsequently modified, cancelled or abrogated due to the existence of conflicting leases, operating agreements, private claims or other future obligations or conditions which may affect all or any portion of the leased Tract, it shall not relieve the Lessee of the obligation to pay any bonus due thereon to the Louisiana State Mineral and

Energy Board, nor shall the Louisiana State Mineral and Energy Board be obligated to refund any consideration paid by the Lessor prior to such modification, cancellation, or abrogation, including, but not limited to, bonuses, rentals and royalties.

NOTE: The State of Louisiana does hereby reserve, and this lease shall be subject to, the imprescriptible right of surface use in the nature of a servitude in favor of the Department of Natural Resources, including its Offices and Commissions, for the sole purpose of implementing, constructing, servicing and maintaining approved coastal zone management and/or restoration projects. Utilization of any and all rights derived under this lease by the mineral lessee, its agents, successors or assigns, shall not interfere with nor hinder the reasonable surface use by the Department of Natural Resources, its Offices or Commissions, as herein above reserved.

Applicant: BLANTON PETROLEUM CORP.

Bidder	Cash Payment	Price/Acre	Rental	Oil	Gas	Other

Legend
13100021
Blocks



TRACT 43527 - Portion of Block 8, Grand Isle Area, Plaquemines Parish, Louisiana

All of the lands now or formerly constituting the beds and bottoms of all water bodies of every nature and description as to which title is vested in the State of Louisiana, together with all islands arising therein and other lands formed by accretion or by reliction, where allowed by law, excepting tax adjudicated lands, and not presently under mineral lease on October 9, 2013, situated in Plaquemines Parish, Louisiana, and more particularly described as follows: Beginning at a point on the West line of Block 8, Grand Isle Area having Coordinates of X = 2,457,659.89 and Y = 207,823.02; thence North 7,228.45 feet along the West line of said Block 8 to its Northwest corner having Coordinates of X = 2,457,659.89 and Y = 215,051.47; thence East 14,758.04 feet along the North line of said Block 8 to its Northeast corner having Coordinates of X = 2,472,417.93 and Y = 215,051.47; thence South 7,228.45 feet along the East line of said Block 8 to a point having Coordinates of X = 2,472,417.93 and Y = 207,823.02; thence West 14,758.04 feet to the point of beginning, containing **2,448.98 acres**, all as more particularly outlined on a plat on file in the Office of Mineral Resources, Department of Natural Resources. All bearings, distances and coordinates are based on Louisiana Coordinate System of 1927, (North or South Zone), where applicable.

NOTE: The above description of the Tract nominated for lease has been provided and corrected, where required, exclusively by the nomination party. Any mineral lease selected from this Tract and awarded by the Louisiana State Mineral and Energy Board shall be without warranty of any kind, either express, implied, or statutory, including, but not limited to, the implied warranties of merchantability and fitness for a particular purpose. Should the mineral lease awarded by the Louisiana State Mineral and Energy Board be subsequently modified, cancelled or abrogated due to the existence of conflicting leases, operating agreements, private claims or other future obligations or conditions which may affect all or any portion of the leased Tract, it shall not relieve the Lessee of the obligation to pay any bonus due thereon to the Louisiana State Mineral and Energy Board, nor shall the Louisiana State Mineral and Energy Board be obligated to refund any consideration paid by the Lessor prior to such modification, cancellation, or abrogation, including, but not limited to, bonuses, rentals and royalties.

NOTE: The State of Louisiana does hereby reserve, and this lease shall be subject to, the imprescriptible right of surface use in the nature of a servitude in favor of the Department of Natural Resources, including its Offices and Commissions, for the sole purpose of implementing, constructing, servicing and maintaining approved coastal zone management and/or restoration projects. Utilization of any and all rights derived under this lease by the mineral lessee, its agents, successors or assigns, shall not interfere with nor hinder the reasonable surface use by the Department of Natural Resources, its Offices or Commissions, as herein above reserved.

NOTE: It appears, according to our records, that a portion of this Tract is located within the restrictive safety fairway area as set out by the Corps of Engineers, U.S. Army and/or the restrictive anchorage area as set out by the U.S. Coast Guard.

Applicant: BLANTON PETROLEUM CORP.

Bidder	Cash Payment	Price/Acre	Rental	Oil	Gas	Other

Legend
13100027
Blocks

WEST DELTA AREA

GULF OF MEXICO

PLAQUEMINES PARISH

GI0002

GRAND ISLE AREA

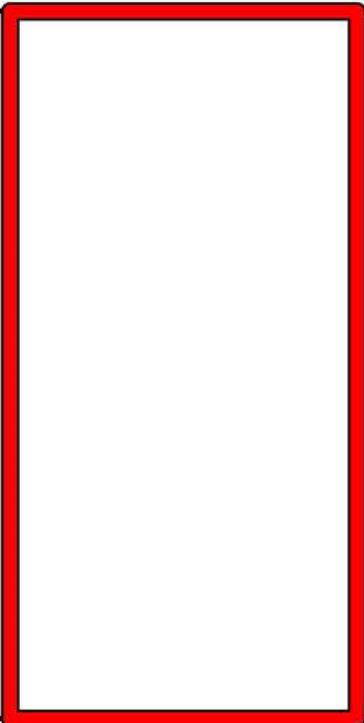

P.O.B.

GI0007

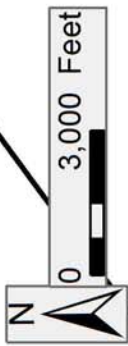

TRACT 43528 - Portion of Block 7, Grand Isle Area, Jefferson and Plaquemines Parishes, Louisiana

All of the lands now or formerly constituting the beds and bottoms of all water bodies of every nature and description as to which title is vested in the State of Louisiana, together with all islands arising therein and other lands formed by accretion or by reliction, where allowed by law, excepting tax adjudicated lands, and not presently under mineral lease on October 9, 2013, situated in Jefferson and Plaquemines Parishes, Louisiana, and more particularly described as follows: Beginning at a point on the South line of Block 7, Grand Isle Area having Coordinates of X = 2,450,280.88 and Y = 200,293.43; thence North 14,758.04 feet to a point on the North line of said Block 7 having Coordinates of X = 2,450,280.88 and Y = 215,051.47; thence East 7,379.01 feet along the North line of said Block 7 to its Northeast corner having Coordinates of X = 2,457,659.89 and Y = 215,051.47; thence South 14,758.04 feet along the East line of said Block 7 to a point having Coordinates of X = 2,457,659.89 and Y = 200,293.43; thence West 7,379.01 feet along the South line of said Block 7 to the point of beginning, containing **2,499.99 acres**, all as more particularly outlined on a plat on file in the Office of Mineral Resources, Department of Natural Resources. All bearings, distances and coordinates are based on Louisiana Coordinate System of 1927, (North or South Zone), where applicable.

NOTE: The above description of the Tract nominated for lease has been provided and corrected, where required, exclusively by the nomination party. Any mineral lease selected from this Tract and awarded by the Louisiana State Mineral and Energy Board shall be without warranty of any kind, either express, implied, or statutory, including, but not limited to, the implied warranties of merchantability and fitness for a particular purpose. Should the mineral lease awarded by the Louisiana State Mineral and Energy Board be subsequently modified, cancelled or abrogated due to the existence of conflicting leases, operating agreements, private claims or other future obligations or conditions which may affect all or any portion of the leased Tract, it shall not relieve the Lessee of the obligation to pay any bonus due thereon to the Louisiana State Mineral and Energy Board, nor shall the Louisiana State Mineral and Energy Board be obligated to refund any consideration paid by the Lessor prior to such modification, cancellation, or abrogation, including, but not limited to, bonuses, rentals and royalties.

NOTE: The State of Louisiana does hereby reserve, and this lease shall be subject to, the imprescriptible right of surface use in the nature of a servitude in favor of the Department of Natural Resources, including its Offices and Commissions, for the sole purpose of implementing, constructing, servicing and maintaining approved coastal zone management and/or restoration projects. Utilization of any and all rights derived under this lease by the mineral lessee, its agents, successors or assigns, shall not interfere with nor hinder the reasonable surface use by the

Department of Natural Resources, its Offices or Commissions, as herein above reserved.

NOTE: It appears, according to our records, that a portion of this Tract is located within the restrictive safety fairway area as set out by the Corps of Engineers, U.S. Army and/or the restrictive anchorage area as set out by the U.S. Coast Guard.

Applicant: BLANTON PETROLEUM CORP.

Bidder	Cash Payment	Price/Acre	Rental	Oil	Gas	Other

Legend
13100026
Blocks



GI0002

PLAQUEMINES PARISH

GI0008

GULF OF MEXICO

GI0003

JEFFERSON PARISH

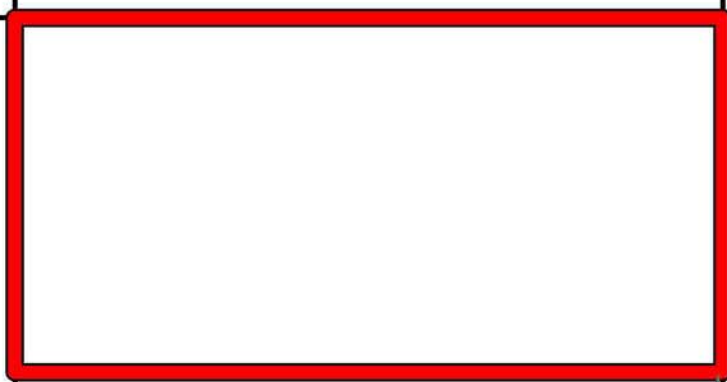

GI0007

P.O.B.

GI0006



TRACT 43529 - Portion of Block 1, South Pass Area, Plaquemines Parish, Louisiana

All of the lands now or formerly constituting the beds and bottoms of all water bodies of every nature and description as to which title is vested in the State of Louisiana, together with all islands arising therein and other lands formed by accretion or by reliction, where allowed by law, excepting tax adjudicated lands, and not presently under mineral lease on October 9, 2013, situated in Plaquemines Parish, Louisiana, and more particularly described as follows: Beginning at the Southeast corner of Block 1, South Pass Area having Coordinates of X = 2,748,750.00 and Y = 202,972.00; thence along the boundary of said Block 1 the following courses: West 13,238.60 feet to a point having Coordinates of X = 2,735,511.40 and Y = 202,971.99 and North 30 degrees 27 minutes 46 seconds West 9,538.83 feet to a point on the Louisiana Coastline, as decreed by the Supreme Court of the United States, as determined by a Special Master appointed therein, in litigation styled *United States v. State of Louisiana et al No. 9 Original*, in 1975, having Coordinates of X = 2,730,675.41 and Y = 211,194.08; thence along said Coastline the following courses: Southeasterly on a straight line to a point having Coordinates of X = 2,734,900 and Y = 209,275; Northeasterly on a straight line to a point having Coordinates of X = 2,737,065 and Y = 210,155; Northeasterly on a straight line to a point having Coordinates of X = 2,738,320 and Y = 210,230; Southeasterly on a straight line to a point having Coordinates of X = 2,738,938 and Y = 209,975; and Southeasterly on a straight line to a point on the East line of said Block 1 having Coordinates of X = 2,748,750.00 and Y = 207,118.67; thence South 4,146.67 feet along the East line of said Block 1 to the point of beginning, **LESS AND EXCEPT** that portion that falls inside of the Pass-A-Loutre Wildlife Management Area, that may lie within the above described tract, containing approximately **606 acres**, all as more particularly outlined on a plat on file in the Office of Mineral Resources, Department of Natural Resources. All bearings, distances and coordinates are based on Louisiana Coordinate System of 1927, (North or South Zone), where applicable.

NOTE: The above description of the Tract nominated for lease has been provided and corrected, where required, exclusively by the nomination party. Any mineral lease selected from this Tract and awarded by the Louisiana State Mineral and Energy Board shall be without warranty of any kind, either express, implied, or statutory, including, but not limited to, the implied warranties of merchantability and fitness for a particular purpose. Should the mineral lease awarded by the Louisiana State Mineral and Energy Board be subsequently modified, cancelled or abrogated due to the existence of conflicting leases, operating agreements, private claims or other future obligations or conditions which may affect all or any portion of the leased Tract, it shall not relieve the Lessee of the obligation to pay any bonus due thereon to the Louisiana State Mineral and Energy Board, nor shall the Louisiana State Mineral and Energy Board be obligated to refund any consideration paid by the Lessor prior to such

modification, cancellation, or abrogation, including, but not limited to, bonuses, rentals and royalties.

NOTE: The State of Louisiana does hereby reserve, and this lease shall be subject to, the imprescriptible right of surface use in the nature of a servitude in favor of the Department of Natural Resources, including its Offices and Commissions, for the sole purpose of implementing, constructing, servicing and maintaining approved coastal zone management and/or restoration projects. Utilization of any and all rights derived under this lease by the mineral lessee, its agents, successors or assigns, shall not interfere with nor hinder the reasonable surface use by the Department of Natural Resources, its Offices or Commissions, as herein above reserved.

NOTE: This tract is located in an area designated by the Louisiana Legislature or the Wildlife and Fisheries Commission as a Public Oyster Seed Ground, Reservation, or area of Calcasieu or Sabine Lake. Proposed projects occurring in these areas will be evaluated on a case by case basis by Louisiana Department of Wildlife & Fisheries. Modifications to proposed project features including, but not limited to, access routes, well sites, flowlines, and appurtenant structures maybe required by the Louisiana Department of Wildlife and Fisheries. In addition, compensatory mitigation will be required to offset unavoidable habitat impacts.

Applicant: COMMON POINT RESOURCES

Bidder	Cash Payment	Price/Acre	Rental	Oil	Gas	Other

1310004:

- Wildlife
- Blocks

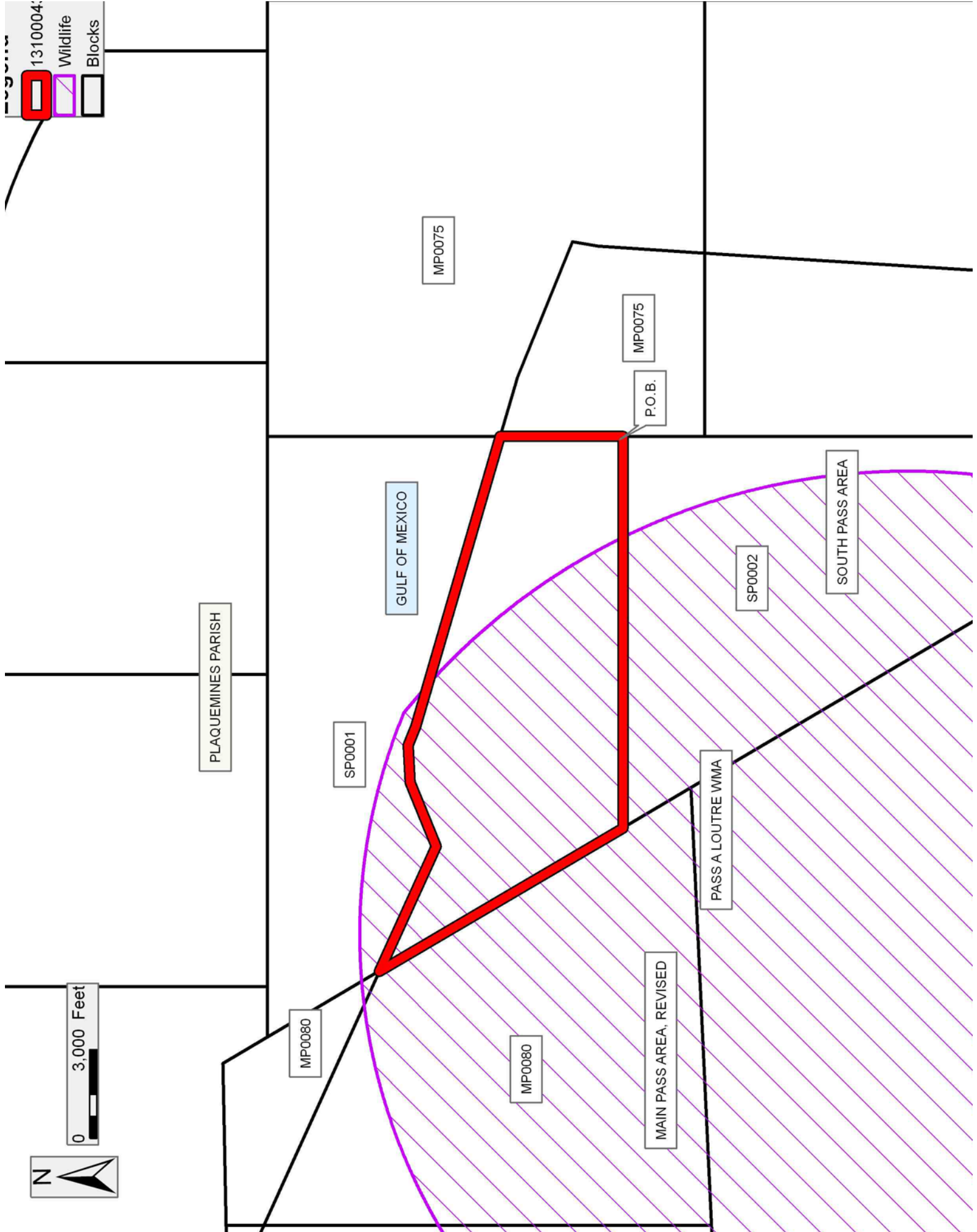

TRACT 43530 - Portion of Block 7, Grand Isle Area, Jefferson Parish, Louisiana

All of the lands now or formerly constituting the beds and bottoms of all water bodies of every nature and description as to which title is vested in the State of Louisiana, together with all islands arising therein and other lands formed by accretion or by reliction, where allowed by law, excepting tax adjudicated lands, and not presently under mineral lease on October 9, 2013, situated in Jefferson Parish, Louisiana, and more particularly described as follows: Beginning at the Southwest corner of Block 7, Grand Isle Area having Coordinates of X = 2,442,901.85 and Y = 200,293.43; thence North 14,758.04 feet along the West line of said Block 7 to its Northwest corner having Coordinates of X = 2,442,901.85 and Y = 215,051.46; thence East 7,379.03 feet along the North line of said Block 7 to a point having Coordinates of X = 2,450,280.88 and Y = 215,051.47; thence South 14,758.04 feet to a point on the South line of said Block 7 having Coordinates of X = 2,450,280.88 and Y = 200,293.43; thence West 7,379.03 feet along the South line of said Block to the point of beginning, containing **2,500.00 acres**, all as more particularly outlined on a plat on file in the Office of Mineral Resources, Department of Natural Resources. All bearings, distances and coordinates are based on Louisiana Coordinate System of 1927, (North or South Zone), where applicable.

NOTE: The above description of the Tract nominated for lease has been provided and corrected, where required, exclusively by the nomination party. Any mineral lease selected from this Tract and awarded by the Louisiana State Mineral and Energy Board shall be without warranty of any kind, either express, implied, or statutory, including, but not limited to, the implied warranties of merchantability and fitness for a particular purpose. Should the mineral lease awarded by the Louisiana State Mineral and Energy Board be subsequently modified, cancelled or abrogated due to the existence of conflicting leases, operating agreements, private claims or other future obligations or conditions which may affect all or any portion of the leased Tract, it shall not relieve the Lessee of the obligation to pay any bonus due thereon to the Louisiana State Mineral and Energy Board, nor shall the Louisiana State Mineral and Energy Board be obligated to refund any consideration paid by the Lessor prior to such modification, cancellation, or abrogation, including, but not limited to, bonuses, rentals and royalties.

NOTE: The State of Louisiana does hereby reserve, and this lease shall be subject to, the imprescriptible right of surface use in the nature of a servitude in favor of the Department of Natural Resources, including its Offices and Commissions, for the sole purpose of implementing, constructing, servicing and maintaining approved coastal zone management and/or restoration projects. Utilization of any and all rights derived under this lease by the mineral lessee, its agents, successors or assigns, shall not interfere with nor hinder the reasonable surface use by the Department of Natural Resources, its Offices or Commissions, as herein above reserved.

NOTE: It appears, according to our records, that a portion of this Tract is located within the restrictive safety fairway area as set out by the Corps of Engineers, U.S. Army and/or the restrictive anchorage area as set out by the U.S. Coast Guard.

Applicant: BLANTON PETROLEUM CORP.

Bidder	Cash Payment	Price/Acre	Rental	Oil	Gas	Other

Legend
13100022
Blocks

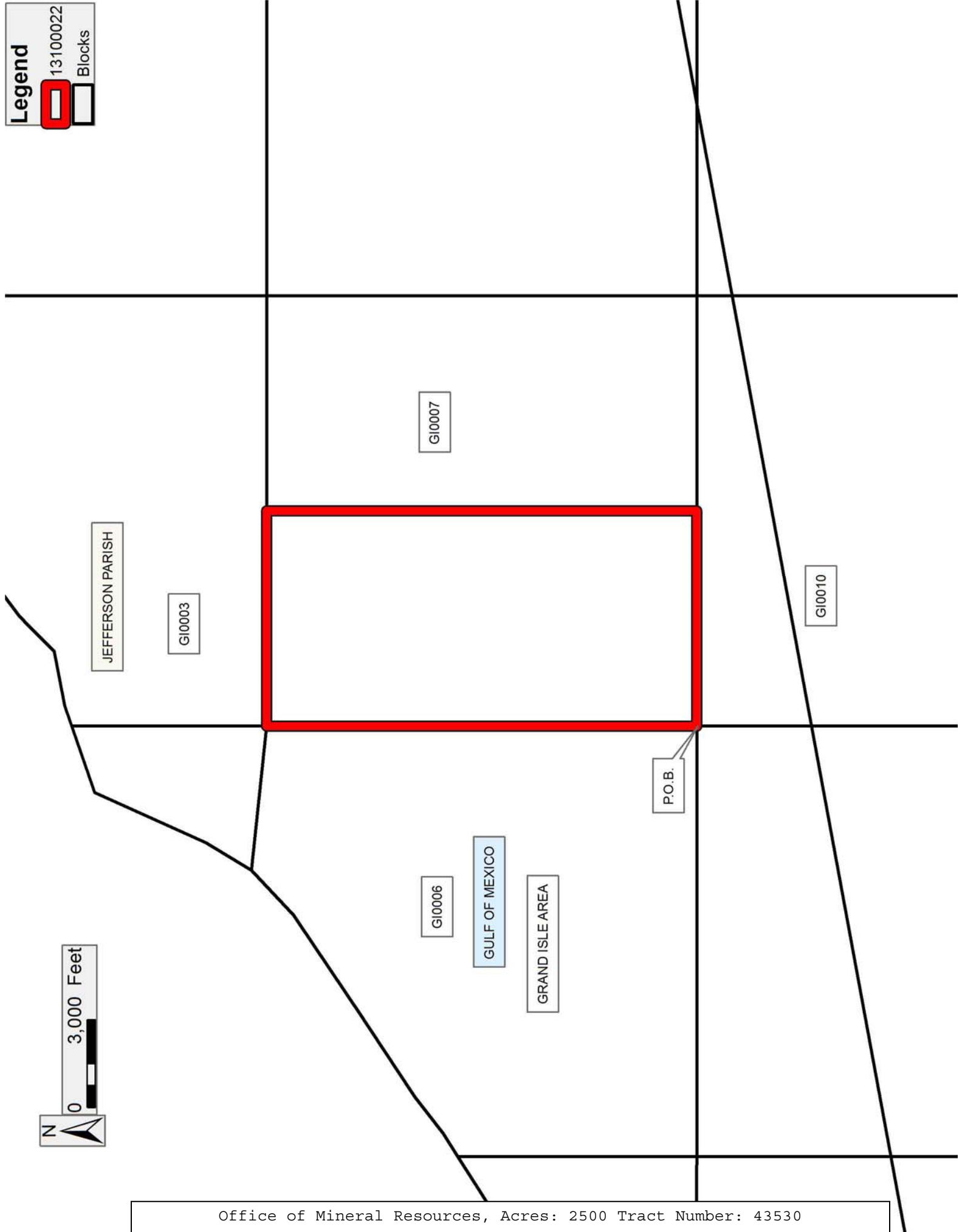

TRACT 43531 - Portion of Block 75, Main Pass Area, Revised, Plaquemines Parish, Louisiana

All of the lands now or formerly constituting the beds and bottoms of all water bodies of every nature and description as to which title is vested in the State of Louisiana, together with all islands arising therein and other lands formed by accretion or by reliction, where allowed by law, excepting tax adjudicated lands, and not presently under mineral lease on October 9, 2013, situated in Plaquemines Parish, Louisiana, and more particularly described as follows: Beginning at the Southwest corner of Block 75, Main Pass Area, Revised, having Coordinates of X = 2,748,750.00 and Y = 200,214.00; thence North 6,904.67 feet along the West line of said Block 75 to a point on the Louisiana Coastline, as decreed by the Supreme Court of the United States, as determined by a Special Master appointed therein, in litigation styled *United States v. State of Louisiana et al No. 9 Original*, in 1975, having Coordinates of X = 2,748,750.00 and Y = 207,118.67; thence along said Coastline the following courses: Southeasterly on a straight line to a point having Coordinates of X = 2,750,755 and Y = 206,535; Southeasterly on a straight line to a point having Coordinates of X = 2,755,325 and Y = 204,680; and Southwesterly on a straight line to a point having Coordinates of X = 2,755,178.00 and Y = 203,815.00; and Southwesterly on a straight line to a point on the South line of said Block 75 having Coordinates of X = 2,754,948.30 and Y = 200,214.00; thence West 6,198.30 feet along the South line of said Block 75 to the point of beginning, containing **847.12 acres**, all as more particularly outlined on a plat on file in the Office of Mineral Resources, Department of Natural Resources. All bearings, distances and coordinates are based on Louisiana Coordinate System of 1927, (North or South Zone), where applicable.

NOTE: The above description of the Tract nominated for lease has been provided and corrected, where required, exclusively by the nomination party. Any mineral lease selected from this Tract and awarded by the Louisiana State Mineral and Energy Board shall be without warranty of any kind, either express, implied, or statutory, including, but not limited to, the implied warranties of merchantability and fitness for a particular purpose. Should the mineral lease awarded by the Louisiana State Mineral and Energy Board be subsequently modified, cancelled or abrogated due to the existence of conflicting leases, operating agreements, private claims or other future obligations or conditions which may affect all or any portion of the leased Tract, it shall not relieve the Lessee of the obligation to pay any bonus due thereon to the Louisiana State Mineral and Energy Board, nor shall the Louisiana State Mineral and Energy Board be obligated to refund any consideration paid by the Lessor prior to such modification, cancellation, or abrogation, including, but not limited to, bonuses, rentals and royalties.

NOTE: The State of Louisiana does hereby reserve, and this lease shall be subject to, the imprescriptible right of surface use in the nature of a servitude in favor of the Department of Natural Resources, including its

Offices and Commissions, for the sole purpose of implementing, constructing, servicing and maintaining approved coastal zone management and/or restoration projects. Utilization of any and all rights derived under this lease by the mineral lessee, its agents, successors or assigns, shall not interfere with nor hinder the reasonable surface use by the Department of Natural Resources, its Offices or Commissions, as herein above reserved.

Applicant: COMMON POINT RESOURCES

Bidder	Cash Payment	Price/Acre	Rental	Oil	Gas	Other



0 2,000 Feet

PLAQUEMINES PARISH

GULF OF MEXICO

MP0075

MAIN PASS AREA, REVISED

MP0076

MP0076

P.O.B.

SP0001

SOUTH PASS AREA

SP0002