

**TRACT 42869 - Plaquemines Parish, Louisiana**

All State owned lands and water bottoms located within the boundaries of the Pass-A-Loutre Wildlife Management Area as defined by the Department of Wildlife and Fisheries incorporating a title opinion from the Office of the Governor dated August 3, 1998, not presently under mineral lease by the State of Louisiana on August 8, 2012, all as set forth following: Beginning at a point within the Pass-A-Loutre Wildlife Management Area, also being a point on the South boundary of State Lease No. 2090, as amended having Coordinates of X = 2,721,700.00 and Y = 161,132.83; thence North 89 degrees 23 minutes 41 seconds East 1,909.11 feet along the South boundary of said State Lease No. 2090 to its Southeast corner located on the West boundary of State Lease No. 1927, as amended having Coordinates of X = 2,723,609.00 and Y = 161,153.00; thence along the West and East boundary of said State Lease No. 1927 the following courses and distances: South 16 degrees 03 minutes 59 seconds West 130.08 feet to a corner having Coordinates of X = 2,723,573.00 and Y = 161,028.00, South 49 degrees 53 minutes 57 seconds East 74.52 feet to a corner having Coordinates of X = 2,723,630.00 and Y = 160,980.00, North 48 degrees 00 minutes 47 seconds East 1,076.23 feet to a corner having Coordinates of X = 2,724,429.96 and Y = 161,699.96, South 63 degrees 11 minutes 21 seconds East 502.23 feet to a corner having Coordinates of X = 2,724,878.20 and Y = 161,473.43, North 59 degrees 17 minutes 02 seconds East 803.21 feet to a corner having Coordinates of X = 2,725,568.73 and Y = 161,883.70 and North 59 degrees 17 minutes 02 seconds East 126.92 feet to a point having Coordinates of X = 2,725,677.84 and Y = 161,948.53; thence North 88 degrees 20 minutes 44 seconds East 8,541.84 feet to a point located on the East boundary of the Pass-A-Loutre Wildlife Management Area having Coordinates of X = 2,734,216.12 and Y = 162,195.16; thence South 27 degrees 15 minutes 54 seconds West 10,906.94 feet along the East boundary of the said Pass-A-Loutre Wildlife Management Area to a point having Coordinates of X = 2,729,219.60 and Y = 152,500.00; thence West 10,419.60 feet to a point having Coordinates of X = 2,718,800.00 and Y = 152,500.00; thence North 3,000.00 feet to the Southwest corner of State Lease No. 16867 having Coordinates of X = 2,718,800.00 and Y = 155,500.00; thence along the South and East boundary of said State Lease No. 16867 the following courses and distances: East 2,900.00 feet to a corner having Coordinates of X = 2,721,700.00 and Y = 155,500.00 and North 4,800.00 feet to its Northeast corner having Coordinates of X = 2,721,700.00 and Y = 160,300.00; thence North 832.83 feet to the point of beginning, containing approximately **2,327.62 acres, LESS AND EXCEPT** any privately owned land that may be located within the above described Tract, if any, all as more particularly outlined on a plat on file in the Office of Mineral Resources, Department of Natural Resources. All bearings, distances and coordinates are based on Louisiana Coordinate System of 1927, (South Zone).

NOTE: The above description of the Tract nominated for lease has been provided and corrected, where required, exclusively by the nomination party. Any mineral lease selected from this Tract and awarded by the Louisiana State Mineral and Energy Board shall be without warranty of any

kind, either express, implied, or statutory, including, but not limited to, the implied warranties of merchantability and fitness for a particular purpose. Should the mineral lease awarded by the Louisiana State Mineral and Energy Board be subsequently modified, cancelled or abrogated due to the existence of conflicting leases, operating agreements, private claims or other future obligations or conditions which may affect all or any portion of the leased Tract, it shall not relieve the Lessee of the obligation to pay any bonus due thereon to the Louisiana State Mineral and Energy Board, nor shall the Louisiana State Mineral and Energy Board be obligated to refund any consideration paid by the Lessor prior to such modification, cancellation, or abrogation, including, but not limited to, bonuses, rentals and royalties.

NOTE: The mineral lease is located in the Pass-A-Loutre WMA under the jurisdiction of the Louisiana Department of Wildlife and Fisheries which has promulgated rules and regulations for the protection of game and wildlife on the aforesaid Tract and, therefore, shall be subject to said rules and regulations, a copy of which shall be attached to the mineral lease. In addition to the specific rules and regulations applicable, the following shall apply regarding operations under this mineral lease:

NOTE: No activities will be allowed without written authorization from the Louisiana Department of Wildlife and Fisheries.

NOTE: Proposed projects will be evaluated on a case by case basis. Modifications to proposed project features including but not limited to access routes, spoil placement, well sites, flowlines and appurtenant structures may be required by the Department of Wildlife and Fisheries.

NOTE: Compliance with the said WMA regulations will be required unless otherwise specified by the Department of Wildlife and Fisheries.

NOTE: Compensatory mitigation will be required to offset unavoidable wetland impacts.

NOTE: Removal of all structures, facilities and equipment will be required within 120 days of abandonment unless otherwise agreed to in writing by the Louisiana Department of Wildlife and Fisheries.

NOTE: No activities will be allowed during the hunting season unless approved by the Department.

NOTE: Prior to submitting applications for wetland permits to Federal and State permitting agencies the leaseholder shall coordinate project details with the Department of Wildlife and Fisheries. Contact person for the Department will be Mike Windham at (504) 284-5268.

NOTE: Additionally, the Department will require a minimum bonus of \$350.00 per acre and a minimum royalty of 25%.

NOTE: The State of Louisiana does hereby reserve, and this lease shall be subject to, the imprescriptible right of surface use in the nature of a servitude in favor of the Department of Natural Resources, including its Offices and Commissions, for the sole purpose of implementing, constructing, servicing and maintaining approved coastal zone management and/or restoration projects. Utilization of any and all rights derived under this lease by the mineral lessee, its agents, successors or assigns, shall not interfere with nor hinder the reasonable surface use by the Department of Natural Resources, its Offices or Commissions, as herein above reserved.

Applicant: THEOPHILUS OIL, GAS & LAND SERVICES, LLC

Bidder	Cash Payment	Price/Acre	Rental	Oil	Gas	Other

**Legend**

- 12080112
- Wildlife
- Blocks
- Active\_Leases

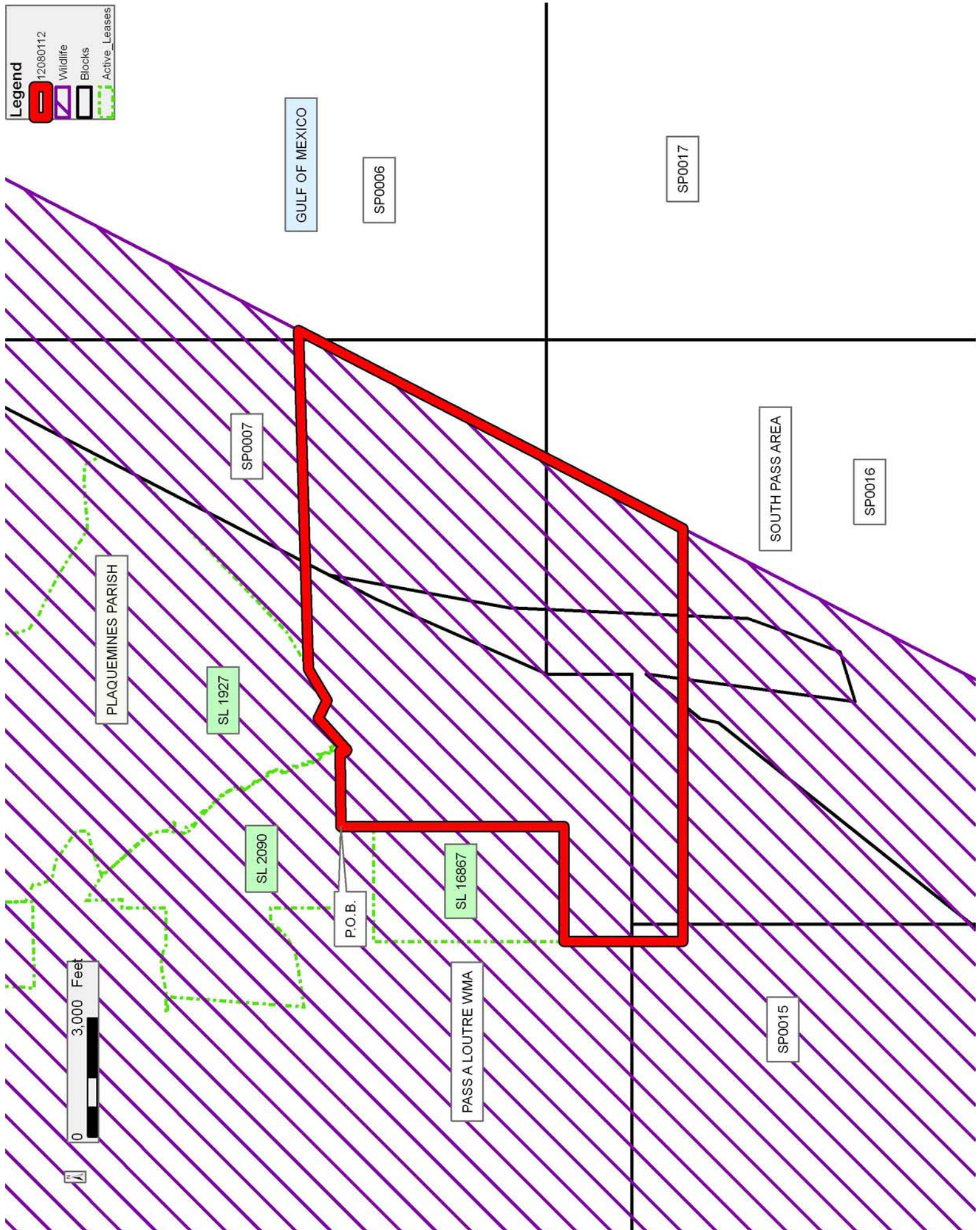



**TRACT 42870 - Plaquemines Parish, Louisiana**

All State owned lands and water bottoms located within the boundaries of the Pass-A-Loutre Wildlife Management Area as defined by the Department of Wildlife and Fisheries incorporating a title opinion from the Office of the Governor dated August 3, 1998, not presently under mineral lease by the State of Louisiana on August 8, 2012, all as set forth following: Beginning at a point within the Pass-A-Loutre Wildlife Management Area, having Coordinates of X = 2,718,800.00 and Y = 152,500.00; thence East 10,419.60 feet to a point on the East boundary of said Pass-A Loutre-Wildlife Management Area having Coordinates of X = 2,729,219.60 and Y = 152,500.00; thence South 27 degrees 15 minutes 54 seconds West 11,249.88 feet along the East boundary of the said Pass-A-Loutre Wildlife Management Area to point having Coordinates of X = 2,724,065.98 and Y = 142,500.00; thence West 5,265.98 feet to a point having Coordinates of X = 2,718,800.00 and Y = 142,500.00; thence North 10,000.00 feet to the point of beginning, containing approximately **1,800.46 acres, LESS AND EXCEPT** any privately owned land that may be located within the above described Tract, if any, all as more particularly outlined on a plat on file in the Office of Mineral Resources, Department of Natural Resources. All bearings, distances and coordinates are based on Louisiana Coordinate System of 1927, (South Zone).

NOTE: The above description of the Tract nominated for lease has been provided and corrected, where required, exclusively by the nomination party. Any mineral lease selected from this Tract and awarded by the Louisiana State Mineral and Energy Board shall be without warranty of any kind, either express, implied, or statutory, including, but not limited to, the implied warranties of merchantability and fitness for a particular purpose. Should the mineral lease awarded by the Louisiana State Mineral and Energy Board be subsequently modified, cancelled or abrogated due to the existence of conflicting leases, operating agreements, private claims or other future obligations or conditions which may affect all or any portion of the leased Tract, it shall not relieve the Lessee of the obligation to pay any bonus due thereon to the Louisiana State Mineral and Energy Board, nor shall the Louisiana State Mineral and Energy Board be obligated to refund any consideration paid by the Lessor prior to such modification, cancellation, or abrogation, including, but not limited to, bonuses, rentals and royalties.

NOTE: The mineral lease is located in the Pass-A-Loutre WMA under the jurisdiction of the Louisiana Department of Wildlife and Fisheries which has promulgated rules and regulations for the protection of game and wildlife on the aforesaid Tract and, therefore, shall be subject to said rules and regulations, a copy of which shall be attached to the mineral lease. In addition to the specific rules and regulations applicable, the following shall apply regarding operations under this mineral lease:

NOTE: No activities will be allowed without written authorization from the Louisiana Department of Wildlife and Fisheries.

NOTE: Proposed projects will be evaluated on a case by case basis. Modifications to proposed project features including but not limited to access routes, spoil placement, well sites, flowlines and appurtenant structures may be required by the Department of Wildlife and Fisheries.

NOTE: Compliance with the said WMA regulations will be required unless otherwise specified by the Department of Wildlife and Fisheries.

NOTE: Compensatory mitigation will be required to offset unavoidable wetland impacts.

NOTE: Removal of all structures, facilities and equipment will be required within 120 days of abandonment unless otherwise agreed to in writing by the Louisiana Department of Wildlife and Fisheries.

NOTE: No activities will be allowed during the hunting season unless approved by the Department.

NOTE: Prior to submitting applications for wetland permits to Federal and State permitting agencies the leaseholder shall coordinate project details with the Department of Wildlife and Fisheries. Contact person for the Department will be Mike Windham at (504) 284-5268.

NOTE: Additionally, the Department will require a minimum bonus of \$350.00 per acre and a minimum royalty of 25%.

NOTE: The State of Louisiana does hereby reserve, and this lease shall be subject to, the imprescriptible right of surface use in the nature of a servitude in favor of the Department of Natural Resources, including its Offices and Commissions, for the sole purpose of implementing, constructing, servicing and maintaining approved coastal zone management and/or restoration projects. Utilization of any and all rights derived under this lease by the mineral lessee, its agents, successors or assigns, shall not interfere with nor hinder the reasonable surface use by the Department of Natural Resources, its Offices or Commissions, as herein above reserved.

NOTE: It appears, according to our records, that a portion of this Tract is located within the restrictive safety fairway area as set out by the Corps of Engineers, U.S. Army and/or the restrictive anchorage area as set out by the U.S. Coast Guard.

Applicant: THEOPHILUS OIL, GAS & LAND SERVICES, LLC

Bidder	Cash Payment	Price/Acre	Rental	Oil	Gas	Other

**Legend**

- 12080113
- Wildlife
- Blocks

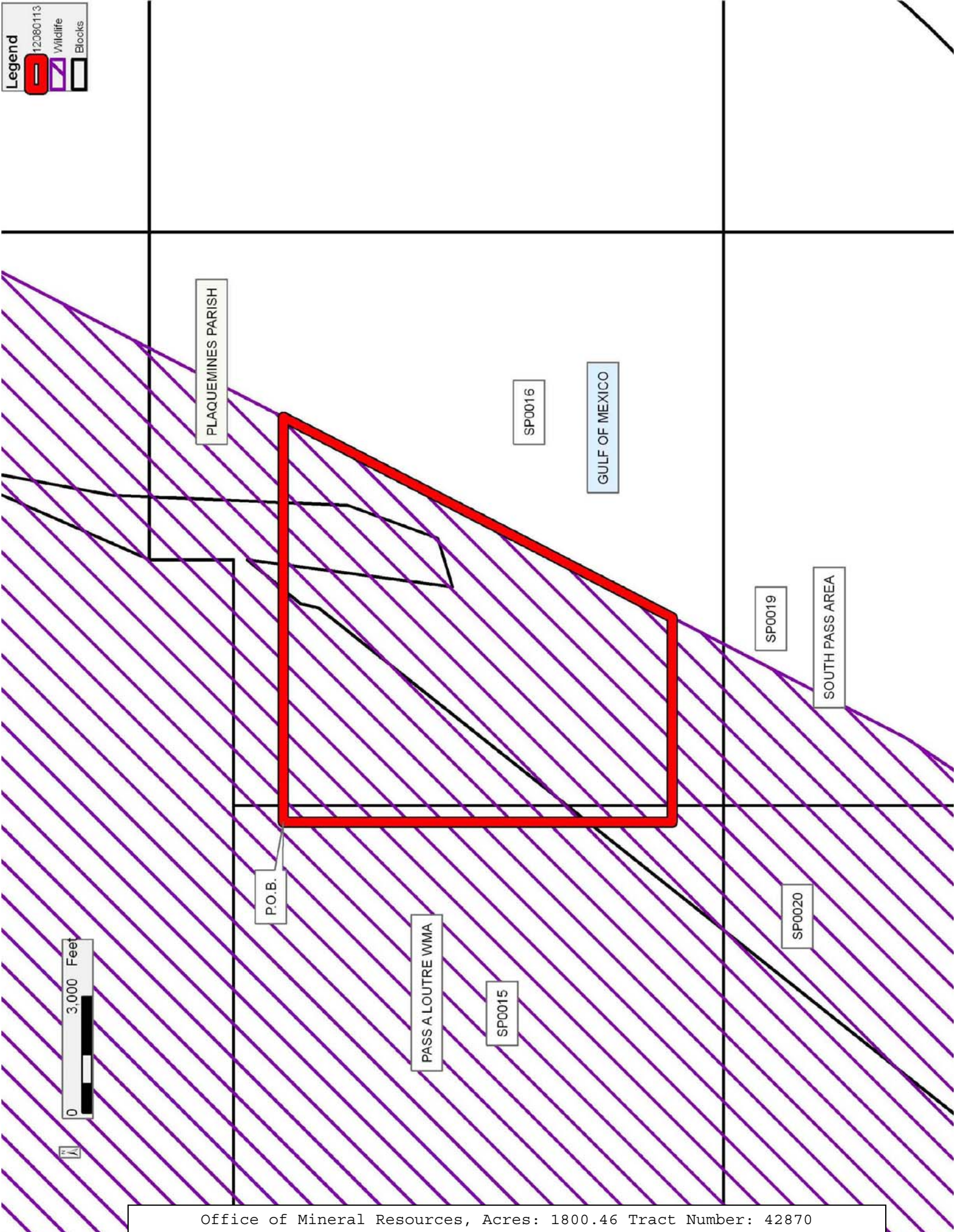



**Legend**

- 12080113
- Wildlife
- Blocks

