

TRACT 41417 - Portion of Block 25, South Pass Area, Plaquemines Parish, Louisiana

The beds and bottoms of all water bodies belonging to the State of Louisiana located in Block 25, South Pass Area, together with any present lands formed by accretion to the shoreline or islands formed therein, located in Plaquemines Parish, Louisiana, owned by and not presently under mineral lease as of May 12, 2010, from the State of Louisiana, the geographical area of which is more fully described as follows: Beginning at a point on the East Line of Block 25, South Pass Area, also being a Southeast corner of State Lease No. 1009, as amended, having Coordinates of X = 2,645,444.00 and Y = 134,784.29; thence South approximately 7,854 feet along the East line of said Block 25 to a Northeast corner of said State Lease No. 1009 having a Coordinate of X = 2,645,444.00; thence Southwesterly approximately 628 feet along the boundary of said State Lease No. 1009 to a point on the South line of said Block 25 having a Coordinate of Y = 126,424.00; thence West approximately 6,551 feet along the South line of said Block 25 to a point on the Louisiana Coastline, as decreed by the Supreme Court of the United States, as determined by a Special Master appointed therein, in litigation styled *United States v. State of Louisiana et al No. 9 Original*, in 1975, having Coordinates of X = 2,638,542.98 and Y = 126,424.00; thence along said Louisiana Coastline the following courses: Northeasterly on a straight line to a point having Coordinates of X = 2,638,945 and Y = 126,780, Easterly on a straight line to a point having Coordinates of X = 2,639,545 and Y = 126,825, Northeasterly on a straight line to a point having Coordinates of X = 2,641,835 and Y = 129,725, Northeasterly on a straight line to a point having Coordinates of X = 2,644,940 and Y = 134,910 and Northeasterly on a straight line to a point on the boundary of said State Lease No. 1009 having Coordinates of X = 2,645,239.45 and Y = 134,984.77; thence South 45 degrees 34 minutes 34 seconds East 286.41 feet along the boundary of said State Lease No. 1009 to the point of beginning, **LESS AND EXCEPT** any portion of said State Lease No. 1009 that may lie within the above described tract, containing approximately **620 acres**, all as more particularly outlined on a plat on file in the Office of Mineral Resources, Department of Natural Resources. All bearings, distances and coordinates are based on Louisiana Coordinate System of 1927, (North or South Zone).

NOTE: The above description of the Tract nominated for lease has been provided and corrected, where required, exclusively by the nomination party. Any mineral lease selected from this Tract and awarded by the Louisiana State Mineral Board shall be without warranty of any kind, either express, implied, or statutory, including, but not limited to, the implied warranties of merchantability and fitness for a particular purpose. Should the mineral lease awarded by the Louisiana State Mineral Board be subsequently modified, cancelled or abrogated due to the existence of conflicting leases, operating agreements, private claims or other future obligations or conditions which may affect all or any portion of the leased Tract, it shall not relieve the Lessee of the obligation to

pay any bonus due thereon to the Louisiana State Mineral Board, nor shall the Louisiana State Mineral Board be obligated to refund any consideration paid by the Lessor prior to such modification, cancellation, or abrogation, including, but not limited to, bonuses, rentals and royalties.

NOTE: The State of Louisiana does hereby reserve, and this lease shall be subject to, the imprescriptible right of surface use in the nature of a servitude in favor of the Department of Natural Resources, including its Offices and Commissions, for the sole purpose of implementing, constructing, servicing and maintaining approved coastal zone management and/or restoration projects. Utilization of any and all rights derived under this lease by the mineral lessee, its agents, successors or assigns, shall not interfere with nor hinder the reasonable surface use by the Department of Natural Resources, its Offices or Commissions, as herein above reserved.

NOTE: The Department of Wildlife and Fisheries has designated certain areas in the coastal waters of the State of Louisiana as Oyster Seed Bed Areas. The exact location of those Seed Bed Areas must be obtained from the Department of Wildlife and Fisheries and any work done under a mineral lease from the State of Louisiana may necessarily be conducted in conformity with the rules and regulations promulgated by the said Department of Wildlife and Fisheries for Oyster Seed Bed Areas.

Applicant: HAROLD J. ANDERSON, INC.

Bidder	Cash Payment	Price/Acre	Rental	Oil	Gas	Other

Legend

- 10050033
- Blocks
- Active Leases

PLAQUEMINES PARISH

GULF OF MEXICO

P.O.B.

SP0024

SOUTH PASS AREA

SL 1008

SL 1009

SL 1010

SP0025

SL 15016

SP0026

WEST DELTA AREA

WD0053



TRACT 41418 - Portion of Block 26, South Pass Area, Plaquemines Parish, Louisiana

The beds and bottoms of all water bodies belonging to the State of Louisiana located in Block 26, South Pass Area, together with any present lands formed by accretion to the shoreline or islands formed therein, located in Plaquemines Parish, Louisiana, owned by and not presently under mineral lease as of May 12, 2010, from the State of Louisiana, the geographical area of which is more fully described as follows: Beginning at a point on the South line of Block 26, South Pass Area having Coordinates of X = 2,635,249.10 and Y = 111,666.00; thence West approximately 6,482 feet on the South line of said Block 26 to a point on the boundary of State Lease No. 2227 having a Coordinate of Y = 111,666.00; thence Northeasterly along the boundary of said State Lease No. 2227 to a point on the boundary of State Lease No. 17203 as amended; thence along the boundary of said State Lease No. 17203 the following courses: South 68 degrees 52 minutes 17 seconds East approximately 1,047 feet to a point having Coordinates of X = 2,632,474.56 and Y = 115,882.00, North 21 degrees 07 minutes 43 seconds East 4,940.00 feet to a point having Coordinates of X = 2,634,255.26 and Y = 120,489.90, and North 68 degrees 52 minutes 17 seconds West approximately 776 feet to a point on the boundary of said State Lease No. 2227; thence Northeasterly along the boundary of said State Lease No. 2227 to a point of intersection with the Louisiana Coastline, as decreed by the Supreme Court of the United States, as determined by a Special Master appointed therein, in litigation styled *United States v. State of Louisiana et al No. 9 Original*, in 1975, thence along said Louisiana Coastline the following courses: Northeasterly on a straight line to a point having Coordinates of X = 2,635,800 and Y = 123,995, and Northeasterly on a straight line to a point on the North line of said Block 26 having Coordinates of X = 2,638,542.98 and Y = 126,424.00; thence East 2,754.50 feet on the North line of said Block 26 to the Northwest corner of State Lease No. 15016 having Coordinates of X = 2,641,297.48 and Y = 126,424.00; thence along the boundary of said State Lease No. 15016 the following courses: South 41 degrees 47 minutes 12 seconds West 9,716.90 feet and South 04 degrees 32 minutes 44 seconds East 5,382.58 feet to a its Southwest corner having Coordinates of X = 2,635,249.10 and Y = 113,813.13; thence South 2,147.13 feet to the point of beginning, **LESS AND EXCEPT** any portion State Lease No. 2227 that may lie within the above described tract, containing approximately **1,102 acres**, all as more particularly outlined on a plat on file in the Office of Mineral Resources, Department of Natural Resources. All bearings, distances and coordinates are based on Louisiana Coordinate System of 1927, (North or South Zone).

NOTE: The above description of the Tract nominated for lease has been provided and corrected, where required, exclusively by the nomination party. Any mineral lease selected from this Tract and awarded by the Louisiana State Mineral Board shall be without warranty of any kind, either express, implied, or statutory, including, but not limited to, the implied warranties of merchantability and fitness for a particular

purpose. Should the mineral lease awarded by the Louisiana State Mineral Board be subsequently modified, cancelled or abrogated due to the existence of conflicting leases, operating agreements, private claims or other future obligations or conditions which may affect all or any portion of the leased Tract, it shall not relieve the Lessee of the obligation to pay any bonus due thereon to the Louisiana State Mineral Board, nor shall the Louisiana State Mineral Board be obligated to refund any consideration paid by the Lessor prior to such modification, cancellation, or abrogation, including, but not limited to, bonuses, rentals and royalties.

NOTE: The State of Louisiana does hereby reserve, and this lease shall be subject to, the imprescriptible right of surface use in the nature of a servitude in favor of the Department of Natural Resources, including its Offices and Commissions, for the sole purpose of implementing, constructing, servicing and maintaining approved coastal zone management and/or restoration projects. Utilization of any and all rights derived under this lease by the mineral lessee, its agents, successors or assigns, shall not interfere with nor hinder the reasonable surface use by the Department of Natural Resources, its Offices or Commissions, as herein above reserved.

NOTE: The Department of Wildlife and Fisheries has designated certain areas in the coastal waters of the State of Louisiana as Oyster Seed Bed Areas. The exact location of those Seed Bed Areas must be obtained from the Department of Wildlife and Fisheries and any work done under a mineral lease from the State of Louisiana may necessarily be conducted in conformity with the rules and regulations promulgated by the said Department of Wildlife and Fisheries for Oyster Seed Bed Areas.

Applicant: HAROLD J. ANDERSON, INC.

Bidder	Cash Payment	Price/Acre	Rental	Oil	Gas	Other

Legend

- 10050031
- Blocks
- Active Leases

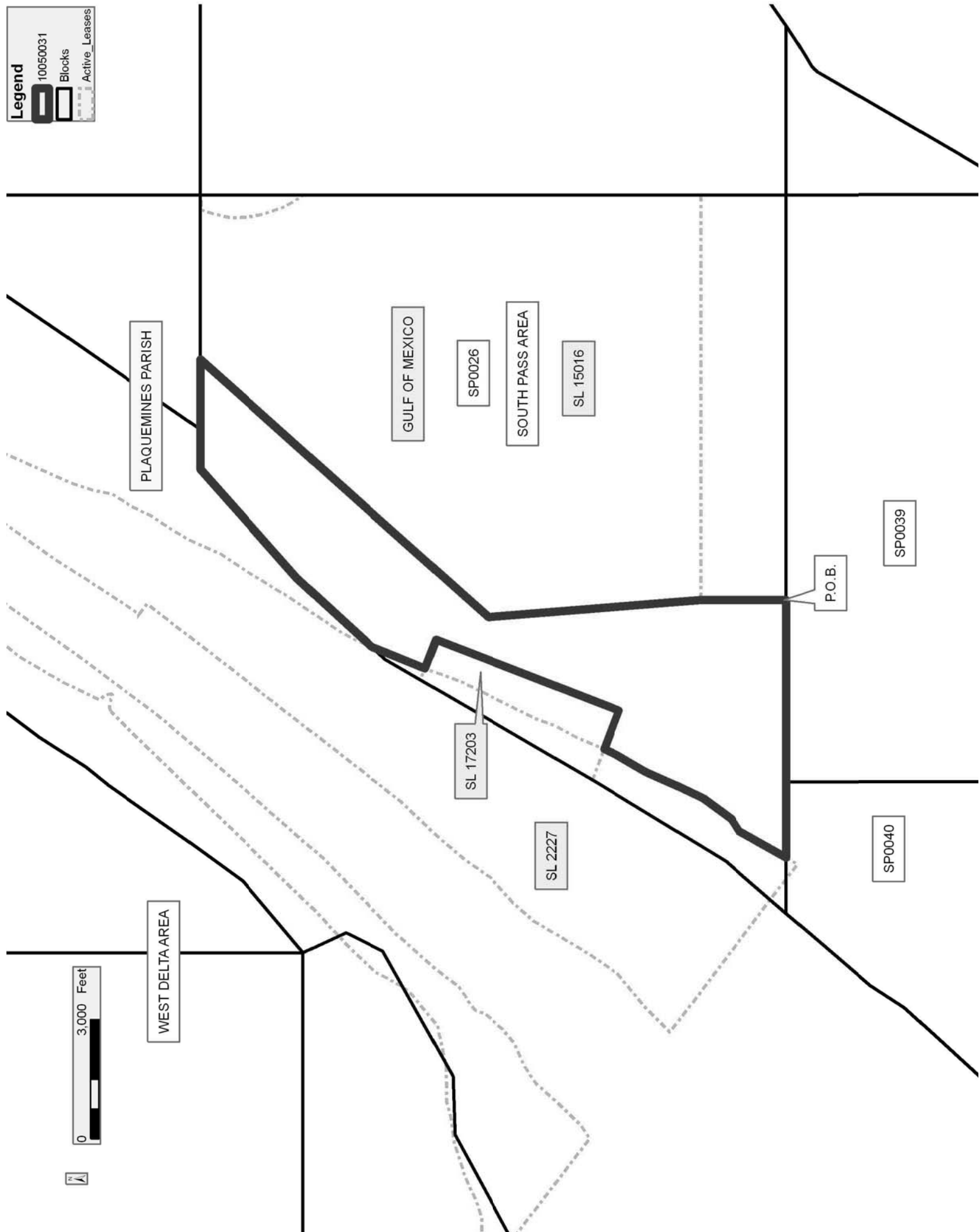

TRACT 41419 - Portion of Blocks 27, and 38, South Pass Area, Plaquemines Parish, Louisiana

The beds and bottoms of all water bodies belonging to the State of Louisiana located in Blocks 27, and 38, South Pass Area, together with any present lands formed by accretion to the shoreline or islands formed therein, located in Plaquemines Parish, Louisiana, owned by and not presently under mineral lease as of May 12, 2010, from the State of Louisiana, the geographical area of which is more fully described as follows: Beginning at a point on the West line of Block 27, South Pass Area, also being the Southwest corner of State Lease No. 1011, as amended having Coordinates of X = 2,645,444.00 and Y = 121,225.00; thence along the boundary of said State Lease No. 1011 the following courses: East 8,885.32 feet, South 20 degrees 46 minutes 55 seconds West 2,331.71 feet and East 3,195.12 feet to a point on the South line of said State Lease No. 1011, also being a point on the Three Mile Line, as decreed by the Supreme Court of the United States, as determined by a Special Master appointed therein, in litigation styled *United States v. State of Louisiana et al No. 9 Original*, in 1975, having Coordinates of X = 2,656,697.12 and Y = 119,045.00; thence along said Three Mile Line the following courses and distances: Southwesterly on a straight line to a point having Coordinates of X = 2,656,605.00 and Y = 119,022.00; Southwesterly on an arc having a radius of 18,240.60 feet and a center at X = 2,641,835.00 and Y = 129,725.00 to a point having Coordinates of X = 2,656,150.00 and Y = 118,421.00; Southwesterly on a straight line to a point having Coordinates of X = 2,653,860.00 and Y = 115,521.00; Southwesterly on an arc having a radius of 18,240.60 feet and a center at X = 2,639,545.00 and Y = 126,825.00 to a point on the South line of said Block 27, also being a point on the North line of Block 38, South Pass Area, having Coordinates of X = 2,649,690.16 and Y = 111,666.00; Southwesterly on an arc having a radius of 18,240.60 feet and a center at X = 2,639,545.00 and Y = 126,825.00 to a point having Coordinates of X = 2,648,682.00 and Y = 111,038.00; Southwesterly on a straight line to a point having Coordinates of X = 2,648,610.00 and Y = 110,974.00; Southwesterly on a straight line to a point having Coordinates of X = 2,648,531.00 and Y = 110,887.00; Southwesterly on a straight line to a point having Coordinates of X = 2,646,419.00 and Y = 107,265.00; Southwesterly on an arc having a radius of 18,240.60 feet and a center at X = 2,630,660.00 and Y = 116,450.00 to a point having Coordinates of X = 2,646,250.00 and Y = 106,981.00; Southwesterly on a straight line to a point on the West line of said Block 38 having Coordinates of X = 2,645,444.00 and Y = 105,653.95; thence North 6,012.05 feet along the West line of said Block 38 to its Northwest corner, also being the Southwest corner of said Block 27 having Coordinates of X = 2,645,444.00 and Y = 111,666.00; thence North 9,559.00 feet along the West line of said Block 27 to the point of beginning, containing approximately **2,048.98 acres, LESS AND EXCEPT** that portion thereof, if any, lying seaward of the line three nautical miles from the coast line of Louisiana, as said three mile line has been decreed by the Supreme Court of the United States, as determined by a Special Master appointed therein, in litigation styled

United States v. State of Louisiana et al No. 9 Original, in 1975, all as more particularly outlined on a plat in the Office of Mineral Resources, Department of Natural Resources. All bearings, distances and coordinates are based on the Louisiana Coordinate System of 1927, (South Zone).

NOTE: The above description of the Tract nominated for lease has been provided and corrected, where required, exclusively by the nomination party. Any mineral lease selected from this Tract and awarded by the Louisiana State Mineral Board shall be without warranty of any kind, either express, implied, or statutory, including, but not limited to, the implied warranties of merchantability and fitness for a particular purpose. Should the mineral lease awarded by the Louisiana State Mineral Board be subsequently modified, cancelled or abrogated due to the existence of conflicting leases, operating agreements, private claims or other future obligations or conditions which may affect all or any portion of the leased Tract, it shall not relieve the Lessee of the obligation to pay any bonus due thereon to the Louisiana State Mineral Board, nor shall the Louisiana State Mineral Board be obligated to refund any consideration paid by the Lessor prior to such modification, cancellation, or abrogation, including, but not limited to, bonuses, rentals and royalties.

NOTE: The State of Louisiana does hereby reserve, and this lease shall be subject to, the imprescriptible right of surface use in the nature of a servitude in favor of the Department of Natural Resources, including its Offices and Commissions, for the sole purpose of implementing, constructing, servicing and maintaining approved coastal zone management and/or restoration projects. Utilization of any and all rights derived under this lease by the mineral lessee, its agents, successors or assigns, shall not interfere with nor hinder the reasonable surface use by the Department of Natural Resources, its Offices or Commissions, as herein above reserved.

NOTE: The Department of Wildlife and Fisheries has designated certain areas in the coastal waters of the State of Louisiana as Oyster Seed Bed Areas. The exact location of those Seed Bed Areas must be obtained from the Department of Wildlife and Fisheries and any work done under a mineral lease from the State of Louisiana may necessarily be conducted in conformity with the rules and regulations promulgated by the said Department of Wildlife and Fisheries for Oyster Seed Bed Areas.

Applicant: HAROLD J. ANDERSON, INC.

Bidder	Cash Payment	Price/Acre	Rental	Oil	Gas	Other

Legend

- 10060034
- Blocks
- Active_Leases

PLAQUEMINES PARISH

SP0027

GULF OF MEXICO

SL 1011

P.O.B.

SP0038



SP0026

SOUTH PASS AREA

SL 15016

SP0039

TRACT 41420 - Portion of Blocks 26, and 39, South Pass Area, Plaquemines Parish, Louisiana

The beds and bottoms of all water bodies belonging to the State of Louisiana located in Blocks 26, and 39, South Pass Area, together with any present lands formed by accretion to the shoreline or islands formed therein, located in Plaquemines Parish, Louisiana, owned by and not presently under mineral lease as of May 12, 2010, from the State of Louisiana, the geographical area of which is more fully described as follows: Beginning at a point on the West line of Block 39, South Pass Area, having Coordinates of X = 2,630,686.00 and Y = 105,772.00; thence North 5,894.00 feet along the West line of said Block 30 to its Northwest corner having Coordinates of X = 2,630,686.00 and Y = 111,666.00; thence East 4,563.10 feet along the North line of said Block 39 to a point, and a point on the South line of Block 26, South Pass Area, having Coordinates of X = 2,635,249.10 and Y = 111,666.00; thence North 00 degrees 00 minutes 01 seconds East 2,147.13 feet to a point having Coordinates of X = 2,635,249.11 and Y = 113,813.13, said point being the Southwest corner of State Lease No. 15016; thence East 10,194.89 feet along the South line of said State Lease No. 15016 to its Southeast corner, also being a point on the East line of said Block 26 having Coordinates of X = 2,645,444.00 and Y = 113,813.13; thence South 2,147.13 feet along the East line of said Block 26 to its Southeast corner, also being the Northeast corner of said Block 39 having Coordinates of X = 2,645,444.00 and Y = 111,666.00; thence South 5,894.00 feet along the East line of said Block 39 to a point having Coordinates of X = 2,645,444.00 and Y = 105,772.00; thence West 14,758.00 feet to the point of beginning, containing approximately **2,499.39 acres, LESS AND EXCEPT** that portion thereof, if any, lying seaward of the line three nautical miles from the coast line of Louisiana, as said three mile line has been decreed by the Supreme Court of the United States, as determined by a Special Master appointed therein, in litigation styled **United States v. State of Louisiana et al No. 9 Original**, in 1975, all as more particularly outlined on a plat in the Office of Mineral Resources, Department of Natural Resources. All bearings, distances and coordinates are based on the Louisiana Coordinate System of 1927, (South Zone).

NOTE: The above description of the Tract nominated for lease has been provided and corrected, where required, exclusively by the nomination party. Any mineral lease selected from this Tract and awarded by the Louisiana State Mineral Board shall be without warranty of any kind, either express, implied, or statutory, including, but not limited to, the implied warranties of merchantability and fitness for a particular purpose. Should the mineral lease awarded by the Louisiana State Mineral Board be subsequently modified, cancelled or abrogated due to the existence of conflicting leases, operating agreements, private claims or other future obligations or conditions which may affect all or any portion of the leased Tract, it shall not relieve the Lessee of the obligation to pay any bonus due thereon to the Louisiana State Mineral Board, nor shall the Louisiana State Mineral Board be obligated to refund any consideration

paid by the Lessor prior to such modification, cancellation, or abrogation, including, but not limited to, bonuses, rentals and royalties.

NOTE: The State of Louisiana does hereby reserve, and this lease shall be subject to, the imprescriptible right of surface use in the nature of a servitude in favor of the Department of Natural Resources, including its Offices and Commissions, for the sole purpose of implementing, constructing, servicing and maintaining approved coastal zone management and/or restoration projects. Utilization of any and all rights derived under this lease by the mineral lessee, its agents, successors or assigns, shall not interfere with nor hinder the reasonable surface use by the Department of Natural Resources, its Offices or Commissions, as herein above reserved.

NOTE: The Department of Wildlife and Fisheries has designated certain areas in the coastal waters of the State of Louisiana as Oyster Seed Bed Areas. The exact location of those Seed Bed Areas must be obtained from the Department of Wildlife and Fisheries and any work done under a mineral lease from the State of Louisiana may necessarily be conducted in conformity with the rules and regulations promulgated by the said Department of Wildlife and Fisheries for Oyster Seed Bed Areas.

Applicant: HAROLD J. ANDERSON, INC.

Bidder	Cash Payment	Price/Acre	Rental	Oil	Gas	Other

Legend

- 10050032
- Blocks
- Active Leases

SP0027

PLAQUEMINES PARISH

SP0026

GULF OF MEXICO

SL 15016

SP0039

SOUTH PASS AREA

SP0040

P.O.B.

