

**TRACT 41528 - Caddo Parish, Louisiana**

All of the lands now or formerly constituting the beds and bottoms of all water bodies of every nature and description the title of which vests in the State of Louisiana, together with all islands arising therein and other lands formed by accretion or by reliction, where allowed by law, excepting tax adjudicated lands, and not presently under mineral lease on July 14, 2010, situated in Caddo Parish, Louisiana, and more particularly described as follows: Beginning at a point having Coordinates of X = 1,533,330.00 and Y = 759,669.77; thence East 5,365.51 feet to a point having Coordinates of X = 1,538,695.51 and Y 759,669.77; thence Southerly approximately 3,550 feet to a Northwest corner of State Lease No. 173, as amended; thence along the Northern boundary of said State Lease No. 173 the following courses: Southerly approximately 1,796 feet; Westerly approximately 2,799 feet; Northerly approximately 1,556 feet; Southwesterly approximately 139 feet; Southwesterly approximately 101 feet; Southerly approximately 390 feet; Southwesterly approximately 100 feet; Southerly approximately 152 feet; Southerly 145 feet; Southeasterly approximately 215 feet; Southeasterly approximately 191 feet and Southeasterly approximately 176 feet to a point of intersection with an East West line having a Coordinate of Y = 754,359.24; thence West approximately 2,502 feet to a point having Coordinates of X = 1,533,330.00 and Y = 754,359.24; thence North 5,310.53 feet to the point of beginning, **LESS AND EXCEPT** any portion of State Lease No. 173, as amended, that may lie within the above described tract, containing approximately **133 acres**, all as more particularly outlined on a plat on file in the Office of Mineral Resources, Department of Natural Resources. All bearings, distances and coordinates are based on Louisiana Coordinate System of 1927, (North or South Zone), where applicable.

NOTE: The above description of the Tract nominated for lease has been provided and corrected, where required, exclusively by the nomination party. Any mineral lease selected from this Tract and awarded by the Louisiana State Mineral Board shall be without warranty of any kind, either express, implied, or statutory, including, but not limited to, the implied warranties of merchantability and fitness for a particular purpose. Should the mineral lease awarded by the Louisiana State Mineral Board be subsequently modified, cancelled or abrogated due to the existence of conflicting leases, operating agreements, private claims or other future obligations or conditions which may affect all or any portion of the leased Tract, it shall not relieve the Lessee of the obligation to pay any bonus due thereon to the Louisiana State Mineral Board, nor shall the Louisiana State Mineral Board be obligated to refund any consideration paid by the Lessor prior to such modification, cancellation, or abrogation, including, but not limited to, bonuses, rentals and royalties.

NOTE: The Office of Mineral Resources will require a minimum bonus of \$250 per acre and a minimum royalty of 22%.

Applicant: STAFF OFFICE OF MINERAL RESOURCES

| Bidder | Cash Payment | Price/Acre | Rental | Oil | Gas | Other |
|--------|--------------|------------|--------|-----|-----|-------|
|        |              |            |        |     |     |       |
|        |              |            |        |     |     |       |
|        |              |            |        |     |     |       |
|        |              |            |        |     |     |       |

Legend

10070010

Active\_Leases

IMAGERY.DOQQ\_2004\_1M

0 2,000 Feet

CADDO PARISH

T20N - R16W

P.O.B.

CADDO LAKE

SL 173

**TRACT 41529 - Natchitoches Parish, Louisiana**

All of the lands now or formerly constituting the beds and bottoms of all water bodies of every nature and description the title of which vests in the State of Louisiana, together with all islands arising therein and other lands formed by accretion or by reliction, where allowed by law, excepting tax adjudicated lands, and not presently under mineral lease on July 14, 2010, situated in Natchitoches Parish, Louisiana, and more particularly described as follows: Beginning at a point having Coordinates of X = 1,750,210.59 and Y = 434,792.11; thence East 10,800.00 feet to a point having Coordinates of X = 1,761,010.59 and Y = 434,792.11; thence South 10,900.00 feet to a point having Coordinates of X = 1,761,010.59 and Y = 423,892.11; thence West 10,800.00 feet to a point having Coordinates of X = 1,750,210.59 and Y = 423,892.11; thence North 10,900.00 feet to the point of beginning, containing approximately **27 acres**, all as more particularly outlined on a plat on file in the Office of Mineral Resources, Department of Natural Resources. All bearings, distances and coordinates are based on Louisiana Coordinate System of 1927, (North or South Zone), where applicable.

NOTE: The above description of the Tract nominated for lease has been provided and corrected, where required, exclusively by the nomination party. Any mineral lease selected from this Tract and awarded by the Louisiana State Mineral Board shall be without warranty of any kind, either express, implied, or statutory, including, but not limited to, the implied warranties of merchantability and fitness for a particular purpose. Should the mineral lease awarded by the Louisiana State Mineral Board be subsequently modified, cancelled or abrogated due to the existence of conflicting leases, operating agreements, private claims or other future obligations or conditions which may affect all or any portion of the leased Tract, it shall not relieve the Lessee of the obligation to pay any bonus due thereon to the Louisiana State Mineral Board, nor shall the Louisiana State Mineral Board be obligated to refund any consideration paid by the Lessor prior to such modification, cancellation, or abrogation, including, but not limited to, bonuses, rentals and royalties.

Applicant: LESLIE M COOPER

| Bidder | Cash Payment | Price/Acre | Rental | Oil | Gas | Other |
|--------|--------------|------------|--------|-----|-----|-------|
|        |              |            |        |     |     |       |
|        |              |            |        |     |     |       |
|        |              |            |        |     |     |       |
|        |              |            |        |     |     |       |

Legend

10070007

IMAGERY.DOQQ\_2004\_1M

0 3,000 Feet



NATCHITOCHE PARISH

T10N - R9W

P.O.B.

ROCKS BAYOU

BAYOU TAPALCAT

**TRACT 41530 - Sabine Parish, Louisiana**

All of the lands now or formerly constituting the beds and bottoms of all water bodies of every nature and description the title of which vests in the State of Louisiana, together with all islands arising therein and other lands formed by accretion or by reliction, where allowed by law, excepting tax adjudicated lands, and not presently under mineral lease on July 14, 2010, situated in Sabine Parish, Louisiana, and more particularly described as follows: Beginning at a point on the South boundary of State Lease No. 19848 having Coordinates of X = 1,588,000.00 and Y = 383,555.00; thence East 10,900.00 feet along the boundary of said State Lease No. 19848 to its Southeast corner having Coordinates of X = 1,598,900.00 and Y = 383,555.00; thence East 7,580.00 feet to a point having Coordinates of X = 1,606,480.00 and Y = 383,555.00; thence South 15,305.00 feet to a point having Coordinates of X = 1,606,480.00 and Y = 368,250.00; thence West 7,580.00 feet to the Northeast corner of State Lease No. 19157 having Coordinates of X = 1,598,900.00 and Y = 368,250.00; thence West 10,900.00 feet along the boundary of said State Lease No. 19157 to a point having Coordinates of X = 1,588,000.00 and Y = 368,250.00; thence North 15,305.00 feet to the point of beginning, containing approximately **156 acres, LESS AND EXCEPT** that portion thereof, if any, located West of the boundary line between the States of Texas and Louisiana as determined by the report of the Special Master and adjudicated by the Supreme Court of the United States in litigation styled **Texas v. Louisiana, et al No. 36 Original**, or as otherwise approved by said court, all as more particularly outlined on a plat on file in the Office of Mineral Resources, Department of Natural Resources. All bearings, distances and coordinates are based on Louisiana Coordinate System of 1927, (North or South Zone), where applicable.

NOTE: The above description of the Tract nominated for lease has been provided and corrected, where required, exclusively by the nomination party. Any mineral lease selected from this Tract and awarded by the Louisiana State Mineral Board shall be without warranty of any kind, either express, implied, or statutory, including, but not limited to, the implied warranties of merchantability and fitness for a particular purpose. Should the mineral lease awarded by the Louisiana State Mineral Board be subsequently modified, cancelled or abrogated due to the existence of conflicting leases, operating agreements, private claims or other future obligations or conditions which may affect all or any portion of the leased Tract, it shall not relieve the Lessee of the obligation to pay any bonus due thereon to the Louisiana State Mineral Board, nor shall the Louisiana State Mineral Board be obligated to refund any consideration paid by the Lessor prior to such modification, cancellation, or abrogation, including, but not limited to, bonuses, rentals and royalties.

Applicant: SANDOZ & ASSOCIATES, INC.

| Bidder | Cash Payment | Price/Acre | Rental | Oil | Gas | Other |
|--------|--------------|------------|--------|-----|-----|-------|
|        |              |            |        |     |     |       |
|        |              |            |        |     |     |       |
|        |              |            |        |     |     |       |
|        |              |            |        |     |     |       |

Legend

10070020

Active\_Leases

IMAGERY.DOQQ\_2004\_1M

0 4,000 Feet



SABINE PARISH

SL 19848

T9N - R14W

SULPHUR SPRINGS SLOUGH LAGOON

P.O.B.

T8N - R14W

SABINE RIVER

SL 19157



**TRACT 41531 - - Sabine Parish, Louisiana**

The State Mineral Board acting on behalf of the Sabine Parish School Board, pursuant to Resolution(s) adopted by that (those) body(ies) and in accordance with Louisiana Revised Statutes 30:121-136 and 151-156, as amended, and Article XIV, Section 16(A)(9) and (B) of the Louisiana Constitution of 1974, as same may be continued and promulgated in proper statutory form and, further, amended from time to time, advertises the lands not under mineral lease on July 14, 2010, excluding the beds and bottoms of all navigable water bodies located within the following: All or a portion of Section 16, Township 08 North, Range 14 West in Sabine Parish, Louisiana, the North half containing approximately **193 acres**, all as more particularly outlined on a plat on file in the Office of Mineral Resources, Department of Natural Resources. All bearings, distances and coordinates are based on Louisiana Coordinate System of 1927, (North or South Zone).

NOTE: The above description of the Tract nominated for lease has been provided and corrected, where required, exclusively by the nomination party. Any mineral lease selected from this Tract and awarded by the Louisiana State Mineral Board shall be without warranty of any kind, either express, implied, or statutory, including, but not limited to, the implied warranties of merchantability and fitness for a particular purpose. Should the mineral lease awarded by the Louisiana State Mineral Board be subsequently modified, cancelled or abrogated due to the existence of conflicting leases, operating agreements, private claims or other future obligations or conditions which may affect all or any portion of the leased Tract, it shall not relieve the Lessee of the obligation to pay any bonus due thereon to the Louisiana State Mineral Board, nor shall the Louisiana State Mineral Board be obligated to refund any consideration paid by the Lessor prior to such modification, cancellation, or abrogation, including, but not limited to, bonuses, rentals and royalties.

NOTE: The Sabine Parish School Board will require a minimum bonus of \$8,000.00 per acre and a minimum royalty of 25%.

Applicant: SANDOZ & ASSOCIATES, INC.

| Bidder | Cash Payment | Price/Acre | Rental | Oil | Gas | Other |
|--------|--------------|------------|--------|-----|-----|-------|
|        |              |            |        |     |     |       |
|        |              |            |        |     |     |       |
|        |              |            |        |     |     |       |
|        |              |            |        |     |     |       |

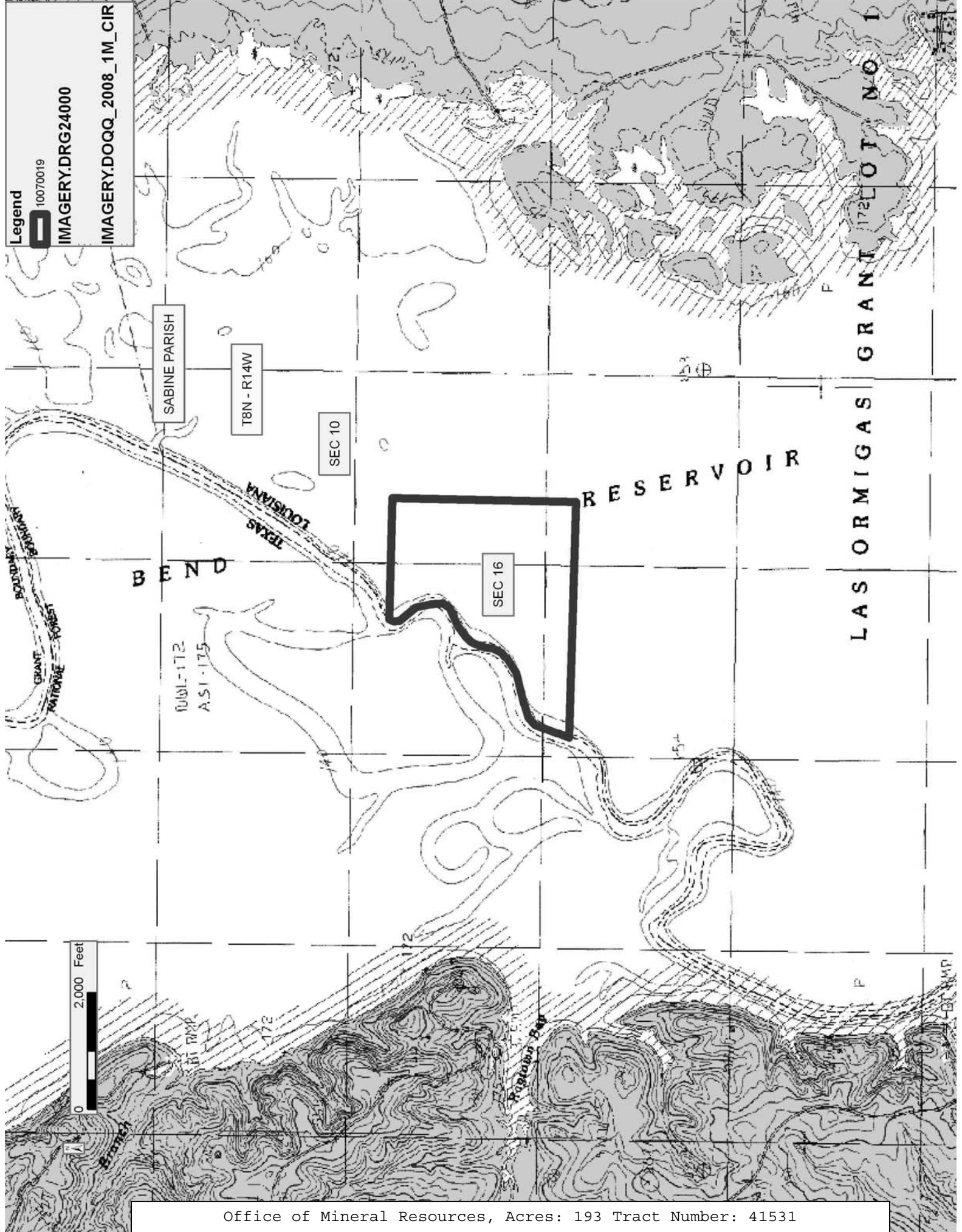

Legend

10070019

IMAGERY.DR24000

IMAGERY.DOQQ\_2008\_1M\_CIR

2,000 Feet

**TRACT 41532 - Natchitoches Parish, Louisiana**

All of the lands now or formerly constituting the beds and bottoms of all water bodies of every nature and description the title of which vests in the State of Louisiana, together with all islands arising therein and other lands formed by accretion or by reliction, where allowed by law, excepting tax adjudicated lands, and not presently under mineral lease on July 14, 2010, situated in Natchitoches Parish, Louisiana, and more particularly described as follows: Beginning at a point having Coordinates of X = 1,860,872.00 and Y = 347,670.00; thence East 4,000.00 feet to a point having Coordinates of X = 1,864,872.00 and Y = 347,670.00; thence South 28 degrees 19 minutes 15 seconds East 8,349.37 feet to a point having Coordinates of X = 1,868,833.00 and Y = 340,320.00; thence West 4,000.00 feet to a point having Coordinates of X = 1,864,833.00 and Y = 340,320.00; thence North 28 degrees 19 minutes 15 seconds West 8,349.37 feet to the point of beginning, containing approximately **35 acres**, all as more particularly outlined on a plat on file in the Office of Mineral Resources, Department of Natural Resources. All bearings, distances and coordinates are based on Louisiana Coordinate System of 1927, (North or South Zone), where applicable.

NOTE: The above description of the Tract nominated for lease has been provided and corrected, where required, exclusively by the nomination party. Any mineral lease selected from this Tract and awarded by the Louisiana State Mineral Board shall be without warranty of any kind, either express, implied, or statutory, including, but not limited to, the implied warranties of merchantability and fitness for a particular purpose. Should the mineral lease awarded by the Louisiana State Mineral Board be subsequently modified, cancelled or abrogated due to the existence of conflicting leases, operating agreements, private claims or other future obligations or conditions which may affect all or any portion of the leased Tract, it shall not relieve the Lessee of the obligation to pay any bonus due thereon to the Louisiana State Mineral Board, nor shall the Louisiana State Mineral Board be obligated to refund any consideration paid by the Lessor prior to such modification, cancellation, or abrogation, including, but not limited to, bonuses, rentals and royalties.

Applicant: THEOPHILUS OIL, GAS & LAND SERVICES, LLC

| Bidder | Cash Payment | Price/Acre | Rental | Oil | Gas | Other |
|--------|--------------|------------|--------|-----|-----|-------|
|        |              |            |        |     |     |       |
|        |              |            |        |     |     |       |
|        |              |            |        |     |     |       |
|        |              |            |        |     |     |       |

Legend

10070018

Active\_Leases

IMAGERY.DOQQ\_2004\_1M

0 2,000 Feet



NATCHITOCHE PARISH

T8N - R5W

LITTLE RIVER

P.O.B.

T7N - R6W

**TRACT 41533 - Concordia Parish, Louisiana**

All of the lands now or formerly constituting the beds and bottoms of all water bodies of every nature and description the title of which vests in the State of Louisiana, together with all islands arising therein and other lands formed by accretion or by reliction, where allowed by law, excepting tax adjudicated lands, and not presently under mineral lease on July 14, 2010, situated in Concordia Parish, Louisiana, and more particularly described as follows: Beginning at a point having Coordinates of X = 2,265,147.52 and Y = 279,041.34; thence East 10,945.62 feet to a point having Coordinates of X = 2,276,093.14 and Y = 279,041.34; thence South 5,440.66 feet to a point having Coordinates of X = 2,276,093.14 and Y = 273,600.68; thence West 10,945.62 feet to a point having Coordinates of X = 2,265,147.52 and Y = 273,600.68; thence North 5,440.66 feet to the point of beginning, containing approximately **25 acres**, all as more particularly outlined on a plat on file in the Office of Mineral Resources, Department of Natural Resources. All bearings, distances and coordinates are based on Louisiana Coordinate System of 1927, (North or South Zone), where applicable.

NOTE: The above description of the Tract nominated for lease has been provided and corrected, where required, exclusively by the nomination party. Any mineral lease selected from this Tract and awarded by the Louisiana State Mineral Board shall be without warranty of any kind, either express, implied, or statutory, including, but not limited to, the implied warranties of merchantability and fitness for a particular purpose. Should the mineral lease awarded by the Louisiana State Mineral Board be subsequently modified, cancelled or abrogated due to the existence of conflicting leases, operating agreements, private claims or other future obligations or conditions which may affect all or any portion of the leased Tract, it shall not relieve the Lessee of the obligation to pay any bonus due thereon to the Louisiana State Mineral Board, nor shall the Louisiana State Mineral Board be obligated to refund any consideration paid by the Lessor prior to such modification, cancellation, or abrogation, including, but not limited to, bonuses, rentals and royalties.

NOTE: The Office of Mineral Resources will require a minimum bonus of \$75 per acre and a minimum royalty of 20%.

NOTE: The above Tract is located upon a restricted scenic river and all operations in this area must be conducted in strict conformity with the regulations of the Corps of Engineers, U.S. Army.

Applicant: STAFF OFFICE OF MINERAL RESOURCES

| Bidder | Cash Payment | Price/Acre | Rental | Oil | Gas | Other |
|--------|--------------|------------|--------|-----|-----|-------|
|        |              |            |        |     |     |       |
|        |              |            |        |     |     |       |
|        |              |            |        |     |     |       |
|        |              |            |        |     |     |       |

Legend

10070030

IMAGERY.DOQQ\_2004\_1M

CONCORDIA PARISH

T5N - R8E

BAYOU COCODRIE

P.O.B.

0 2,000 Feet



**TRACT 41534 - Calcasieu Parish, Louisiana**

All of the lands now or formerly constituting the beds and bottoms of all water bodies of every nature and description the title of which vests in the State of Louisiana, together with all islands arising therein and other lands formed by accretion or by reliction, where allowed by law, excepting tax adjudicated lands, and not presently under mineral lease on July 14, 2010, situated in Calcasieu Parish, Louisiana, and more particularly described as follows: Beginning at a point having Coordinates of X = 1,436,390.00 and Y = 617,650.00; thence North 5,000.00 feet to a point having Coordinates of X = 1,436,390.00 and Y = 622,650.00; thence East 18,480.00 feet to a point having Coordinates of X = 1,454,870.00 and Y = 622,650.00; thence South 5,000.00 feet to a point having Coordinates of X = 1,454,870.00 and Y = 617,650.00; thence West 10,470.00 feet to the Northeast corner of State Lease No. 20196 having Coordinates of X = 1,444,400.00 and Y = 617,650.00; thence West 2,640.00 feet along the North boundary of said State Lease No. 20196 its Northwest corner having Coordinates of X = 1,441,760.00 and Y = 617,650.00; thence West 5,370.00 feet to the point of beginning, containing approximately **60 acres**, all as more particularly outlined on a plat on file in the Office of Mineral Resources, Department of Natural Resources. All bearings, distances and coordinates are based on Louisiana Coordinate System of 1927, (North or South Zone), where applicable.

NOTE: The above description of the Tract nominated for lease has been provided and corrected, where required, exclusively by the nomination party. Any mineral lease selected from this Tract and awarded by the Louisiana State Mineral Board shall be without warranty of any kind, either express, implied, or statutory, including, but not limited to, the implied warranties of merchantability and fitness for a particular purpose. Should the mineral lease awarded by the Louisiana State Mineral Board be subsequently modified, cancelled or abrogated due to the existence of conflicting leases, operating agreements, private claims or other future obligations or conditions which may affect all or any portion of the leased Tract, it shall not relieve the Lessee of the obligation to pay any bonus due thereon to the Louisiana State Mineral Board, nor shall the Louisiana State Mineral Board be obligated to refund any consideration paid by the Lessor prior to such modification, cancellation, or abrogation, including, but not limited to, bonuses, rentals and royalties.

NOTE: The above Tract is located upon a restricted scenic river and all operations in this area must be conducted in strict conformity with the regulations of the Corps of Engineers, U.S. Army.



Applicant: TAYLEX, INC.

| Bidder | Cash Payment | Price/Acre | Rental | Oil | Gas | Other |
|--------|--------------|------------|--------|-----|-----|-------|
|        |              |            |        |     |     |       |
|        |              |            |        |     |     |       |
|        |              |            |        |     |     |       |
|        |              |            |        |     |     |       |

Legend

10070012

Active Leases

IMAGERY.DOQQ\_2008\_1M\_CIR

0 4,000 Feet

JEFFERSON DAVIS PARISH

T8S - R7W

CALCASIEU PARISH

CALCASIEU RIVER

SL 20196

P.O.B.

**TRACT 41535 - Iberville Parish, Louisiana**

All of the lands now or formerly constituting the beds and bottoms of all water bodies of every nature and description the title of which vests in the State of Louisiana, together with all islands arising therein and other lands formed by accretion or by reliction, where allowed by law, excepting tax adjudicated lands, and not presently under mineral lease on July 14, 2010, situated in Iberville Parish, Louisiana, and more particularly described as follows: Beginning at a point having Coordinates of X = 1,989,100.00 and Y = 607,400.00; thence East 14,200.00 feet to a point having Coordinates of X = 2,003,300.00 and Y = 607,400.00; thence South 5,400.00 feet to the Northwest corner of Operating Agreement No. 215 having Coordinates of X = 2,003,300.00 and Y = 602,000.00; thence South 5,500.00 feet along the West line of said Operating Agreement No. 215 to its Southwest corner having Coordinates of X = 2,003,300.00 and Y = 596,500.00; thence South 3,300.00 feet to a point having Coordinates of X = 2,003,300.00 and Y = 593,200.00; thence West 14,200.00 feet to a point having Coordinates of X = 1,989,100.00 and Y = 593,200.00; thence North 14,200.00 feet to the Point of Beginning, containing approximately **61 acres**, all as more particularly outlined on a plat on file in the Office of Mineral Resources, Department of Natural Resources. All bearings, distances and coordinates are based on Louisiana Coordinate System of 1927, (North or South Zone), where applicable.

NOTE: The above description of the Tract nominated for lease has been provided and corrected, where required, exclusively by the nomination party. Any mineral lease selected from this Tract and awarded by the Louisiana State Mineral Board shall be without warranty of any kind, either express, implied, or statutory, including, but not limited to, the implied warranties of merchantability and fitness for a particular purpose. Should the mineral lease awarded by the Louisiana State Mineral Board be subsequently modified, cancelled or abrogated due to the existence of conflicting leases, operating agreements, private claims or other future obligations or conditions which may affect all or any portion of the leased Tract, it shall not relieve the Lessee of the obligation to pay any bonus due thereon to the Louisiana State Mineral Board, nor shall the Louisiana State Mineral Board be obligated to refund any consideration paid by the Lessor prior to such modification, cancellation, or abrogation, including, but not limited to, bonuses, rentals and royalties.

Applicant: ALBERT S. RUFFIN, JR.

| Bidder | Cash Payment | Price/Acre | Rental | Oil | Gas | Other |
|--------|--------------|------------|--------|-----|-----|-------|
|        |              |            |        |     |     |       |
|        |              |            |        |     |     |       |
|        |              |            |        |     |     |       |
|        |              |            |        |     |     |       |

Legend

10070006

Active\_Leases

IMAGERY.DOQQ\_2008\_1M\_CIR

0 4,000 Feet

IBERVILLE PARISH

BAYOU GROSSE TETE

CHOCTAW BAYOU

P.O.B.

AO 0215

T8S - R11E

T9S - R11E

**TRACT 41536 - Cameron Parish, Louisiana**

All of the lands now or formerly constituting the beds and bottoms of all water bodies of every nature and description the title of which vests in the State of Louisiana, together with all islands arising therein and other lands formed by accretion or by reliction, where allowed by law, excepting tax adjudicated lands, and not presently under mineral lease on July 14, 2010, situated in Cameron Parish, Louisiana, and more particularly described as follows: Beginning at a point having Coordinates of X = 1,576,211.00 and Y = 460,531.00; thence East 9,412.00 feet to a point having Coordinates of X = 1,585,623.00 and Y = 460,531.00; thence South 8,647.00 feet to the Northeast corner of State Lease No. 19354 having Coordinates of X = 1,585,623.00 and Y = 451,884.00; thence along the boundary of said State Lease No. 19354 the following courses: West 3,666.00 feet; North 1,596.00 feet; West 4,126.00 feet; North 1,000.00 feet and West 1,620.00 feet to its Northwest corner having Coordinates of X = 1,576,211.00 and Y = 454,480.00; thence North 6,051.00 feet to the point of beginning, **LESS AND EXCEPT** all of State Lease No. 18506, as amended, that lies within the above described tract, more particularly described as follows: Commencing at the point of beginning of the above described tract having Coordinates of X = 1,576,211.00 and Y = 460,531.00; thence South 21 degrees 46 minutes 09 seconds East 4,368.12 feet to the Northwest corner of State Lease No. 18506, as amended, having Coordinates of X = 1,577,831.00 and Y = 456,474.39; thence along the boundary of said State Lease No. 18506 the following courses: Northeasterly along an arc to the left having a radius of 4,108.03 feet and a center at X = 1,576,710.94 and Y = 460,426.77 to a point having Coordinates of X = 1,578,142.79 and Y = 456,576.36; Northeasterly along an arc to the right having a radius of 1,676.59 feet and a center at X = 1,578,896.78 and Y = 455,078.87 to a point having Coordinates of X = 1,578,707.57 and Y = 456,744.75; Southeasterly along an arc to the right having a radius of 1,521.60 feet and a center at X = 1,578,923.95 and Y = 455,238.62 to a point having Coordinates of X = 1,579,767.25 and Y = 456,505.15; Southeasterly along an arc to the right having a radius of 1,480.88 feet and a center at X = 1,578,926.07 and Y = 455,286.38 to a point having Coordinates of X = 1,580,107.13 and Y = 456,179.73; Southeasterly along an arc to the right having a radius of 651.63 feet and a center at X = 1,579,559.59 and Y = 455,826.42 to a point having Coordinates of X = 1,580,210.67 and Y = 455,799.58; Southwesterly along an arc to the left having a radius of 4,023.62 feet and a center at X = 1,581,918.33 and Y = 452,156.31 to a point having Coordinates of X = 1,579,197.79 and Y = 455,120.80; Southwesterly along an arc to the right having a radius of 878.71 feet and a center at X = 1,578,580.21 and Y = 455,745.88 to a point having Coordinates of X = 1,578,754.36 and Y = 454,884.60; Southwesterly along an arc to the right having a radius of 3,935.75 feet and a center at X = 1,578,318.22 and Y = 458,796.12 to a point having Coordinates of X = 1,578,044.31 and Y = 454,869.90; Northwesterly along an arc to the right having a radius of 10,093.84 feet and a center at X = 1,579,143.42 and Y = 464,903.72 to a point having Coordinates of X = 1,577,831.00 and Y = 454,895.57 and North 1,578.82 feet back to its Northwest corner; The above

described nominated tract containing approximately **931 acres**, all as more particularly outlined on a plat on file in the Office of Mineral Resources, Department of Natural Resources. All bearings, distances and coordinates are based on Louisiana Coordinate System of 1927, (North or South Zone), where applicable.

NOTE: The above description of the Tract nominated for lease has been provided and corrected, where required, exclusively by the nomination party. Any mineral lease selected from this Tract and awarded by the Louisiana State Mineral Board shall be without warranty of any kind, either express, implied, or statutory, including, but not limited to, the implied warranties of merchantability and fitness for a particular purpose. Should the mineral lease awarded by the Louisiana State Mineral Board be subsequently modified, cancelled or abrogated due to the existence of conflicting leases, operating agreements, private claims or other future obligations or conditions which may affect all or any portion of the leased Tract, it shall not relieve the Lessee of the obligation to pay any bonus due thereon to the Louisiana State Mineral Board, nor shall the Louisiana State Mineral Board be obligated to refund any consideration paid by the Lessor prior to such modification, cancellation, or abrogation, including, but not limited to, bonuses, rentals and royalties.

NOTE: The Office of Mineral Resources will require a minimum bonus of \$300 per acre and a minimum royalty of 23%.

NOTE: The State of Louisiana does hereby reserve, and this lease shall be subject to, the imprescriptible right of surface use in the nature of a servitude in favor of the Department of Natural Resources, including its Offices and Commissions, for the sole purpose of implementing, constructing, servicing and maintaining approved coastal zone management and/or restoration projects. Utilization of any and all rights derived under this lease by the mineral lessee, its agents, successors or assigns, shall not interfere with nor hinder the reasonable surface use by the Department of Natural Resources, its Offices or Commissions, as herein above reserved.

Applicant: STAFF OFFICE OF MINERAL RESOURCES

| Bidder | Cash Payment | Price/Acre | Rental | Oil | Gas | Other |
|--------|--------------|------------|--------|-----|-----|-------|
|        |              |            |        |     |     |       |
|        |              |            |        |     |     |       |
|        |              |            |        |     |     |       |
|        |              |            |        |     |     |       |

Legend

10070011

Active\_Leases

Counties

IMAGERY.DOQQ\_2008\_1M\_CIR

CAMERON PARISH

0 2,000 Feet

P.O.B.

MALLARD BAY

SL 18506

SL 19354



**TRACT 41537 - Iberia Parish, Louisiana**

All of the lands now or formerly constituting the beds and bottoms of all water bodies of every nature and description the title of which vests in the State of Louisiana, together with all islands arising therein and other lands formed by accretion or by reliction, where allowed by law, excepting tax adjudicated lands, and not presently under mineral lease on July 14, 2010, situated in Iberia Parish, Louisiana, and more particularly described as follows: Beginning at the Westernmost Southwest corner of State Lease No. 20182 having Coordinates of X = 1,876,643.99 and Y = 339,137.36; thence along the boundary of said State Lease No. 20182 the following courses: South 89 degrees 45 minutes 52 seconds East 1,903.63 feet to a point having Coordinates of X = 1,878,547.60 and Y = 339,129.53 and South 00 degrees 15 minutes 27 seconds West 353.40 feet to the Northwest corner of State Lease No. 19139 having Coordinates of X = 1,878,546.01 and Y = 338,776.13; thence South 00 degrees 13 minutes 53 seconds West 1,935.25 feet along the West boundary of said State Lease No. 19139 to the Northernmost Northeast corner of State Lease No. 1706, as amended, having Coordinates of X = 1,878,538.20 and Y = 336,840.90; thence North 89 degrees 45 minutes 52 seconds West 1,894.23 feet along the North boundary of said State Lease No. 1706 to a point having Coordinates of X = 1,876,643.99 and Y = 336,848.69; thence North 2,288.66 feet to the point of beginning, containing approximately **99.77 acres**, all as more particularly outlined on a plat on file in the Office of Mineral Resources, Department of Natural Resources. All bearings, distances and coordinates are based on Louisiana Coordinate System of 1927, (North or South Zone), where applicable.

NOTE: The above description of the Tract nominated for lease has been provided and corrected, where required, exclusively by the nomination party. Any mineral lease selected from this Tract and awarded by the Louisiana State Mineral Board shall be without warranty of any kind, either express, implied, or statutory, including, but not limited to, the implied warranties of merchantability and fitness for a particular purpose. Should the mineral lease awarded by the Louisiana State Mineral Board be subsequently modified, cancelled or abrogated due to the existence of conflicting leases, operating agreements, private claims or other future obligations or conditions which may affect all or any portion of the leased Tract, it shall not relieve the Lessee of the obligation to pay any bonus due thereon to the Louisiana State Mineral Board, nor shall the Louisiana State Mineral Board be obligated to refund any consideration paid by the Lessor prior to such modification, cancellation, or abrogation, including, but not limited to, bonuses, rentals and royalties.

NOTE: The acreage contained herein, being a portion of State Lease 335, 340 or 341, was subject to the litigation between Texaco, Inc. and the State of Louisiana which resulted in the Global Settlement Agreement compromise whereby this acreage was reassigned through various mesne conveyances to the successors of William T. Burton, the original lessee of said leases from the State, (hereinafter otherwise referred to as the

"ORRO's) and approved by the State Mineral Board, becoming effective April 25, 1994. Under separate agreement by and between the State and the ORRO's, certain obligations were to be met within a specified time frame or the ORRO's became obligated to release the reassigned acreage back to the State. The obligations were not met within the specified time frame and the State began securing the releases for the acreage contained herein. Due to the extremely large number of ORRO's, their nationwide and worldwide dispersal, the unreliability of available contact information and/or a present inability to obtain full, requisite cooperation, the State has, as yet, not secured releases from certain ORRO's representing approximately a .0258336 interest in this acreage. Accordingly, although the State is diligently pursuing the requisite releases affecting this acreage (the furnishing of which the ORRO's representing the stated decimal interest are obligated), nevertheless, a party obtaining a mineral lease from the State of Louisiana on the acreage contained herein shall do so with full knowledge that a complete release of all specific ORRO interest in this acreage has not as yet been secured and shall assume a business risk commensurate with the unsecured interest release.

NOTE: The Office of Mineral Resources will require a minimum royalty of 25%.

NOTE: This tract is located in an area designated by the Louisiana Legislature or the Wildlife and Fisheries Commission as a public oyster seed ground or reservation, or area of Calcasieu or Sabine Lake. Proposed activities on this tract will be evaluated on a case by case basis. Modifications to proposed project features including, but not limited to, access routes, well sites, flowlines, and appurtenant structures may be required. In addition, compensatory mitigation will be required to offset unavoidable habitat impacts.

NOTE: The State of Louisiana does hereby reserve, and this lease shall be subject to, the imprescriptible right of surface use in the nature of a servitude in favor of the Department of Natural Resources, including its Offices and Commissions, for the sole purpose of implementing, constructing, servicing and maintaining approved coastal zone management and/or restoration projects. Utilization of any and all rights derived under this lease by the mineral lessee, its agents, successors or assigns, shall not interfere with nor hinder the reasonable surface use by the Department of Natural Resources, its Offices or Commissions, as herein above reserved.

NOTE: All or a portion of this Tract lies within one nautical mile of the boundary of the Russell Sage or Marsh Island Wildlife Refuge and Game Preserve. Any activities connected with this lease conducted within this Tract which may pose potential environmental impacts to the said Wildlife Refuge and Game Preserve should be coordinated with the Louisiana Department of Wildlife and Fisheries.

Applicant: STAFF OFFICE OR MINERAL RESOURCES

| Bidder | Cash Payment | Price/Acre | Rental | Oil | Gas | Other |
|--------|--------------|------------|--------|-----|-----|-------|
|        |              |            |        |     |     |       |
|        |              |            |        |     |     |       |
|        |              |            |        |     |     |       |
|        |              |            |        |     |     |       |

**Legend**  
10070016  
Active\_Leases



IBERIA PARISH

VERMILION BAY

SL 20182

P.O.B.

SL 19139

SL 1706