

**TRACT 41596 - Portion of Block 45, Breton Sound Area, Plaquemines Parish, Louisiana**

The beds and bottoms of all water bodies belonging to the State of Louisiana located in Block 45, Breton Sound Area, together with any present lands formed by accretion to the shoreline or islands formed therein, located in Plaquemines Parish, Louisiana, owned by and not presently under mineral lease as of September 8, 2010, from the State of Louisiana, the geographical area of which is more fully described as follows: Beginning at the Northernmost corner of State Lease No. 17942, as amended, also being a point on the Southern boundary of State Lease No. 19391 having Coordinates of X = 2,688,438.19 and Y = 294,809.64; thence North 64 degrees 19 minutes 10 seconds East 2,121.35 feet along the boundary of said State Lease No. 19391 to its Southeast corner, also being the Southernmost Southwestern corner of State Lease No. 19052 having Coordinates of X = 2,690,350.00 and Y = 295,728.93; thence North 64 degrees 19 minutes 10 seconds East 1,387.01 feet along the Southern boundary of said State Lease No. 19052 to the Northernmost Northwest corner of State Lease No. 19051 having Coordinates of X = 2,691,600.00 and Y = 296,330.00; thence South 50 degrees 31 minutes 39 seconds West 3,347.00 feet along the Western boundary of said State Lease No. 19051 to its Westernmost Northwest corner, also being the Northernmost corner of State Lease No. 19347, also being the Northernmost corner of State Lease No. 15683, as amended, and the Easternmost corner of said State Lease No. 17942 having Coordinates of X = 2,698,016.35 and Y = 294,202.28; thence North 43 degrees 35 minutes 21 seconds West 838.54 feet along the Eastern boundary of said State Lease No. 17942 to the point of beginning, containing approximately **32.13 acres**, all as more particularly outlined on a plat on file in the Office of Mineral Resources, Department of Natural Resources. All bearings, distances and coordinates are based on Louisiana Coordinate System of 1927, (North or South Zone).

NOTE: The above description of the Tract nominated for lease has been provided and corrected, where required, exclusively by the nomination party. Any mineral lease selected from this Tract and awarded by the Louisiana State Mineral and Energy Board shall be without warranty of any kind, either express, implied, or statutory, including, but not limited to, the implied warranties of merchantability and fitness for a particular purpose. Should the mineral lease awarded by the Louisiana State Mineral and Energy Board be subsequently modified, cancelled or abrogated due to the existence of conflicting leases, operating agreements, private claims or other future obligations or conditions which may affect all or any portion of the leased Tract, it shall not relieve the Lessee of the obligation to pay any bonus due thereon to the Louisiana State Mineral and Energy Board, nor shall the Louisiana State Mineral and Energy Board be obligated to refund any consideration paid by the Lessor prior to such modification, cancellation, or abrogation, including, but not limited to, bonuses, rentals and royalties.

NOTE: The State of Louisiana does hereby reserve, and this lease shall be subject to, the imprescriptible right of surface use in the nature of a servitude in favor of the Department of Natural Resources, including its Offices and Commissions, for the sole purpose of implementing, constructing, servicing and maintaining approved coastal zone management and/or restoration projects. Utilization of any and all rights derived under this lease by the mineral lessee, its agents, successors or assigns, shall not interfere with nor hinder the reasonable surface use by the Department of Natural Resources, its Offices or Commissions, as herein above reserved.

Applicant: CENTURY EXPLORATION NEW ORLEANS, INC.

Bidder	Cash Payment	Price/Acre	Rental	Oil	Gas	Other

**Legend**

- 10090017
- Blocks
- Active Leases

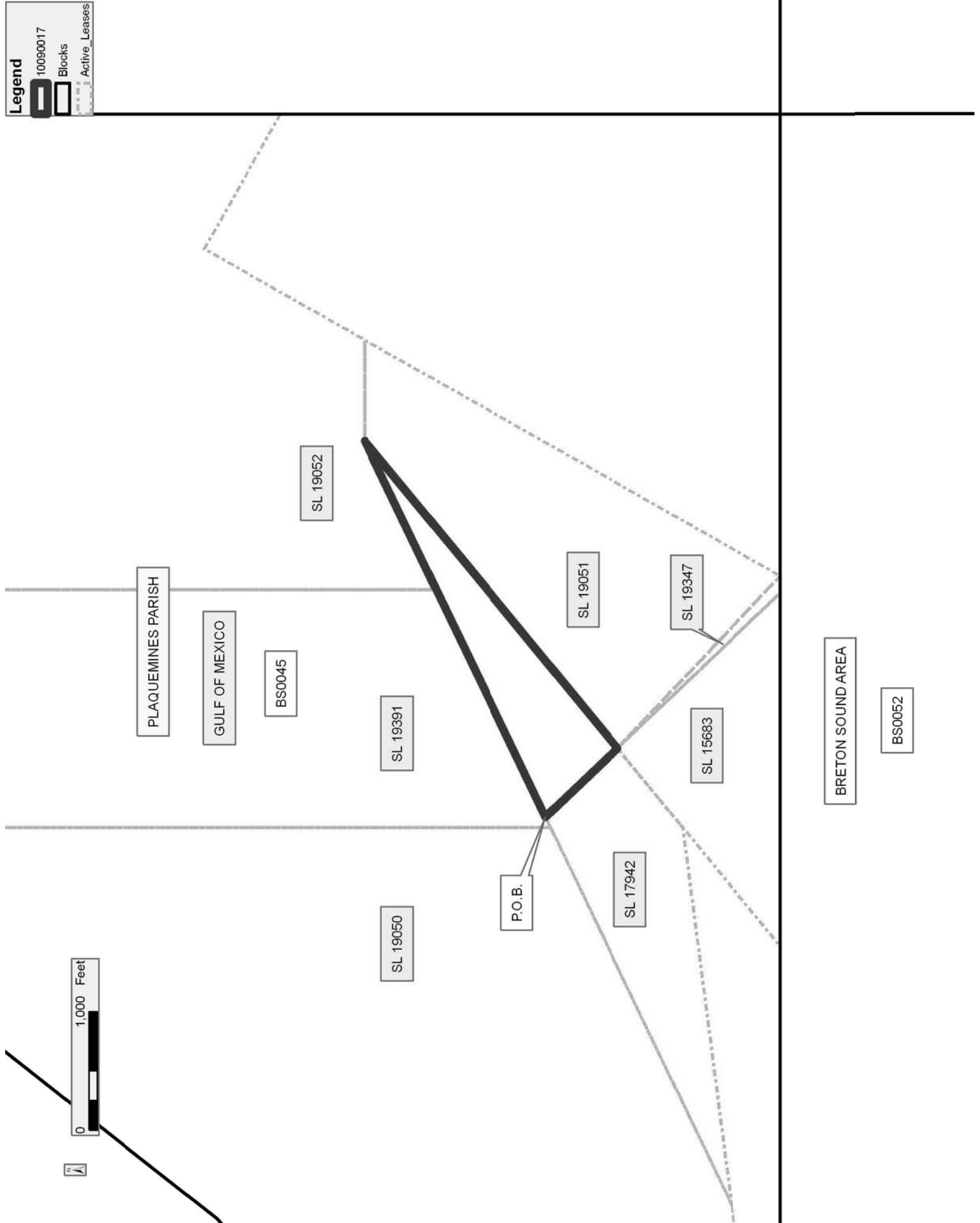

Office of Mineral Resources, Acres: 32.13 Tract Number: 41596