

**TRACT 41698 - Red River Parish, Louisiana**

All of the lands now or formerly constituting the beds and bottoms of all water bodies of every nature and description as to which title is vested in the State of Louisiana, together with all islands arising therein and other lands formed by accretion or by reliction, where allowed by law, excepting tax adjudicated lands, and not presently under mineral lease on November 10, 2010, situated in Red River Parish, Louisiana, and more particularly described as follows: Beginning at an interior corner of State Lease No. 19765, as amended, having Coordinates of X = 1,708,893.73 and Y = 572,007.62; thence along the boundary of said State Lease No. 19765 the following courses: South 00 degrees 34 minutes 44 seconds West 5,245.71 feet to a point having Coordinates of X = 1,708,840.74 and Y = 566,762.18; North 89 degrees 30 minutes 08 seconds West 5,279.62 feet to a point having Coordinates of X = 1,703,561.32 and Y = 566,808.04; North 00 degrees 30 minutes 25 seconds East 5,222.64 feet to a point having Coordinates of X = 1,703,607.52 and Y = 572,030.48 and South 89 degrees 45 minutes 08 seconds East 5,286.26 feet to the point of beginning, **LESS AND EXCEPT**, that portion, if any, of State Lease No. 19794 which may lie within the above described tract, containing approximately **110 acres**, all as more particularly outlined on a plat on file in the Office of Mineral Resources, Department of Natural Resources. All bearings, distances and coordinates are based on Louisiana Coordinate System of 1927, (North or South Zone), where applicable.

NOTE: The above description of the Tract nominated for lease has been provided and corrected, where required, exclusively by the nomination party. Any mineral lease selected from this Tract and awarded by the Louisiana State Mineral and Energy Board shall be without warranty of any kind, either express, implied, or statutory, including, but not limited to, the implied warranties of merchantability and fitness for a particular purpose. Should the mineral lease awarded by the Louisiana State Mineral and Energy Board be subsequently modified, cancelled or abrogated due to the existence of conflicting leases, operating agreements, private claims or other future obligations or conditions which may affect all or any portion of the leased Tract, it shall not relieve the Lessee of the obligation to pay any bonus due thereon to the Louisiana State Mineral and Energy Board, nor shall the Louisiana State Mineral and Energy Board be obligated to refund any consideration paid by the Lessor prior to such modification, cancellation, or abrogation, including, but not limited to, bonuses, rentals and royalties.

Applicant: HUNTER ENERGY CORPORATION

Bidder	Cash Payment	Price/Acre	Rental	Oil	Gas	Other

Legend

10/11/00/19

Active\_Leases

IMAGERY.DOQQ\_2004\_1M

0 2,000 Feet



T15N - R11W

BOSSIER PARISH

SL 19794

P.O.B.



SL 19765

RED RIVER

RED RIVER PARISH

T14N - R11W

**TRACT 41699 - Red River Parish, Louisiana**

All of the lands now or formerly constituting the beds and bottoms of all water bodies of every nature and description as to which title is vested in the State of Louisiana, together with all islands arising therein and other lands formed by accretion or by reliction, where allowed by law, excepting tax adjudicated lands, and not presently under mineral lease on November 10, 2010, situated in Red River Parish, Louisiana, and more particularly described as follows: Beginning at a point on the Southern boundary of State Lease No. 19765, as amended, having Coordinates of X = 1,698,551.84 and Y = 562,127.92; thence along the boundary of said State Lease No. 19765 the following courses: South 88 degrees 43 minutes 44 seconds East 12.89 feet; South 89 degrees 29 minutes 06 seconds East 1,986.46 feet; South 40 degrees 49 minutes 12 seconds East 731.47 feet and South 89 degrees 29 minutes 35 seconds East 2,498.29 feet to a point having Coordinates of X = 1,703,527.44 and Y = 561,534.13; thence South 00 degrees 36 minutes 16 seconds West 5,325.26 feet to a point having Coordinates of X = 1,703,471.27 and Y = 556,209.17; thence North 89 degrees 29 minutes 34 seconds West 477.81 feet to a point having Coordinates of X = 1,702,993.48 and Y = 556,213.40; thence North 06 degrees 10 minutes 47 seconds East 611.52 feet to a point having Coordinates of X = 1,703,059.31 and Y = 556,821.37; thence North 89 degrees 29 minutes 04 seconds West 4,533.49 feet to a point on the East boundary of State Lease No. 19124 having Coordinates of X = 1,698,526.00 and Y = 556,862.16; thence along the boundary of said State Lease No. 19124 the following courses: North 131.84 feet and West 51.20 feet to a point having Coordinates of X = 1,698,474.80 and Y = 556,994.00; thence North 00 degrees 51 minutes 35 seconds East 5,134.50 feet to the point of beginning, containing approximately **96 acres**, all as more particularly outlined on a plat on file in the Office of Mineral Resources, Department of Natural Resources. All bearings, distances and coordinates are based on Louisiana Coordinate System of 1927, (North or South Zone), where applicable.

NOTE: The above description of the Tract nominated for lease has been provided and corrected, where required, exclusively by the nomination party. Any mineral lease selected from this Tract and awarded by the Louisiana State Mineral and Energy Board shall be without warranty of any kind, either express, implied, or statutory, including, but not limited to, the implied warranties of merchantability and fitness for a particular purpose. Should the mineral lease awarded by the Louisiana State Mineral and Energy Board be subsequently modified, cancelled or abrogated due to the existence of conflicting leases, operating agreements, private claims or other future obligations or conditions which may affect all or any portion of the leased Tract, it shall not relieve the Lessee of the obligation to pay any bonus due thereon to the Louisiana State Mineral and Energy Board, nor shall the Louisiana State Mineral and Energy Board be obligated to refund any consideration paid by the Lessor prior to such modification, cancellation, or abrogation, including, but not limited to, bonuses, rentals and royalties.

Applicant: GOODRICH PETROLEUM COMPANY, L.L.C.

Bidder	Cash Payment	Price/Acre	Rental	Oil	Gas	Other

Legend

10110024

Active\_Leases

IMAGERY.DOQQ\_2004\_1M

RED RIVER PARISH

T14N - R11W

SL 19765

RED RIVER

P.O.B.

SL 19124

0 2,000 Feet

**TRACT 41700 - Red River Parish, Louisiana**

All of the lands now or formerly constituting the beds and bottoms of all water bodies of every nature and description as to which title is vested in the State of Louisiana, together with all islands arising therein and other lands formed by accretion or by reliction, where allowed by law, excepting tax adjudicated lands, and not presently under mineral lease on November 10, 2010, situated in Red River Parish, Louisiana, and more particularly described as follows: Beginning at the Southeast corner of State Lease No. 19765, as amended, also being a point on the West boundary of State Lease No. 20014 having Coordinates of X = 1,708,957.21 and Y = 561,486.44; thence South 186.44 feet along the West boundary of said State Lease No. 20014 to its Southwest corner, also being the Northwest corner of State Lease No. 20015 having Coordinates of X = 1,708,957.21 and Y = 561,300.00; thence South 5,139.10 feet along the West boundary of said State Lease No. 20015 to the Northeast corner of the Northeastern portion of State Lease No. 19769, as amended, having Coordinates of X = 1,708,957.21 and Y = 556,160.90; thence North 89 degrees 36 minutes 38 seconds West 206.81 feet along the North boundary of the Northeastern portion of said State Lease No. 19769 to its Northwest corner having Coordinates of X = 1,708,750.41 and Y = 556,162.31; thence North 00 degrees 29 minutes 49 seconds East 1.01 feet to a point having Coordinates of X = 1,708,750.42 and Y = 556,163.31; thence North 89 degrees 30 minutes 08 seconds West 5,279.35 feet to a point having Coordinates of X = 1,703,471.27 and Y = 556,209.17; thence North 00 degrees 36 minutes 16 seconds East 5,325.26 feet to a point on the Southern boundary of said State Lease No. 19765 having Coordinates of X = 1,703,527.44 and Y = 561,534.13; thence along the boundary of said State Lease No. 19765 the following courses: South 89 degrees 30 minutes 08 seconds East 5,269.35 feet to a point having Coordinates of X = 1,708,796.59 and Y = 561,488.36 and South 89 degrees 19 minutes 02 seconds East 160.63 feet to the point of beginning, containing approximately **42 acres**, all as more particularly outlined on a plat on file in the Office of Mineral Resources, Department of Natural Resources. All bearings, distances and coordinates are based on Louisiana Coordinate System of 1927, (North or South Zone), where applicable.

NOTE: The above description of the Tract nominated for lease has been provided and corrected, where required, exclusively by the nomination party. Any mineral lease selected from this Tract and awarded by the Louisiana State Mineral and Energy Board shall be without warranty of any kind, either express, implied, or statutory, including, but not limited to, the implied warranties of merchantability and fitness for a particular purpose. Should the mineral lease awarded by the Louisiana State Mineral and Energy Board be subsequently modified, cancelled or abrogated due to the existence of conflicting leases, operating agreements, private claims or other future obligations or conditions which may affect all or any portion of the leased Tract, it shall not relieve the Lessee of the obligation to pay any bonus due thereon to the Louisiana State Mineral and Energy Board, nor shall the Louisiana State Mineral and Energy Board be

obligated to refund any consideration paid by the Lessor prior to such modification, cancellation, or abrogation, including, but not limited to, bonuses, rentals and royalties.

Applicant: PARAMOUNT ENERGY, INC.

Bidder	Cash Payment	Price/Acre	Rental	Oil	Gas	Other



Legend

10110039

Active\_Leases

IMAGERY.DOQQ\_2004\_1M

RED RIVER PARISH

T14N - R11W

SL 19765

SL 20014

P.O.B.

SL 20015

LOGGY BAYOU

SL 19769

0 2,000 Feet



**TRACT 41701 - Red River Parish, Louisiana**

All of the lands now or formerly constituting the beds and bottoms of all water bodies of every nature and description as to which title is vested in the State of Louisiana, together with all islands arising therein and other lands formed by accretion or by reliction, where allowed by law, excepting tax adjudicated lands, and not presently under mineral lease on November 10, 2010, situated in Red River Parish, Louisiana, and more particularly described as follows: Beginning at a point on the East boundary of State Lease No. 19124 having Coordinates of X = 1,698,526.00 and Y = 556,862.16; thence South 89 degrees 29 minutes 04 seconds East 4,533.49 feet to a point having Coordinates of X = 1,703,059.31 and Y = 556,821.37; thence South 06 degrees 10 minutes 47 seconds West 611.52 feet to a point having Coordinates of X = 1,702,993.48 and Y = 556,213.40; thence South 89 degrees 29 minutes 34 seconds East 477.81 feet to a point having Coordinates of X = 1,703,471.27 and Y = 556,209.17; thence South 00 degrees 30 minutes 24 seconds West 2,540.81 feet to a point having Coordinates of X = 1,703,448.80 and Y = 553,668.46; thence South 43 degrees 34 minutes 45 seconds East 348.75 feet to a point having Coordinates of X = 1,703,689.21 and Y = 553,415.82; thence South 00 degrees 30 minutes 23 seconds West 1,880.86 feet to a point on the Northern boundary of the Southwestern portion of State Lease No. 19769, as amended, having Coordinates of X = 1,703,672.59 and Y = 551,535.03; thence North 89 degrees 25 minutes 04 seconds West 5,146.86 feet along the Northern boundary of said portion of State Lease No. 19769 to its Northwest corner, also being a point on the East boundary of said State Lease No. 19124 having Coordinates of X = 1,698,526.00 and Y = 551,587.32; thence North 5,274.83 feet along the East boundary of said State Lease No. 19124 to the point of beginning, containing approximately **44 acres**, all as more particularly outlined on a plat on file in the Office of Mineral Resources, Department of Natural Resources. All bearings, distances and coordinates are based on Louisiana Coordinate System of 1927, (North or South Zone), where applicable.

NOTE: The above description of the Tract nominated for lease has been provided and corrected, where required, exclusively by the nomination party. Any mineral lease selected from this Tract and awarded by the Louisiana State Mineral and Energy Board shall be without warranty of any kind, either express, implied, or statutory, including, but not limited to, the implied warranties of merchantability and fitness for a particular purpose. Should the mineral lease awarded by the Louisiana State Mineral and Energy Board be subsequently modified, cancelled or abrogated due to the existence of conflicting leases, operating agreements, private claims or other future obligations or conditions which may affect all or any portion of the leased Tract, it shall not relieve the Lessee of the obligation to pay any bonus due thereon to the Louisiana State Mineral and Energy Board, nor shall the Louisiana State Mineral and Energy Board be obligated to refund any consideration paid by the Lessor prior to such modification, cancellation, or abrogation, including, but not limited to, bonuses, rentals and royalties.

Applicant: GOODRICH PETROLEUM COMPANY, L.L.C.

Bidder	Cash Payment	Price/Acre	Rental	Oil	Gas	Other

Legend

10110022

Active\_Leases

IMAGERY.DOQQ\_2004\_1M

RED RIVER PARISH

T14N - R11W

RED RIVER

P.O.B.

SL 19124

SL 19769

0 2,000 Feet

**TRACT 41702 - Red River Parish, Louisiana**

All of the lands now or formerly constituting the beds and bottoms of all water bodies of every nature and description as to which title is vested in the State of Louisiana, together with all islands arising therein and other lands formed by accretion or by reliction, where allowed by law, excepting tax adjudicated lands, and not presently under mineral lease on November 10, 2010, situated in Red River Parish, Louisiana, and more particularly described as follows: Beginning at a point having Coordinates of X = 1,703,471.27 and Y = 556,209.17; thence South 89 degrees 30 minutes 08 seconds East 5,279.35 feet to a point having Coordinates of X = 1,708,750.42 and Y = 556,163.31; thence South 00 degrees 29 minutes 49 seconds West 1.01 feet to the Northwest corner of the Northeastern portion of State Lease No. 19769, as amended, having Coordinates of X = 1,708,750.41 and Y = 556,162.31; thence South 00 degrees 30 minutes 11 seconds West 5,281.09 feet along the West boundary of said Northeastern portion of State Lease No. 19769 to its Southwest corner, also being the Northeast corner of the Southwestern portion of said State Lease No. 19769 having Coordinates of X = 1,708,704.04 and Y = 550,881.42; thence along the boundary of said Southwestern portion of State Lease No. 19769 the following courses: North 89 degrees 30 minutes 08 seconds West 3,345.95 feet; North 21 degrees 40 minutes 01 seconds East 653.70 feet and North 89 degrees 29 minutes 37 seconds West 1,927.06 feet to a point having Coordinates of X = 1,703,672.59 and Y = 551,535.03; thence North 00 degrees 30 minutes 23 seconds East 1,880.86 feet to a point having Coordinates of X = 1,703,689.21 and Y = 553,415.82; thence North 43 degrees 34 minutes 45 seconds West 348.75 feet to a point having Coordinates of X = 1,703,448.80 and Y = 553,668.46; thence North 00 degrees 30 minutes 24 seconds East 2,540.81 feet to the point of beginning, containing approximately **169 acres**, all as more particularly outlined on a plat on file in the Office of Mineral Resources, Department of Natural Resources. All bearings, distances and coordinates are based on Louisiana Coordinate System of 1927, (North or South Zone), where applicable.

NOTE: The above description of the Tract nominated for lease has been provided and corrected, where required, exclusively by the nomination party. Any mineral lease selected from this Tract and awarded by the Louisiana State Mineral and Energy Board shall be without warranty of any kind, either express, implied, or statutory, including, but not limited to, the implied warranties of merchantability and fitness for a particular purpose. Should the mineral lease awarded by the Louisiana State Mineral and Energy Board be subsequently modified, cancelled or abrogated due to the existence of conflicting leases, operating agreements, private claims or other future obligations or conditions which may affect all or any portion of the leased Tract, it shall not relieve the Lessee of the obligation to pay any bonus due thereon to the Louisiana State Mineral and Energy Board, nor shall the Louisiana State Mineral and Energy Board be obligated to refund any consideration paid by the Lessor prior to such

modification, cancellation, or abrogation, including, but not limited to, bonuses, rentals and royalties.

Applicant: GOODRICH PETROLEUM COMPANY, L.L.C.

Bidder	Cash Payment	Price/Acre	Rental	Oil	Gas	Other

Legend

10110023

Active\_Leases

IMAGERY.DOQQ\_2004\_1M

0 2,000 Feet



RED RIVER PARISH

T14N - R11W

LOGGY BAYOU

P.O.B.

RED RIVER

SL 19769

SL 19769

**TRACT 41703 - Red River Parish, Louisiana**

All of the lands now or formerly constituting the beds and bottoms of all water bodies of every nature and description as to which title is vested in the State of Louisiana, together with all islands arising therein and other lands formed by accretion or by reliction, where allowed by law, excepting tax adjudicated lands, and not presently under mineral lease on November 10, 2010, situated in Red River Parish, Louisiana, and more particularly described as follows: Beginning at a point on the West boundary of State Lease No. 20015, also being the Easternmost Northeast corner of the Southwestern portion of State Lease No. 19769, as amended, having Coordinates of X = 1,708,957.21 and Y = 545,575.77; thence along the Southwestern portion of said State Lease No. 19769 the following courses: North 89 degrees 30 minutes 40 seconds West 308.15 feet to a point having Coordinates of X = 1,708,649.07 and Y = 545,578.40 and North 00 degrees 35 minutes 38 seconds East 5,303.30 feet to the Southwest corner of the Northeastern portion of said State Lease No. 19769 having Coordinates of X = 1,708,704.04 and Y = 550,881.42; thence South 89 degrees 30 minutes 40 seconds East 253.18 feet along the South boundary of the Northeastern portion of said State Lease No. 19769 to its Southeast corner, also being a point on the West boundary of said State Lease No. 20015 having Coordinates of X = 1,708,957.21 and Y = 550,879.26; thence South 5,303.49 feet along the West boundary of said State Lease No. 20015 to the point of beginning, containing approximately **33 acres**, all as more particularly outlined on a plat on file in the Office of Mineral Resources, Department of Natural Resources. All bearings, distances and coordinates are based on Louisiana Coordinate System of 1927, (North or South Zone), where applicable.

NOTE: The above description of the Tract nominated for lease has been provided and corrected, where required, exclusively by the nomination party. Any mineral lease selected from this Tract and awarded by the Louisiana State Mineral and Energy Board shall be without warranty of any kind, either express, implied, or statutory, including, but not limited to, the implied warranties of merchantability and fitness for a particular purpose. Should the mineral lease awarded by the Louisiana State Mineral and Energy Board be subsequently modified, cancelled or abrogated due to the existence of conflicting leases, operating agreements, private claims or other future obligations or conditions which may affect all or any portion of the leased Tract, it shall not relieve the Lessee of the obligation to pay any bonus due thereon to the Louisiana State Mineral and Energy Board, nor shall the Louisiana State Mineral and Energy Board be obligated to refund any consideration paid by the Lessor prior to such modification, cancellation, or abrogation, including, but not limited to, bonuses, rentals and royalties.



Applicant: PARAMOUNT ENERGY, INC.

Bidder	Cash Payment	Price/Acre	Rental	Oil	Gas	Other

Legend

101110041

Active\_Leases

IMAGERY.DOQQ\_2004\_1M

SL 19769

RED RIVER PARISH

T14N - R10W

SL 20015

P.O.B.

RED RIVER

SL 19769



0 1,000 Feet

**TRACT 41704 - - Sabine Parish, Louisiana**

The State Mineral and Energy Board acting on behalf of the Sabine Parish School Board , pursuant to Resolution(s) adopted by that (those) body(ies) and in accordance with Louisiana Revised Statutes 30:121-136 and 151-156, as amended, and Article XIV, Section 16(A)(9) and (B) of the Louisiana Constitution of 1974, as same may be continued and promulgated in proper statutory form and, further, amended from time to time, advertises the lands not under mineral lease on November 10, 2010, excluding the beds and bottoms of all navigable water bodies located within the following: All or a portion of Section 16, Township 08 North, Range 14 West in Sabine Parish, Louisiana, The North half (N/2) of fractional Section 16, Township 8 North, Range 14 West in Sabine Parish, Louisiana, containing approximately **193 acres, LESS AND EXCEPT:** that portion thereof, if any, located West of the boundary line between the States of Texas and Louisiana as determined by the report of the Special master and adjudicated by the Supreme Court of the United States in litigation styled **Texas v. Louisiana, et al No. 36 Original**, or as otherwise approved by said court, all as more particularly outlined on a plat on file in the Office of Mineral Resources, Department of Natural Resources. All bearings, distances and coordinates are based on Louisiana Coordinate System of 1927, (North or South Zone).

NOTE: The above description of the Tract nominated for lease has been provided and corrected, where required, exclusively by the nomination party. Any mineral lease selected from this Tract and awarded by the Louisiana State Mineral and Energy Board shall be without warranty of any kind, either express, implied, or statutory, including, but not limited to, the implied warranties of merchantability and fitness for a particular purpose. Should the mineral lease awarded by the Louisiana State Mineral and Energy Board be subsequently modified, cancelled or abrogated due to the existence of conflicting leases, operating agreements, private claims or other future obligations or conditions which may affect all or any portion of the leased Tract, it shall not relieve the Lessee of the obligation to pay any bonus due thereon to the Louisiana State Mineral and Energy Board, nor shall the Louisiana State Mineral and Energy Board be obligated to refund any consideration paid by the Lessor prior to such modification, cancellation, or abrogation, including, but not limited to, bonuses, rentals and royalties.

NOTE: The Sabine Parish School Board requests a minimum bonus of \$4,000.00 per acre and a minimum royalty of 25%.

Applicant: SANDOZ & ASSOCIATES, INC.

Bidder	Cash Payment	Price/Acre	Rental	Oil	Gas	Other

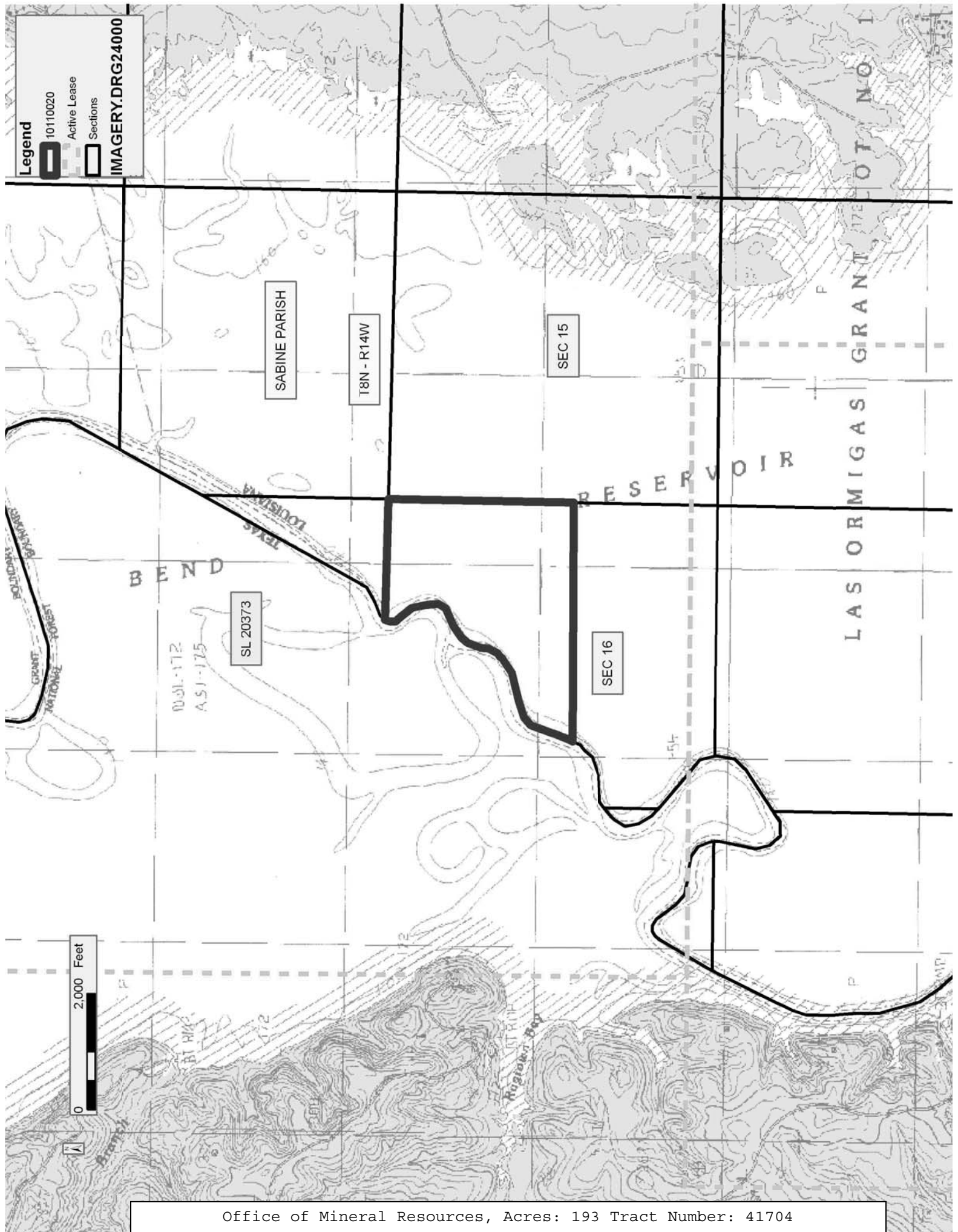

**Legend**  
10110020  
Active Lease  
Sections  
IMAGERY.DRG24000

0 2,000 Feet

**TRACT 41705 - Acadia Parish, Louisiana**

All of the lands now or formerly constituting the beds and bottoms of all water bodies of every nature and description as to which title is vested in the State of Louisiana, together with all islands arising therein and other lands formed by accretion or by reliction, where allowed by law, excepting tax adjudicated lands, and not presently under mineral lease on November 10, 2010, situated in Acadia Parish, Louisiana, and more particularly described as follows: Beginning at a point having Coordinates of X = 1,629,840.00 and Y = 634,911.00; thence East 13,243.00 feet to a point having Coordinates of X = 1,643,083.00 and Y = 634,911.00; thence South 7,184.00 feet to a point having Coordinates of X = 1,643,083.00 and Y = 627,727.00; thence West 13,243.00 feet to a point having Coordinates of X = 1,629,840.00 and Y = 627,727.00; thence North 7,184.00 feet to the Point of Beginning, containing **24 acres**, all as more particularly outlined on a plat on file in the Office of Mineral Resources, Department of Natural Resources. All bearings, distances and coordinates are based on Louisiana Coordinate System of 1927, (North or South Zone), where applicable.

NOTE: The above description of the Tract nominated for lease has been provided and corrected, where required, exclusively by the nomination party. Any mineral lease selected from this Tract and awarded by the Louisiana State Mineral and Energy Board shall be without warranty of any kind, either express, implied, or statutory, including, but not limited to, the implied warranties of merchantability and fitness for a particular purpose. Should the mineral lease awarded by the Louisiana State Mineral and Energy Board be subsequently modified, cancelled or abrogated due to the existence of conflicting leases, operating agreements, private claims or other future obligations or conditions which may affect all or any portion of the leased Tract, it shall not relieve the Lessee of the obligation to pay any bonus due thereon to the Louisiana State Mineral and Energy Board, nor shall the Louisiana State Mineral and Energy Board be obligated to refund any consideration paid by the Lessor prior to such modification, cancellation, or abrogation, including, but not limited to, bonuses, rentals and royalties.

Applicant: ORBIT ENERGY, INC.

Bidder	Cash Payment	Price/Acre	Rental	Oil	Gas	Other

Legend

10110029

IMAGERY.DOQQ\_2008\_1M\_CIR

0 2,000 Feet



ACADIA PARISH

T7S - R1W

P.O.B.

BAYOU MALLET

T8S - R1W

**TRACT 41706 - Cameron Parish, Louisiana**

All of the lands now or formerly constituting the beds and bottoms of all water bodies of every nature and description as to which title is vested in the State of Louisiana, together with all islands arising therein and other lands formed by accretion or by reliction, where allowed by law, excepting tax adjudicated lands, and not presently under mineral lease on November 10, 2010, situated in Cameron Parish, Louisiana, and more particularly described as follows: Beginning at a point on the South line of State Lease No. 20341 having Coordinates of X = 1,224,315.84 and Y = 470,300.00; thence along the boundary of said State Lease No. 20341 the following courses: East 823.16 feet to a point having Coordinates of X = 1,225,139.00 and Y = 470,300.00 and North 2,550.00 feet to a point having Coordinates of X = 1,225,139.00 and Y = 472,850.00; thence East 2,424.87 feet to the Southwest corner of State Lease No. 20235 having Coordinates of X = 1,227,563.87 and Y = 472,850.00; thence East 5,800.00 feet along the South line of said State Lease No. 20235 to its Southeast corner having Coordinates of X = 1,233,363.87 and Y = 472,850.00; thence East 1,136.13 feet to a point having Coordinates of X = 1,234,500.00 and Y = 472,850.00; thence South 11,850.00 feet to a point having Coordinates of X = 1,234,500.00 and Y = 461,000.00; thence West 8,728.00 feet to a point on the East line of State Lease No. 19438 having Coordinates of X = 1,225,772.00 and Y = 461,000.00; thence along the boundary of said State Lease No. 19438 the following courses: North 2,164.00 feet to a point having Coordinates of X = 1,225,772.00 and Y = 463,164.00; West 1,323.53 feet to a point having Coordinates of X = 1,224,448.47 and Y = 463,164.00; and West 132.63 feet to a point having Coordinates of X = 1,224,315.84 and Y = 463,164.00; thence North 7,136.00 feet to the Point of Beginning, containing approximately **1,599 acres**, all as more particularly outlined on a plat on file in the Office of Mineral Resources, Department of Natural Resources. All bearings, distances and coordinates are based on Louisiana Coordinate System of 1927, (North or South Zone), where applicable.

NOTE: The above description of the Tract nominated for lease has been provided and corrected, where required, exclusively by the nomination party. Any mineral lease selected from this Tract and awarded by the Louisiana State Mineral and Energy Board shall be without warranty of any kind, either express, implied, or statutory, including, but not limited to, the implied warranties of merchantability and fitness for a particular purpose. Should the mineral lease awarded by the Louisiana State Mineral and Energy Board be subsequently modified, cancelled or abrogated due to the existence of conflicting leases, operating agreements, private claims or other future obligations or conditions which may affect all or any portion of the leased Tract, it shall not relieve the Lessee of the obligation to pay any bonus due thereon to the Louisiana State Mineral and Energy Board, nor shall the Louisiana State Mineral and Energy Board be obligated to refund any consideration paid by the Lessor prior to such modification, cancellation, or abrogation, including, but not limited to, bonuses, rentals and royalties.



NOTE: The State of Louisiana does hereby reserve, and this lease shall be subject to, the imprescriptible right of surface use in the nature of a servitude in favor of the Department of Natural Resources, including its Offices and Commissions, for the sole purpose of implementing, constructing, servicing and maintaining approved coastal zone management and/or restoration projects. Utilization of any and all rights derived under this lease by the mineral lessee, its agents, successors or assigns, shall not interfere with nor hinder the reasonable surface use by the Department of Natural Resources, its Offices or Commissions, as herein above reserved.

NOTE: This tract is located in an area designated by the Louisiana Legislature or the Wildlife and Fisheries Commission as a Public Oyster Seed Ground, Reservation, or area of Calcasieu or Sabine Lake. Proposed projects occurring in these areas will be evaluated on a case by case basis by Louisiana Department of Wildlife & Fisheries. Modifications to proposed project features including, but not limited to, access routes, well sites, flowlines, and appurtenant structures maybe required by the Louisiana Department of Wildlife and Fisheries. In addition, compensatory mitigation will be required to offset unavoidable habitat impacts.

Applicant: SAUR MINERALS, LLC

Bidder	Cash Payment	Price/Acre	Rental	Oil	Gas	Other

Legend

10110004

Active\_Leases

IMAGERY.DOQQ\_2008\_1M\_CIR

0 3,000 Feet



CAMERON PARISH

SL 20235

SL 20341

P.O.B.

SABINE LAKE

SL 19438

**TRACT 41707 - Cameron Parish, Louisiana**

All of the lands now or formerly constituting the beds and bottoms of all water bodies of every nature and description the title of which vests in the State of Louisiana, together with all islands arising therein and other lands formed by accretion or by reliction, where allowed by law, excepting tax adjudicated lands, and not presently under mineral lease on November 10, 2010, situated in Cameron Parish, Louisiana, and more particularly described as follows: Beginning at a point on the South line of State Lease No. 20341 having Coordinates of X = 1,224,315.84 and Y = 470,300.00; thence South 7,136.00 feet to a point on the North line of State Lease No. 19438 to point having Coordinates of X = 1,224,315.84 and Y = 463,164.00; thence along the boundary of said State Lease No. 19438 the following courses: West 4,721.84 feet to a point having Coordinates of X = 1,219,594.00 and Y = 463,164.00 and South 4,264.00 feet to a point having Coordinates of X = 1,219,594.00 and Y = 458,900.00; thence West 8,882.00 feet to a point on the Texas-Louisiana boundary having Coordinates of X = 1,210,712.00 and Y = 458,900.00; thence along the boundary of said Texas-Louisiana the following courses: North 31 degrees 07 minutes 12 seconds East 2,201.88 feet to a point having Coordinates of X = 1,211,850.00 and Y = 460,785.00; North 21 degrees 41 minutes 28 seconds East 2,895.00 feet to a point having Coordinates of X = 1,212,920.00 and Y = 463,475.00; North 14 degrees 23 minutes 58 seconds East 5,549.33 feet to a point having Coordinates of X = 1,214,300.00 and Y = 468,850.00; and North 11 degrees 52 minutes 43 seconds East 1,481.73 feet to the Southwest corner of State Lease No. 20032 having Coordinates of X = 1,214,605.00 and Y = 470,300.00; thence East 4,734.00 feet along the South line of said State Lease No. 20032 to its Southeast corner, said corner also being the Southwest corner of State Lease No. 20341, having Coordinates of X = 1,219,339.00 and Y = 470,300.00; thence East 4,976.84 feet along the South line of said State Lease No. 20341 to the Point of Beginning, containing **2,487.98 acres, LESS AND EXCEPT** that portion thereof, if any, located West of the boundary line between the States of Texas and Louisiana as determined by the report of the Special Master and adjudicated by the Supreme Court of the United States in litigation styled **Texas v. Louisiana, et al No. 36 Original**, or as otherwise approved by said court, all as more particularly outlined on a plat on file in the Office of Mineral Resources, Department of Natural Resources. All bearings, distances and coordinates are based on Louisiana Coordinate System of 1927, (North or South Zone), where applicable.

NOTE: The above description of the Tract nominated for lease has been provided and corrected, where required, exclusively by the nomination party. Any mineral lease selected from this Tract and awarded by the Louisiana State Mineral and Energy Board shall be without warranty of any kind, either express, implied, or statutory, including, but not limited to, the implied warranties of merchantability and fitness for a particular purpose. Should the mineral lease awarded by the Louisiana State Mineral and Energy Board be subsequently modified, cancelled or abrogated due to the existence of conflicting leases, operating agreements, private claims

or other future obligations or conditions which may affect all or any portion of the leased Tract, it shall not relieve the Lessee of the obligation to pay any bonus due thereon to the Louisiana State Mineral and Energy Board, nor shall the Louisiana State Mineral and Energy Board be obligated to refund any consideration paid by the Lessor prior to such modification, cancellation, or abrogation, including, but not limited to, bonuses, rentals and royalties.

NOTE: The State of Louisiana does hereby reserve, and this lease shall be subject to, the imprescriptible right of surface use in the nature of a servitude in favor of the Department of Natural Resources, including its Offices and Commissions, for the sole purpose of implementing, constructing, servicing and maintaining approved coastal zone management and/or restoration projects. Utilization of any and all rights derived under this lease by the mineral lessee, its agents, successors or assigns, shall not interfere with nor hinder the reasonable surface use by the Department of Natural Resources, its Offices or Commissions, as herein above reserved.

NOTE: This tract is located in an area designated by the Louisiana Legislature or the Wildlife and Fisheries Commission as a Public Oyster Seed Ground, Reservation, or area of Calcasieu or Sabine Lake. Proposed projects occurring in these areas will be evaluated on a case by case basis by Louisiana Department of Wildlife & Fisheries. Modifications to proposed project features including, but not limited to, access routes, well sites, flowlines, and appurtenant structures maybe required by the Louisiana Department of Wildlife and Fisheries. In addition, compensatory mitigation will be required to offset unavoidable habitat impacts.

Applicant: SAUR MINERALS, LLC

Bidder	Cash Payment	Price/Acre	Rental	Oil	Gas	Other

**Legend**  
10110003  
Active\_Leases

