

TRACT 41708 - Cameron Parish, Louisiana

All of the lands now or formerly constituting the beds and bottoms of all water bodies of every nature and description as to which title is vested in the State of Louisiana, together with all islands arising therein and other lands formed by accretion or by reliction, where allowed by law, excepting tax adjudicated lands, and not presently under mineral lease on November 10, 2010, situated in Cameron Parish, Louisiana, and more particularly described as follows: Beginning at a point having Coordinates of X = 1,360,272.00 and Y = 419,981.00; thence East 9,160.00 feet to a point having Coordinates of X = 1,369,432.00 and Y = 419,981.00; thence South 8,128.00 feet to a point having Coordinates of X = 1,369,432.00 and Y = 411,853.00; thence West 9,160.00 feet to a point having Coordinates of X = 1,360,272.00 and Y = 411,853.00; thence North 8,128.00 feet to the point of beginning, (This lease includes only waterbottoms claimed and owned by the state and specifically excludes any land which the state may claim or own and to which the mineral rights are vested in the state), containing approximately **270 acres**, all as more particularly outlined on a plat on file in the Office of Mineral Resources, Department of Natural Resources. All bearings, distances and coordinates are based on Louisiana Coordinate System of 1927, (North or South Zone), where applicable.

NOTE: The above description of the Tract nominated for lease has been provided and corrected, where required, exclusively by the nomination party. Any mineral lease selected from this Tract and awarded by the Louisiana State Mineral and Energy Board shall be without warranty of any kind, either express, implied, or statutory, including, but not limited to, the implied warranties of merchantability and fitness for a particular purpose. Should the mineral lease awarded by the Louisiana State Mineral and Energy Board be subsequently modified, cancelled or abrogated due to the existence of conflicting leases, operating agreements, private claims or other future obligations or conditions which may affect all or any portion of the leased Tract, it shall not relieve the Lessee of the obligation to pay any bonus due thereon to the Louisiana State Mineral and Energy Board, nor shall the Louisiana State Mineral and Energy Board be obligated to refund any consideration paid by the Lessor prior to such modification, cancellation, or abrogation, including, but not limited to, bonuses, rentals and royalties.

NOTE: The State of Louisiana does hereby reserve, and this lease shall be subject to, the imprescriptible right of surface use in the nature of a servitude in favor of the Department of Natural Resources, including its Offices and Commissions, for the sole purpose of implementing, constructing, servicing and maintaining approved coastal zone management and/or restoration projects. Utilization of any and all rights derived under this lease by the mineral lessee, its agents, successors or assigns, shall not interfere with nor hinder the reasonable surface use by the Department of Natural Resources, its Offices or Commissions, as herein above reserved.

Applicant: THEOPHILUS OIL, GAS & LAND SERVICES, LLC

Bidder	Cash Payment	Price/Acre	Rental	Oil	Gas	Other

Legend

10110028

IMAGERY.DOQQ_2008_1M_CIR

CAMERON PARISH

T14S - R10W

CALCASIEU RIVER

P.O.B.

T15S - R10W

0 2,000 Feet



TRACT 41709 - Portion of Blocks 25, 26, 31, and 32, Main Pass Area, Revised, Plaquemines Parish, Louisiana

All of the lands now or formerly constituting the beds and bottoms of all water bodies of every nature and description as to which title is vested in the State of Louisiana, together with all islands arising therein and other lands formed by accretion or by reliction, where allowed by law, excepting tax adjudicated lands, and not presently under mineral lease on November 10, 2010, situated in Plaquemines Parish, Louisiana, and more particularly described as follows: Beginning at a point being the Northeast corner of State Lease No. 1958, as amended having Coordinates of X = 2,620,600.00 and Y = 297,280.00, said point also being on the Eastern boundary of Block 32 Main Pass Area, Revised; thence West 8,362.00 feet along the Northern boundary of said State Lease No. 1958, as amended, to a point having Coordinates of X = 2,612,238.00 and Y = 297,280.00; thence North 10,300.00 feet to a point on the Northern boundary of Block 32, Main Pass Area, Revised, having Coordinates of X = 2,612,238.00 and Y = 307,580.00; thence North 1,106.00 feet to a point being in Block 25, Main Pass Area, Revised, having Coordinates of X = 2,612,238.00 and Y = 308,686.00; thence East 8,362.00 feet to a point being on the Eastern boundary of Block 25, Main Pass Area, Revised, having Coordinates of X = 2,620,600.00 and Y = 308,686.00; thence East 1,234.00 feet to a point being in Block 26, Main Pass Area, Revised, having Coordinates of X = 2,621,834.00 and Y = 308,686.00; thence South 1,106.00 feet to a point being on the Southern boundary of Block 31, Main Pass Area, Revised, having Coordinates of X = 2,621,834.00 and Y = 307,580.00; thence South 10,300.00 feet to a point being in Block 31, Main Pass Area, Revised, having Coordinates of X = 2,621,834.00 and Y = 297,280.00; thence West 1,234.00 feet to the point of beginning, **LESS AND EXCEPT:** State Lease No. 20103 in its entirety, being more particularly described as follows: Beginning at a point being the point of beginning of the above mentioned tract having Coordinates of X = 2,620,600.00 and Y = 297,280.00; thence North 38 degrees 08 minutes 13 seconds West 732.11 feet to the point of beginning of State Lease No. 20103 having Coordinates of X = 2,620,147.89 and Y = 297,855.83; thence North 1,320.00 feet to the point having Coordinates of X = 2,620,147.89 and Y = 299,175.83; thence East 1,320.00 feet to a point having Coordinates of X = 2,621,467.89 and Y = 299,175.83; thence South 1,320.00 feet to a point having Coordinates of X = 2,621,467.89 and Y = 297,855.83; thence West 1,320.00 feet to its point of beginning; total nominated acreage containing **2,472.67 acres**, all as more particularly outlined on a plat on file in the Office of Mineral Resources, Department of Natural Resources. All bearings, distances and coordinates are based on Louisiana Coordinate System of 1927, (North or South Zone), where applicable.

NOTE: The above description of the Tract nominated for lease has been provided and corrected, where required, exclusively by the nomination party. Any mineral lease selected from this Tract and awarded by the Louisiana State Mineral and Energy Board shall be without warranty of any kind, either express, implied, or statutory, including, but not limited

to, the implied warranties of merchantability and fitness for a particular purpose. Should the mineral lease awarded by the Louisiana State Mineral and Energy Board be subsequently modified, cancelled or abrogated due to the existence of conflicting leases, operating agreements, private claims or other future obligations or conditions which may affect all or any portion of the leased Tract, it shall not relieve the Lessee of the obligation to pay any bonus due thereon to the Louisiana State Mineral and Energy Board, nor shall the Louisiana State Mineral and Energy Board be obligated to refund any consideration paid by the Lessor prior to such modification, cancellation, or abrogation, including, but not limited to, bonuses, rentals and royalties.

NOTE: The State of Louisiana does hereby reserve, and this lease shall be subject to, the imprescriptible right of surface use in the nature of a servitude in favor of the Department of Natural Resources, including its Offices and Commissions, for the sole purpose of implementing, constructing, servicing and maintaining approved coastal zone management and/or restoration projects. Utilization of any and all rights derived under this lease by the mineral lessee, its agents, successors or assigns, shall not interfere with nor hinder the reasonable surface use by the Department of Natural Resources, its Offices or Commissions, as herein above reserved.

NOTE: This tract is located in an area designated by the Louisiana Legislature or the Wildlife and Fisheries Commission as a Public Oyster Seed Ground, Reservation, or area of Calcasieu or Sabine Lake. Proposed projects occurring in these areas will be evaluated on a case by case basis by Louisiana Department of Wildlife & Fisheries. Modifications to proposed project features including, but not limited to, access routes, well sites, flowlines, and appurtenant structures maybe required by the Louisiana Department of Wildlife and Fisheries. In addition, compensatory mitigation will be required to offset unavoidable habitat impacts.

Applicant: ROBERT A. SCHROEDER, INC.

Bidder	Cash Payment	Price/Acre	Rental	Oil	Gas	Other

Legend

-  10110030
-  Blocks
-  Active Leases

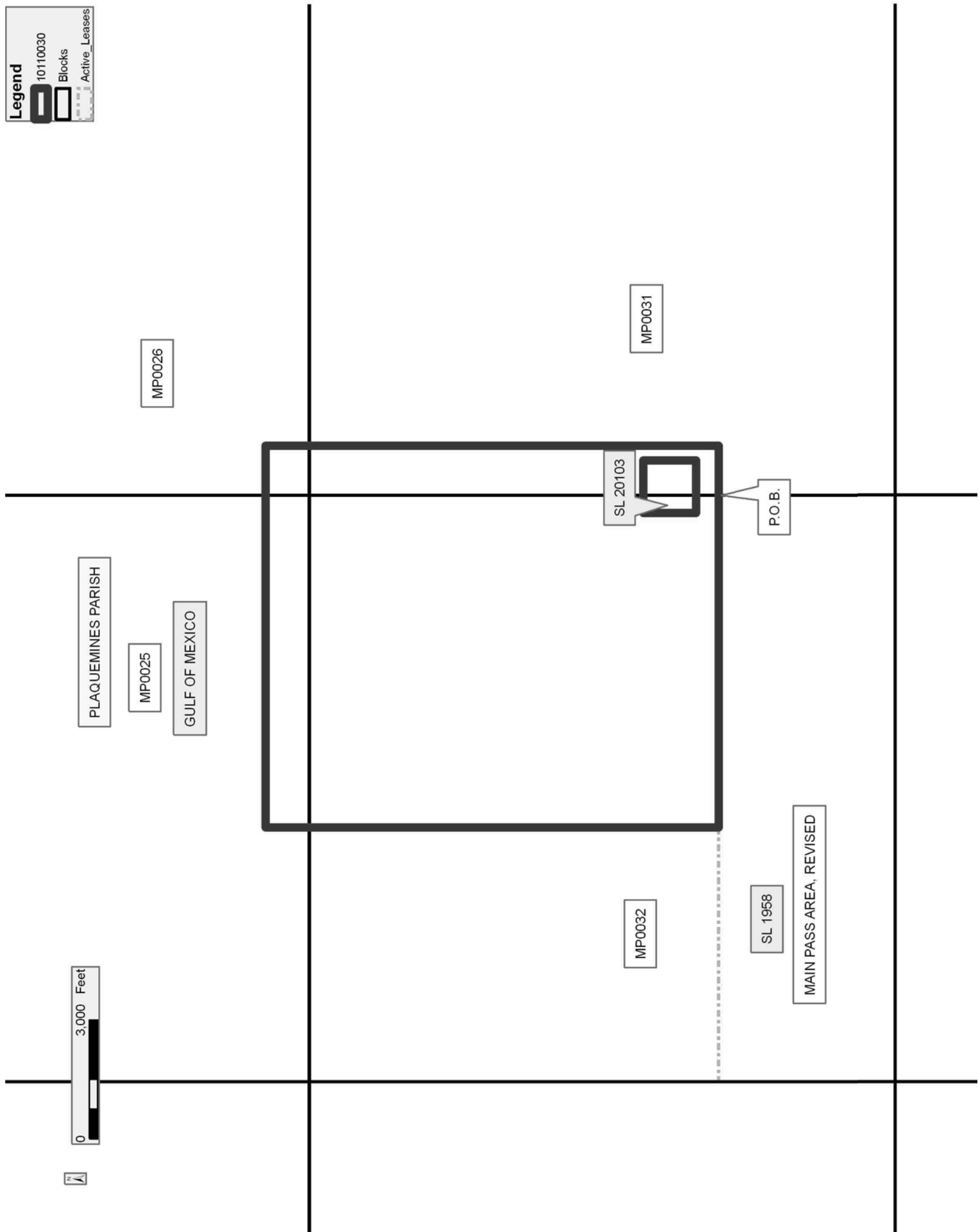

TRACT 41710 - Portion of Blocks 32, and 33, Main Pass Area, Revised, Plaquemines Parish, Louisiana

All of the lands now or formerly constituting the beds and bottoms of all water bodies of every nature and description as to which title is vested in the State of Louisiana, together with all islands arising therein and other lands formed by accretion or by reliction, where allowed by law, excepting tax adjudicated lands, and not presently under mineral lease on November 10, 2010, situated in Plaquemines Parish, Louisiana, and more particularly described as follows: Beginning at a point being the Northwest corner of State Lease No. 1958, as amended having Coordinates of X = 2,605,850.00 and Y = 297,280.00, said point also being on the Eastern boundary of Block 33, Main Pass Area, Revised; thence South 4,450.00 feet along the Western boundary of said State Lease No. 1958, as amended to its Southwest corner having Coordinates of X = 2,605,850.00 and Y = 292,830.00, said point also being the Southeast corner of said Block 33, Main Pass Area, Revised; thence West 2,900.00 feet along the Southern boundary of said Block 33, Main Pass Area, Revised to a point having Coordinates of X = 2,602,950.00 and Y = 292,830.00; thence North 14,750.00 feet to a point a point on the Northern boundary of said Block 33, Main Pass Area, Revised having Coordinates of X = 2,602,950.00 and Y = 307,580.00; thence East 2,900.00 feet along the Northern boundary of said Block 33, Main Pass Area, Revised, to a point having Coordinates of X = 2,605,850.00 and Y = 307,580.00, said point also being the Northwest corner of said Block 32, Main Pass Area, Revised; thence East 6,388.00 feet along the Northern boundary of said Block 32, Main Pass Area, Revised, to a point having Coordinates of X = 2,612,238.00 and Y = 307,580.00; thence South 10,300.00 feet to a point on the Northern boundary of said of State Lease No. 1958, as amended having Coordinates of X = 2,612,238.00 and Y = 297,280.00; thence West 6,388.00 feet along the Northern boundary said State Lease No. 1958, as amended, to the point of beginning, containing **2,492.46 acres**, all as more particularly outlined on a plat on file in the Office of Mineral Resources, Department of Natural Resources. All bearings, distances and coordinates are based on Louisiana Coordinate System of 1927, (North or South Zone), where applicable.

NOTE: The above description of the Tract nominated for lease has been provided and corrected, where required, exclusively by the nomination party. Any mineral lease selected from this Tract and awarded by the Louisiana State Mineral and Energy Board shall be without warranty of any kind, either express, implied, or statutory, including, but not limited to, the implied warranties of merchantability and fitness for a particular purpose. Should the mineral lease awarded by the Louisiana State Mineral and Energy Board be subsequently modified, cancelled or abrogated due to the existence of conflicting leases, operating agreements, private claims or other future obligations or conditions which may affect all or any portion of the leased Tract, it shall not relieve the Lessee of the obligation to pay any bonus due thereon to the Louisiana State Mineral and Energy Board, nor shall the Louisiana State Mineral and Energy Board be obligated to refund any consideration paid by the Lessor prior to such

modification, cancellation, or abrogation, including, but not limited to, bonuses, rentals and royalties.

NOTE: The State of Louisiana does hereby reserve, and this lease shall be subject to, the imprescriptible right of surface use in the nature of a servitude in favor of the Department of Natural Resources, including its Offices and Commissions, for the sole purpose of implementing, constructing, servicing and maintaining approved coastal zone management and/or restoration projects. Utilization of any and all rights derived under this lease by the mineral lessee, its agents, successors or assigns, shall not interfere with nor hinder the reasonable surface use by the Department of Natural Resources, its Offices or Commissions, as herein above reserved.

NOTE: This tract is located in an area designated by the Louisiana Legislature or the Wildlife and Fisheries Commission as a Public Oyster Seed Ground, Reservation, or area of Calcasieu or Sabine Lake. Proposed projects occurring in these areas will be evaluated on a case by case basis by Louisiana Department of Wildlife & Fisheries. Modifications to proposed project features including, but not limited to, access routes, well sites, flowlines, and appurtenant structures maybe required by the Louisiana Department of Wildlife and Fisheries. In addition, compensatory mitigation will be required to offset unavoidable habitat impacts.

Applicant: ROBERT A. SCHROEDER, INC.

Bidder	Cash Payment	Price/Acre	Rental	Oil	Gas	Other

Legend

- 10110031
- Blocks
- Active Leases

PLAQUEMINES PARISH

MP0025

GULF OF MEXICO

MP0032

SL 1958

MAIN PASS AREA, REVISED

SL 1961

P.O.B.



MP0024

MP0033



TRACT 41711 - Plaquemines Parish, Louisiana

All of the lands now or formerly constituting the beds and bottoms of all water bodies of every nature and description as to which title is vested in the State of Louisiana, together with all islands arising therein and other lands formed by accretion or by reliction, where allowed by law, excepting tax adjudicated lands, and not presently under mineral lease on November 10, 2010, situated in Plaquemines Parish, Louisiana, and more particularly described as follows: Beginning at a point on the Southwestern corner of State Lease No. 19250 having Coordinates of X = 2,569,403.70 and Y = 249,698.71; thence South 53 degrees 32 minutes 34 seconds East approximately 946 feet, along a Southern boundary of said State Lease No. 19250, to a point on a Western boundary of State Lease No. 192, as amended; thence Southerly and Westerly approximately 10,230 feet, along the boundary of said State Lease No. 192, as amended, to a point on a Northern boundary of State Lease No. 3212; thence Westerly along the boundary of said State Lease No. 3212 approximately 3,953 feet to a point on an Eastern boundary of State Lease No. 2651; thence along the boundary of said State Lease No. 2651, the following courses: North approximately 2,399 feet and West approximately 8,576 feet to a point having a Coordinate of X = 2,552,352.00; thence North approximately 5,925 feet to a point having Coordinates of X = 2,552,352.00 and Y = 250,441.00; thence East 16,837.00 feet to a point having Coordinates of X = 2,569,189.00 and Y = 250,441.00; thence South 62 degrees 49 minutes 55 seconds East 621.00 feet to a point on the Northwestern boundary of said State Lease No. 19250 having Coordinates of X = 2,569,741.49 and Y = 250,157.45; thence South 36 degrees 21 minutes 57 seconds West 569.69 feet along the Northwestern boundary of said State Lease No. 19250 to the point of beginning, containing approximately **1,559 acres**, all as more particularly outlined on a plat on file in the Office of Mineral Resources, Department of Natural Resources. All bearings, distances and coordinates are based on Louisiana Coordinate System of 1927, (North or South Zone), where applicable.

NOTE: The above description of the Tract nominated for lease has been provided and corrected, where required, exclusively by the nomination party. Any mineral lease selected from this Tract and awarded by the Louisiana State Mineral and Energy Board shall be without warranty of any kind, either express, implied, or statutory, including, but not limited to, the implied warranties of merchantability and fitness for a particular purpose. Should the mineral lease awarded by the Louisiana State Mineral and Energy Board be subsequently modified, cancelled or abrogated due to the existence of conflicting leases, operating agreements, private claims or other future obligations or conditions which may affect all or any portion of the leased Tract, it shall not relieve the Lessee of the obligation to pay any bonus due thereon to the Louisiana State Mineral and Energy Board, nor shall the Louisiana State Mineral and Energy Board be obligated to refund any consideration paid by the Lessor prior to such modification, cancellation, or abrogation, including, but not limited to, bonuses, rentals and royalties.

NOTE: The State of Louisiana does hereby reserve, and this lease shall be subject to, the imprescriptible right of surface use in the nature of a servitude in favor of the Department of Natural Resources, including its Offices and Commissions, for the sole purpose of implementing, constructing, servicing and maintaining approved coastal zone management and/or restoration projects. Utilization of any and all rights derived under this lease by the mineral lessee, its agents, successors or assigns, shall not interfere with nor hinder the reasonable surface use by the Department of Natural Resources, its Offices or Commissions, as herein above reserved.

Applicant: ROBERT A. SCHROEDER, INC.

Bidder	Cash Payment	Price/Acre	Rental	Oil	Gas	Other

Legend

10110032

Active_Leases

IMAGERY.DOQQ_2008_1M_CIR

0 3,000 Feet



PLAQUEMINES PARISH

T20S - R28E

T20S - R29E

SL 19250

P.O.B.

SL 192

BAY POMME D'OR

SL 2651

SL 3212

SL 192

TRACT 41712 - Plaquemines Parish, Louisiana

All of the lands now or formerly constituting the beds and bottoms of all water bodies of every nature and description as to which title is vested in the State of Louisiana, together with all islands arising therein and other lands formed by accretion or by reliction, where allowed by law, excepting tax adjudicated lands, and not presently under mineral lease on November 10, 2010, situated in Plaquemines Parish, Louisiana, and more particularly described as follows: Beginning at the Southwest corner of State Lease No. 2485, as amended, having Coordinates of X = 2,646,798.60 and Y = 152,175.23; thence Easterly approximately 253 feet along the Southern boundary of said State Lease No. 2485 to a point; thence South 42 degrees 21 minutes 11 seconds West approximately 3,062 feet to a point of intersection with the Eastern boundary of Operating Agreement No. AO 0001; thence along the boundary of said Operating Agreement No. AO 0001 the following: Northerly approximately 2,142 feet; Westerly approximately 1,092 feet and Northerly approximately 177 feet to the Southeast corner of State Lease No. 451; thence Northerly approximately 10,293 feet along the East boundary of said State Lease No. 451 to the Southwest corner of State Lease No. 2484; thence Easterly approximately 4,549 feet to a point that is North 01 degrees 48 minutes 53 seconds West approximately 7,768 feet from X = 2,648,273.87 and Y = 154,730.46; thence South 01 degrees 48 minutes 53 seconds East approximately 7,768 feet to a point on the Western boundary of said State Lease No. 2485 having Coordinates of X = 2,648,273.87 and Y = 154,730.46; thence along the Western boundary of said State Lease No. 2485 South 30 degrees 00 minutes 00 seconds West 2,950.53 feet to the point of beginning, **LESS AND EXCEPT** that portion, if any, of Operating Agreement No. AO 0001, State Lease No. 451, State Lease No. 2484 and State Lease No. 2485, as amended and approximately 155 acres of Freeze Statute acreage subject to La. R.S. 9:1151 that may lie within the above described tract, containing approximately **956 acres**, all as more particularly outlined on a plat on file in the Office of Mineral Resources, Department of Natural Resources. All bearings, distances and coordinates are based on Louisiana Coordinate System of 1927, (North or South Zone), where applicable.

NOTE: The above description of the Tract nominated for lease has been provided and corrected, where required, exclusively by the nomination party. Any mineral lease selected from this Tract and awarded by the Louisiana State Mineral and Energy Board shall be without warranty of any kind, either express, implied, or statutory, including, but not limited to, the implied warranties of merchantability and fitness for a particular purpose. Should the mineral lease awarded by the Louisiana State Mineral and Energy Board be subsequently modified, cancelled or abrogated due to the existence of conflicting leases, operating agreements, private claims or other future obligations or conditions which may affect all or any portion of the leased Tract, it shall not relieve the Lessee of the obligation to pay any bonus due thereon to the Louisiana State Mineral and Energy Board, nor shall the Louisiana State Mineral and Energy Board be obligated to refund any consideration paid by the Lessor prior to such

modification, cancellation, or abrogation, including, but not limited to, bonuses, rentals and royalties.

NOTE: The State of Louisiana does hereby reserve, and this lease shall be subject to, the imprescriptible right of surface use in the nature of a servitude in favor of the Department of Natural Resources, including its Offices and Commissions, for the sole purpose of implementing, constructing, servicing and maintaining approved coastal zone management and/or restoration projects. Utilization of any and all rights derived under this lease by the mineral lessee, its agents, successors or assigns, shall not interfere with nor hinder the reasonable surface use by the Department of Natural Resources, its Offices or Commissions, as herein above reserved.

Applicant: MARK A. O'NEAL & ASSOCIATES, INC.

Bidder	Cash Payment	Price/Acre	Rental	Oil	Gas	Other

Legend

10110025

Freeze Statute Acreage

Slowwaterbottoms

Active_Leases

IMAGERY.DOQQ_2008_1M_CIR

SL 2484

SL 2485

P.O.B.

SL 451

GULF OF MEXICO

AO 0001

Approximate Freeze Statute acreage
Digitized from 1935, 1953 U.S.G.S.
1:24,000 Quads
154.67 acs.



TRACT 41713 - Terrebonne Parish, Louisiana

All of the lands now or formerly constituting the beds and bottoms of all water bodies of every nature and description as to which title is vested in the State of Louisiana, together with all islands arising therein and other lands formed by accretion or by reliction, where allowed by law, excepting tax adjudicated lands, and not presently under mineral lease on November 10, 2010, situated in Terrebonne Parish, Louisiana, and more particularly described as follows: Beginning at a point having Coordinates of X = 2,189,371.31 and Y = 145,100.13; thence North 00 degrees 10 minutes 09 seconds East 4,294.89 feet to a point having Coordinates of X = 2,189,384.00 and Y = 149,395.00; thence North 79 degrees 12 minutes 34 seconds East 7,595.30 feet to a point having Coordinates of X = 2,196,845.00 and Y = 150,817.00; thence South 01 degrees 39 minutes 05 seconds East 3,834.54 feet to a point having Coordinates of X = 2,196,955.51 and Y = 146,984.06; thence South 76 degrees 03 minutes 00 seconds West 7,814.68 feet to the Point of Beginning containing approximately **703.67 acres**, all as more particularly outlined on a plat on file in the Office of Mineral Resources, Department of Natural Resources. All bearings, distances and coordinates are based on Louisiana Coordinate System of 1927, (North or South Zone), where applicable.

NOTE: The above description of the Tract nominated for lease has been provided and corrected, where required, exclusively by the nomination party. Any mineral lease selected from this Tract and awarded by the Louisiana State Mineral and Energy Board shall be without warranty of any kind, either express, implied, or statutory, including, but not limited to, the implied warranties of merchantability and fitness for a particular purpose. Should the mineral lease awarded by the Louisiana State Mineral and Energy Board be subsequently modified, cancelled or abrogated due to the existence of conflicting leases, operating agreements, private claims or other future obligations or conditions which may affect all or any portion of the leased Tract, it shall not relieve the Lessee of the obligation to pay any bonus due thereon to the Louisiana State Mineral and Energy Board, nor shall the Louisiana State Mineral and Energy Board be obligated to refund any consideration paid by the Lessor prior to such modification, cancellation, or abrogation, including, but not limited to, bonuses, rentals and royalties.

NOTE: The State of Louisiana does hereby reserve, and this lease shall be subject to, the imprescriptible right of surface use in the nature of a servitude in favor of the Department of Natural Resources, including its Offices and Commissions, for the sole purpose of implementing, constructing, servicing and maintaining approved coastal zone management and/or restoration projects. Utilization of any and all rights derived under this lease by the mineral lessee, its agents, successors or assigns, shall not interfere with nor hinder the reasonable surface use by the Department of Natural Resources, its Offices or Commissions, as herein above reserved.

Applicant: LESLIE M. COOPER

Bidder	Cash Payment	Price/Acre	Rental	Oil	Gas	Other

Legend

-  10110018
-  Blocks
-  Active Leases

TERREBONNE PARISH

LAKE PELTO

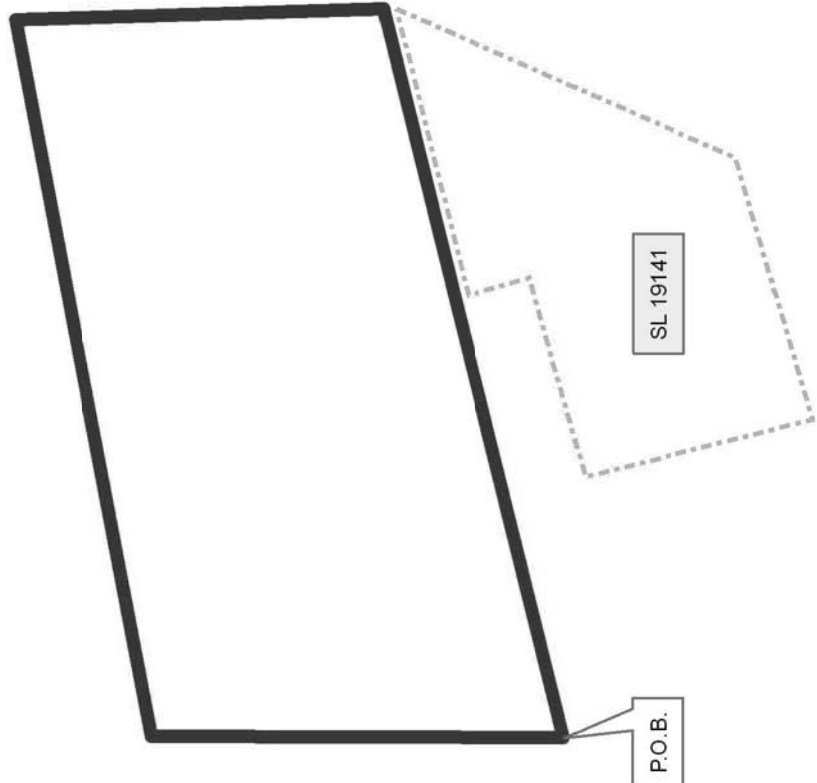

P.O.B.

SL 19141



SS0042

SHIP SHOAL AREA

SS0043