

**TRACT 42935 - St. Mary Parish, Louisiana**

A portion of all lands located above the mean high water mark, together with lands now or formerly constituting the beds and bottoms of any water body of whatever description or nature belonging to the State of Louisiana which is now located within the boundaries of the Atchafalaya Delta Wildlife Management Area and not presently under mineral lease by the State of Louisiana on October 10, 2012, and more particularly located as follows: Beginning at a point within the Atchafalaya Delta Wildlife Management Area having Coordinates of  $X = 1,955,521.20$  and  $Y = 310,529.10$ ; thence North approximately 8,352 feet to a point on the Northern boundary of the Atchafalaya Delta Wildlife Management Area having a Coordinate of  $X = 1,955,521.20$ ; thence Easterly along the meanders of the boundary of said Atchafalaya Delta Wildlife Management Area to a point on the West boundary of a portion of State Lease No. 340 B4, as amended; thence Southerly approximately 8,556 feet along the West boundary of said State Lease No. 340 B4 to the point of intersection with an East-West line having a Coordinate of  $Y = 310,529.10$ ; thence West approximately 10,145 feet along said line to the point of beginning, **LESS AND EXCEPT** that portion, if any, of the above described tract which may lie outside of the boundary of the Atchafalaya Delta Wildlife Management Area, also **LESS AND EXCEPT** any portion of State Lease No. 340 B4, as amended, that may lie within the above described tract, containing approximately **2,074 acres**, all as more particularly outlined on a plat on file in the Office of Mineral Resources, Department of Natural Resources. All bearings, distances and coordinates are based on Louisiana Coordinate System of 1927, (South Zone).

NOTE: The above description of the Tract nominated for lease has been provided and corrected, where required, exclusively by the nomination party. Any mineral lease selected from this Tract and awarded by the Louisiana State Mineral and Energy Board shall be without warranty of any kind, either express, implied, or statutory, including, but not limited to, the implied warranties of merchantability and fitness for a particular purpose. Should the mineral lease awarded by the Louisiana State Mineral and Energy Board be subsequently modified, cancelled or abrogated due to the existence of conflicting leases, operating agreements, private claims or other future obligations or conditions which may affect all or any portion of the leased Tract, it shall not relieve the Lessee of the obligation to pay any bonus due thereon to the Louisiana State Mineral and Energy Board, nor shall the Louisiana State Mineral and Energy Board be obligated to refund any consideration paid by the Lessor prior to such modification, cancellation, or abrogation, including, but not limited to, bonuses, rentals and royalties.

NOTE: The mineral lease is located in the Atchafalaya Delta WMA under the jurisdiction of the Louisiana Department of Wildlife and Fisheries which has promulgated rules and regulations for the protection of game and wildlife on the aforesaid Tract and, therefore, shall be subject to said rules and regulations, a copy of which shall be attached to the mineral

leases. In addition to the specific rules and regulations applicable, the following shall apply regarding operations under this mineral lease:

- No activities will be allowed without written authorization of the Louisiana Department of Wildlife and Fisheries.
- Proposed projects will be evaluated on a case by case basis. Modifications to proposed project features including but not limited to access routes, spoil placement, well sites, flowlines and appurtenant structures may be required by the Department of Wildlife and Fisheries.
- Compliance with the Atchafalaya Delta WMA regulations will be required unless otherwise specified by the Department of Wildlife and Fisheries.
- Compensatory mitigation will be required to offset unavoidable wetland impacts.
- Compensation and/or oyster seed ground surveys may be required by the Department for potential impacts to productive oyster seed grounds located within the management area.
- Removal of all structures, facilities and equipment will be required within 120 days of abandonment unless otherwise agreed to in writing by the Louisiana Department of Wildlife and Fisheries.
- No activities will be allowed during the hunting season unless approved by the Department.
- This tract is located within the emerging Atchafalaya Delta. No activities will be allowed on emergent islands, sub aerial mudflats or vegetated wetlands. Drilling will be restricted to passes and open water bays. The Louisiana Department of Wildlife and Fisheries (LDWF) shall have discretion to determine access routes. In the event that LDWF approves of dredging for access, LDWF shall have discretion to require hydraulic or spray dredging to reduce environmental impacts.
- Prior to submitting application for wetland permits to Federal and State permitting agencies the leaseholder shall coordinate project details with the Department of Wildlife and Fisheries. Contact person for the Department will be Mike Windham at (504)284-5268.

Additionally, the Department will require a minimum bonus of \$350.00 per acre and a minimum royalty of 25%.

NOTE: The State of Louisiana does hereby reserve, and this lease shall be subject to, the imprescriptible right of surface use in the nature of a servitude in favor of the Department of Natural Resources, including its Offices and Commissions, for the sole purpose of implementing, constructing, servicing and maintaining approved coastal zone management and/or restoration projects. Utilization of any and all rights derived under this lease by the mineral lessee, its agents, successors or assigns, shall not interfere with nor hinder the reasonable surface use by the

Department of Natural Resources, its Offices or Commissions, as herein above reserved.

NOTE: This tract is located in an area designated by the Louisiana Legislature or the Wildlife and Fisheries Commission as a Public Oyster Seed Ground, Reservation, or area of Calcasieu or Sabine Lake. Proposed projects occurring in these areas will be evaluated on a case by case basis by Louisiana Department of Wildlife & Fisheries. Modifications to proposed project features including, but not limited to, access routes, well sites, flowlines, and appurtenant structures maybe required by the Louisiana Department of Wildlife and Fisheries. In addition, compensatory mitigation will be required to offset unavoidable habitat impacts.

Applicant: LESLIE M. COOPER

Bidder	Cash Payment	Price/ Acre	Rental	Oil	Gas	Other



**Legend**

- 12100040
- Wildlife
- Active Leases

ST MARY PARISH



T17S - R10E

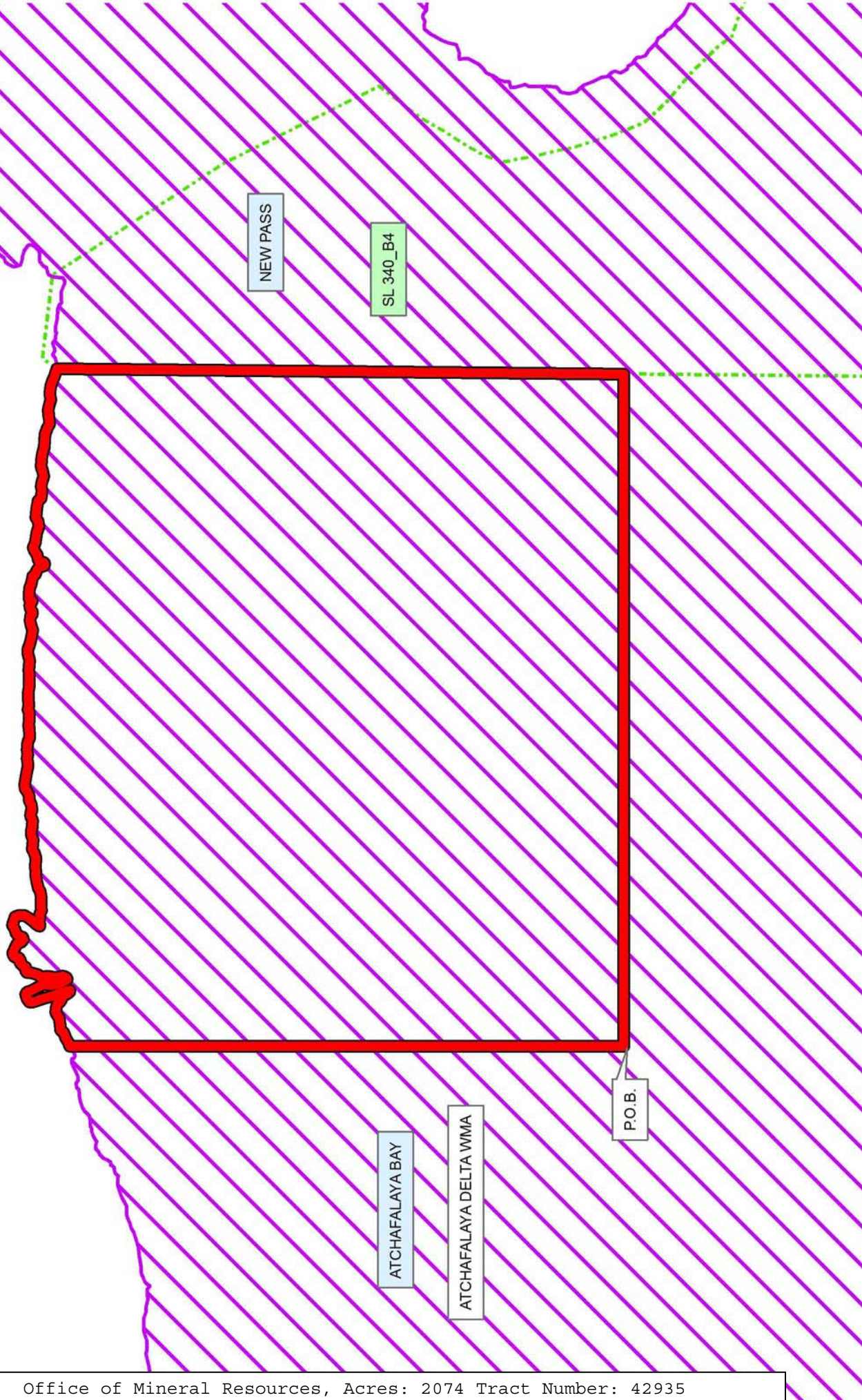



**TRACT 42936 - St. Mary Parish, Louisiana**

A portion of all lands located above the mean high water mark, together with lands now or formerly constituting the beds and bottoms of any water body of whatever description or nature belonging to the State of Louisiana which is now located within the boundaries of the Atchafalaya Delta Wildlife Management Area and not presently under mineral lease by the State of Louisiana on October 10, 2012, and more particularly located as follows: Beginning at a point within the Atchafalaya Delta Wildlife Management Area having Coordinates of X = 1,944,808.66 and Y = 311,740.53; thence North approximately 3,808 feet to a point on the Northern boundary of the Atchafalaya Delta Wildlife Management Area having a Coordinate of X = 1,944,808.66; thence Northeasterly along the meanders of the boundary of said Atchafalaya Delta Wildlife Management Area to a point on the Southern boundary of AO 0291; thence North 80 degrees 00 minutes 00 seconds East approximately 4,666 feet along the Southern boundary of said AO 0291 to a point on the Northern boundary of said Atchafalaya Delta Wildlife Management Area; thence Northeasterly along the meanders of the boundary of said Atchafalaya Delta Wildlife Management Area to a point on the Southern boundary of said AO 0291; thence North 80 degrees 00 minutes 00 seconds East approximately 559 feet along the Southern boundary of said AO 0291 to the Southwest corner of State Lease No. 18348, as amended, having Coordinates of X = 1,952,530.67 and Y = 317,861.71; thence along the boundary of said State Lease No. 18348 the following courses: North 80 degrees 00 minutes 00 seconds East 1,758.59 feet and North 10 degrees 00 minutes 00 seconds West approximately 390 feet to a point on the Northern boundary of said Atchafalaya Delta Wildlife Management Area; thence Northeasterly along the meanders of the boundary of said Atchafalaya Delta Wildlife Management Area to the point of intersection with a North South line having a Coordinate of X = 1,955,521.20; thence South approximately 7,148 feet along said line to a point having Coordinates of X = 1,955,521.20 and Y = 311,740.53; thence West 4,052.53 feet to a point on the East boundary of State Lease No. 20868 having Coordinates of X = 1,951,468.67 and Y = 311,740.53; thence along the boundaries of said State Lease No. 20868 the following courses: North 29 degrees 00 minutes 40 seconds East 1,002.29 feet to a point having Coordinates of X = 1,951,954.76 and Y = 312,617.06, North 33 degrees 59 minutes 32 seconds West 684.75 feet to a point having Coordinates of X = 1,951,571.93 and Y = 313,184.79, North 70 degrees 34 minutes 54 seconds West 548.33 feet to a point having Coordinates of X = 1,951,054.80 and Y = 313,367.09, North 81 degrees 19 minutes 29 seconds West 1,093.30 feet to a point having Coordinates of X = 1,949,974.00 and Y = 313,532.00 and South 01 degrees 25 minutes 41 seconds East 1,792.03 feet to a point having Coordinates of X = 1,950,018.66 and Y = 311,740.53; thence West 5,210.01 feet to the point of beginning, **LESS AND EXCEPT** that portion, if any, of the above described tract which may lie outside of the boundary of the Atchafalaya Delta Wildlife Management Area, also **LESS AND EXCEPT** any portion of State Lease No. 329, as amended, that may lie within the above described tract containing approximately **1,320 acres**, all as more particularly outlined on a plat on file in the Office of Mineral

Resources, Department of Natural Resources. All bearings, distances and coordinates are based on Louisiana Coordinate System of 1927, (South Zone).

NOTE: The above description of the Tract nominated for lease has been provided and corrected, where required, exclusively by the nomination party. Any mineral lease selected from this Tract and awarded by the Louisiana State Mineral and Energy Board shall be without warranty of any kind, either express, implied, or statutory, including, but not limited to, the implied warranties of merchantability and fitness for a particular purpose. Should the mineral lease awarded by the Louisiana State Mineral and Energy Board be subsequently modified, cancelled or abrogated due to the existence of conflicting leases, operating agreements, private claims or other future obligations or conditions which may affect all or any portion of the leased Tract, it shall not relieve the Lessee of the obligation to pay any bonus due thereon to the Louisiana State Mineral and Energy Board, nor shall the Louisiana State Mineral and Energy Board be obligated to refund any consideration paid by the Lessor prior to such modification, cancellation, or abrogation, including, but not limited to, bonuses, rentals and royalties.

NOTE: The mineral lease is located in the Atchafalaya Delta WMA under the jurisdiction of the Louisiana Department of Wildlife and Fisheries which has promulgated rules and regulations for the protection of game and wildlife on the aforesaid Tract and, therefore, shall be subject to said rules and regulations, a copy of which shall be attached to the mineral leases. In addition to the specific rules and regulations applicable, the following shall apply regarding operations under this mineral lease:

- No activities will be allowed without written authorization of the Louisiana Department of Wildlife and Fisheries.
- Proposed projects will be evaluated on a case by case basis. Modifications to proposed project features including but not limited to access routes, spoil placement, well sites, flowlines and appurtenant structures may be required by the Department of Wildlife and Fisheries.
- Compliance with the Atchafalaya Delta WMA regulations will be required unless otherwise specified by the Department of Wildlife and Fisheries.
- Compensatory mitigation will be required to offset unavoidable wetland impacts.
- Compensation and/or oyster seed ground surveys may be required by the Department for potential impacts to productive oyster seed grounds located within the management area.
- Removal of all structures, facilities and equipment will be required within 120 days of abandonment unless otherwise agreed to in writing by the Louisiana Department of Wildlife and Fisheries.

- No activities will be allowed during the hunting season unless approved by the Department.
- This tract is located within the emerging Atchafalaya Delta. No activities will be allowed on emergent islands, sub aerial mudflats or vegetated wetlands. Drilling will be restricted to passes and open water bays. The Louisiana Department of Wildlife and Fisheries (LDWF) shall have discretion to determine access routes. In the event that LDWF approves of dredging for access, LDWF shall have discretion to require hydraulic or spray dredging to reduce environmental impacts.
- Prior to submitting application for wetland permits to Federal and State permitting agencies the leaseholder shall coordinate project details with the Department of Wildlife and Fisheries. Contact person for the Department will be Mike Windham at (504)284-5268.

Additionally, the Department will require a minimum bonus of \$350.00 per acre and a minimum royalty of 25%.

NOTE: The State of Louisiana does hereby reserve, and this lease shall be subject to, the imprescriptible right of surface use in the nature of a servitude in favor of the Department of Natural Resources, including its Offices and Commissions, for the sole purpose of implementing, constructing, servicing and maintaining approved coastal zone management and/or restoration projects. Utilization of any and all rights derived under this lease by the mineral lessee, its agents, successors or assigns, shall not interfere with nor hinder the reasonable surface use by the Department of Natural Resources, its Offices or Commissions, as herein above reserved.

NOTE: This tract is located in an area designated by the Louisiana Legislature or the Wildlife and Fisheries Commission as a Public Oyster Seed Ground, Reservation, or area of Calcasieu or Sabine Lake. Proposed projects occurring in these areas will be evaluated on a case by case basis by Louisiana Department of Wildlife & Fisheries. Modifications to proposed project features including, but not limited to, access routes, well sites, flowlines, and appurtenant structures maybe required by the Louisiana Department of Wildlife and Fisheries. In addition, compensatory mitigation will be required to offset unavoidable habitat impacts.

Applicant: LESLIE M. COOPER

Bidder	Cash Payment	Price/ Acre	Rental	Oil	Gas	Other



**Legend**

12100041

Wildlife

Active Leases

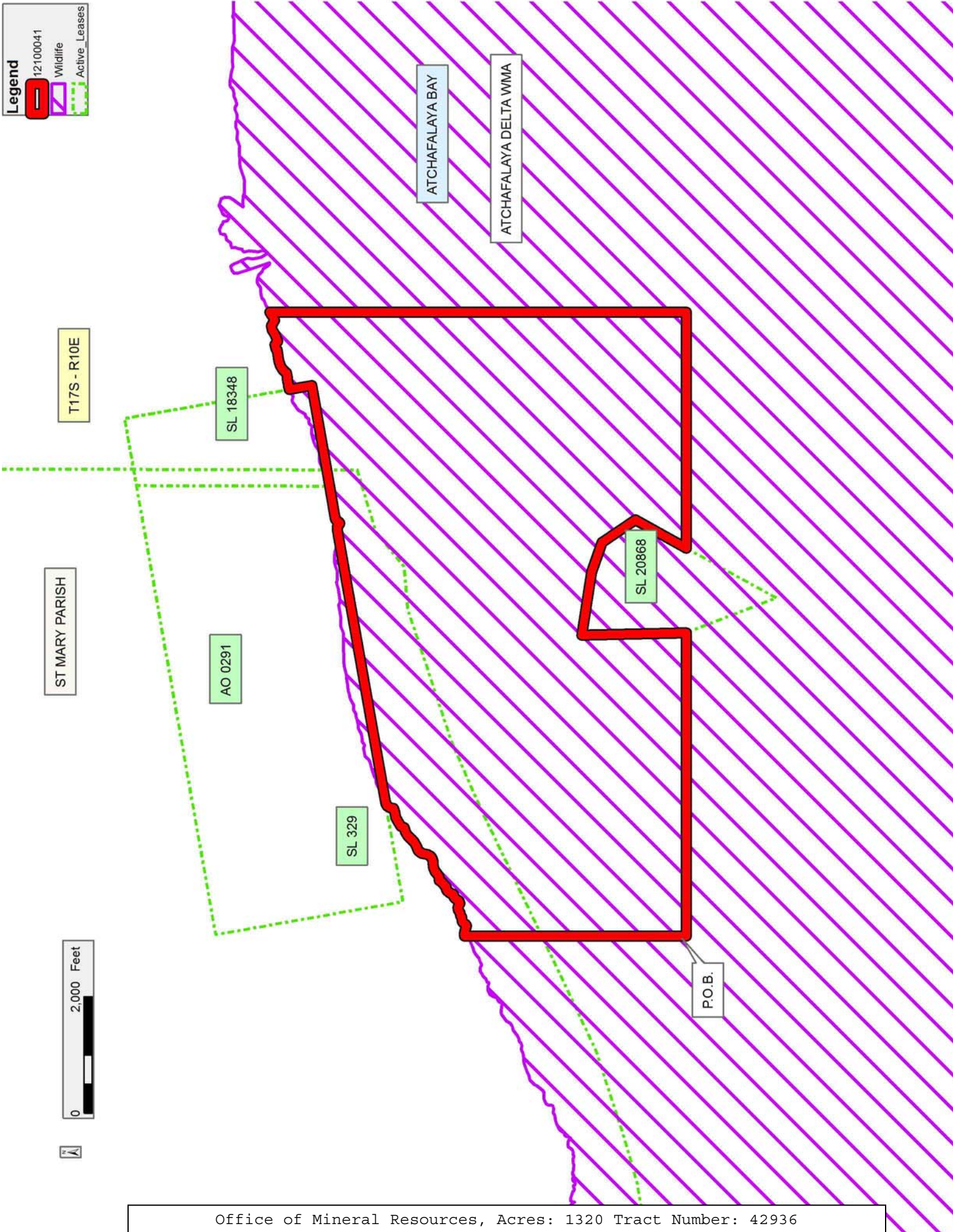

**TRACT 42937 - St. Mary Parish, Louisiana**

A portion of all lands located above the mean high water mark, together with lands now or formerly constituting the beds and bottoms of any water body of whatever description or nature belonging to the State of Louisiana which is now located within the boundaries of the Atchafalaya Delta Wildlife Management Area and not presently under mineral lease by the State of Louisiana on October 10, 2012, and more particularly located as follows: Beginning at a point within the Atchafalaya Delta Wildlife Management Area having Coordinates of X = 1,937,321.66 and Y = 305,401.60; thence North approximately 10,167 feet to a point on the Northern boundary of the Atchafalaya Delta Wildlife Management Area having a Coordinate of X = 1,937,321.66; thence Easterly along the meanders of the boundary of said Atchafalaya Delta Wildlife Management Area to a point of intersection with a North-South line having a Coordinate of X = 1,944,808.66; thence South approximately 10,167 feet to a point having Coordinates of X = 1,944,808.66 and Y = 305,401.60; thence West 7,487.00 feet to the point of beginning, **LESS AND EXCEPT** that portion, if any, of the above described tract which may lie outside of the boundary of the Atchafalaya Delta Wildlife Management Area, containing approximately **1,497 acres**, all as more particularly outlined on a plat on file in the Office of Mineral Resources, Department of Natural Resources. All bearings, distances and coordinates are based on Louisiana Coordinate System of 1927, (South Zone).

NOTE: The above description of the Tract nominated for lease has been provided and corrected, where required, exclusively by the nomination party. Any mineral lease selected from this Tract and awarded by the Louisiana State Mineral and Energy Board shall be without warranty of any kind, either express, implied, or statutory, including, but not limited to, the implied warranties of merchantability and fitness for a particular purpose. Should the mineral lease awarded by the Louisiana State Mineral and Energy Board be subsequently modified, cancelled or abrogated due to the existence of conflicting leases, operating agreements, private claims or other future obligations or conditions which may affect all or any portion of the leased Tract, it shall not relieve the Lessee of the obligation to pay any bonus due thereon to the Louisiana State Mineral and Energy Board, nor shall the Louisiana State Mineral and Energy Board be obligated to refund any consideration paid by the Lessor prior to such modification, cancellation, or abrogation, including, but not limited to, bonuses, rentals and royalties.

NOTE: The mineral lease is located in the Atchafalaya Delta WMA under the jurisdiction of the Louisiana Department of Wildlife and Fisheries which has promulgated rules and regulations for the protection of game and wildlife on the aforesaid Tract and, therefore, shall be subject to said rules and regulations, a copy of which shall be attached to the mineral leases. In addition to the specific rules and regulations applicable, the following shall apply regarding operations under this mineral lease:

- No activities will be allowed without written authorization of the Louisiana Department of Wildlife and Fisheries.
- Proposed projects will be evaluated on a case by case basis. Modifications to proposed project features including but not limited to access routes, spoil placement, well sites, flowlines and appurtenant structures may be required by the Department of Wildlife and Fisheries.
- Compliance with the Atchafalaya Delta WMA regulations will be required unless otherwise specified by the Department of Wildlife and Fisheries.
- Compensatory mitigation will be required to offset unavoidable wetland impacts.
- Compensation and/or oyster seed ground surveys may be required by the Department for potential impacts to productive oyster seed grounds located within the management area.
- Removal of all structures, facilities and equipment will be required within 120 days of abandonment unless otherwise agreed to in writing by the Louisiana Department of Wildlife and Fisheries.
- No activities will be allowed during the hunting season unless approved by the Department.
- This tract is located within the emerging Atchafalaya Delta. No activities will be allowed on emergent islands, sub aerial mudflats or vegetated wetlands. Drilling will be restricted to passes and open water bays. The Louisiana Department of Wildlife and Fisheries (LDWF) shall have discretion to determine access routes. In the event that LDWF approves of dredging for access, LDWF shall have discretion to require hydraulic or spray dredging to reduce environmental impacts.
- Prior to submitting application for wetland permits to Federal and State permitting agencies the leaseholder shall coordinate project details with the Department of Wildlife and Fisheries. Contact person for the Department will be Mike Windham at (504)284-5268.

Additionally, the Department will require a minimum bonus of \$350.00 per acre and a minimum royalty of 25%.

NOTE: The State of Louisiana does hereby reserve, and this lease shall be subject to, the imprescriptible right of surface use in the nature of a servitude in favor of the Department of Natural Resources, including its Offices and Commissions, for the sole purpose of implementing, constructing, servicing and maintaining approved coastal zone management and/or restoration projects. Utilization of any and all rights derived under this lease by the mineral lessee, its agents, successors or assigns, shall not interfere with nor hinder the reasonable surface use by the Department of Natural Resources, its Offices or Commissions, as herein above reserved.

NOTE: This tract is located in an area designated by the Louisiana Legislature or the Wildlife and Fisheries Commission as a Public Oyster Seed Ground, Reservation, or area of Calcasieu or Sabine Lake. Proposed projects occurring in these areas will be evaluated on a case by case basis by Louisiana Department of Wildlife & Fisheries. Modifications to proposed project features including, but not limited to, access routes, well sites, flowlines, and appurtenant structures maybe required by the Louisiana Department of Wildlife and Fisheries. In addition, compensatory mitigation will be required to offset unavoidable habitat impacts.

Applicant: LESLIE M. COOPER

Bidder	Cash Payment	Price/ Acre	Rental	Oil	Gas	Other



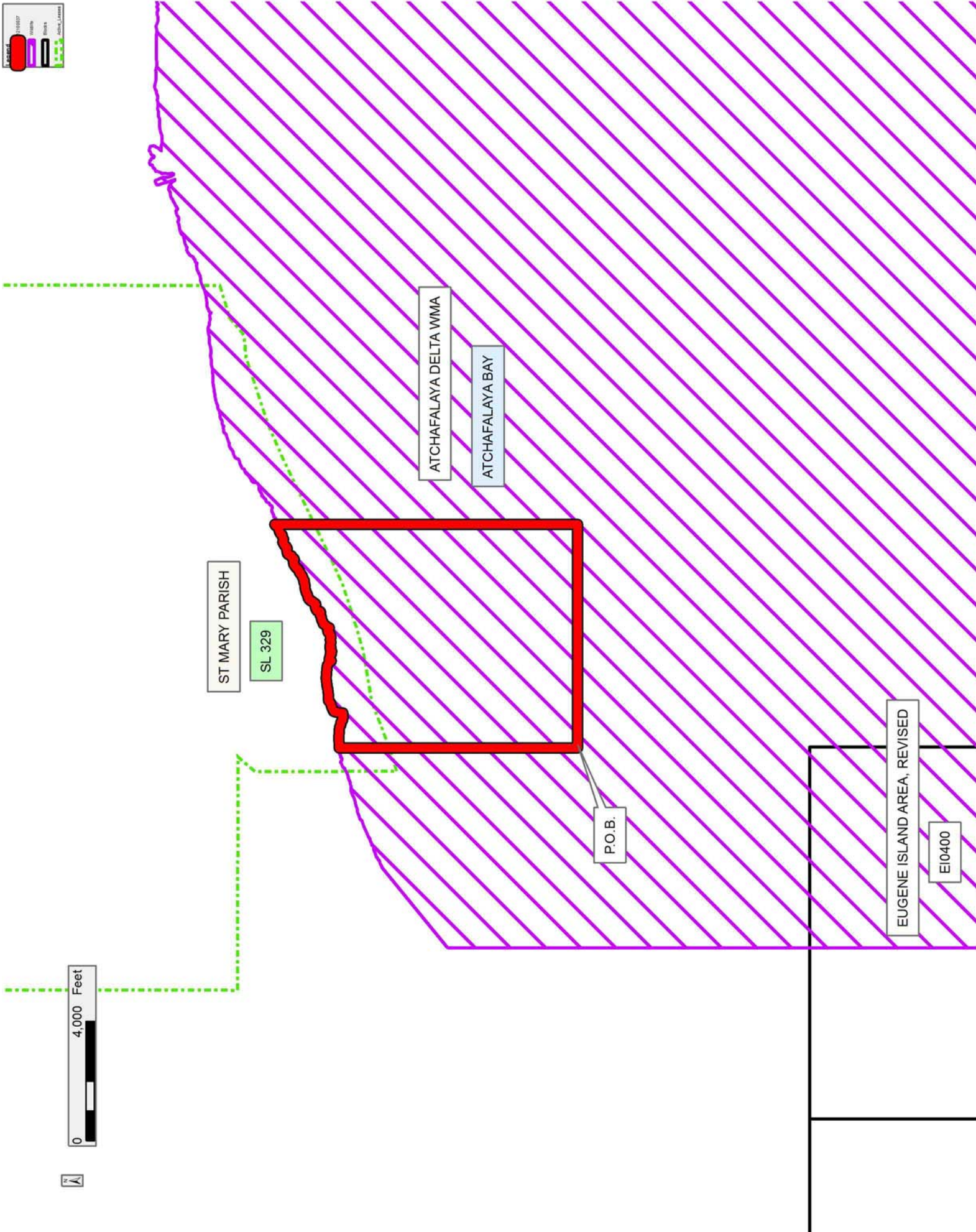
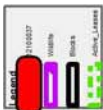



**TRACT 42938 - St. Mary Parish, Louisiana**

A portion of all lands located above the mean high water mark, together with lands now or formerly constituting the beds and bottoms of any water body of whatever description or nature belonging to the State of Louisiana which is now located within the boundaries of the Atchafalaya Delta Wildlife Management Area and not presently under mineral lease by the State of Louisiana on October 10, 2012, and more particularly located as follows: Beginning at a point within the Atchafalaya Delta Wildlife Management Area being a point having Coordinates of X = 1,944,808.66 and Y = 311,740.53; thence East 5,210.01 feet to a point on the West boundary of State Lease No. 20868 having Coordinates of X = 1,950,018.66 and Y = 311,740.53; thence along the boundaries of said State Lease No. 20868 the following courses: South 21 degrees 02 minutes 08 seconds East 1,654.21 feet to a point having Coordinates of X = 1,950,612.44 and Y = 310,196.56 and North 29 degrees 00 minutes 40 seconds East 1,765.49 feet to a point having Coordinates of X = 1,951,468.67 and Y = 311,740.53; thence East 4,052.53 feet to a point having Coordinates of X = 1,955,521.20 and Y = 311,740.53; thence South 3,589.73 feet to a point on the North boundary of State Lease No. 20869 having Coordinates of X = 1,955,521.20 and Y = 308,150.80; thence along the boundaries of said State Lease No. 20869 the following courses: South 44 degrees 44 minutes 51 seconds West 2,887.57 feet to a point having Coordinates of X = 1,953,488.40 and Y = 306,100.00 and South 27 degrees 39 minutes 25 seconds East 788.49 feet to its Southernmost point having Coordinates of X = 1,953,854.40 and Y = 305,401.60; thence West 9,045.74 feet to a point having Coordinates of X = 1,944,808.66 and Y = 305,401.60; thence North 6,338.93 feet to the point of beginning, containing approximately **1,455.70 acres**, all as more particularly outlined on a plat on file in the Office of Mineral Resources, Department of Natural Resources. All bearings, distances and coordinates are based on Louisiana Coordinate System of 1927, (South Zone).

NOTE: The above description of the Tract nominated for lease has been provided and corrected, where required, exclusively by the nomination party. Any mineral lease selected from this Tract and awarded by the Louisiana State Mineral and Energy Board shall be without warranty of any kind, either express, implied, or statutory, including, but not limited to, the implied warranties of merchantability and fitness for a particular purpose. Should the mineral lease awarded by the Louisiana State Mineral and Energy Board be subsequently modified, cancelled or abrogated due to the existence of conflicting leases, operating agreements, private claims or other future obligations or conditions which may affect all or any portion of the leased Tract, it shall not relieve the Lessee of the obligation to pay any bonus due thereon to the Louisiana State Mineral and Energy Board, nor shall the Louisiana State Mineral and Energy Board be obligated to refund any consideration paid by the Lessor prior to such modification, cancellation, or abrogation, including, but not limited to, bonuses, rentals and royalties.

NOTE: The mineral lease is located in the Atchafalaya Delta WMA under the jurisdiction of the Louisiana Department of Wildlife and Fisheries which has promulgated rules and regulations for the protection of game and wildlife on the aforesaid Tract and, therefore, shall be subject to said rules and regulations, a copy of which shall be attached to the mineral leases. In addition to the specific rules and regulations applicable, the following shall apply regarding operations under this mineral lease:

- No activities will be allowed without written authorization of the Louisiana Department of Wildlife and Fisheries.
- Proposed projects will be evaluated on a case by case basis. Modifications to proposed project features including but not limited to access routes, spoil placement, well sites, flowlines and appurtenant structures may be required by the Department of Wildlife and Fisheries.
- Compliance with the Atchafalaya Delta WMA regulations will be required unless otherwise specified by the Department of Wildlife and Fisheries.
- Compensatory mitigation will be required to offset unavoidable wetland impacts.
- Compensation and/or oyster seed ground surveys may be required by the Department for potential impacts to productive oyster seed grounds located within the management area.
- Removal of all structures, facilities and equipment will be required within 120 days of abandonment unless otherwise agreed to in writing by the Louisiana Department of Wildlife and Fisheries.
- No activities will be allowed during the hunting season unless approved by the Department.
- This tract is located within the emerging Atchafalaya Delta. No activities will be allowed on emergent islands, sub aerial mudflats or vegetated wetlands. Drilling will be restricted to passes and open water bays. The Louisiana Department of Wildlife and Fisheries (LDWF) shall have discretion to determine access routes. In the event that LDWF approves of dredging for access, LDWF shall have discretion to require hydraulic or spray dredging to reduce environmental impacts.
- Prior to submitting application for wetland permits to Federal and State permitting agencies the leaseholder shall coordinate project details with the Department of Wildlife and Fisheries. Contact person for the Department will be Mike Windham at (504)284-5268.

Additionally, the Department will require a minimum bonus of \$350.00 per acre and a minimum royalty of 25%.

NOTE: The State of Louisiana does hereby reserve, and this lease shall be subject to, the imprescriptible right of surface use in the nature of a servitude in favor of the Department of Natural Resources, including its

Offices and Commissions, for the sole purpose of implementing, constructing, servicing and maintaining approved coastal zone management and/or restoration projects. Utilization of any and all rights derived under this lease by the mineral lessee, its agents, successors or assigns, shall not interfere with nor hinder the reasonable surface use by the Department of Natural Resources, its Offices or Commissions, as herein above reserved.

NOTE: This tract is located in an area designated by the Louisiana Legislature or the Wildlife and Fisheries Commission as a Public Oyster Seed Ground, Reservation, or area of Calcasieu or Sabine Lake. Proposed projects occurring in these areas will be evaluated on a case by case basis by Louisiana Department of Wildlife & Fisheries. Modifications to proposed project features including, but not limited to, access routes, well sites, flowlines, and appurtenant structures maybe required by the Louisiana Department of Wildlife and Fisheries. In addition, compensatory mitigation will be required to offset unavoidable habitat impacts.

Applicant: LESLIE M. COOPER

Bidder	Cash Payment	Price/ Acre	Rental	Oil	Gas	Other



**Legend**

12100038

Wildlife

Active Leases

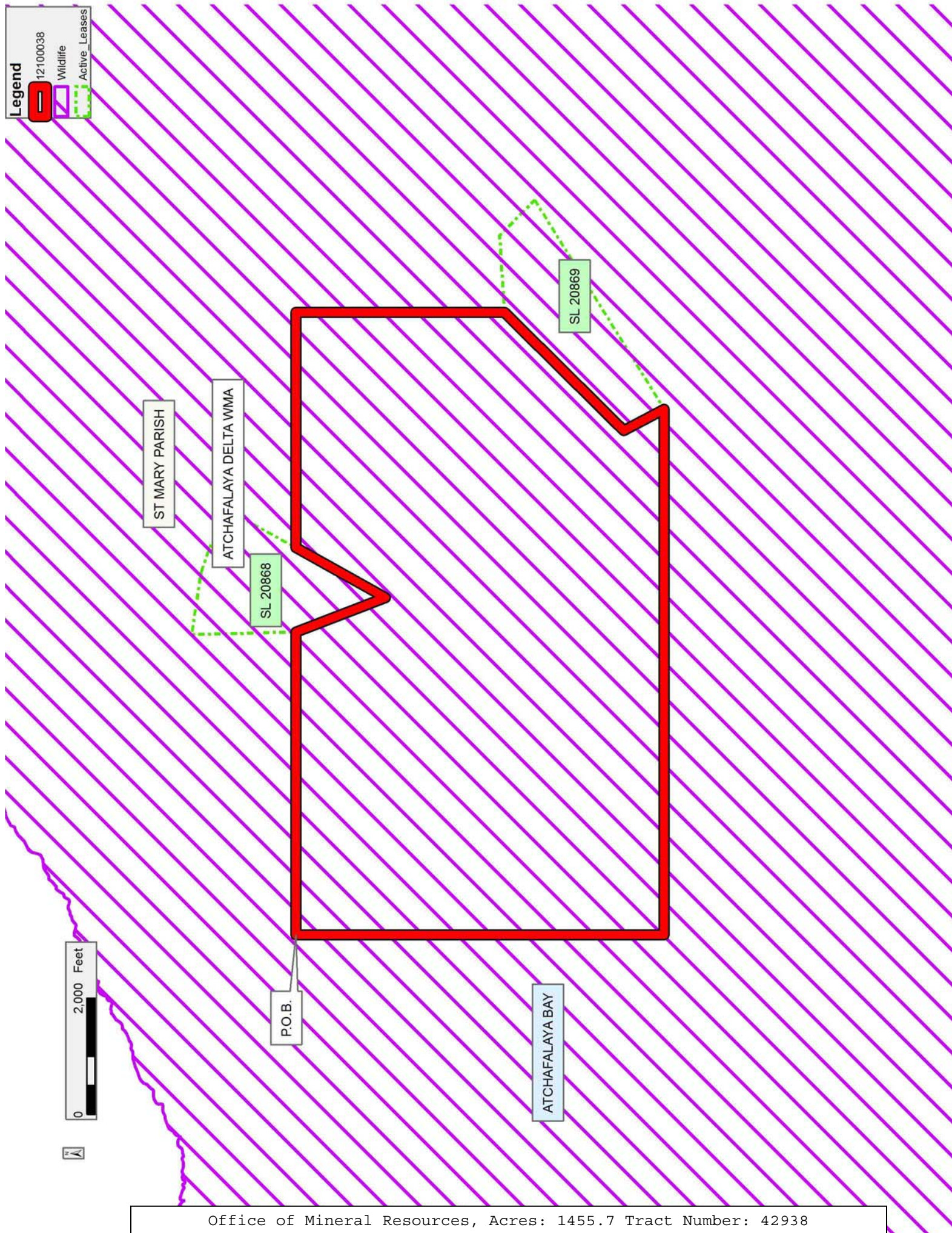



**TRACT 42939 - St. Mary Parish, Louisiana**

A portion of all lands located above the mean high water mark, together with lands now or formerly constituting the beds and bottoms of any water body of whatever description or nature belonging to the State of Louisiana which is now located within the boundaries of the Atchafalaya Delta Wildlife Management Area and not presently under mineral lease by the State of Louisiana on October 10, 2012, and more particularly located as follows: Beginning at a point within the Atchafalaya Delta Wildlife Management Area having Coordinates of X = 1,955,521.20 and Y = 310,529.10; thence East approximately 10,145 to a point on West boundary of State Lease No. 340 B4, as amended; thence Southerly approximately 5,128 feet along the West boundary of said State Lease No. 340 B4 to the point of intersection with a East-West line having a Coordinate of Y = 305,401.60; thence West approximately 11,765 feet along said line to a point being the Southernmost point of State Lease No. 20869 having Coordinates of X = 1,953,854.40 and Y = 305,401.60; thence along the boundaries of said State Lease No. 20869 the following courses: North 58 degrees 12 minutes 23 seconds East 4,234.13 feet to a point having Coordinates of X = 1,957,453.20 and Y = 307,632.40, North 45 degrees 37 minutes 15 seconds West 861.31 feet to a point having Coordinates of X = 1,956,837.60 and Y = 308,234.80 and South 86 degrees 20 minutes 56 seconds West 1,319.08 feet to a point having Coordinates of X = 1,955,521.20 and Y = 308,150.80; thence North 2,378.30 feet to the point of beginning, **LESS AND EXCEPT** that portion, if any, of State Lease No. 340, as amended, which may lie within the above described tract, containing approximately **1,163 acres**, all as more particularly outlined on a plat on file in the Office of Mineral Resources, Department of Natural Resources. All bearings, distances and coordinates are based on Louisiana Coordinate System of 1927, (South Zone).

NOTE: The above description of the Tract nominated for lease has been provided and corrected, where required, exclusively by the nomination party. Any mineral lease selected from this Tract and awarded by the Louisiana State Mineral and Energy Board shall be without warranty of any kind, either express, implied, or statutory, including, but not limited to, the implied warranties of merchantability and fitness for a particular purpose. Should the mineral lease awarded by the Louisiana State Mineral and Energy Board be subsequently modified, cancelled or abrogated due to the existence of conflicting leases, operating agreements, private claims or other future obligations or conditions which may affect all or any portion of the leased Tract, it shall not relieve the Lessee of the obligation to pay any bonus due thereon to the Louisiana State Mineral and Energy Board, nor shall the Louisiana State Mineral and Energy Board be obligated to refund any consideration paid by the Lessor prior to such modification, cancellation, or abrogation, including, but not limited to, bonuses, rentals and royalties.

NOTE: The mineral lease is located in the Atchafalaya Delta WMA under the jurisdiction of the Louisiana Department of Wildlife and Fisheries which



has promulgated rules and regulations for the protection of game and wildlife on the aforesaid Tract and, therefore, shall be subject to said rules and regulations, a copy of which shall be attached to the mineral leases. In addition to the specific rules and regulations applicable, the following shall apply regarding operations under this mineral lease:

- No activities will be allowed without written authorization of the Louisiana Department of Wildlife and Fisheries.
- Proposed projects will be evaluated on a case by case basis. Modifications to proposed project features including but not limited to access routes, spoil placement, well sites, flowlines and appurtenant structures may be required by the Department of Wildlife and Fisheries.
- Compliance with the Atchafalaya Delta WMA regulations will be required unless otherwise specified by the Department of Wildlife and Fisheries.
- Compensatory mitigation will be required to offset unavoidable wetland impacts.
- Compensation and/or oyster seed ground surveys may be required by the Department for potential impacts to productive oyster seed grounds located within the management area.
- Removal of all structures, facilities and equipment will be required within 120 days of abandonment unless otherwise agreed to in writing by the Louisiana Department of Wildlife and Fisheries.
- No activities will be allowed during the hunting season unless approved by the Department.
- This tract is located within the emerging Atchafalaya Delta. No activities will be allowed on emergent islands, sub aerial mudflats or vegetated wetlands. Drilling will be restricted to passes and open water bays. The Louisiana Department of Wildlife and Fisheries (LDWF) shall have discretion to determine access routes. In the event that LDWF approves of dredging for access, LDWF shall have discretion to require hydraulic or spray dredging to reduce environmental impacts.
- Prior to submitting application for wetland permits to Federal and State permitting agencies the leaseholder shall coordinate project details with the Department of Wildlife and Fisheries. Contact person for the Department will be Mike Windham at (504)284-5268.

Additionally, the Department will require a minimum bonus of \$350.00 per acre and a minimum royalty of 25%.

NOTE: The State of Louisiana does hereby reserve, and this lease shall be subject to, the imprescriptible right of surface use in the nature of a servitude in favor of the Department of Natural Resources, including its Offices and Commissions, for the sole purpose of implementing, constructing, servicing and maintaining approved coastal zone management

and/or restoration projects. Utilization of any and all rights derived under this lease by the mineral lessee, its agents, successors or assigns, shall not interfere with nor hinder the reasonable surface use by the Department of Natural Resources, its Offices or Commissions, as herein above reserved.

NOTE: This tract is located in an area designated by the Louisiana Legislature or the Wildlife and Fisheries Commission as a Public Oyster Seed Ground, Reservation, or area of Calcasieu or Sabine Lake. Proposed projects occurring in these areas will be evaluated on a case by case basis by Louisiana Department of Wildlife & Fisheries. Modifications to proposed project features including, but not limited to, access routes, well sites, flowlines, and appurtenant structures maybe required by the Louisiana Department of Wildlife and Fisheries. In addition, compensatory mitigation will be required to offset unavoidable habitat impacts.

Applicant: LESLIE M. COOPER

Bidder	Cash Payment	Price/ Acre	Rental	Oil	Gas	Other



**Legend**

12100039

Wildlife

Active Leases

ST MARY PARISH

ATCHAFALAYA DELTA WMA

ATCHAFALAYA BAY

P.O.B.

SL 340\_B4

SL 20869

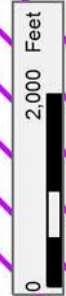



**TRACT 42940 - St. Mary Parish, Louisiana**

A portion of all lands located above the mean high water mark, together with lands now or formerly constituting the beds and bottoms of any water body of whatever description or nature belonging to the State of Louisiana which is now located within the boundaries of the Atchafalaya Delta Wildlife Management Area and not presently under mineral lease by the State of Louisiana on October 10, 2012, and more particularly located as follows: Beginning at a point within the Atchafalaya Delta Wildlife Management Area having Coordinates of X = 1,947,560.00 Y = 305,401.60; thence East 6,294.40 feet to a point being the Southernmost corner of State Lease No. 20869, having Coordinates of X = 1,953,854.40 and Y = 305,401.60; thence East approximately 11,765 feet to a point on the West line of State Lease No. 340, as amended, having a Coordinate of Y = 305,401.60; thence Southerly approximately 6,550 feet along the West line of said State Lease No. 340, as amended, to its Southwest corner; thence Westerly approximately 5,462 feet to a point on the East line of State Lease No. 20871, having a Coordinate of X = 1,960,098.11 and Y = 298,852.27; thence North 20 degrees 15 minutes 09 seconds West 2,039.85 feet along the East line of said State Lease No. 20871 to a point being its Northeast corner having Coordinates of X = 1,959,392.00 and Y = 300,766.00; thence South 89 degrees 36 minutes 05 seconds West 1,622.04 feet along the North line of said State Lease No. 20871, to a point being the Southeasternmost corner of State Lease No. 20878, having Coordinates of X = 1,957,770.00 and Y = 300,754.72; thence along the boundary of said State Lease No. 20878, the following courses: North 655.28 feet to a point having Coordinates of X = 1,957,770.00 and Y = 301,410.00, East 1,850.40 feet to a point having Coordinates of X = 1,959,620.40 and Y = 301,410.00, North 00 degrees 28 minutes 05 seconds West 1,910.06 feet to a point having Coordinates of X = 1,959,604.80 and Y = 303,320.00, West 2,266.80 feet to a point having Coordinates of X = 1,957,338.00 and Y = 303,320.00, South 02 degrees 15 minutes 38 seconds East 851.86 feet to a point having Coordinates of X = 1,957,371.60 and Y = 302,468.80, South 84 degrees 16 minutes 19 seconds West 2,344.51 feet to a point having Coordinates of X = 1,955,038.80 and Y = 302,234.80, North 89 degrees 05 minutes 00 seconds West 1,050.13 feet to a point having Coordinates of X = 1,953,988.80 and Y = 302,251.60, North 71 degrees 10 minutes 40 seconds West 3,311.49 feet to a point having Coordinates of X = 1,950,854.40 and Y = 303,320.00, West 2,064.40 feet to a point having Coordinates of X = 1,948,790.00 and Y = 303,320.00; South 1,685.00 feet to a point having Coordinates of X = 1,948,790.00 and Y = 301,635.00, South 75 degrees 19 minutes 46 seconds East 2,961.35 feet to a point having Coordinates of X = 1,951,654.80 and Y = 300,885.00, and South 88 degrees 00 minutes 36 seconds East 1,900.75 feet to a point having Coordinates of X = 1,953,554.40 and Y = 300,819.00; thence South 59 degrees 57 minutes 23 seconds East 184.75 feet to a point on the North line of said State Lease No. 20871, having Coordinates of X = 1,953,714.33 and Y = 300,726.50; thence South 89 degrees 36 minutes 05 seconds West 72.33 feet along the North line of said State Lease No. 20871, to a point being its Northwest corner having Coordinates of X = 1,953,642.00 and Y = 300,726.00; thence South 06 degrees 41 minutes 20

seconds West 2,086.20 feet along the West line of said State Lease No. 20871, to a point having Coordinates of X = 1,953,399.01 and Y = 298,654.00; thence West 2,109.01 feet to a point being the Southeast corner of State Lease No. 18351, as amended having Coordinates of X = 1,951,290.00 and Y = 298,654.00; thence North 57 degrees 31 minutes 48 seconds West 343.74 feet along the North line of said State Lease No. 18351, as amended, to a point being its Northernmost corner having Coordinates of X = 1,951,000.00 and Y = 298,838.54, said point also being the Northeast corner of State Lease No. 18350, as amended; thence North 57 degrees 31 minutes 48 seconds West 3,264.29 feet along the North line of State Lease No. 18350, as amended, to a point being its Northeast corner having Coordinates of X = 1,948,246.01 and Y = 300,591.00, said point also being the Eastern corner of State Lease No. 19006, as amended; thence North 57 degrees 31 minutes 48 seconds West 813.12 feet along the North line of said State Lease No. 19006, as amended, to a point having Coordinates of X = 1,947,560.00 and Y = 301,027.53; thence North 4,374.07 feet to the point of beginning, containing approximately **1,908 acres**, all as more particularly outlined on a plat on file in the Office of Mineral Resources, Department of Natural Resources. All bearings, distances and coordinates are based on Louisiana Coordinate System of 1927, (South Zone).

NOTE: The above description of the Tract nominated for lease has been provided and corrected, where required, exclusively by the nomination party. Any mineral lease selected from this Tract and awarded by the Louisiana State Mineral and Energy Board shall be without warranty of any kind, either express, implied, or statutory, including, but not limited to, the implied warranties of merchantability and fitness for a particular purpose. Should the mineral lease awarded by the Louisiana State Mineral and Energy Board be subsequently modified, cancelled or abrogated due to the existence of conflicting leases, operating agreements, private claims or other future obligations or conditions which may affect all or any portion of the leased Tract, it shall not relieve the Lessee of the obligation to pay any bonus due thereon to the Louisiana State Mineral and Energy Board, nor shall the Louisiana State Mineral and Energy Board be obligated to refund any consideration paid by the Lessor prior to such modification, cancellation, or abrogation, including, but not limited to, bonuses, rentals and royalties.

NOTE: The mineral lease is located in the Atchafalaya Delta WMA under the jurisdiction of the Louisiana Department of Wildlife and Fisheries which has promulgated rules and regulations for the protection of game and wildlife on the aforesaid Tract and, therefore, shall be subject to said rules and regulations, a copy of which shall be attached to the mineral leases. In addition to the specific rules and regulations applicable, the following shall apply regarding operations under this mineral lease:

- No activities will be allowed without written authorization of the Louisiana Department of Wildlife and Fisheries.



- Proposed projects will be evaluated on a case by case basis. Modifications to proposed project features including but not limited to access routes, spoil placement, well sites, flowlines and appurtenant structures may be required by the Department of Wildlife and Fisheries.
- Compliance with the Atchafalaya Delta WMA regulations will be required unless otherwise specified by the Department of Wildlife and Fisheries.
- Compensatory mitigation will be required to offset unavoidable wetland impacts.
- Compensation and/or oyster seed ground surveys may be required by the Department for potential impacts to productive oyster seed grounds located within the management area.
- Removal of all structures, facilities and equipment will be required within 120 days of abandonment unless otherwise agreed to in writing by the Louisiana Department of Wildlife and Fisheries.
- No activities will be allowed during the hunting season unless approved by the Department.
- This tract is located within the emerging Atchafalaya Delta. No activities will be allowed on emergent islands, sub aerial mudflats or vegetated wetlands. Drilling will be restricted to passes and open water bays. The Louisiana Department of Wildlife and Fisheries (LDWF) shall have discretion to determine access routes. In the event that LDWF approves of dredging for access, LDWF shall have discretion to require hydraulic or spray dredging to reduce environmental impacts.
- Prior to submitting application for wetland permits to Federal and State permitting agencies the leaseholder shall coordinate project details with the Department of Wildlife and Fisheries. Contact person for the Department will be Mike Windham at (504)284-5268.

Additionally, the Department will require a minimum bonus of \$350.00 per acre and a minimum royalty of 25%.

NOTE: The State of Louisiana does hereby reserve, and this lease shall be subject to, the imprescriptible right of surface use in the nature of a servitude in favor of the Department of Natural Resources, including its Offices and Commissions, for the sole purpose of implementing, constructing, servicing and maintaining approved coastal zone management and/or restoration projects. Utilization of any and all rights derived under this lease by the mineral lessee, its agents, successors or assigns, shall not interfere with nor hinder the reasonable surface use by the Department of Natural Resources, its Offices or Commissions, as herein above reserved.

NOTE: This tract is located in an area designated by the Louisiana Legislature or the Wildlife and Fisheries Commission as a Public Oyster Seed Ground, Reservation, or area of Calcasieu or Sabine Lake. Proposed

projects occurring in these areas will be evaluated on a case by case basis by Louisiana Department of Wildlife & Fisheries. Modifications to proposed project features including, but not limited to, access routes, well sites, flowlines, and appurtenant structures maybe required by the Louisiana Department of Wildlife and Fisheries. In addition, compensatory mitigation will be required to offset unavoidable habitat impacts.

Applicant: D. J. WATKINS

Bidder	Cash Payment	Price/ Acre	Rental	Oil	Gas	Other



**Legend**

12100003  
Wildlife

Active Leases



ATCHAFALAYA DELTA WMA

ST MARY PARISH

ATCHAFALAYA BAY

P.O.B.

SL 20869

SL 19006

SL 18350

SL 20878

SL 20870

SL 20871

SL 18351

SL 340\_B4



**TRACT 42941 - St. Mary Parish, Louisiana**

A portion of all lands located above the mean high water mark, together with lands now or formerly constituting the beds and bottoms of any water body of whatever description or nature belonging to the State of Louisiana which is now located within the boundaries of the Atchafalaya Delta Wildlife Management Area and not presently under mineral lease by the State of Louisiana on October 10, 2012, and more particularly located as follows: Beginning at a point within the Atchafalaya Delta Wildlife Management Area having Coordinates of X = 1,937,321.66 and Y = 305,401.60; thence East 10,238.34 feet to a point having Coordinates of X = 1,947,560.00 and Y = 305,401.60; thence South 4,374.07 feet to a point on the North line of State Lease No. 19006, as amended, having Coordinates of X = 1,947,560.00 and Y = 301,027.53; thence North 57 degrees 31 minutes 48 seconds West 3,394.68 feet along the North line of State Lease No. 19006, as amended, to a point having Coordinates of X = 1,944,696.00 and Y = 302,850.00; thence West 4,069.00 feet along the North line of State Lease No. 19006, as amended, to a point being its Northwest corner having Coordinates of X = 1,940,627.00 and Y = 302,850.00; thence South 2,259.00 feet along the West line of State Lease No. 19006, as amended, to a point being its Southwest corner having Coordinates of X = 1,940,627.00 and Y = 300,591.00, said point also being the Northwest corner of State Lease No. 18350, as amended; thence South 763.00 feet along the West line of State Lease No. 18350, as amended, to a point having Coordinates of X = 1,940,627.00 and Y = 299,828.00; thence South 24 degrees 36 minutes 47 seconds West 2,557.09 feet along the West line of State Lease No. 18350, as amended, to a point having Coordinates of X = 1,939,562.00 and Y = 297,503.25, said point being a common corner of State Lease No. 18350, as amended, State Lease No. 19006, as amended, and State Lease No. 18352, as amended; thence South 24 degrees 36 minutes 44 seconds West 240.16 feet along the West line of State Lease No. 19006, as amended, to a point being its Southwest corner having Coordinates of X = 1,939,461.98 and Y = 297,284.91; thence East 100.02 feet along the South line of State Lease No. 19006, as amended, to a point being its Southeast corner having Coordinates of X = 1,939,562.00 and Y = 297,284.91, said point also being the Southwest corner of State Lease No. 18352, as amended; thence East 363.41 feet along the South line of State Lease No. 18352, as amended, to a point having Coordinates of X = 1,939,925.41 and Y = 297,284.91; thence North 75 degrees 48 minutes 36 seconds East 890.69 feet along the South line of State Lease No. 18352, as amended, to a point having Coordinates of X = 1,940,788.92 and Y = 297,503.25, said point lying on the South line of State Lease No. 18350, as amended, and also being the Northeast corner of State Lease No. 18352, as amended; thence North 75 degrees 48 minutes 36 seconds East 4,694.31 feet along the South line of State Lease No. 18350, as amended, to a point having Coordinates of X = 1,945,340.00 and Y = 298,654.00; thence East 2,220.00 feet along the South line of State Lease No. 18350, as amended, to a point having Coordinates of X = 1,947,560.00 and Y = 298,654.00; thence South 5,746.86 feet to a point having Coordinates of X = 1,947,560.00 and Y = 292,907.14; thence West 10,249.22 feet to a point on the East line of State Lease No. 340, as

amended, having Coordinates of X = 1,937,310.78 and Y = 292,907.14; thence North 00 degrees 08 minutes 00 seconds East 4,674.75 feet along the East line of State Lease No. 340, as amended, to its Northeast corner having Coordinates of X = 1,937,321.66 and Y = 297,581.88; thence North 7,819.72 feet to the point of beginning, containing approximately **2,232.31 acres**, all as more particularly outlined on a plat on file in the Office of Mineral Resources, Department of Natural Resources. All bearings, distances and coordinates are based on Louisiana Coordinate System of 1927, (South Zone).

NOTE: The above description of the Tract nominated for lease has been provided and corrected, where required, exclusively by the nomination party. Any mineral lease selected from this Tract and awarded by the Louisiana State Mineral and Energy Board shall be without warranty of any kind, either express, implied, or statutory, including, but not limited to, the implied warranties of merchantability and fitness for a particular purpose. Should the mineral lease awarded by the Louisiana State Mineral and Energy Board be subsequently modified, cancelled or abrogated due to the existence of conflicting leases, operating agreements, private claims or other future obligations or conditions which may affect all or any portion of the leased Tract, it shall not relieve the Lessee of the obligation to pay any bonus due thereon to the Louisiana State Mineral and Energy Board, nor shall the Louisiana State Mineral and Energy Board be obligated to refund any consideration paid by the Lessor prior to such modification, cancellation, or abrogation, including, but not limited to, bonuses, rentals and royalties.

NOTE: The mineral lease is located in the Atchafalaya Delta WMA under the jurisdiction of the Louisiana Department of Wildlife and Fisheries which has promulgated rules and regulations for the protection of game and wildlife on the aforesaid Tract and, therefore, shall be subject to said rules and regulations, a copy of which shall be attached to the mineral leases. In addition to the specific rules and regulations applicable, the following shall apply regarding operations under this mineral lease:

- No activities will be allowed without written authorization of the Louisiana Department of Wildlife and Fisheries.
- Proposed projects will be evaluated on a case by case basis. Modifications to proposed project features including but not limited to access routes, spoil placement, well sites, flowlines and appurtenant structures may be required by the Department of Wildlife and Fisheries.
- Compliance with the Atchafalaya Delta WMA regulations will be required unless otherwise specified by the Department of Wildlife and Fisheries.
- Compensatory mitigation will be required to offset unavoidable wetland impacts.



- Compensation and/or oyster seed ground surveys may be required by the Department for potential impacts to productive oyster seed grounds located within the management area.
- Removal of all structures, facilities and equipment will be required within 120 days of abandonment unless otherwise agreed to in writing by the Louisiana Department of Wildlife and Fisheries.
- No activities will be allowed during the hunting season unless approved by the Department.
- This tract is located within the emerging Atchafalaya Delta. No activities will be allowed on emergent islands, sub aerial mudflats or vegetated wetlands. Drilling will be restricted to passes and open water bays. The Louisiana Department of Wildlife and Fisheries (LDWF) shall have discretion to determine access routes. In the event that LDWF approves of dredging for access, LDWF shall have discretion to require hydraulic or spray dredging to reduce environmental impacts.
- Prior to submitting application for wetland permits to Federal and State permitting agencies the leaseholder shall coordinate project details with the Department of Wildlife and Fisheries. Contact person for the Department will be Mike Windham at (504)284-5268.

Additionally, the Department will require a minimum bonus of \$350.00 per acre and a minimum royalty of 25%.

NOTE: The above described tract may be in the vicinity of existing shell reefs where drilling and dredging operations must be conducted in strict conformity with the regulations adopted by the Louisiana Department of Wildlife and Fisheries and/or the U.S. Corps of Engineers, U.S. Army.

NOTE: The State of Louisiana does hereby reserve, and this lease shall be subject to, the imprescriptible right of surface use in the nature of a servitude in favor of the Department of Natural Resources, including its Offices and Commissions, for the sole purpose of implementing, constructing, servicing and maintaining approved coastal zone management and/or restoration projects. Utilization of any and all rights derived under this lease by the mineral lessee, its agents, successors or assigns, shall not interfere with nor hinder the reasonable surface use by the Department of Natural Resources, its Offices or Commissions, as herein above reserved.

NOTE: This tract is located in an area designated by the Louisiana Legislature or the Wildlife and Fisheries Commission as a Public Oyster Seed Ground, Reservation, or area of Calcasieu or Sabine Lake. Proposed projects occurring in these areas will be evaluated on a case by case basis by Louisiana Department of Wildlife & Fisheries. Modifications to proposed project features including, but not limited to, access routes, well sites, flowlines, and appurtenant structures maybe required by the

Louisiana Department of Wildlife and Fisheries. In addition, compensatory mitigation will be required to offset unavoidable habitat impacts.

Applicant: D. J. WATKINS

Bidder	Cash Payment	Price/ Acre	Rental	Oil	Gas	Other



**Legend**

- 12100002
- Wildlife
- Blocks
- Active Leases

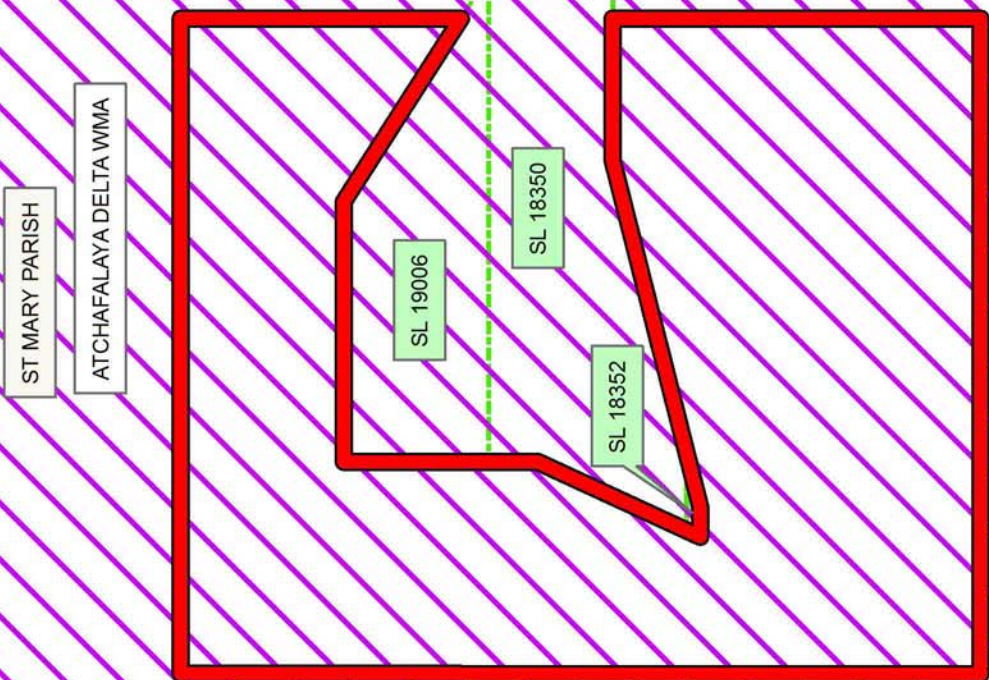

ST MARY PARISH  
ATCHAFALAYA DELTA WMA

P.O.B.

ATCHAFALAYA BAY

EI0400

EUGENE ISLAND AREA, REVISED

SL 340



**TRACT 42942 - St. Mary Parish, Louisiana**

A portion of all lands located above the mean high water mark, together with lands now or formerly constituting the beds and bottoms of any water body of whatever description or nature belonging to the State of Louisiana which is now located within the boundaries of the Atchafalaya Delta Wildlife Management Area and not presently under mineral lease by the State of Louisiana on October 10, 2012, and more particularly located as follows: Beginning at a point within the Atchafalaya Delta Wildlife Management Area and on the East line of State Lease No. 20871 having Coordinates of X = 1,960,098.11 and Y = 298,852.27; thence Easterly approximately 5,462 feet to the Southwest corner of State Lease No. 340, as amended; thence Easterly approximately 5,000 feet along the South line of State Lease No. 340, as amended, to a point having a Coordinate of X = 1,970,559.01; thence Southerly approximately 5,862 feet to a point on the North line of State Lease No. 20523, having Coordinates of X = 1,970,559.01 and Y = 292,928.01; thence along the boundary of said State Lease No. 20523, the following courses: South 70 degrees 51 minutes 25 seconds West 1,570.42 feet to a point having Coordinates of X = 1,969,075.43 and Y = 292,413.02; South 34 degrees 54 minutes 56 seconds West 4,041.86 feet to a point having Coordinates of X = 1,966,762.00 and Y = 289,098.70; South 557.04 feet to a point having Coordinates of X = 1,966,762.00 and Y = 288,541.66; and South 77 degrees 02 minutes 29 seconds East 3,233.01 feet to a point having Coordinates of X = 1,969,912.67 and Y = 287,816.66; thence West 10,987.11 feet to a point having Coordinates of X = 1,958,925.56 and Y = 287,816.66; thence North 5,487.90 feet to a point on the Southern line of State Lease No. 20873 having Coordinates of X = 1,958,925.56 and Y = 293,304.57; thence North 79 degrees 52 minutes 27 seconds East 3,068.23 feet along the South line of said State Lease No. 20873, to a point being its Southeast corner having Coordinates of X = 1,961,946.00 and Y = 293,844.00; thence North 20 degrees 15 minutes 09 seconds West 2,675.08 feet along the East line of State Lease No. 20873, to a point being its Northernmost corner having Coordinates of X = 1,961,020.00 and Y = 296,353.70, said point also being a Southeast corner of State Lease No. 20871; thence North 20 degrees 15 minutes 09 seconds West 2,663.22 feet along the East line of State Lease No. 20871, to the point of beginning, containing approximately **2,389 acres**, all as more particularly outlined on a plat on file in the Office of Mineral Resources, Department of Natural Resources. All bearings, distances and coordinates are based on Louisiana Coordinate System of 1927, (South Zone).

NOTE: The above description of the Tract nominated for lease has been provided and corrected, where required, exclusively by the nomination party. Any mineral lease selected from this Tract and awarded by the Louisiana State Mineral and Energy Board shall be without warranty of any kind, either express, implied, or statutory, including, but not limited to, the implied warranties of merchantability and fitness for a particular purpose. Should the mineral lease awarded by the Louisiana State Mineral and Energy Board be subsequently modified, cancelled or abrogated due to



the existence of conflicting leases, operating agreements, private claims or other future obligations or conditions which may affect all or any portion of the leased Tract, it shall not relieve the Lessee of the obligation to pay any bonus due thereon to the Louisiana State Mineral and Energy Board, nor shall the Louisiana State Mineral and Energy Board be obligated to refund any consideration paid by the Lessor prior to such modification, cancellation, or abrogation, including, but not limited to, bonuses, rentals and royalties.

NOTE: The mineral lease is located in the Atchafalaya Delta WMA under the jurisdiction of the Louisiana Department of Wildlife and Fisheries which has promulgated rules and regulations for the protection of game and wildlife on the aforesaid Tract and, therefore, shall be subject to said rules and regulations, a copy of which shall be attached to the mineral leases. In addition to the specific rules and regulations applicable, the following shall apply regarding operations under this mineral lease:

- No activities will be allowed without written authorization of the Louisiana Department of Wildlife and Fisheries.
- Proposed projects will be evaluated on a case by case basis. Modifications to proposed project features including but not limited to access routes, spoil placement, well sites, flowlines and appurtenant structures may be required by the Department of Wildlife and Fisheries.
- Compliance with the Atchafalaya Delta WMA regulations will be required unless otherwise specified by the Department of Wildlife and Fisheries.
- Compensatory mitigation will be required to offset unavoidable wetland impacts.
- Compensation and/or oyster seed ground surveys may be required by the Department for potential impacts to productive oyster seed grounds located within the management area.
- Removal of all structures, facilities and equipment will be required within 120 days of abandonment unless otherwise agreed to in writing by the Louisiana Department of Wildlife and Fisheries.
- No activities will be allowed during the hunting season unless approved by the Department.
- This tract is located within the emerging Atchafalaya Delta. No activities will be allowed on emergent islands, sub aerial mudflats or vegetated wetlands. Drilling will be restricted to passes and open water bays. The Louisiana Department of Wildlife and Fisheries (LDWF) shall have discretion to determine access routes. In the event that LDWF approves of dredging for access, LDWF shall have discretion to require hydraulic or spray dredging to reduce environmental impacts.
- Prior to submitting application for wetland permits to Federal and State permitting agencies the leaseholder shall coordinate project

details with the Department of Wildlife and Fisheries. Contact person for the Department will be Mike Windham at (504)284-5268.

Additionally, the Department will require a minimum bonus of \$350.00 per acre and a minimum royalty of 25%.

NOTE: The State of Louisiana does hereby reserve, and this lease shall be subject to, the imprescriptible right of surface use in the nature of a servitude in favor of the Department of Natural Resources, including its Offices and Commissions, for the sole purpose of implementing, constructing, servicing and maintaining approved coastal zone management and/or restoration projects. Utilization of any and all rights derived under this lease by the mineral lessee, its agents, successors or assigns, shall not interfere with nor hinder the reasonable surface use by the Department of Natural Resources, its Offices or Commissions, as herein above reserved.

NOTE: This tract is located in an area designated by the Louisiana Legislature or the Wildlife and Fisheries Commission as a Public Oyster Seed Ground, Reservation, or area of Calcasieu or Sabine Lake. Proposed projects occurring in these areas will be evaluated on a case by case basis by Louisiana Department of Wildlife & Fisheries. Modifications to proposed project features including, but not limited to, access routes, well sites, flowlines, and appurtenant structures maybe required by the Louisiana Department of Wildlife and Fisheries. In addition, compensatory mitigation will be required to offset unavoidable habitat impacts.

Applicant: D. J. WATKINS

Bidder	Cash Payment	Price/Acre	Rental	Oil	Gas	Other



**Legend**

12100004  
Wildlife  
Active Leases

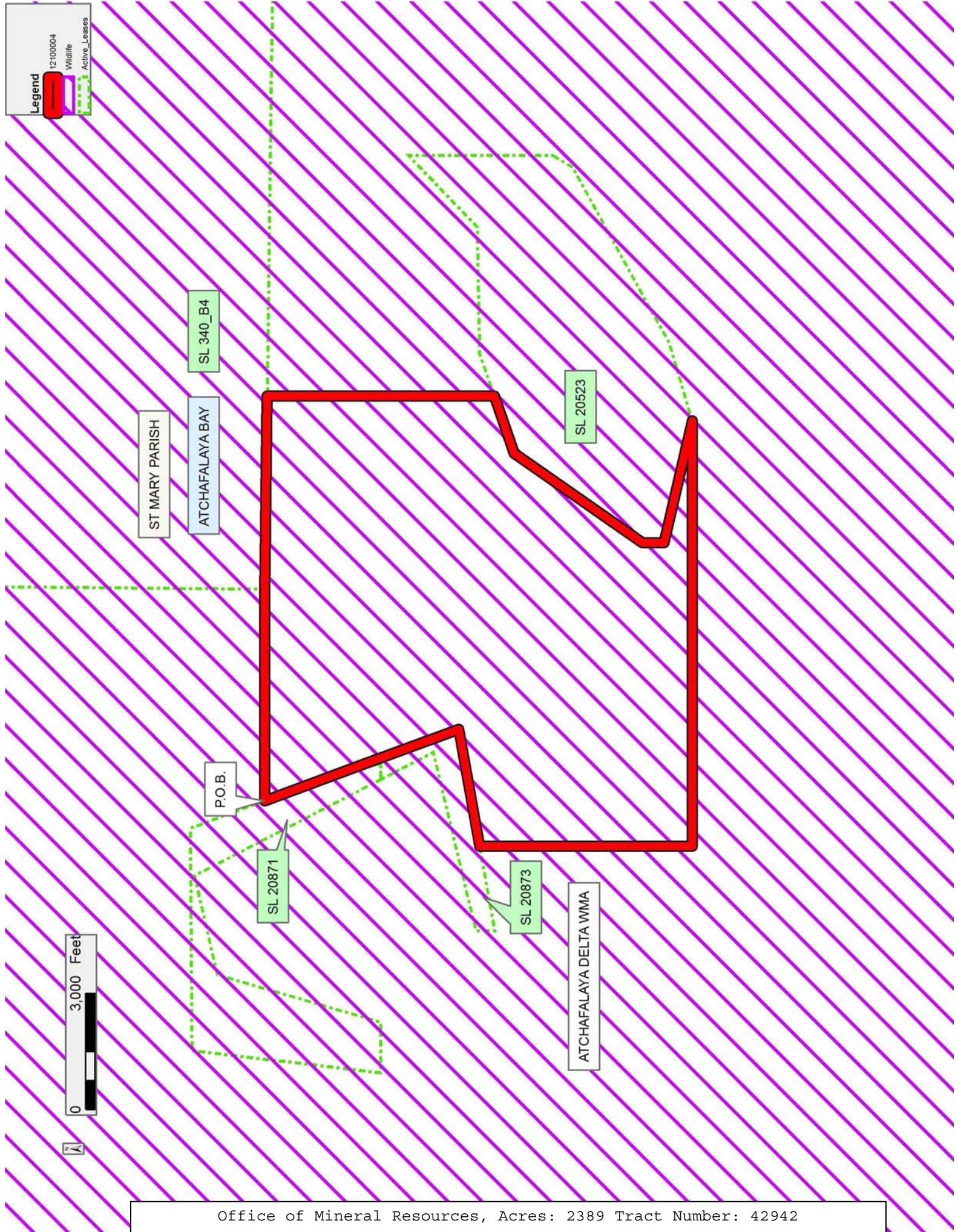



#### **TRACT 42943 - St. Mary Parish, Louisiana**

A portion of all lands located above the mean high water mark, together with lands now or formerly constituting the beds and bottoms of any water body of whatever description or nature belonging to the State of Louisiana which is now located within the boundaries of the Atchafalaya Delta Wildlife Management Area and not presently under mineral lease by the State of Louisiana on October 10, 2012, and more particularly located as follows: Beginning at a point within the Atchafalaya Delta Wildlife Management Area being a point on the Northern boundary of State Lease No. 20523 having Coordinates of X = 1,970,559.01 and Y = 292,928.01; thence Northerly approximately 5,861 feet to the South boundary of a portion of State Lease No. 340, as amended; thence Easterly approximately 8,684 feet along the South boundary of said State Lease No. 340 to the point of intersection with a North-South line having a Coordinate of X = 1,979,242.09; thence South approximately 2,723 feet along said line to the Northeast corner of State Lease No. 20524 having Coordinates of X = 1,979,242.09 and Y = 295,957.29; thence along the boundary of said State Lease No. 20524 the following courses: South 89 degrees 49 minutes 02 seconds West 1,633.02 feet and South 46 degrees 06 minutes 08 seconds West 1,175.56 feet to its Westernmost Northwest corner, also being the Northeast corner of State Lease No. 20523 having Coordinates of X = 1,976,762.00 and Y = 295,136.98; thence along the boundary of said State Lease No. 20523 the following courses: South 46 degrees 06 minutes 08 seconds West 2,550.19 feet; South 88 degrees 57 minutes 00 seconds West 3,268.78 feet; South 70 degrees 51 minutes 25 seconds West 1,161.37 feet to the point of beginning, **LESS AND EXCEPT** that portion, if any, of State Lease No. 340, as amended, which may lie within the above described tract, containing approximately **902 acres**, all as more particularly outlined on a plat on file in the Office of Mineral Resources, Department of Natural Resources. All bearings, distances and coordinates are based on Louisiana Coordinate System of 1927, (South Zone).

NOTE: The above description of the Tract nominated for lease has been provided and corrected, where required, exclusively by the nomination party. Any mineral lease selected from this Tract and awarded by the Louisiana State Mineral and Energy Board shall be without warranty of any kind, either express, implied, or statutory, including, but not limited to, the implied warranties of merchantability and fitness for a particular purpose. Should the mineral lease awarded by the Louisiana State Mineral and Energy Board be subsequently modified, cancelled or abrogated due to the existence of conflicting leases, operating agreements, private claims or other future obligations or conditions which may affect all or any portion of the leased Tract, it shall not relieve the Lessee of the obligation to pay any bonus due thereon to the Louisiana State Mineral and Energy Board, nor shall the Louisiana State Mineral and Energy Board be obligated to refund any consideration paid by the Lessor prior to such modification, cancellation, or abrogation, including, but not limited to, bonuses, rentals and royalties.



NOTE: The mineral lease is located in the Atchafalaya Delta WMA under the jurisdiction of the Louisiana Department of Wildlife and Fisheries which has promulgated rules and regulations for the protection of game and wildlife on the aforesaid Tract and, therefore, shall be subject to said rules and regulations, a copy of which shall be attached to the mineral leases. In addition to the specific rules and regulations applicable, the following shall apply regarding operations under this mineral lease:

- No activities will be allowed without written authorization of the Louisiana Department of Wildlife and Fisheries.
- Proposed projects will be evaluated on a case by case basis. Modifications to proposed project features including but not limited to access routes, spoil placement, well sites, flowlines and appurtenant structures may be required by the Department of Wildlife and Fisheries.
- Compliance with the Atchafalaya Delta WMA regulations will be required unless otherwise specified by the Department of Wildlife and Fisheries.
- Compensatory mitigation will be required to offset unavoidable wetland impacts.
- Compensation and/or oyster seed ground surveys may be required by the Department for potential impacts to productive oyster seed grounds located within the management area.
- Removal of all structures, facilities and equipment will be required within 120 days of abandonment unless otherwise agreed to in writing by the Louisiana Department of Wildlife and Fisheries.
- No activities will be allowed during the hunting season unless approved by the Department.
- This tract is located within the emerging Atchafalaya Delta. No activities will be allowed on emergent islands, sub aerial mudflats or vegetated wetlands. Drilling will be restricted to passes and open water bays. The Louisiana Department of Wildlife and Fisheries (LDWF) shall have discretion to determine access routes. In the event that LDWF approves of dredging for access, LDWF shall have discretion to require hydraulic or spray dredging to reduce environmental impacts.
- Prior to submitting application for wetland permits to Federal and State permitting agencies the leaseholder shall coordinate project details with the Department of Wildlife and Fisheries. Contact person for the Department will be Mike Windham at (504)284-5268.

Additionally, the Department will require a minimum bonus of \$350.00 per acre and a minimum royalty of 25%.

NOTE: The State of Louisiana does hereby reserve, and this lease shall be subject to, the imprescriptible right of surface use in the nature of a servitude in favor of the Department of Natural Resources, including its

Offices and Commissions, for the sole purpose of implementing, constructing, servicing and maintaining approved coastal zone management and/or restoration projects. Utilization of any and all rights derived under this lease by the mineral lessee, its agents, successors or assigns, shall not interfere with nor hinder the reasonable surface use by the Department of Natural Resources, its Offices or Commissions, as herein above reserved.

NOTE: This tract is located in an area designated by the Louisiana Legislature or the Wildlife and Fisheries Commission as a Public Oyster Seed Ground, Reservation, or area of Calcasieu or Sabine Lake. Proposed projects occurring in these areas will be evaluated on a case by case basis by Louisiana Department of Wildlife & Fisheries. Modifications to proposed project features including, but not limited to, access routes, well sites, flowlines, and appurtenant structures maybe required by the Louisiana Department of Wildlife and Fisheries. In addition, compensatory mitigation will be required to offset unavoidable habitat impacts.

Applicant: LESLIE M. COOPER

Bidder	Cash Payment	Price/ Acre	Rental	Oil	Gas	Other



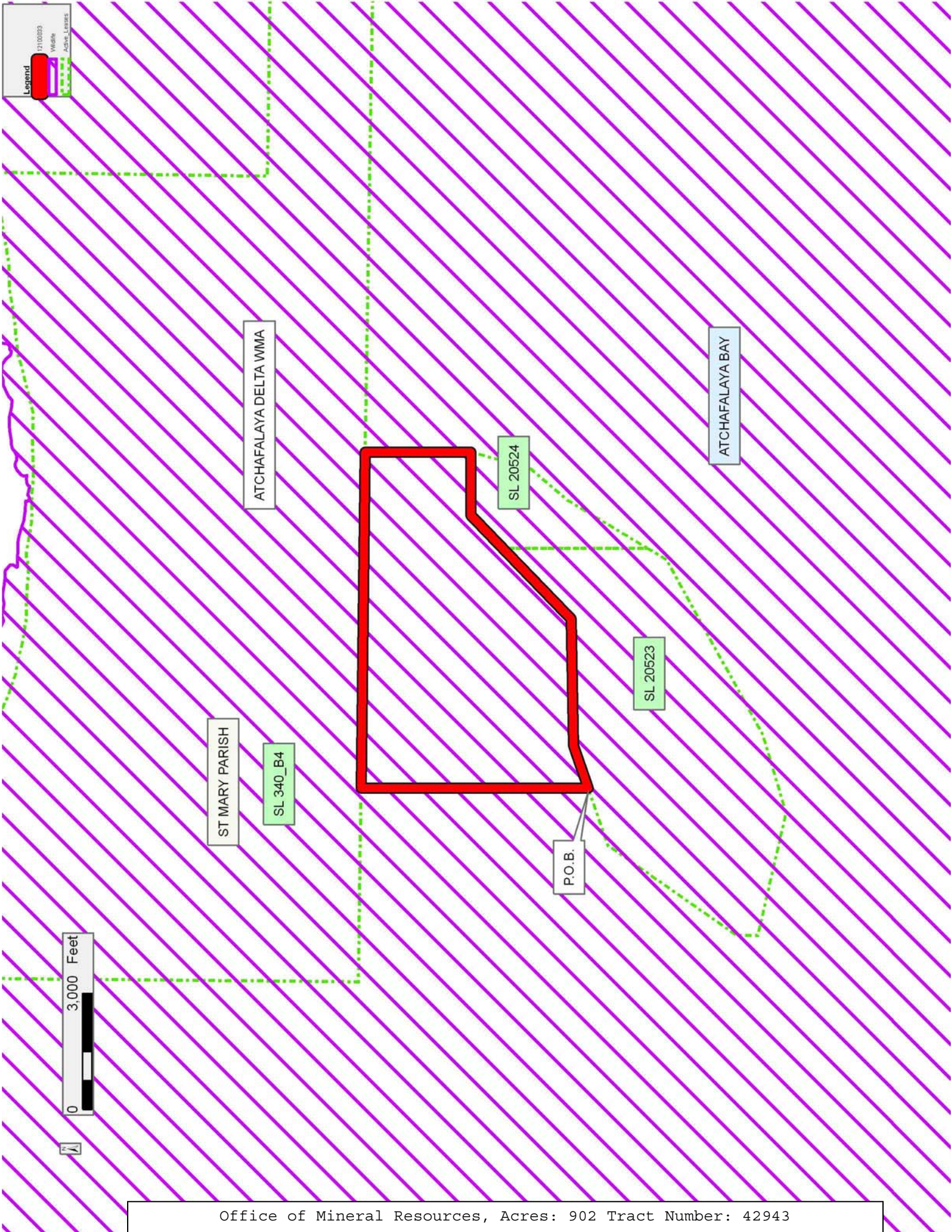



**TRACT 42944 - St. Mary Parish, Louisiana**

A portion of all lands located above the mean high water mark, together with lands now or formerly constituting the beds and bottoms of any water body of whatever description or nature belonging to the State of Louisiana which is now located within the boundaries of the Atchafalaya Delta Wildlife Management Area and not presently under mineral lease by the State of Louisiana on October 10, 2012, and more particularly located as follows: Beginning at a point within the Atchafalaya Delta Wildlife Management Area having Coordinates of X = 1,976,762.00 and Y = 287,764.45; thence North 3,640.45 feet to a point on the South boundary of State Lease No. 20524 having Coordinates of X = 1,976,762.00 and Y = 291,404.90; thence along the boundaries of said State Lease No. 20524 the following courses: North 31 degrees 01 minutes 56 seconds East 2,401.28 feet to a point having Coordinates of X = 1,977,999.91 and Y = 293,462.50, North 40 degrees 25 minutes 22 seconds East 1,269.11 feet to a point having Coordinates of X = 1,978,822.82 and Y = 294,428.64 and North 15 degrees 20 minutes 16 seconds East 1,585.10 feet to its Northeast corner having Coordinates of X = 1,979,242.09 and Y = 295,957.29; thence North approximately 2,723 feet to a point on the South boundary of a portion of State Lease No. 340 B4, as amended; thence Easterly approximately 7,521 feet along the South boundary of said State Lease No. 340 B4 to the point of intersection with a North-South line having a Coordinate of X = 1,986,762.00; thence South approximately 10,794 feet along said line to a point having Coordinates of X = 1,986,762.00 and Y = 287,764.45; thence West 10,000.00 feet to the point of beginning, **LESS AND EXCEPT** that portion, if any, of State Lease No. 340 B4, as amended, which may lie within the above described tract, containing approximately **2,195 acres**, all as more particularly outlined on a plat on file in the Office of Mineral Resources, Department of Natural Resources. All bearings, distances and coordinates are based on Louisiana Coordinate System of 1927, (South Zone).

NOTE: The above description of the Tract nominated for lease has been provided and corrected, where required, exclusively by the nomination party. Any mineral lease selected from this Tract and awarded by the Louisiana State Mineral and Energy Board shall be without warranty of any kind, either express, implied, or statutory, including, but not limited to, the implied warranties of merchantability and fitness for a particular purpose. Should the mineral lease awarded by the Louisiana State Mineral and Energy Board be subsequently modified, cancelled or abrogated due to the existence of conflicting leases, operating agreements, private claims or other future obligations or conditions which may affect all or any portion of the leased Tract, it shall not relieve the Lessee of the obligation to pay any bonus due thereon to the Louisiana State Mineral and Energy Board, nor shall the Louisiana State Mineral and Energy Board be obligated to refund any consideration paid by the Lessor prior to such modification, cancellation, or abrogation, including, but not limited to, bonuses, rentals and royalties.



NOTE: The mineral lease is located in the Atchafalaya Delta WMA under the jurisdiction of the Louisiana Department of Wildlife and Fisheries which has promulgated rules and regulations for the protection of game and wildlife on the aforesaid Tract and, therefore, shall be subject to said rules and regulations, a copy of which shall be attached to the mineral leases. In addition to the specific rules and regulations applicable, the following shall apply regarding operations under this mineral lease:

- No activities will be allowed without written authorization of the Louisiana Department of Wildlife and Fisheries.
- Proposed projects will be evaluated on a case by case basis. Modifications to proposed project features including but not limited to access routes, spoil placement, well sites, flowlines and appurtenant structures may be required by the Department of Wildlife and Fisheries.
- Compliance with the Atchafalaya Delta WMA regulations will be required unless otherwise specified by the Department of Wildlife and Fisheries.
- Compensatory mitigation will be required to offset unavoidable wetland impacts.
- Compensation and/or oyster seed ground surveys may be required by the Department for potential impacts to productive oyster seed grounds located within the management area.
- Removal of all structures, facilities and equipment will be required within 120 days of abandonment unless otherwise agreed to in writing by the Louisiana Department of Wildlife and Fisheries.
- No activities will be allowed during the hunting season unless approved by the Department.
- This tract is located within the emerging Atchafalaya Delta. No activities will be allowed on emergent islands, sub aerial mudflats or vegetated wetlands. Drilling will be restricted to passes and open water bays. The Louisiana Department of Wildlife and Fisheries (LDWF) shall have discretion to determine access routes. In the event that LDWF approves of dredging for access, LDWF shall have discretion to require hydraulic or spray dredging to reduce environmental impacts.
- Prior to submitting application for wetland permits to Federal and State permitting agencies the leaseholder shall coordinate project details with the Department of Wildlife and Fisheries. Contact person for the Department will be Mike Windham at (504)284-5268.

Additionally, the Department will require a minimum bonus of \$350.00 per acre and a minimum royalty of 25%.

NOTE: The State of Louisiana does hereby reserve, and this lease shall be subject to, the imprescriptible right of surface use in the nature of a

servitude in favor of the Department of Natural Resources, including its Offices and Commissions, for the sole purpose of implementing, constructing, servicing and maintaining approved coastal zone management and/or restoration projects. Utilization of any and all rights derived under this lease by the mineral lessee, its agents, successors or assigns, shall not interfere with nor hinder the reasonable surface use by the Department of Natural Resources, its Offices or Commissions, as herein above reserved.

NOTE: This tract is located in an area designated by the Louisiana Legislature or the Wildlife and Fisheries Commission as a Public Oyster Seed Ground, Reservation, or area of Calcasieu or Sabine Lake. Proposed projects occurring in these areas will be evaluated on a case by case basis by Louisiana Department of Wildlife & Fisheries. Modifications to proposed project features including, but not limited to, access routes, well sites, flowlines, and appurtenant structures maybe required by the Louisiana Department of Wildlife and Fisheries. In addition, compensatory mitigation will be required to offset unavoidable habitat impacts.

Applicant: LESLIE M. COOPER

Bidder	Cash Payment	Price/ Acre	Rental	Oil	Gas	Other



**Legend**

12100032

Wildlife

Active Leases

