

TRACT 45943 - Portion of Block 32, Main Pass Area, Revised, Plaquemines Parish, Louisiana

All of the lands now or formerly constituting the beds and bottoms of all water bodies of every nature and description as to which title is vested in the State of Louisiana, together with all islands arising therein and other lands formed by accretion or by reliction, where allowed by law, excepting tax adjudicated lands, and not presently under mineral lease on July 9, 2025, situated in Plaquemines Parish, Louisiana, and more particularly described as follows: Beginning at a point having Coordinates of X = 2,620,600.00 and Y = 307,580.00, said point being the Northeast corner of Block 32, Main Pass Area, Revised; thence South 10,300.00 feet along the East line of said Block 32, Main Pass Area, Revised, to a point having Coordinates of X = 2,620,600.00 and Y = 297,280.00, said point also being the Northeast corner of State Lease No. 1958, as amended; thence West 14,750.00 feet along the North line of said State Lease No. 1958, as amended, to a point having Coordinates of X = 2,605,850.00 and Y = 297,280.00, said point being the Northwest corner of said State Lease No. 1958, as amended, said point also being on the West line of said Block 32, Main Pass Area, Revised; thence North 8,800.00 feet along said West line of said Block 32, Main Pass Area, Revised, to a point having Coordinates of X = 2,605,850.00 and Y = 306,080.00; thence North 45 degrees 00 minutes 00 seconds East 2,121.32 feet to a point having Coordinates of X = 2,607,350.00 and Y = 307,580.00, said point being on the North line of said Block 32, Main Pass Area, Revised; thence East 13,250.00 feet along said North line of said Block 32, Main Pass Area, Revised, to the point of beginning, **LESS AND EXCEPT** all that portion of the above described tract situated within the surface boundaries of State Lease No. 22175 and being more particularly described as follows: Beginning at a point within Block 32, Main Pass Area, Revised, said point having Coordinates of point X = 2,619,555.00 and Y = 306,526.00; thence South 7,350.67 feet to a point having Coordinates of X = 2,619,555.00 and Y = 299,175.83; thence West 8,191.90 feet to a point having Coordinates of X = 2,611,363.10 and Y = 299,175.83; thence North 1,911.50 feet to a point having Coordinates of X = 2,611,363.10 and Y = 301,087.33; thence North 50 degrees 51 minutes 38 seconds East 8,617.08 feet to a point having Coordinates of X = 2,618,046.62 and Y = 306,526.50; thence East 1,508.38 feet to the point of beginning, containing approximately 965.10 acres. The above described tract contains approximately **2,496.79 acres**, all as more particularly outlined on a plat on file in the Office of Mineral Resources, Department of Natural Resources. All bearings, distances and coordinates are based on Louisiana Coordinate System of 1927, (North or South Zone), where applicable.

NOTE: The above description of the Tract nominated for lease has been provided and corrected, where required, exclusively by the nomination party. Any mineral lease selected from this Tract and awarded by the Louisiana State Mineral and Energy Board shall be without warranty of any kind, either express, implied, or statutory, including, but not limited to, the implied warranties of merchantability and fitness for a particular purpose. Should the mineral lease awarded by the Louisiana State Mineral and Energy Board be subsequently modified, cancelled or abrogated due to the existence of

conflicting leases, operating agreements, private claims or other future obligations or conditions which may affect all or any portion of the leased Tract, it shall not relieve the Lessee of the obligation to pay any bonus due thereon to the Louisiana State Mineral and Energy Board, nor shall the Louisiana State Mineral and Energy Board be obligated to refund any consideration paid by the Lessor prior to such modification, cancellation, or abrogation, including, but not limited to, bonuses, rentals and royalties.

NOTE: The State of Louisiana does hereby reserve, and this lease shall be subject to, the imprescriptible right of surface use in the nature of a servitude in favor of the Department of Natural Resources, including its Offices and Commissions, for the sole purpose of implementing, constructing, servicing and maintaining approved coastal zone management and/or restoration projects. Utilization of any and all rights derived under this lease by the mineral lessee, its agents, successors or assigns, shall not interfere with nor hinder the reasonable surface use by the Department of Natural Resources, its Offices or Commissions, as herein above reserved.

NOTE: This tract is located in an area designated by the Louisiana Legislature or the Wildlife and Fisheries Commission as a Public Oyster Seed Ground, Reservation, or area of Calcasieu or Sabine Lake. Proposed projects occurring in these areas will be evaluated on a case by case basis by Louisiana Department of Wildlife & Fisheries. Modifications to proposed project features including, but not limited to, access routes, well sites, flowlines, and appurtenant structures maybe required by the Louisiana Department of Wildlife and Fisheries. In addition, compensatory mitigation will be required to offset unavoidable habitat impacts.

Applicant: ROBERT A. SCHROEDER, INC.

Bidder	Cash Payment	Price/ Acre	Rental	Oil	Gas	Other



PLAQUEMINES

Main Pass
Area,
Revised

MP00025

Legend

25070003

Blocks

Active Leases

P.O.B.

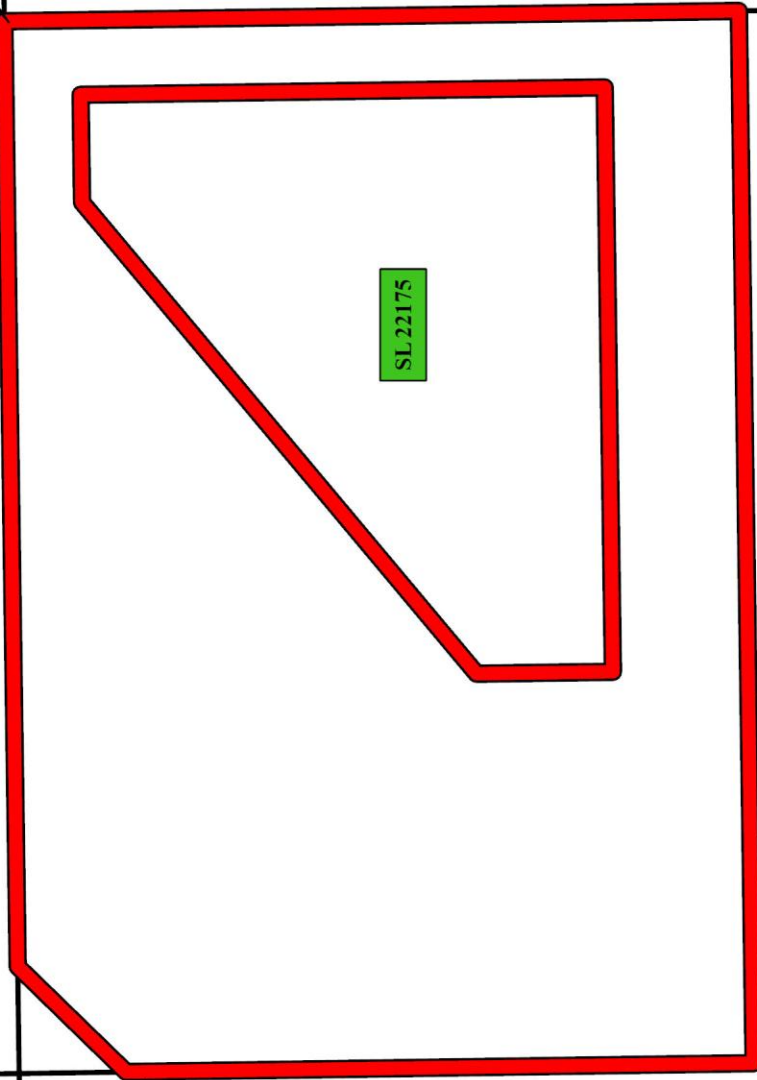

SL 22175

MP00031

MP00033

MP00032

SL 1958